

GENERAL NOTES FOR PEDESTRIAN FACILITIES

1. ALL SLOPES ARE MAXIMUM ALLOWABLE. THE LEAST POSSIBLE SLOPE THAT WILL STILL DRAIN PROPERLY SHOULD BE USED. ADJUST CURB RAMP LENGTH OR GRADE OF APPROACH SIDEWALKS AS DIRECTED.
2. LANDINGS SHALL BE 6" MINIMUM WITH A MAXIMUM 2% SLOPE IN ANY DIRECTION.
3. MANEUVERING SPACE AT THE BOTTOM OF CURB RAMP SHALL BE A MINIMUM OF 4'x4' WHOLLY CONTAINED WITHIN THE CROSSWALK AND WHOLLY OUTSIDE THE PARALLEL VEHICULAR TRAVEL PATH.
4. MAXIMUM ALLOWABLE CROSS SLOPE ON SIDEWALK AND CURB RAMP SURFACES IS 2%.
5. CURB RAMP WITH RETURNED CURBS MAY BE USED ONLY WHERE PEDESTRIANS WOULD NOT NORMALLY WALK ACROSS THE RAMP. EITHER BECAUSE THE ADJACENT SURFACE IS PLANTING OR OTHER NON-WALKING SURFACE OR BECAUSE THE SIDE APPROACH IS SUBSTANTIALLY OBSTRUCTED. OTHERWISE, PROVIDE FLARED SIDES.
6. ADDITIONAL INFORMATION ON CURB RAMP LOCATION, DESIGN, LIGHT REFLECTIVE VALUE AND TEXTURE MAY BE FOUND IN THE CURRENT EDITION OF THE TEXAS ACCESSIBILITY STANDARDS (TAS) AND 16 TAC §88.102.
7. CURB RAMP SHALL BE ALIGNED WITH THEORETICAL CROSSWALKS, OR AS DIRECTED BY THE TOWN ENGINEER.
8. HANDRAILS ARE NOT REQUIRED ON CURB RAMP. PROVIDE CURB RAMP WHEREVER ON ACCESSIBLE ROUTE CROSSES (PENETRATES) A CURB.
9. FLARE SLOPE SHALL NOT EXCEED 10% MEASURED ALONG CURB LINE.
10. BARRIER FREE RAMP SHALL BE CONSTRUCTED IN ACCORDANCE WITH THE CURRENT EDITION OF THE TEXAS ACCESSIBILITY STANDARDS (TAS).
11. ALL BARRIER FREE RAMP MUST PASS AN INDEPENDENT INSPECTION. A LETTER OF COMPLIANCE ACCEPTANCE IS REQUIRED PRIOR TO FINAL ACCEPTANCE BY THE TOWN OF ADDISON.
12. STREETS ON STEEP GRADE WILL REQUIRE LONGER TRANSITION ON UPGRADE SIDE.
13. MAXIMUM SLOPE ON RAMP PORTION SHALL NOT EXCEED 1" PER FOOT AT ANY LOCATION. VERTICAL DISTANCE BETWEEN STREET AND RAMP SHALL NOT EXCEED 4".

GENERAL NOTES FOR DETECTABLE WARNINGS

1. CURB RAMP MUST CONTAIN A DETECTABLE WARNING SURFACE THAT CONSIST OF RAISED TRUNCATED DOME PAVING COMPLYING WITH SECTION 4.29 OF THE TEXAS ACCESSIBILITY STANDARDS (TAS). THE SURFACE MUST CONTRAST VISUALLY WITH THE ADJOINING SURFACES, INCLUDING SIDE FLARES. FURNISH DARK RED COLORED DETECTABLE WARNING SURFACE ADJACENT TO UNCOLORED CONCRETE AND CREAM COLORED DETECTABLE WARNING SURFACE ADJACENT TO DARK RED COLORED BROOK PAVERS.
2. DETECTABLE WARNING SURFACES MUST BE SLIP RESISTANT AND NOT ALLOW WATER TO ACCUMULATE.
3. ALIGN TRUNCATED DOME IN THE DIRECTION OF PEDESTRIAN TRAVEL WHEN ENTERING THE STREET.
4. DETECTABLE WARNING SURFACES SHALL BE A MINIMUM OF 24" IN DEPTH IN THE DIRECTION OF PEDESTRIAN TRAVEL AND EXTEND THE FULL WIDTH OF THE CURB RAMP OR LANDING WHERE THE PEDESTRIAN ACCESS ROUTE ENTERS THE STREET.
5. DETECTABLE WARNING SURFACES SHALL BE LOCATED SO THAT THE EDGE NEAREST THE CURB LINE IS A MINIMUM OF 6" AND A MAXIMUM OF 8" FROM THE EXTENSION OF THE FACE OF CURB AND SHALL BE AN INTEGRAL PART OF THE WALKING SURFACE. DETECTABLE WARNING SURFACES MAY BE CURVED ALONG THE CORNER RADIUS.

GENERAL NOTES FOR DETECTABLE WARNING PAVEMENT UNITS

1. DETECTABLE WARNING PAVEMENT UNITS SHALL MEET OR EXCEED ALL REQUIREMENTS OF ASTM C-936, C-933, AND BE LAID IN A TWO BY TWO UNIT BASKET WEAVE PATTERN OR AS DIRECTED.
2. LAY FULL-SIZE UNITS FIRST FOLLOWED BY CLOSURE UNITS CONSISTING OF AT LEAST 25 PERCENT OF A FULL UNIT. CUT DETECTABLE WARNING PAVEMENT UNITS USING A POWER SAW.

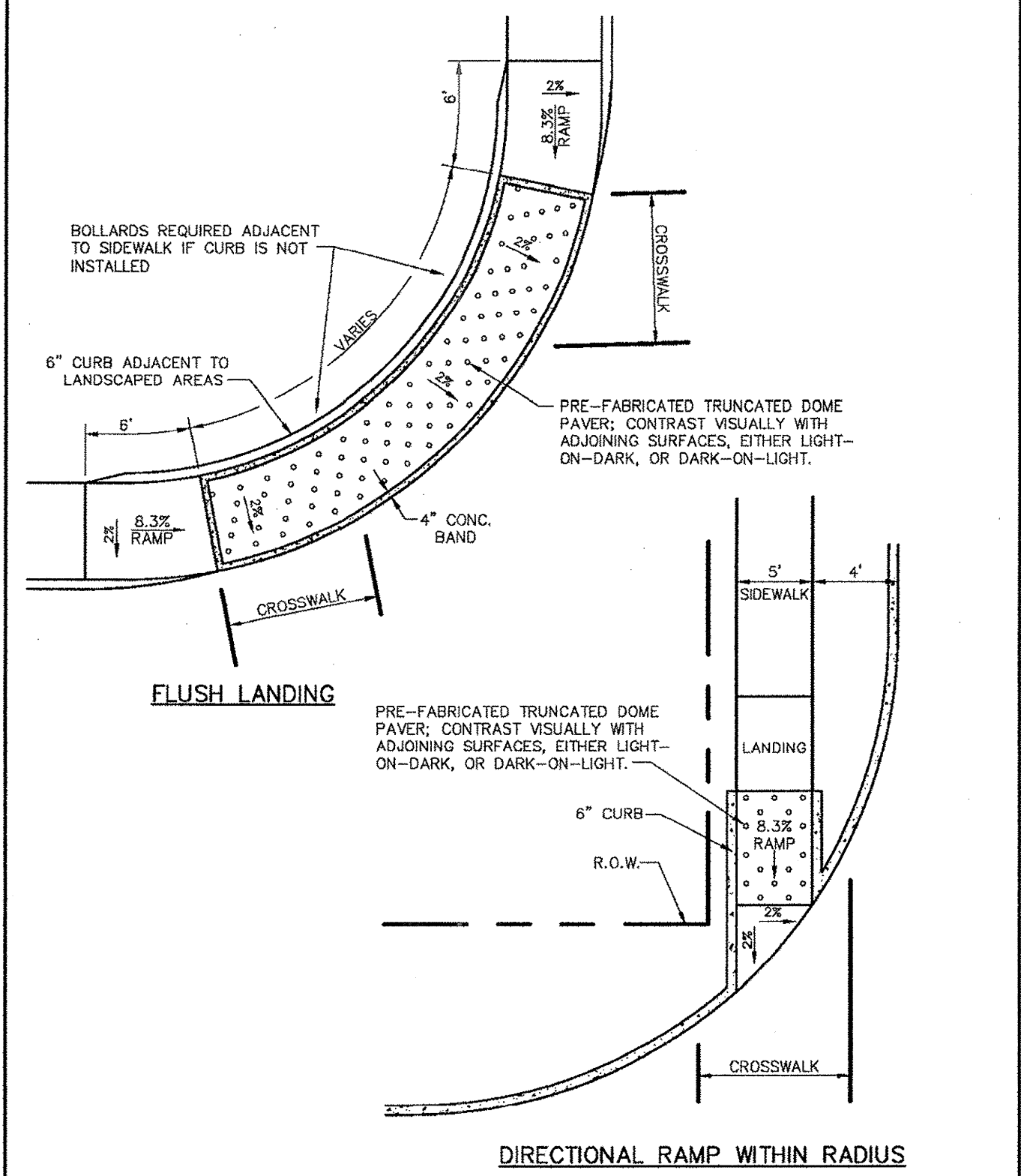

DIRECTIONAL RAMP WITHIN RADIUS

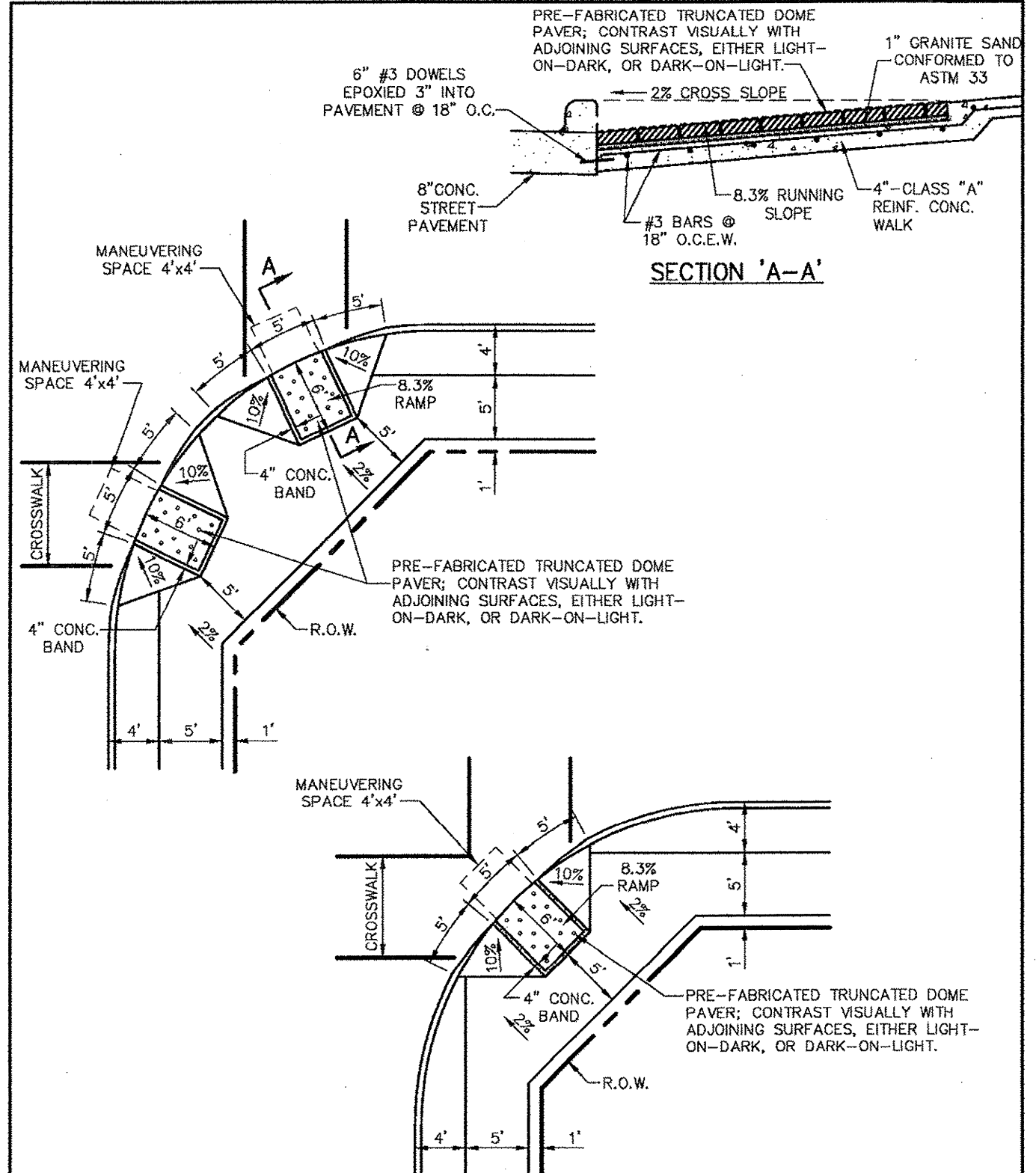

BARRIER FREE RAMP (RESIDENTIAL)

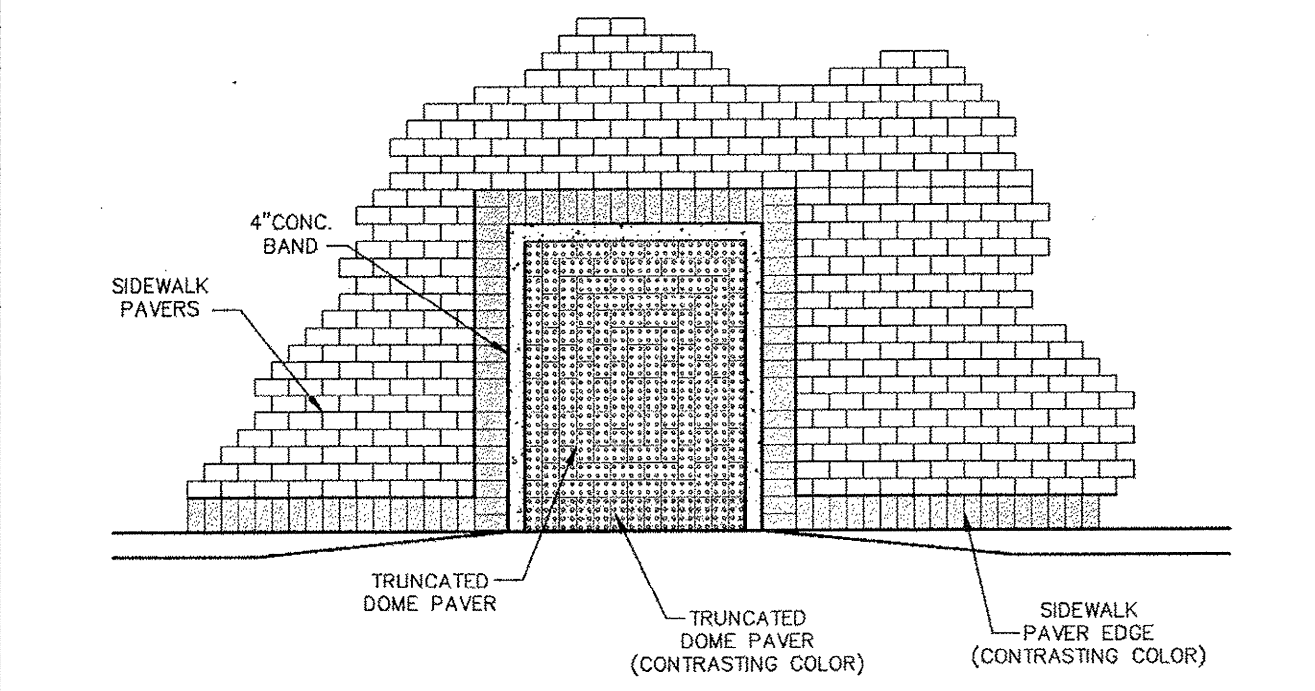

TYPICAL PATTERN FOR PAVER SIDEWALK AND CURB RAMP

NOTE: ALL PAVER COLORS TO BE APPROVED BY TOWN OF ADDISON.

Addison! PUBLIC WORKS DEPARTMENT	PEDESTRIAN FACILITIES GENERAL NOTES	STANDARD CONSTRUCTION DETAILS PAVING	
		DATE: AUGUST, 2010	SHEET: SD-P37

Addison! PUBLIC WORKS DEPARTMENT	PEDESTRIAN RAMPS	STANDARD CONSTRUCTION DETAILS PAVING	
		DATE: AUGUST, 2010	SHEET: SD-P38

Addison! PUBLIC WORKS DEPARTMENT	BARRIER FREE RAMP (RESIDENTIAL)	STANDARD CONSTRUCTION DETAILS PAVING	
		DATE: AUGUST, 2010	SHEET: SD-P39

Addison! PUBLIC WORKS DEPARTMENT	TYPICAL PATTERN FOR PAVER SIDEWALK AND CURB RAMP	STANDARD CONSTRUCTION DETAILS PAVING	
		DATE: AUGUST, 2010	SHEET: SD-P40

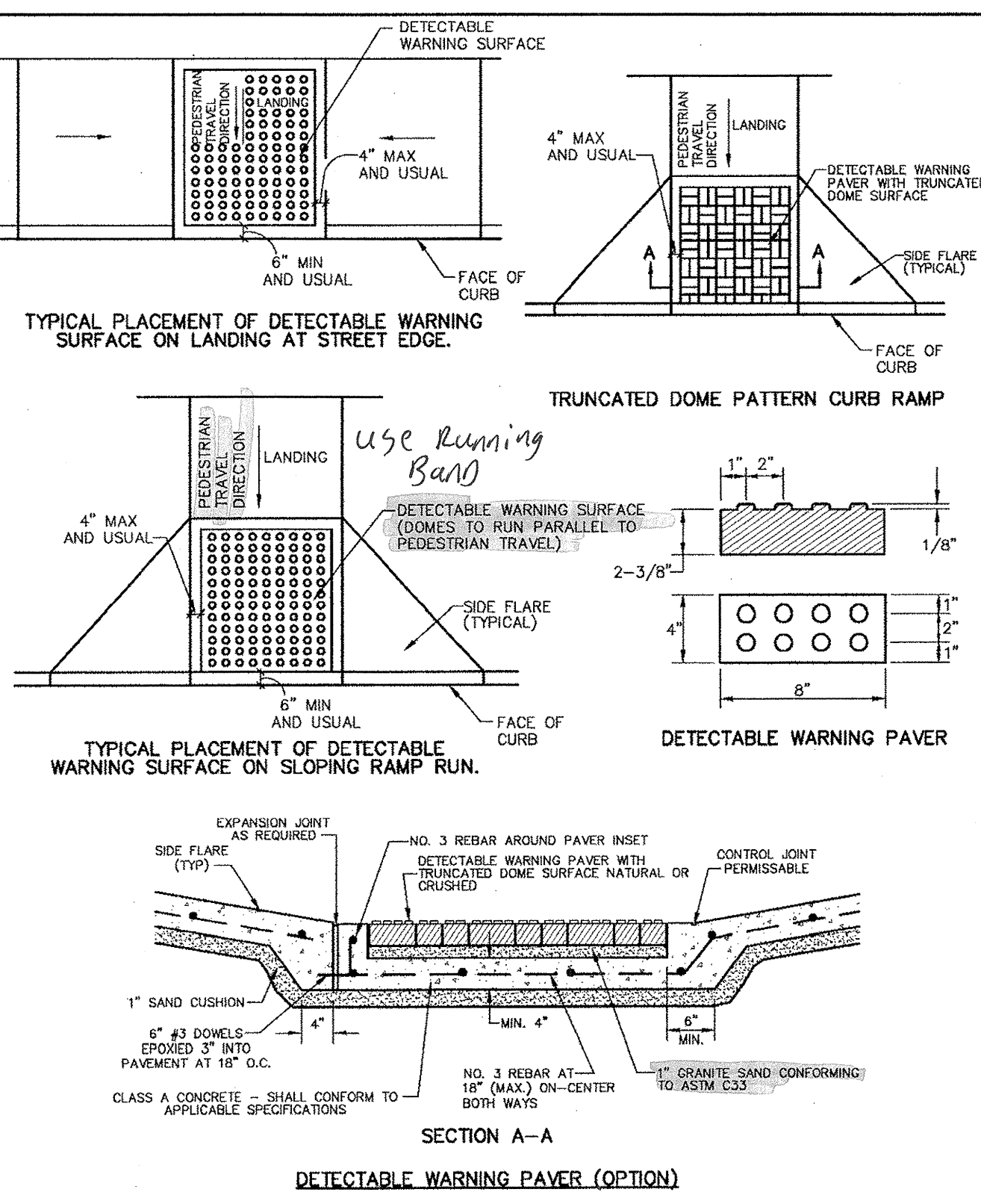

DETECTABLE WARNING PAVER (OPTION)

Addison! PUBLIC WORKS DEPARTMENT	DETECTABLE WARNING PAVER	STANDARD CONSTRUCTION DETAILS PAVING	
		DATE: AUGUST, 2010	SHEET: SD-P41

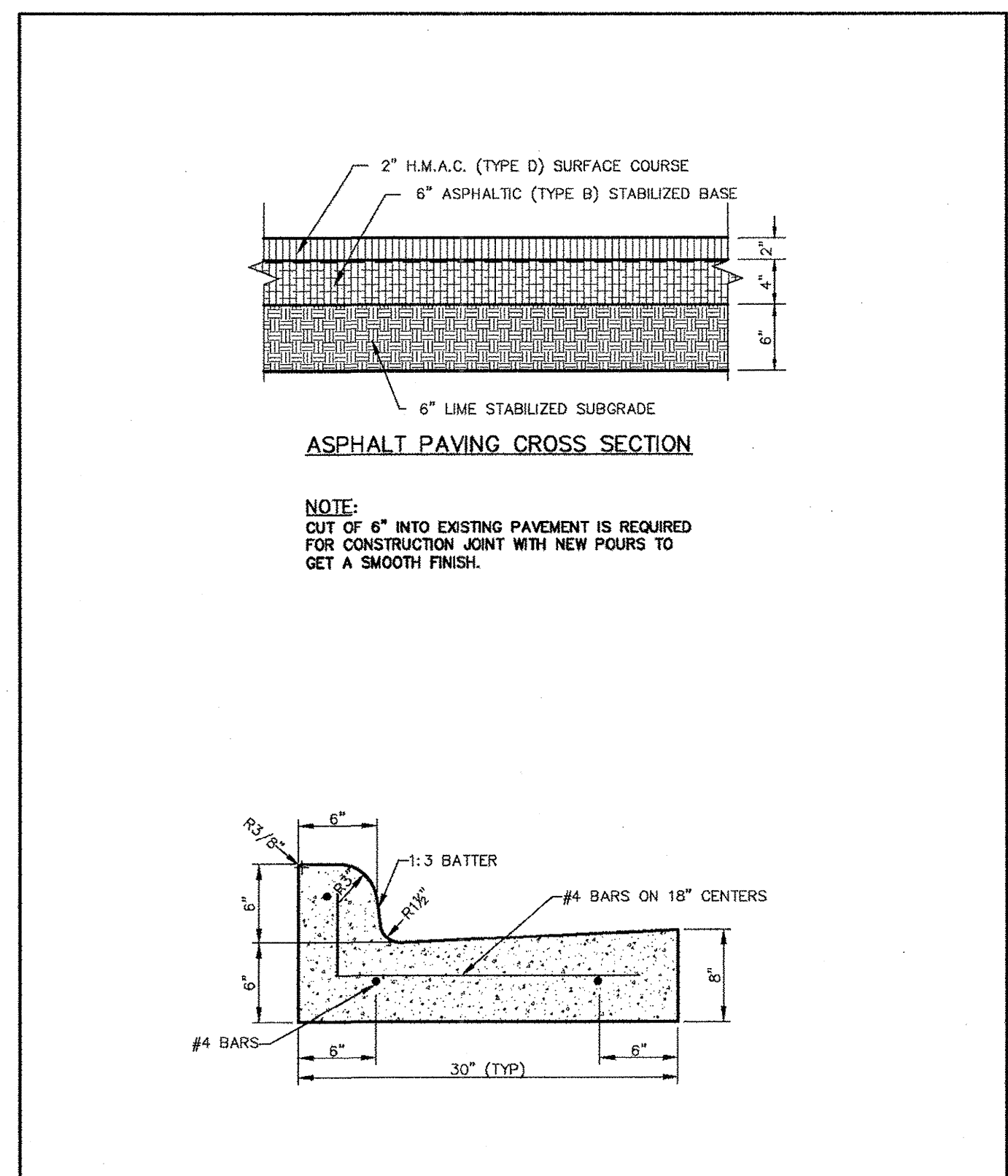

ASPHALT PAVING CROSS SECTION

NOTE: CUT OF 6" INTO EXISTING PAVEMENT IS REQUIRED FOR CONSTRUCTION JOINT WITH NEW POURS TO GET A SMOOTH FINISH.

CURB AND GUTTER & ASPHALT PAVING CROSS SECTION

Addison! PUBLIC WORKS DEPARTMENT	CURB AND GUTTER & ASPHALT PAVING CROSS SECTION	STANDARD CONSTRUCTION DETAILS PAVING	
		DATE: AUGUST, 2010	SHEET: SD-P08

Kimley-Horn
and Associates, Inc.
2020 Park Central Drive, Suite 800
Dallas, TX 75201-8888
Phone: 972-235-8888
Fax: 972-235-8888

Revised: 8/26/11
No. 1
T REVISOR: TOWN DETAILS

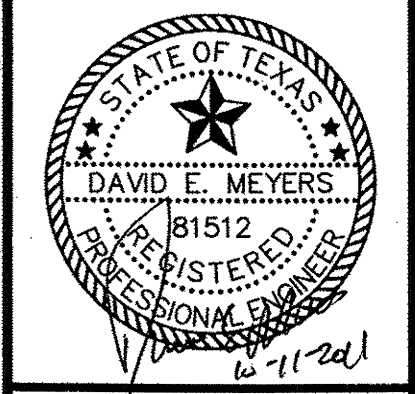

Keller Springs Lofts
Loft Apartments in Addison
Town of Addison, Texas

PAVING DETAILS

DATE: OCTOBER 11, 2011
DESIGN: KHA
DRAWN: KHA
CHECKED: KHA
KHA NO.: 064362003
CITY NO.: