

KELLER SPRINGS CLUBHOUSE  
ADDISON, TX

REVISED FOR CONSTRUCTION  
MAY 16, 2012

TRIMS, MISC. DETAILS, & LOBBY LIGHT PANEL

△ ADDED FABRICATION DETAILS 5-16-12  
© 2012 M. FORD & ASSOCIATES, INC.  
THIS DOCUMENT IS PUBLISHED AS AN INSTRUMENT OF SERVICE AND IS GIVEN IN CONFIDENCE. IT REMAINS THE PROPERTY OF M. FORD & ASSOCIATES, INC. THIS DOCUMENT AND THE INFORMATION CONTAINED WITHIN MAY NOT BE DUPLICATED OR DISCLOSED WITHOUT WRITTEN CONSENT OF M. FORD & ASSOCIATES, INC. HOUSTON, TEXAS

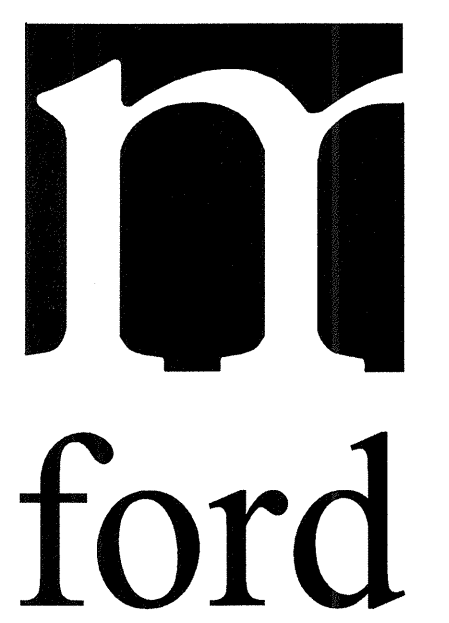

m. ford & associates  
interior design  
99 deterring street  
suite 165  
houston, tx 77007  
phone 713-630-0800  
fax 713-630-0814  
mford@mfordassociates.com  
www.mfordassociates.com



SHEET NO.

ID.4.0

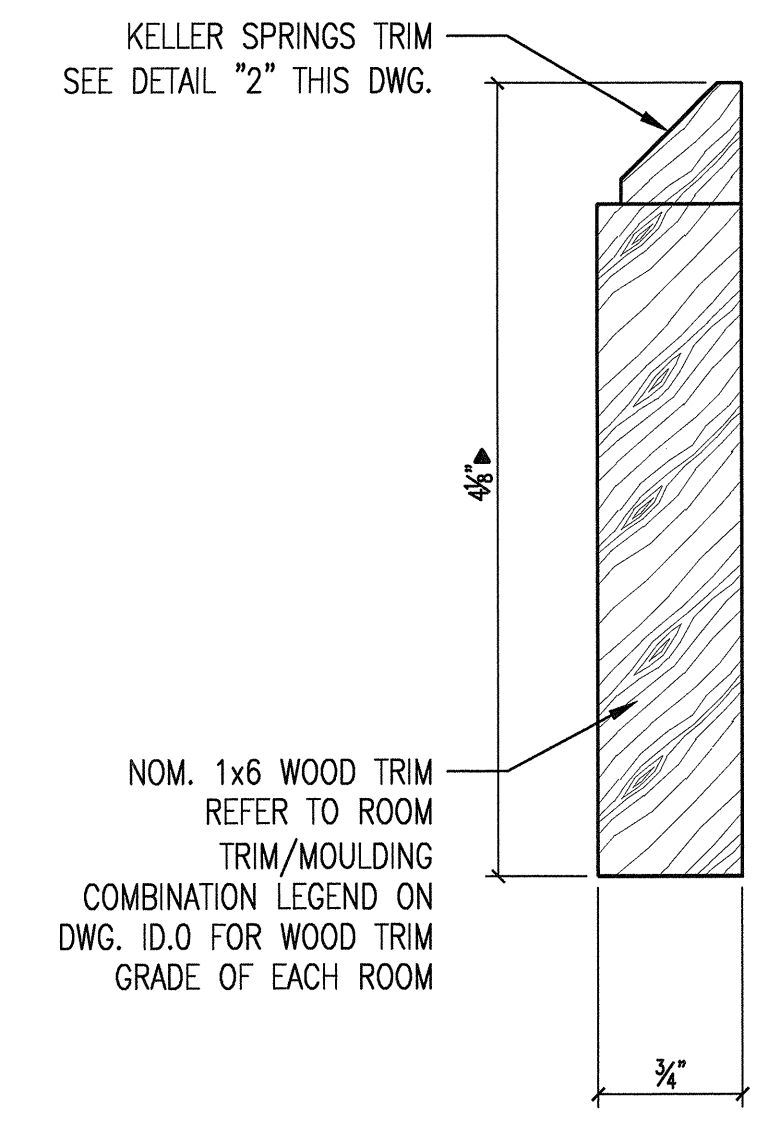

1 KELLER SPRINGS BASE MOULD ASS'Y.  
FULL SIZE

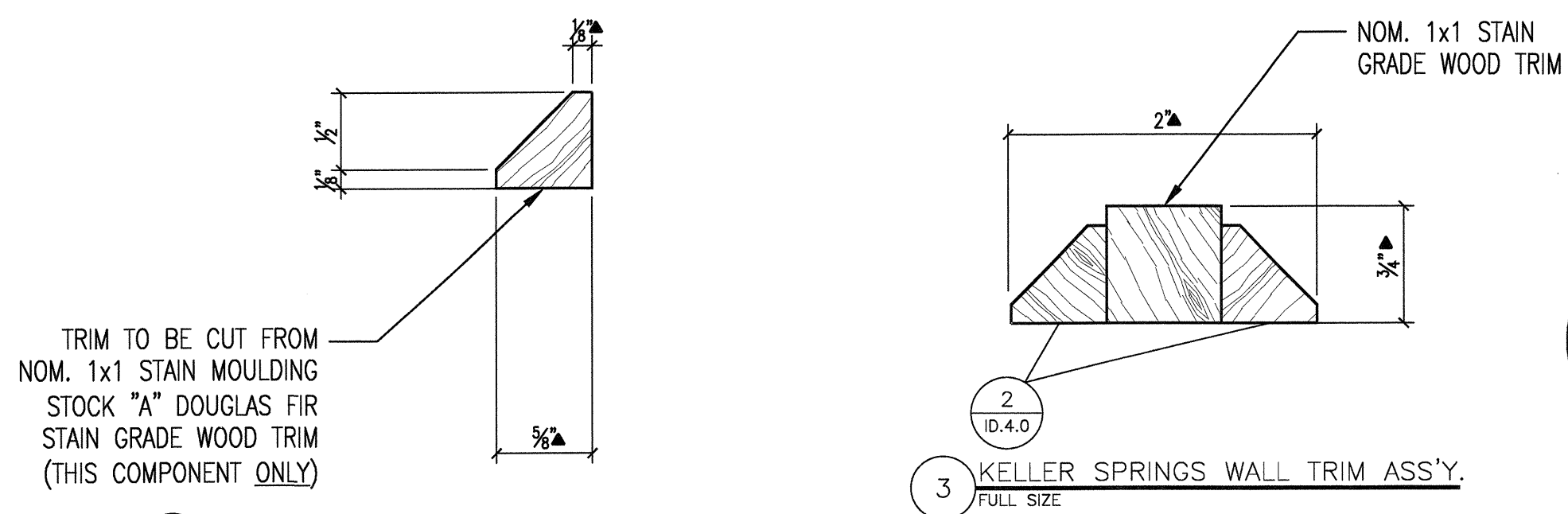

2 KELLER SPRINGS TRIM  
FULL SIZE



3 KELLER SPRINGS WALL TRIM ASS'Y.  
FULL SIZE

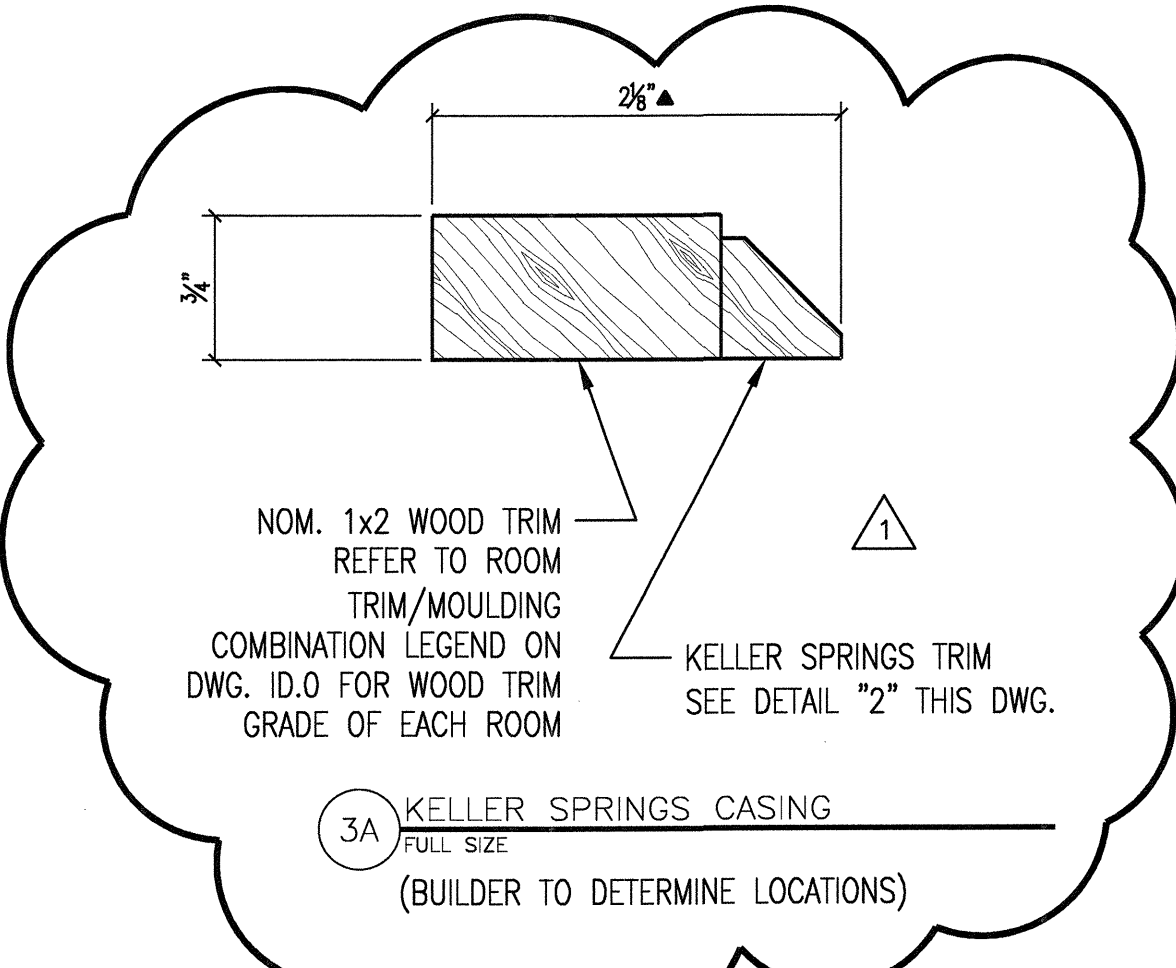

3A KELLER SPRINGS CASING  
FULL SIZE  
(BUILDER TO DETERMINE LOCATIONS)

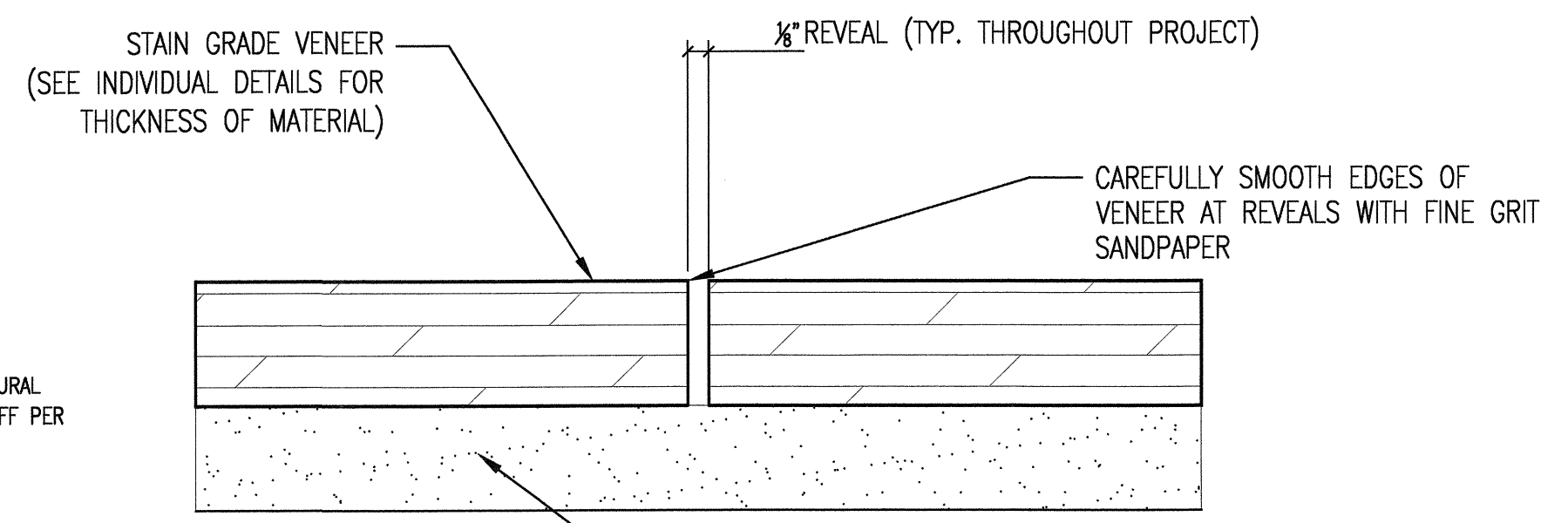

4 TYPICAL VENEER REVEAL  
FULL SIZE

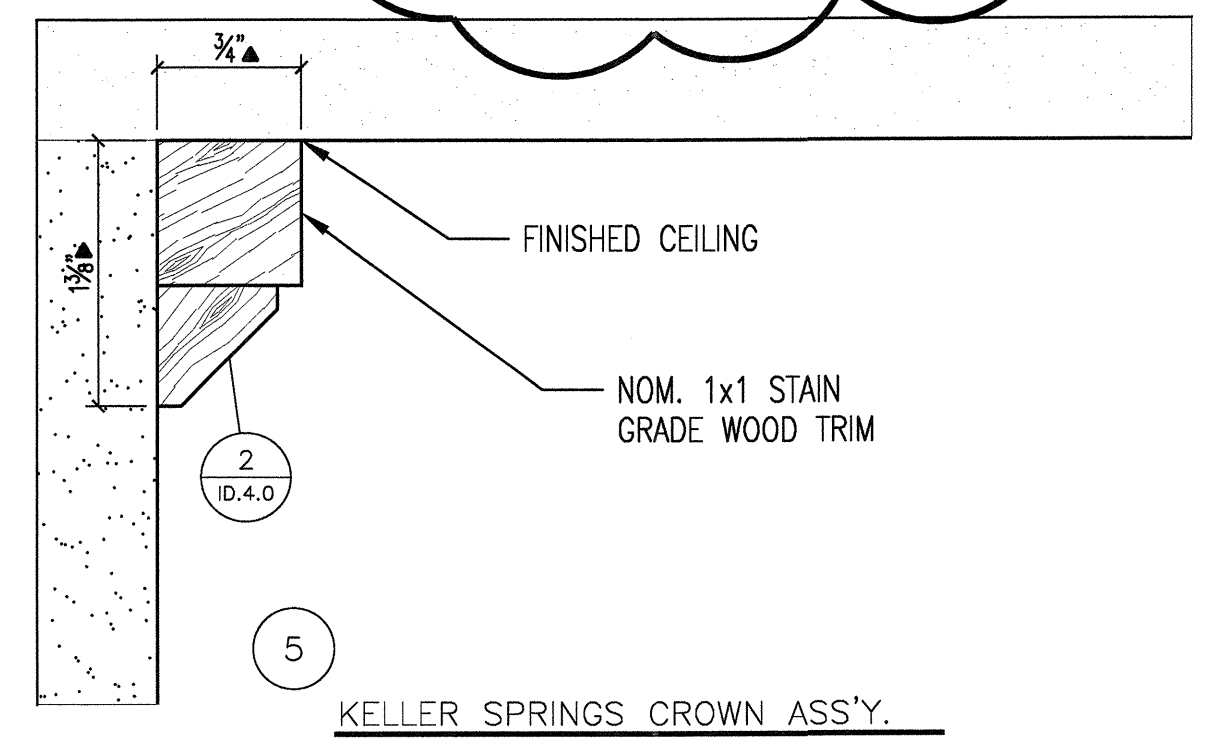

5 KELLER SPRINGS CROWN ASS'Y.  
FULL SIZE  
(UPTURNED & USED AS BASE @ VENEER COLS.)

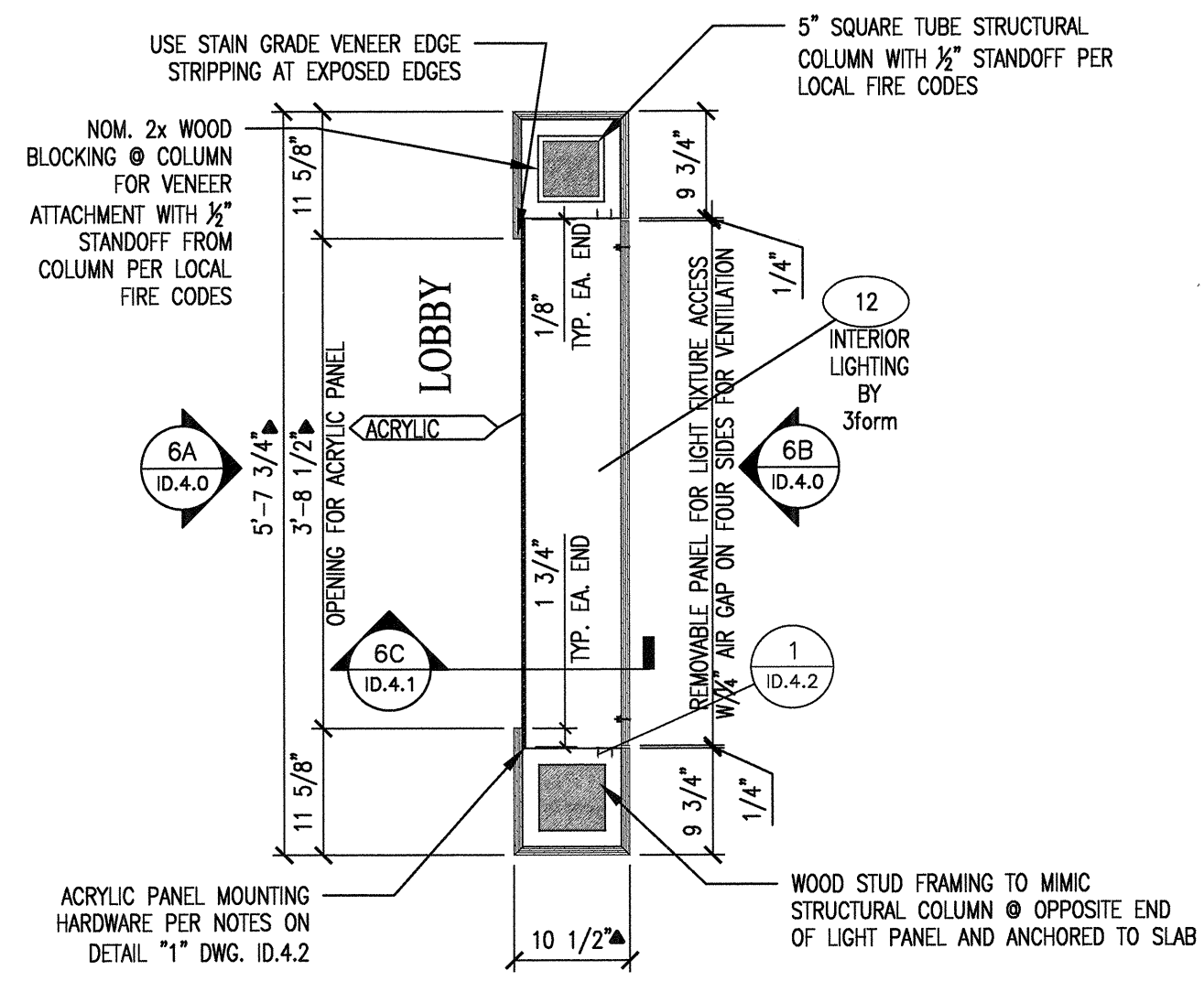

6 ENLARGED PLAN @ LOBBY LIGHT PANEL  
3/4" = 1'-0"

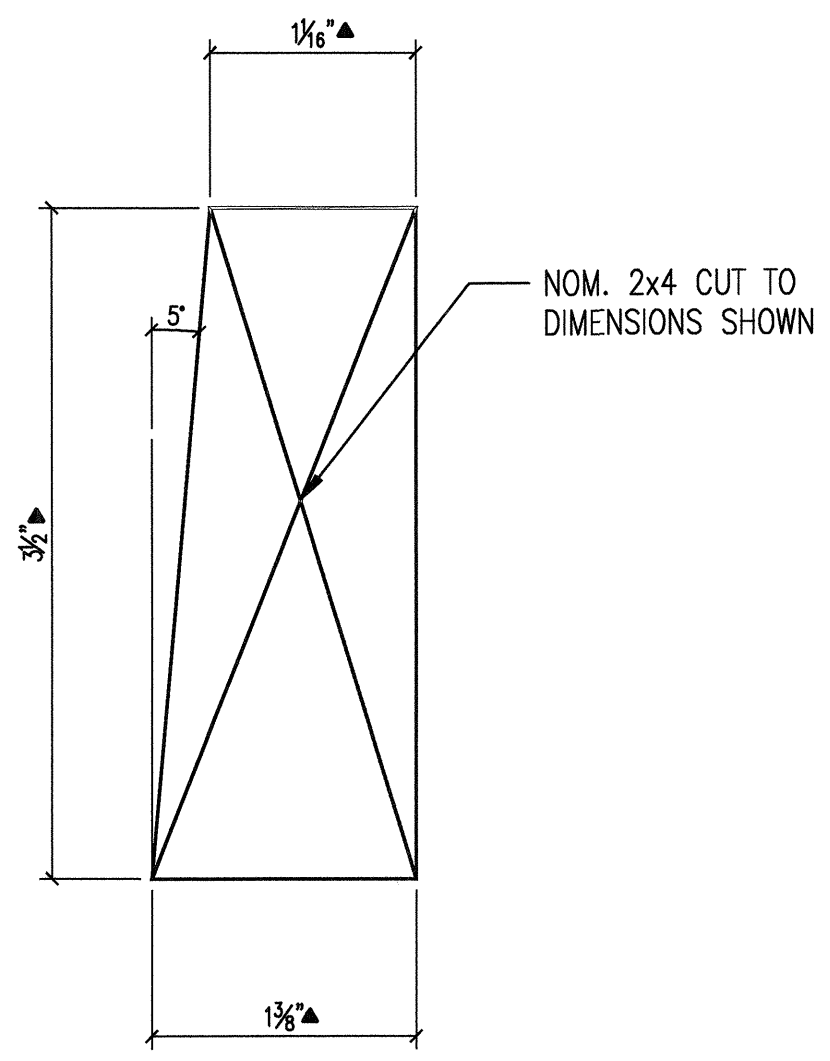

7 TYP. COLUMN BLOCKING  
FULL SIZE  
(USED @ ALL COLS. SEE DETAILS "9" & "10" ON DWG. ID.4.1)

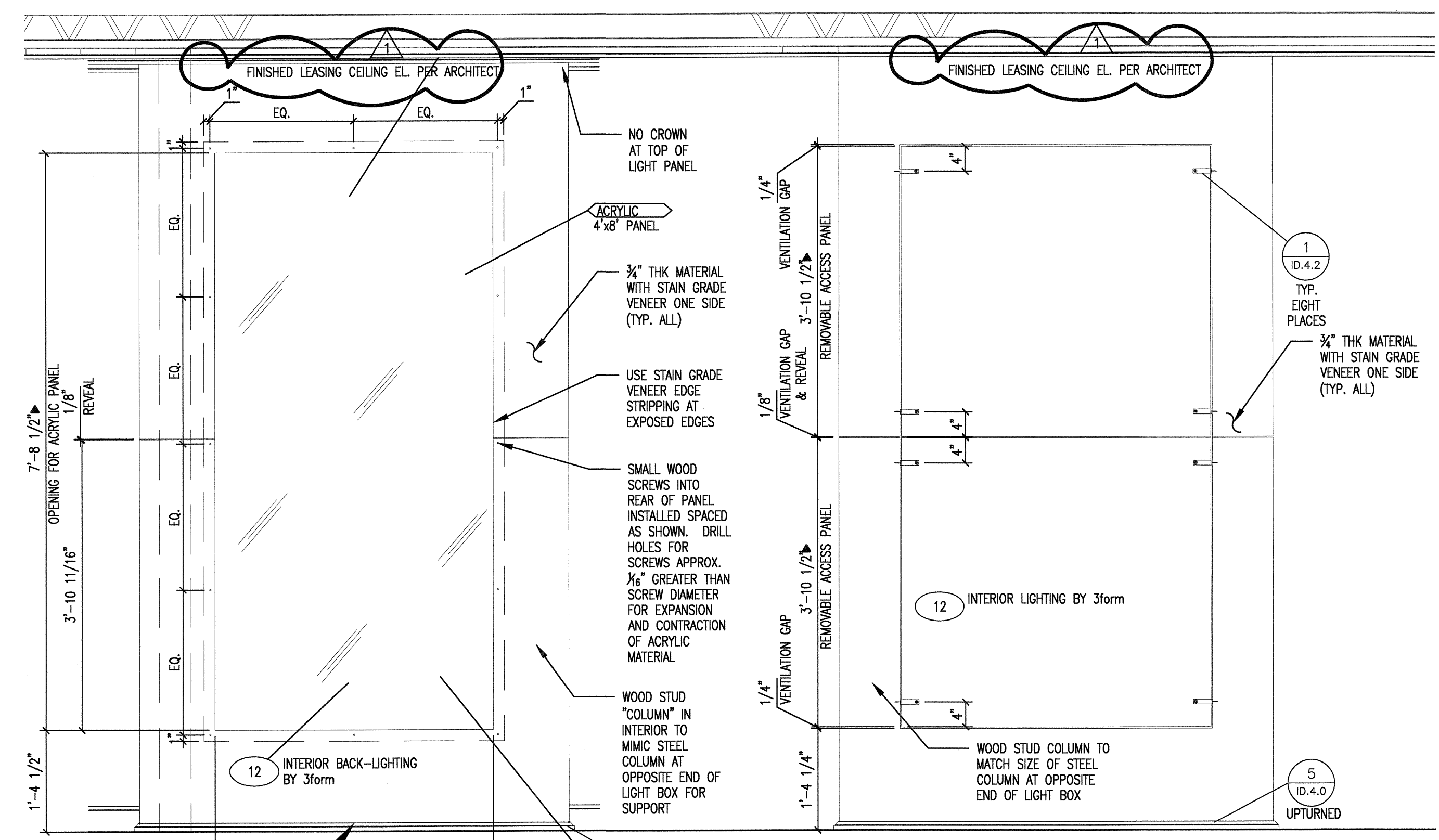

6A ELEVATION @ LOBBY LIGHT PANEL  
3/4" = 1'-0"

6B ELEVATION @ LOBBY LIGHT PANEL ACCESS  
3/4" = 1'-0"

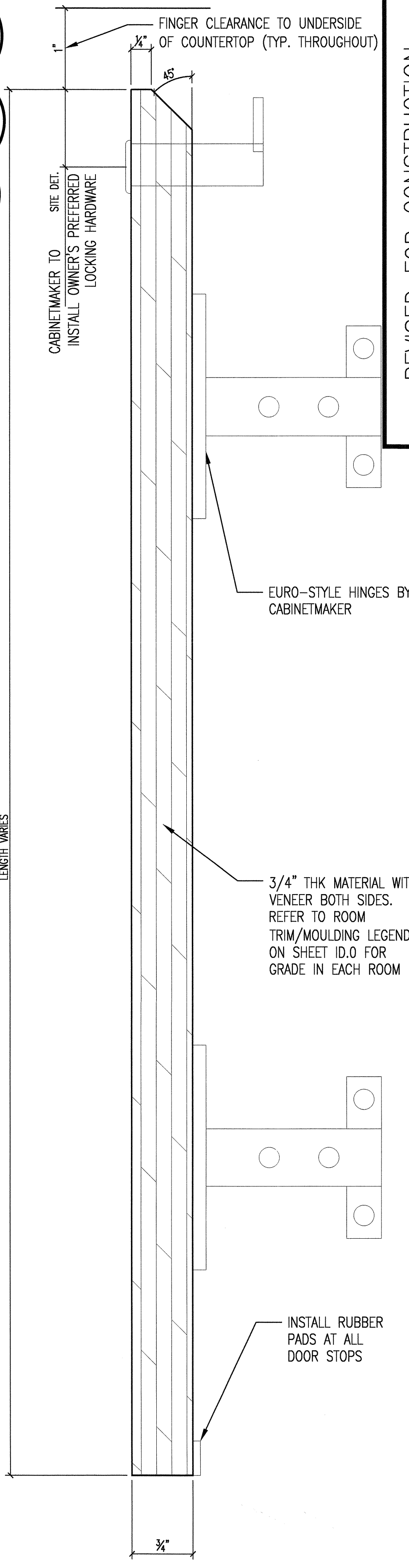

8 TYP. CABINET DOOR PROFILE  
FULL SIZE

LENGTH VARIES

3/4" THK MATERIAL WITH VENEER BOTH SIDES. REFER TO ROOM TRIM/MOULDING LEGEND ON SHEET ID.0 FOR GRADE IN EACH ROOM

INSTALL RUBBER PADS AT ALL DOOR STOPS