

3 UNIT A1-HC - PARTIAL 1
SCALE: 1/4" = 1'-0" OCCURS AT: (1) TOTAL UNITS ON SITE

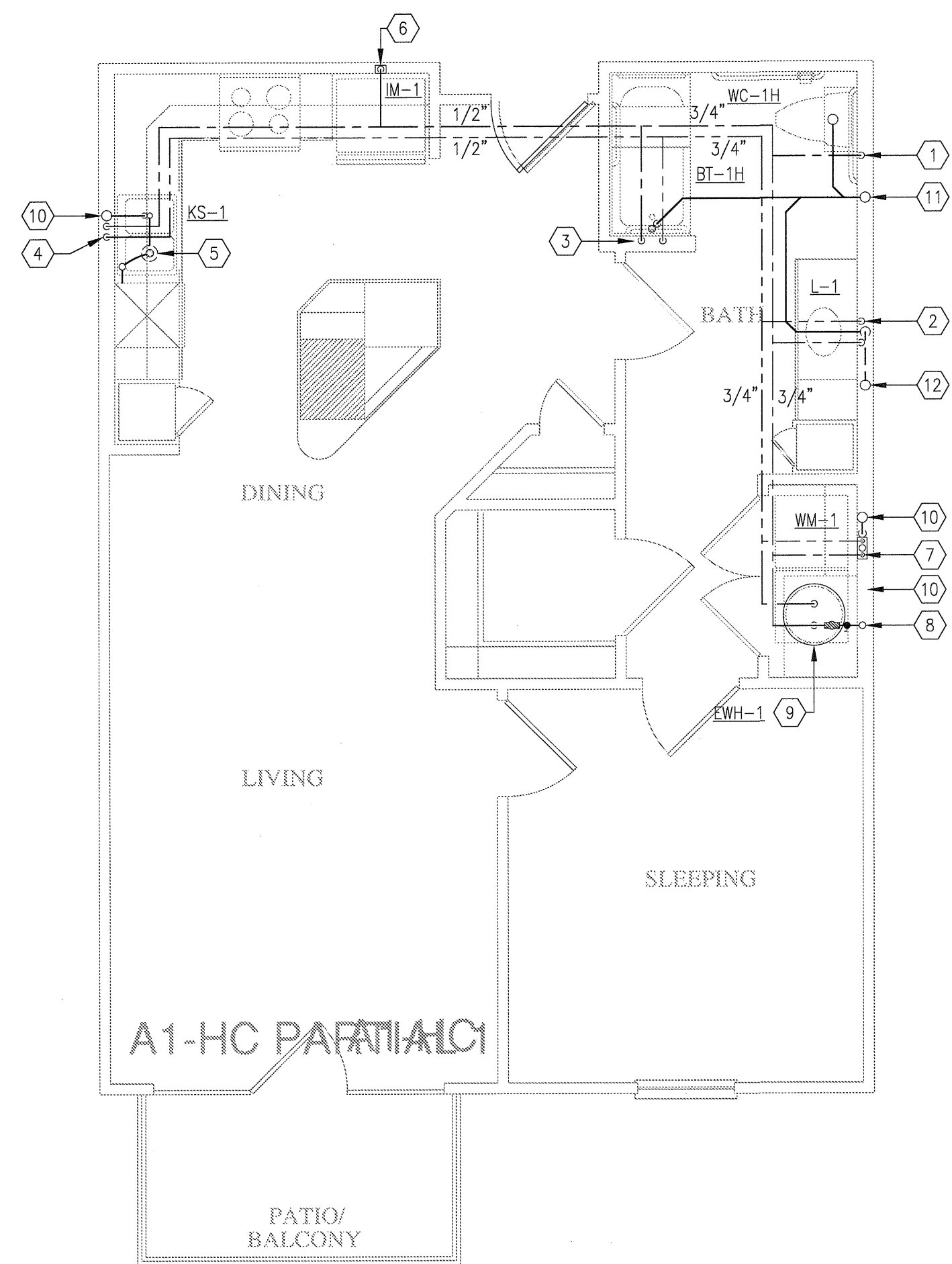

2 UNIT A1-HC - ONE SLEEPING/ONE BATH
SCALE: 1/4" = 1'-0" OCCURS AT: (1) TOTAL UNITS ON SITE

KEY NOTES:

- 1 1/2" CW DOWN IN WALL TO WATER CLOSET.
- 2 1/2" H & CW DOWN IN WALL TO LAVATORY.
- 3 1/2" H & CW DOWN IN WALL TO BATHTUB/SHOWER. 3/4" H & CW DOWN IN WALL IF SERVING BATHTUB AND SHOWER.
- 4 1/2" H & CW TO SINK AND DISHWASHER. PROVIDE 1/2"x3/8" STOP ON CW. PROVIDE 1/2"x3/8"x3/8" STOP ON HW. 3/8" H & CW TO SINK FAUCET. 3/8" HW TO DISHWASHER.
- 5 DISPOSAL BELOW SINK WITH DISHWASHER WASTE CONNECTION. CONNECT DRAIN THRU AIR GAP TO DISPOSAL. DISPOSAL BY G.C. AND INSTALLED BY PLUMBING CONTRACTOR.
- 6 1/2" CW DOWN IN WALL TO ICE MAKER VALVE AND BOX.
- 7 WASHING MACHINE CONNECTION BOX 2" WASTE, 1/2" H & CW.
- 8 DOMESTIC WATER RISER. PROVIDE ISOLATION VALVE, REMOTE READ SUB-METER, AND PRV IF REQUIRED. REFER TO RISER DIAGRAM FOR SIZES.
- 9 ELECTRIC WATER HEATER. REFER TO DETAILS AND SCHEDULE.
- 10 3" SANITARY WASTE/VENT RISER PER IPC SEC 910.
- 11 3" SANITARY WASTE RISER.
- 12 3" SANITARY VENT RISER.

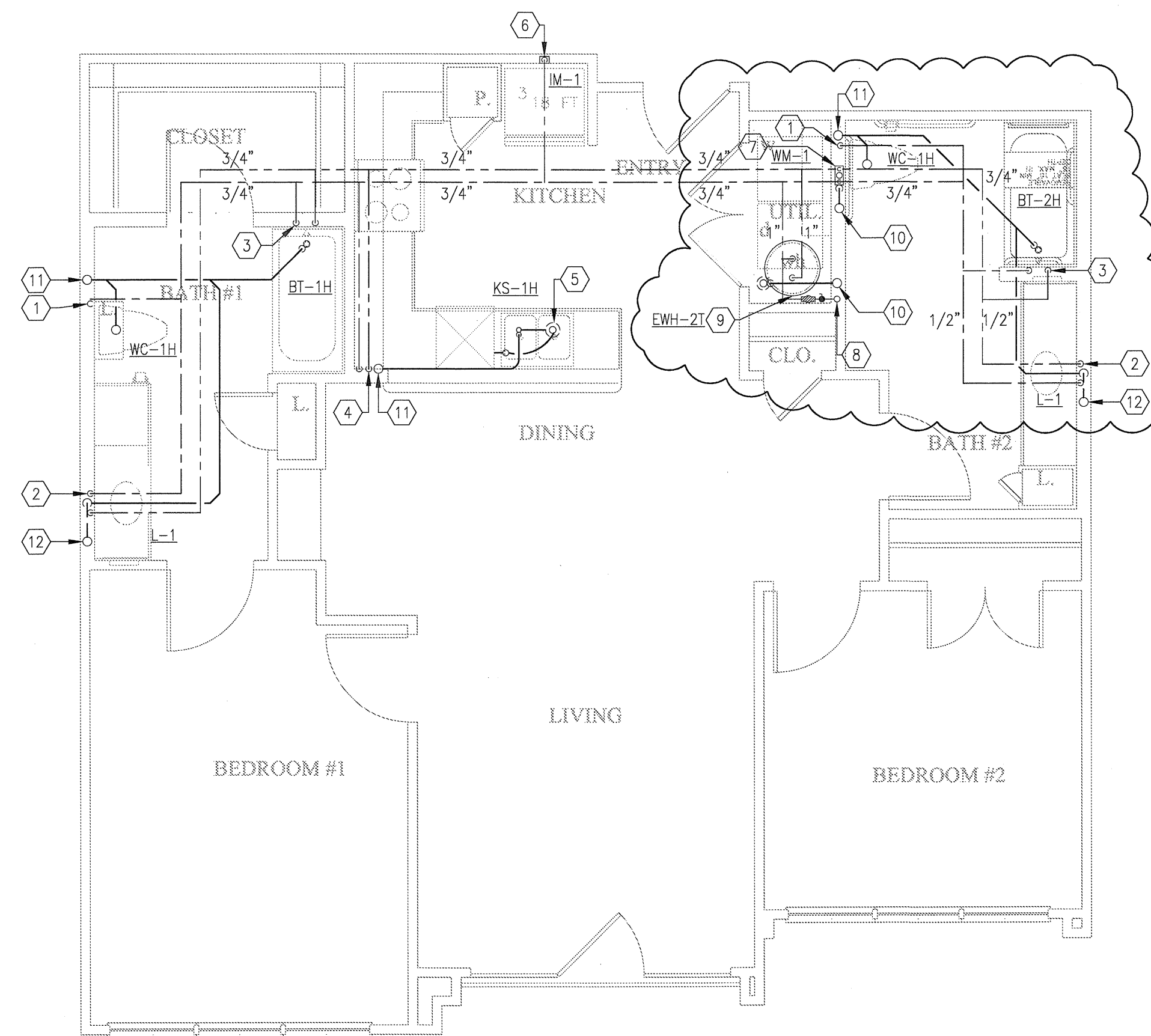

1 UNIT B1-HC-ALT D - TWO BEDROOM/TWO BATH
SCALE: 1/4" = 1'-0" OCCURS AT: (3) TOTAL UNITS ON SITE

REVISIONS

1	9-2-2011	DESIGN REVISIONS
2	9-13-2011	ANSI/FHA COMMENTS DESIGN REVISIONS
3	9-23-2011	DESIGN REVISIONS
4	10-17-2011	CONSTRUCTION ISSUE DESIGN REVISIONS
5	12-21-2011	DESIGN REVISIONS
6	1-17-2012	DESIGN REVISIONS
7	2-15-2012	TRANSFORMER REVISIONS
8	3-27-2012	CLUBHOUSE REVISIONS
9	4-17-2012	COORDINATION

KELLER SPRINGS LOFTS

LOFT APARTMENTS IN ADDISON, TEXAS

10	5-15-2012	COORDINATION
11	5-30-2012	SITE COORDINATION
12	6-01-12	LIGHTING REVISIONS
13	6-29-12	SITE COORDINATION

BGO
architects

4144 N. Central Expy.
Suite 855
Dallas, TX 75204
214.520.8878
bgoarchitects.com

DATE
08-05-11

PROJECT
11129

SHEET NUMBER

P-2.11