

| REVISIONS |            |                    |
|-----------|------------|--------------------|
| 1         | 9-2-2011   | DESIGN REVISIONS   |
| 2         | 9-13-2011  | ANSI/FHA COMMENTS  |
| 3         | 9-23-2011  | DESIGN REVISIONS   |
| 4         | 10-17-2011 | CONSTRUCTION ISSUE |

**KELLER SPRINGS LOFTS**

LOFT APARTMENTS IN ADDISON, TEXAS

**BGO**  
architects  
4144 N. Central Expy.  
Suite 855  
Dallas, TX 75204  
214.520.8878  
bgoarchitects.com

DATE  
08-05-11

PROJECT  
11129

SHEET NUMBER

**P-2.7**

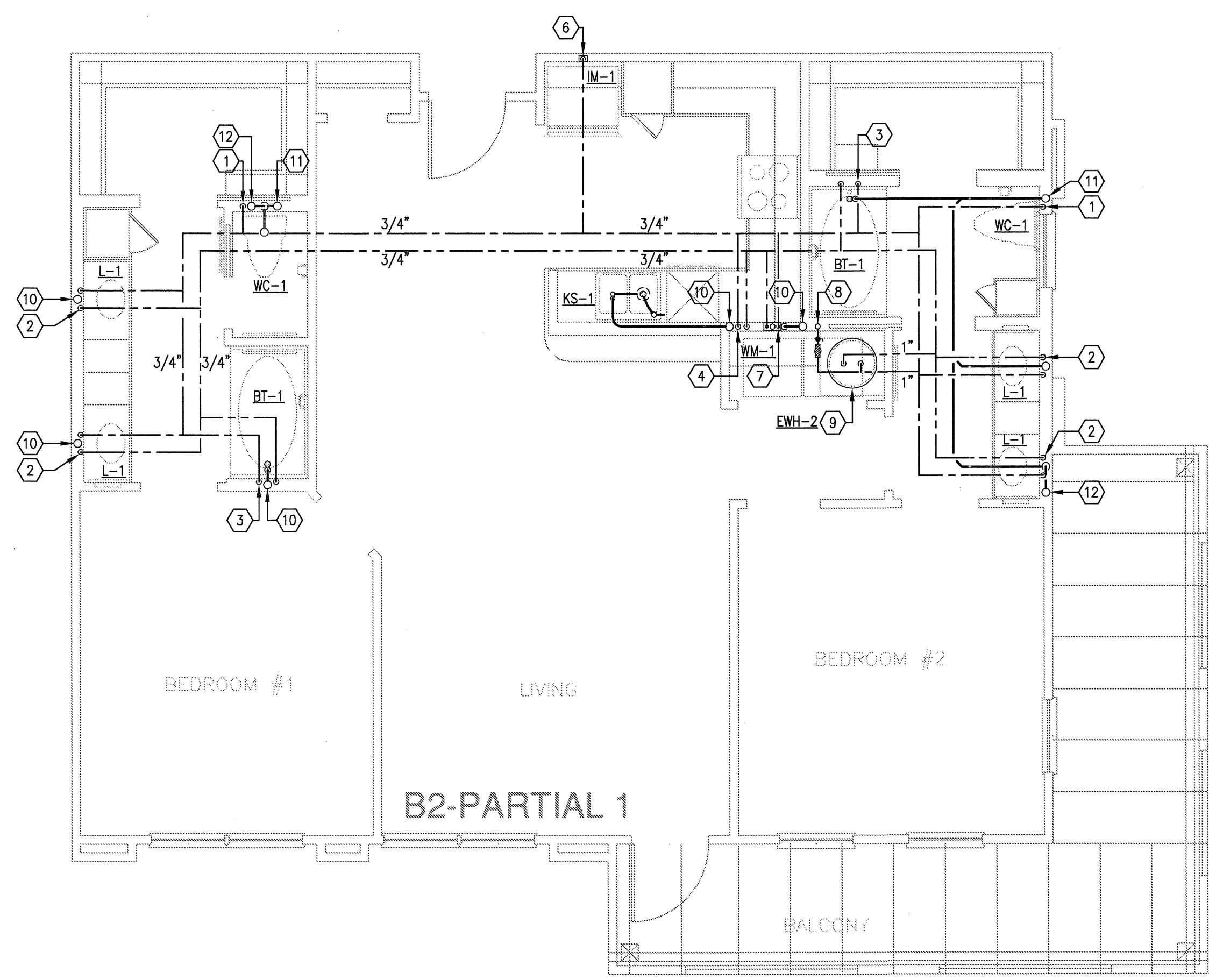

**7** UNIT B2 - PARTIAL 1  
SCALE: 1/4" = 1'-0" OCCURS AT: (3) TOTAL UNITS ON SITE

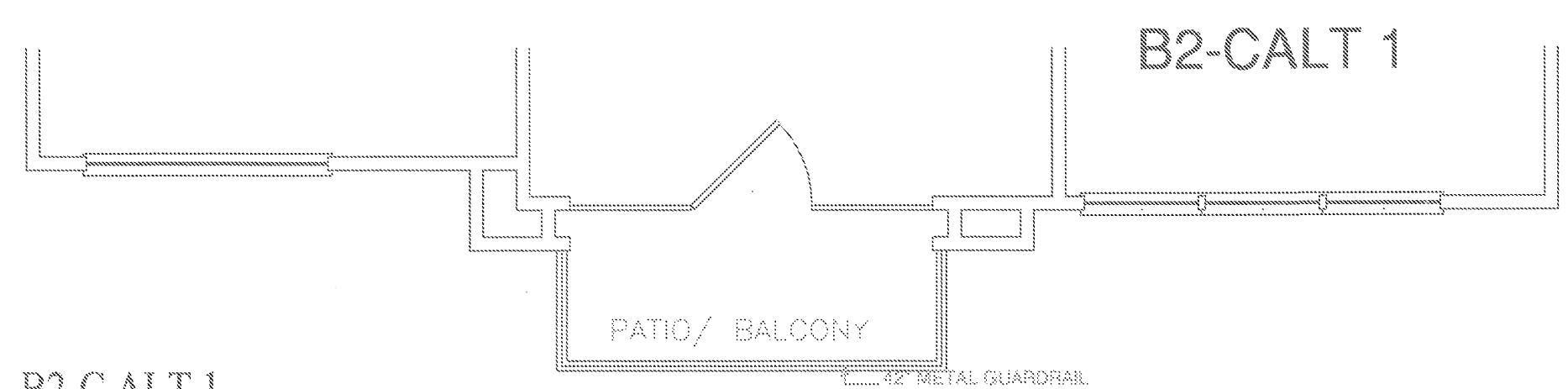

**6** UNIT B2-C - ALT 1  
SCALE: 1/4" = 1'-0" OCCURS AT: (12) TOTAL UNITS ON SITE

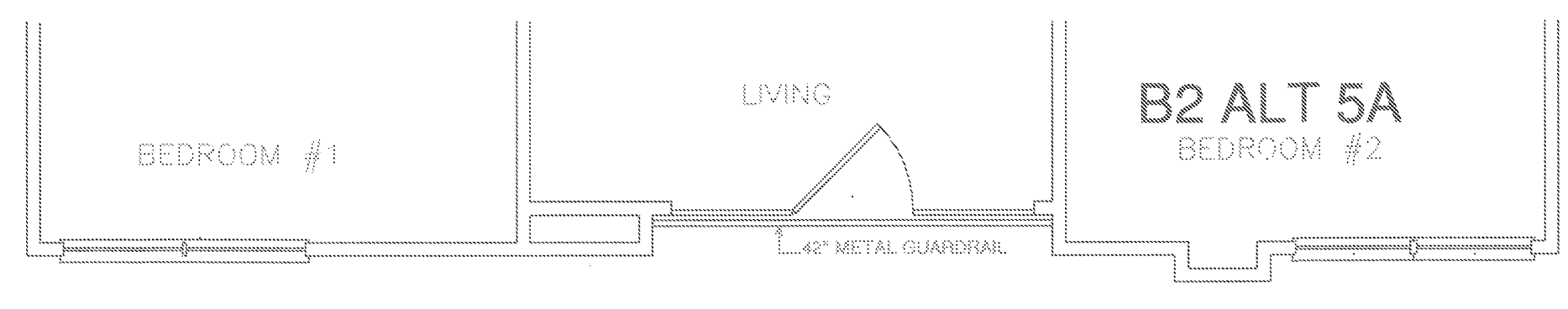

**5** UNIT B2 - ALT 5A  
SCALE: 1/4" = 1'-0" OCCURS AT: (1) TOTAL UNITS ON SITE



**4** UNIT B2 - ALT 4A  
SCALE: 1/4" = 1'-0" OCCURS AT: (1) TOTAL UNITS ON SITE

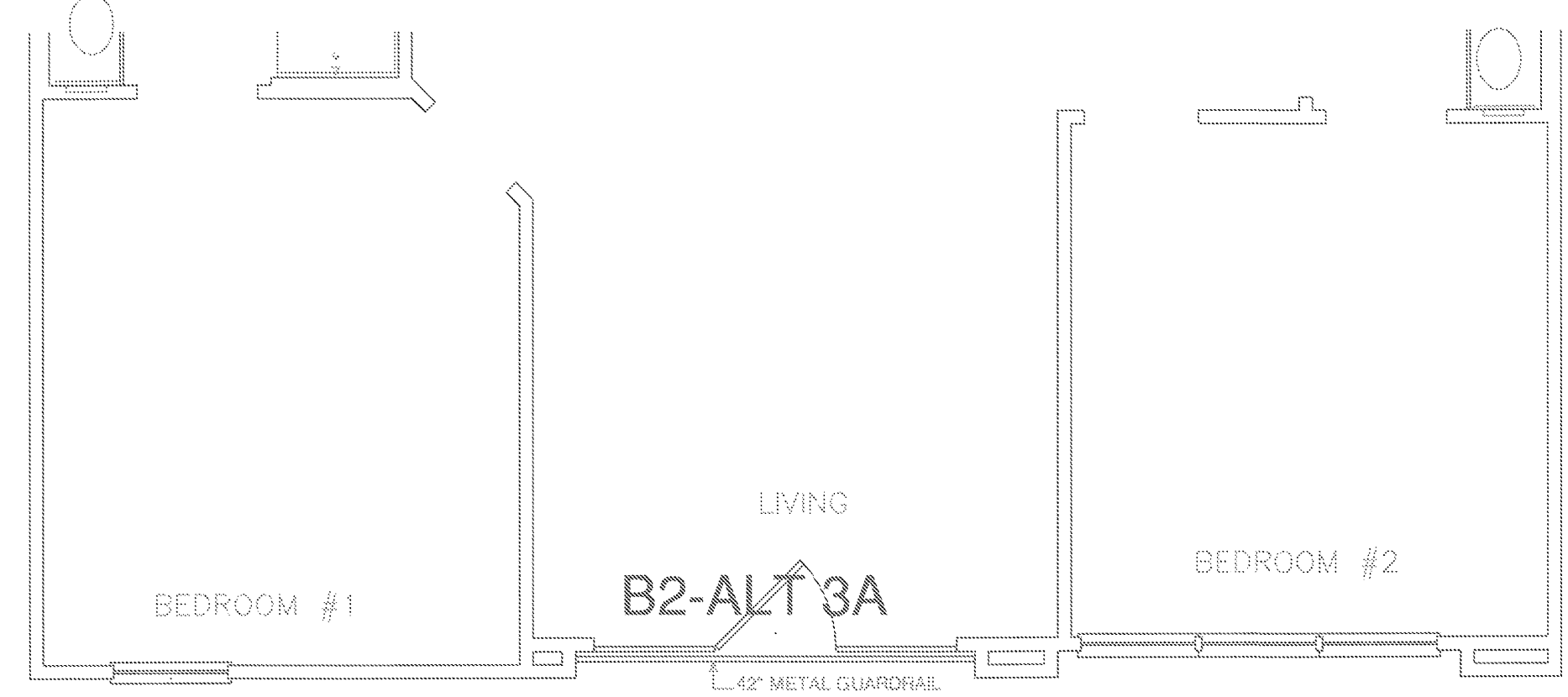

**3** UNIT B2 - ALT 3A  
SCALE: 1/4" = 1'-0" OCCURS AT: (1) TOTAL UNITS ON SITE

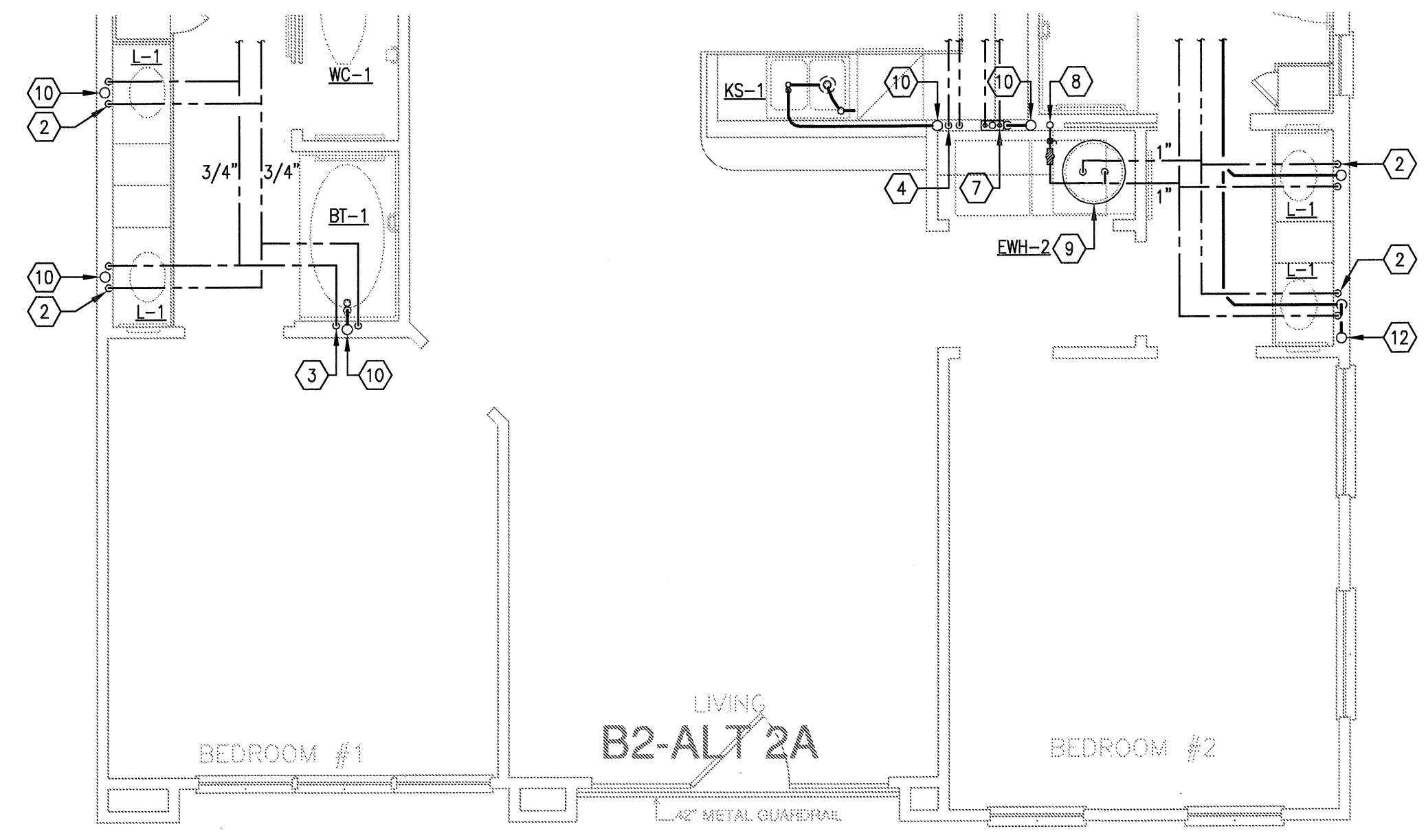

**2** UNIT B2 - ALT 2A  
SCALE: 1/4" = 1'-0" OCCURS AT: (1) TOTAL UNITS ON SITE

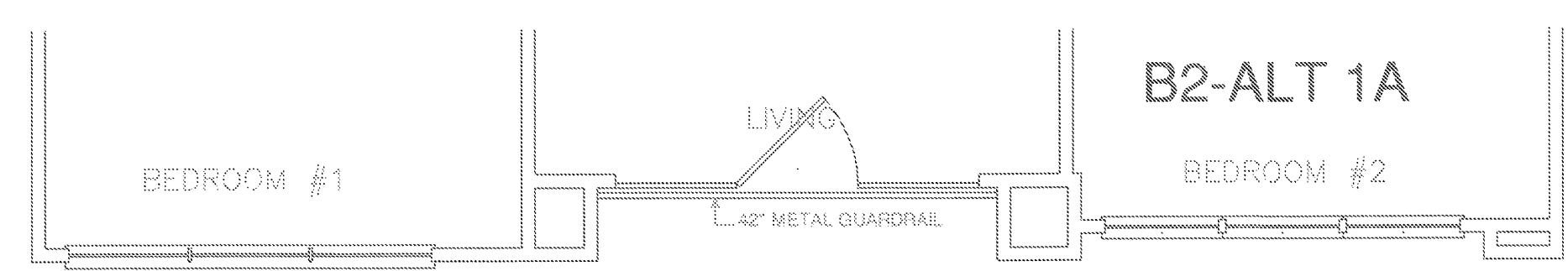

**1** UNIT B2 - ALT 1A  
SCALE: 1/4" = 1'-0" OCCURS AT: (2) TOTAL UNITS ON SITE

- KEY NOTES:**
- 1 1/2" CW DOWN IN WALL TO WATER CLOSET.
  - 2 1/2" H & CW DOWN IN WALL TO LAVATORY.
  - 3 1/2" H & CW DOWN IN WALL TO BATHTUB/SHOWER. 3/4" H & CW DOWN IN WALL IF SERVING BATHTUB AND SHOWER.
  - 4 1/2" H & CW TO SINK AND DISHWASHER. PROVIDE 1/2"x3/8" STOP ON CW. PROVIDE 1/2"x3/8"x3/8" STOP ON HW. 3/8" H & CW TO SINK FAUCET, 3/8" HW TO DISHWASHER.
  - 5 DISPOSAL BELOW SINK WITH DISHWASHER WASTE CONNECTION. CONNECT DRAIN THRU AIR GAP TO DISPOSAL. DISPOSAL BY G.C. AND INSTALLED BY PLUMBING CONTRACTOR.
  - 6 1/2" CW DOWN IN WALL TO ICE MAKER VALVE AND BOX.
  - 7 WASHING MACHINE CONNECTION BOX 2" WASTE, 1/2" H & CW.
  - 8 DOMESTIC WATER RISER. PROVIDE ISOLATION VALVE, REMOTE READ SUB-METER, AND PRV IF REQUIRED. REFER TO RISER DIAGRAM FOR SIZES.
  - 9 ELECTRIC WATER HEATER. REFER TO DETAILS AND SCHEDULE.
  - 10 3" SANITARY WASTE/VENT RISER PER IPC SEC 910.
  - 11 3" SANITARY WASTE RISER.
  - 12 3" SANITARY VENT RISER.