

EMBREY BUILDERS, LLC.
 1020 N. E. Loop 410, Suite 700
 San Antonio, TX 78209
 Ph: (210) 824-6044 Fax: (210) 824-7656

RFI

To: Trent Perkins
 Parkin Perkins Olsen
 9330 LBJ Freeway, Suite 1055
 Dallas, TX 75243
 Ph: (214)221-2220 Fax: (214)221-2252

RFI #: 75
 Date: 3/13/2012
 Job: EB-02 Keller Springs Lofts
 Phone: 877-777-5115

CC: David Gallagher (Embrey Build (Embrey Construction LLC))

Subject: Forming grade beams per SK#1

Drawing: SK #1 Spec Section:
 Cost Impact: None Schedule Impact: None

Request: Date Required: 3/20/2012
 As per phone conversation and attached e-mail and SK #1. Please confirm we are to form the grade beams as per SK #1.

Requested by: Bryan Pickler
 Embrey Partners, Ltd.

Response:

No exceptions taken.
 Trent Perkins, PE
 Principal
 March 13, 2012

Answered by _____
 Company _____ Date _____

Page 1 of 1

EMBREY BUILDERS, LLC.
 1020 N. E. Loop 410, Suite 700
 San Antonio, TX 78209
 Ph: (210) 824-6044 Fax: (210) 824-7656

RFI

To: Trent Perkins
 Parkin Perkins Olsen
 9330 LBJ Freeway, Suite 1055
 Dallas, TX 75243
 Ph: (214)221-2220 Fax: (214)221-2252

RFI #: 82
 Date: 3/21/2012
 Job: EB-02 Keller Springs Lofts
 Phone: 877-777-5115

CC:

Subject: Dowels at Pier Caps

Drawing: S3.01 & S3.02 Spec Section:
 Cost Impact: None Schedule Impact: None

Request: Date Required: 3/22/2012
 In our meeting on 3/16/12 at your office we discussed the already poured piers on slab pour #1 as having 4-#6's of dowels as shown on 1/SG3.01 vs the proper detail as shown on 3/SG3.02, which requires 6 #7 dowels. You were going to check to see if we can reduce the required number of #7 dowels to go along with the in place #6 dowels.

Requested by: David Miller
 Embrey Builders LLC

Response:

Please provide 4 - 7 "L" dowels in addition to the 4-#6 dowels currently in place.
 R. Trent Perkins, PE
 Parkin-Perkins-Olsen Consulting Engineering, Inc.
 March 22, 2012

Answered by _____
 Company _____ Date _____

Page 1 of 1

Brian Peterson

From: Brande Parkey <bparkey@ppoinc.net>
 Sent: Friday, January 06, 2012 4:39 PM
 To: Brian Peterson
 Cc: 'Trent Perkins'; David Gallagher; 'Scott Wharton'; Bryan Pickler; thomasparadis@verizon.net
 Subject: RE: Keller Springs: pier depths

Brian -

Yes, it is acceptable to terminate the building piers once they have achieved the 5 feet of penetration into the bearing strata as determined by the geotechnical engineer per the structural drawings. If you have questions or require additional information regarding this matter, please do not hesitate to contact us.

Regards,

Brande L. Parkey, P.E.
 Associate

PARKIN-PERKINS-OLSEN
 CONSULTING ENGINEERING, INC.

1 214.221.2220 www.ppoinc.net

From: Brian Peterson [mailto:BPeterson@embreydc.com]
 Sent: Friday, January 06, 2012 1:54 PM
 To: Brande Parkey
 Cc: 'Trent Perkins'; David Gallagher; Scott Wharton (swarton@ecslimited.com); Bryan Pickler; thomasparadis@verizon.net
 Subject: RE: Keller Springs: pier depths

Brande,

Does the same principal hold for the building piers. I know we dug a test hole in the courtyard of the East bldg, and hit rock at about 8 1/2' from F.F. We did the same thing on the West Bldg, and hit rock around 12'. Just wanted to confirm that 5' into Grey Limestone was sufficient.

Thanks,

1

Brian Peterson
 Project Superintendent
 Embrey Builders, LLC
 bpeterson@embreydc.com
 M. 469-422-8724

From: Brande Parkey [mailto:bparkey@ppoinc.net]
 Sent: Wednesday, December 28, 2011 5:03 PM
 To: Brian Peterson
 Cc: 'Trent Perkins'
 Subject: Keller Springs: pier depths

Brian -

Per our discussion, the 17'-0" minimum depth requirement indicated in 1/SG3.01 does not need to be met provided that the piers penetrate a minimum of 5'-0" into the bearing strata as indicated on the structural drawings. If you have questions or require additional information regarding this matter, please do not hesitate to contact us.

Brande L. Parkey, P.E.
 Associate

PARKIN-PERKINS-OLSEN
 CONSULTING ENGINEERING, INC.

1 214.221.2220 www.ppoinc.net

2

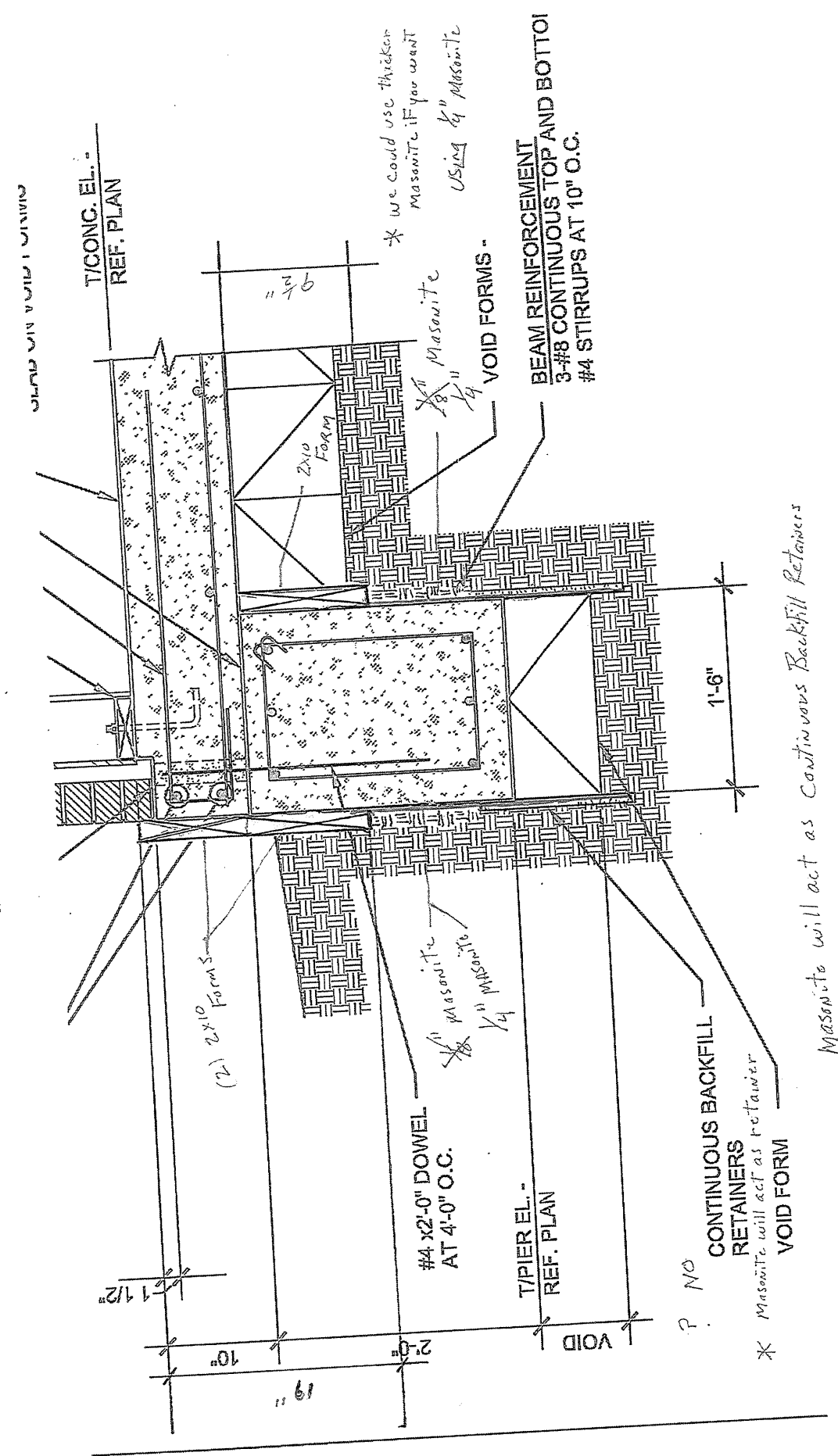

Brian Peterson
 From: Brian Peterson [mailto:BPeterson@embreydc.com]
 Sent: Monday, March 12, 2012 3:14 PM
 To: 'Trent Perkins (perkins@ppoinc.net)'; Brande Parkey (bparkey@ppoinc.net)
 Cc: David Gallagher
 Subject: FW: Keller Springs Formed Beams Options
 GUY'S

R. Trent Perkins, P.E.
 Principal
 PARKIN-PERKINS-OLSEN
 CONSULTING ENGINEERING, INC.
 1 214.221.2220 www.ppoinc.net

Per our telephone conversation earlier today, please utilize 3" Masonite in lieu of the combination of 1/8" Masonite and backfill retainers.
 If you have any questions or require additional information, please do not hesitate to call.
 Thank you for this opportunity to be of service.

Regards,
 R. Trent Perkins, P.E.
 Principal
 PARKIN-PERKINS-OLSEN
 CONSULTING ENGINEERING, INC.
 1 214.221.2220 www.ppoinc.net

1