

INSTALLATION PLAN
Scale 1/8" = 1'-0"
POOL AND AMENITY

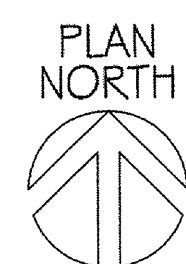

3rd FLOOR

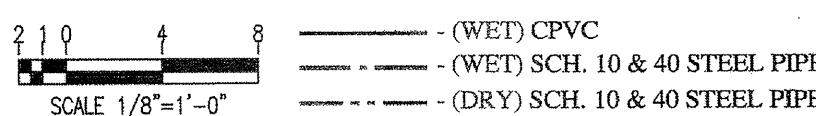

PIPE SIZE	SLEEVE DIA.
1"	2"
1-1/4"	2"
1-1/2"	2-1/2"
2"	3"
2-1/2"	3"
3"	4"
4"	5"
5"	6"
6"	8"
8"	10"

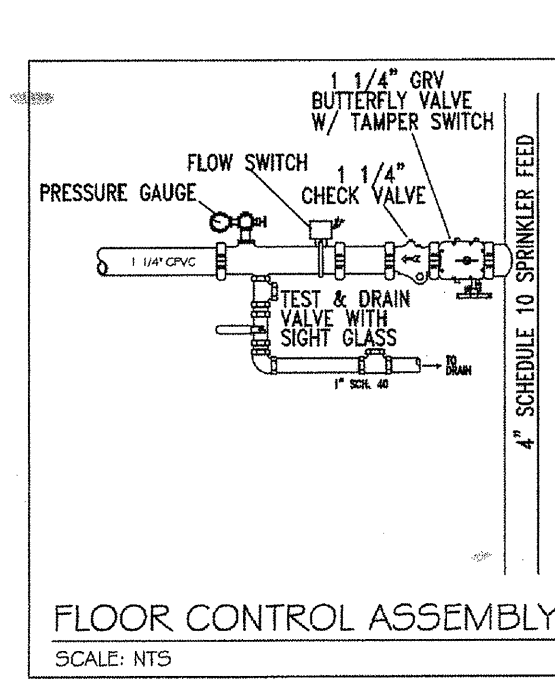
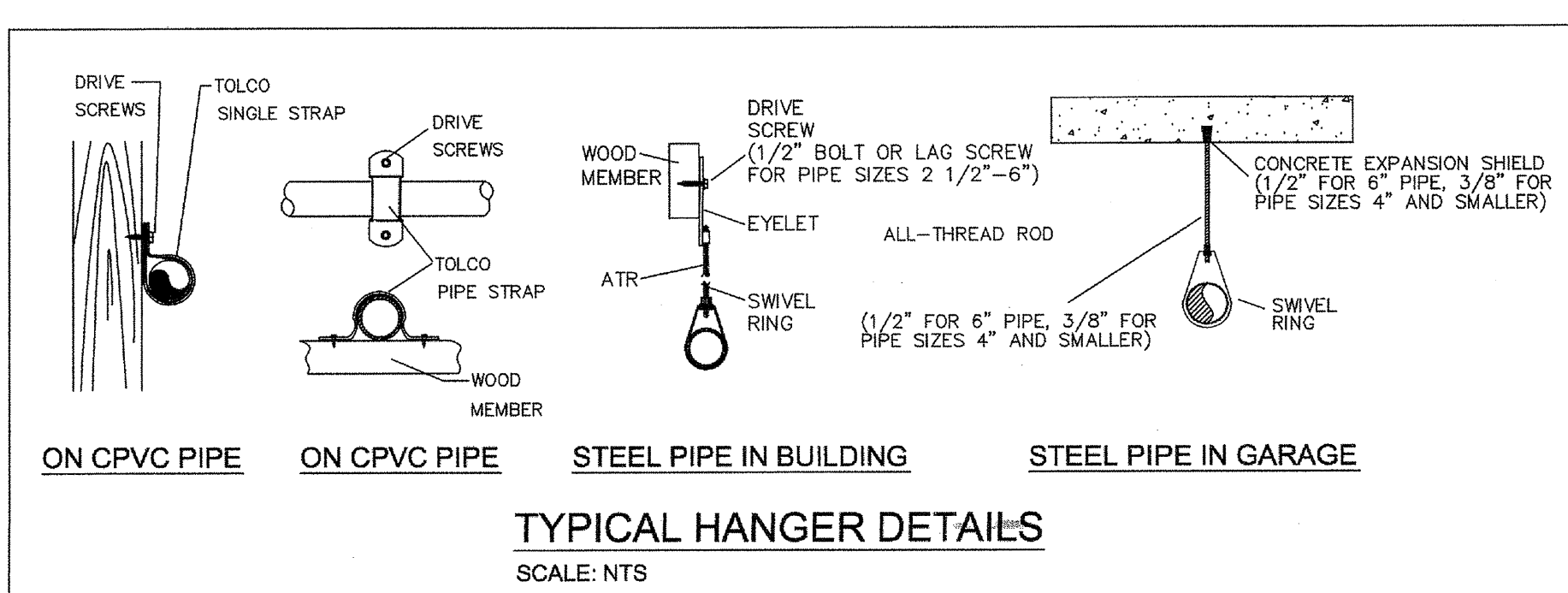
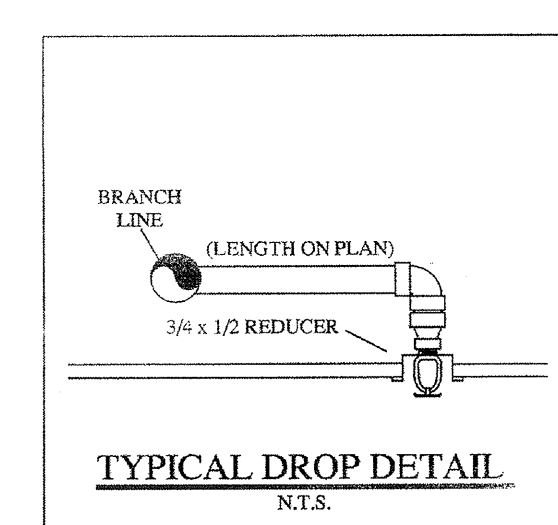
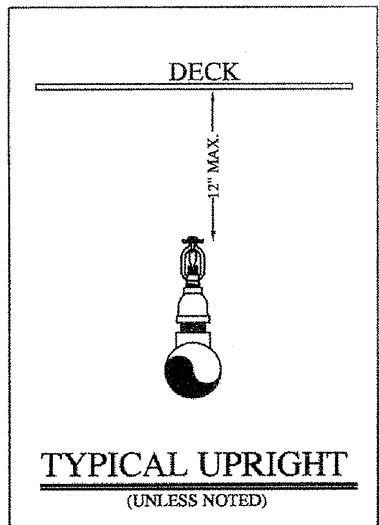
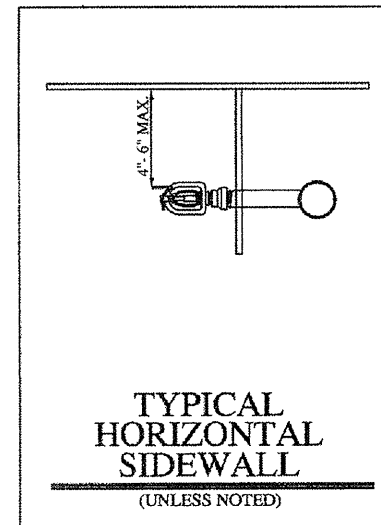
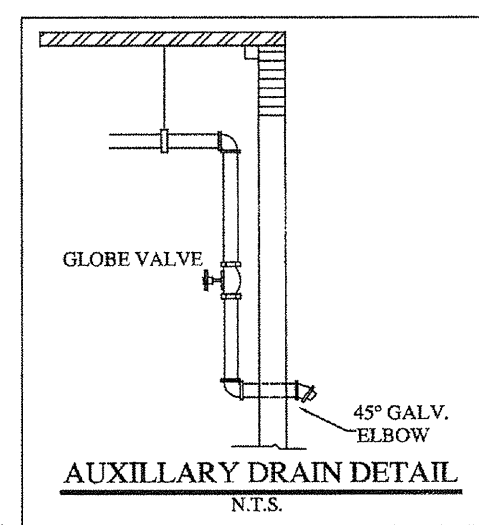

HANGER SPACING CHART

PIPE SIZE (OD)	3/4"	1"	1-1/4"	1-1/2"	2"	2-1/2"	3"	4"	6"
STEEL PIPE	N/A	12-0	12-0	15-0	15-0	15-0	15-0	15-0	15-0
THREADER	N/A	12-0	12-0	12-0	12-0	12-0	N/A	N/A	N/A
COPPER	8-0	8-0	10-0	10-0	12-0	12-0	12-0	15-0	15-0
CPVC	5-6	6-0	6-6	7-0	8-0	9-0	10-0	N/A	N/A

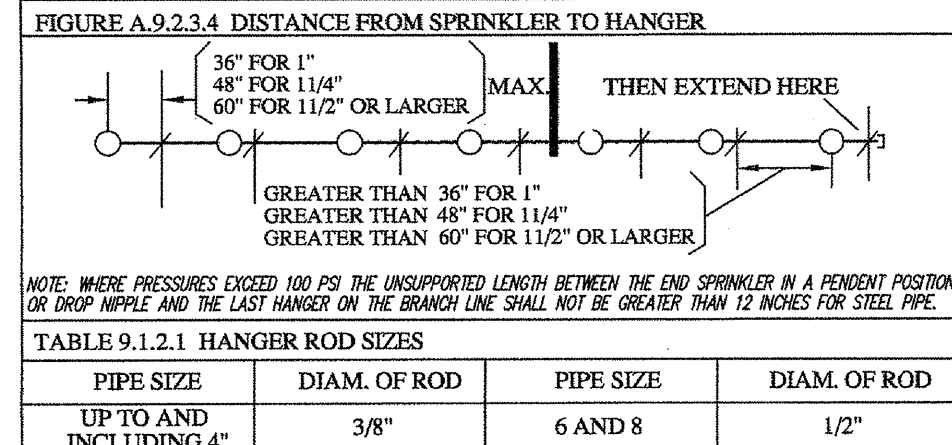

GENERAL NOTES:

- Ranger Fire's work shall consist of all necessary labor and material to design and install new automatic fire sprinkler systems in the referenced (9) Apartment Buildings and attached Parking Garage.
- Ranger Fire excludes all electrical and ceiling work.
- All design and installation shall conform to NFPA 13, 13R, 14, 20, & the City of Addison requirements.
- All material to be UL/FM approved for fire services.
- All new plastic piping shall be Schedule 40 CPVC with CPVC plastic fittings (u.o.n.). All steel piping shall be Black Sch. 10 with grooved fittings for the mains and Black Sch. 40 with threaded fittings for the branchlines.
- Owner or tenant is responsible for maintaining adequate heat to prevent the system from freezing (Min. 40 degrees F.).
- Sprinkler equipment room and equipment components shall be properly identified.
- Install signage on sprinkler equipment room door stating "Sprinkler Valve Room" in at least 4 inches in height.
- All hangers shall be in accordance with NFPA 13 requirements.
- All systems shall be tested at 200 psi for 2 hours and witnessed by a representative of the Addison Fire Department. Any leaks shall be repaired.
- The system has been hydraulically calculated per NFPA 13, 13R, 14, & 20 requirements.
- Install Black steel piping in Parking Garage.

LEGEND:

- SYSTEM RISER
- 4" X 2 1/2" X 2 1/2" F.D.C.
- VERTICAL PIPE (UP or DN)
- HYDRAULIC NODE POINT
- REMOTE AREA OUTLINE
- 2 1/2" HOSE VALVE
- BUTTERFLY VALVE
- HANGERS (SIZE VARIES)
- CEILING ELEVATION
- PIPE ELEVATION

RESIDENTIAL BUILDING INFO

OCCUPANCY: R-2/A-3
GROSS BLDG AREA: 424,139 S.F.
TYPE OF CONSTRUCTION: V-A

GARAGE BUILDING INFO

OCCUPANCY: S-2
GROSS BLDG AREA: 181,834 S.F.
TYPE OF CONSTRUCTION: 2-B

I have reviewed these plans and certify that they comply with the adopted NFPA standards.

Ranger Fire, Inc.
1000 South Main Street
Suite 150
Grapevine, Texas 76051
Phone: 817-410-9070
SCR-0590

RME SIGNATURE:
PRINTED RME NAME: Matthew B. Claxton
RME NUMBER: 0778 DATE: 7-31-13
 AS-BUILT SUBMITTAL OTHER

AS-BUILT

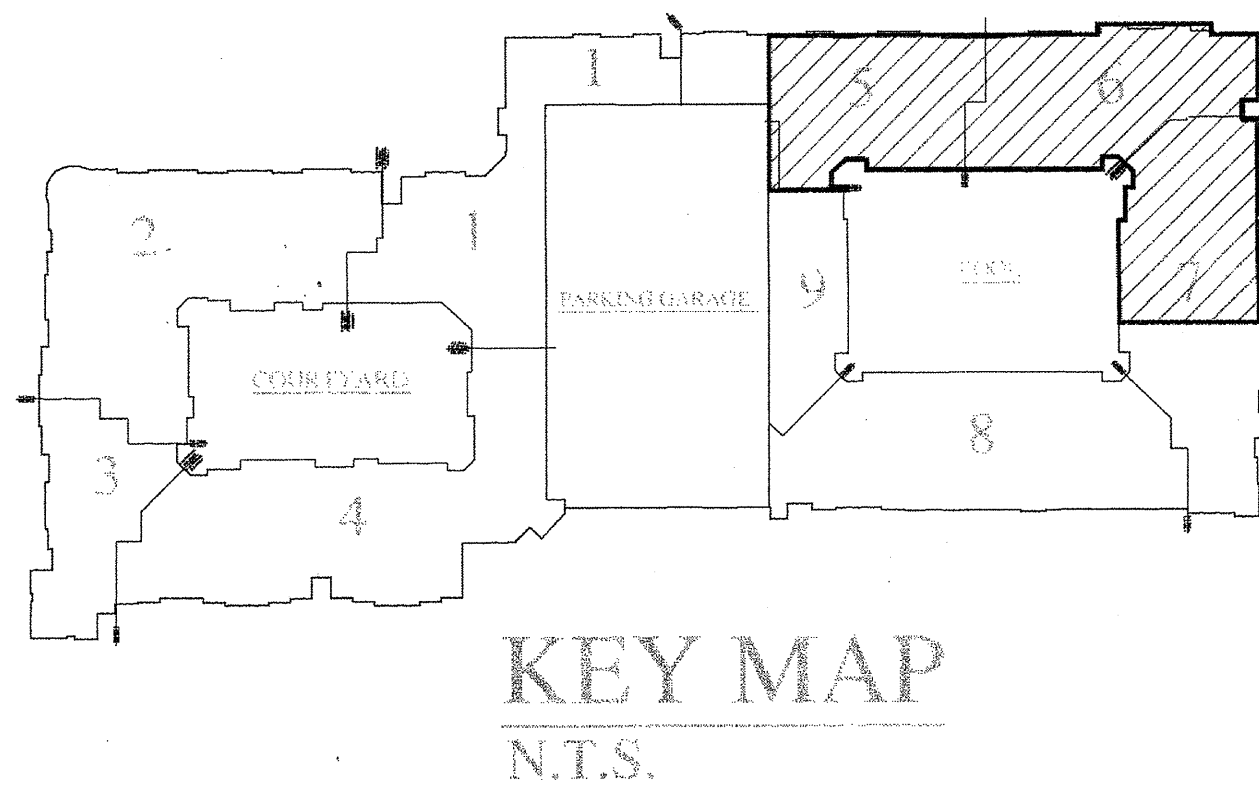

KEY MAP
N.T.S.

CONFIDENTIALITY STATEMENT
This drawing, the information and the description herein contained, are the property of Ranger Fire, Inc. and shall remain confidential. No part of this drawing may be reproduced or transmitted in any form or by any means, electronic, mechanical, photocopying, recording, or by any information storage and retrieval system, without the prior written consent of Ranger Fire, Inc.

GENERAL CONTRACTOR:
EMERBY PARTNERS LTD.
1020 N. LOOP 410, STE 700
SAN ANTONIO, TX
210-824-6044

OWNER:
EMERBY PARTNERS LTD.
1020 N. LOOP 410, STE 700
SAN ANTONIO, TX
210-824-6044

DATE: 7/31/13
REV #: 01

NO.	MAKE	MODEL	FINISH	ESCALATION
1	RELIABLE	FT BRS-29 PENDING	R3316 L40 1/2" 15SP WHITE	ESCALATION
2	RELIABLE	FT BRS-44 HSW	R3331 L44 1/2" 15SP WHITE	ESCALATION
3	RELIABLE	FT BRS-44 HSW	R3331 L44 1/2" 15SP CHROME	ESCALATION
4	RELIABLE	FT BRS-44 HSW	R3331 L44 1/2" 15SP CHROME	ESCALATION
5	RELIABLE	FT BRS-44 HSW	R3331 L44 1/2" 20P CHROME	ESCALATION

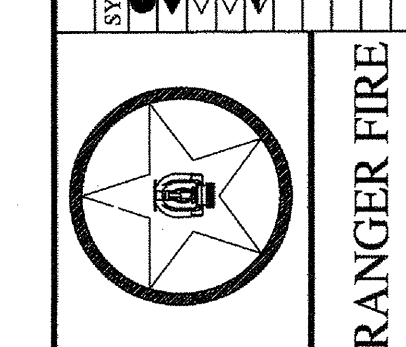

KELLER SPRINGS LOFTS
4800 KELLER SPRINGS PKWY
ADDISON, TEXAS 75001

CONTRACT NAME:
CONTRACT # 11-055
DESCRIPTION: 3RD FLOOR
SCALE: 1/8" = 1'-0"
DRAWN BY: C. ALEXANDER
CHECKED BY:
DATE: 04-01-12
DWG # FP 13 OF 30

RANGER FIRE, INC.
920 SOUTH MAIN STREET
SUITE 200
GRAPEVINE, TEXAS 76051
TEXAS LICENSE: 0590