

**LEGEND**

- ① 24" STOP BAR ( PROVIDED UNDER TRAFFIC SIGNAL CONTRACT)
- ② NOT USED
- ③ LANE LINE (4" WHITE CERAMIC RAISED PAVEMENT MARKERS)
- ④ LEFT AND RIGHT TURN LANE BAY DIVIDE LINE (4" WHITE CERAMIC RAISED PAVEMENT MARKERS)
- ⑤ CENTER LINE (4" YELLOW CERAMIC RAISED PAVEMENT MARKERS)
- ⑥ LEFT TURN ARROW (SOLID WHITE ALKYD THERMOPLASTIC)
- ⑦ RIGHT TURN ARROW (SOLID WHITE ALKYD THERMOPLASTIC)
- ⑧ "ONLY" (SOLID WHITE ALKYD THERMOPLASTIC)
- ⑨ CONTINUOUS TURN LANE LINE (4" YELLOW CERAMIC RAISED PAVEMENT MARKERS)
- ⑩ MEDIAN MARKINGS (4" YELLOW CERAMIC RAISED PAVEMENT MARKERS)

**NOTES :**

- 1. SEE SIGNAL LAYOUT PLAN FOR LOCATION OF STOP BARS
- 2. SEE MISCELLANEOUS DETAILS FOR TURN ARROW LAYOUT AND HANDICAP RAMPS.
- 3. DIMENSIONS ARE TO FACE OF CURB OR CENTER OF PAVEMENT MARKINGS.
- 4. SEE PAVING PLAN/PROFILE SHEETS FOR HORIZONTAL LAYOUT OF CENTERLINE MARKERS AND TURN BAY DIVIDE LINE MARKERS.

**MEDIAN MARKINGS**

**CONTINUOUS TURN LANE LINE**

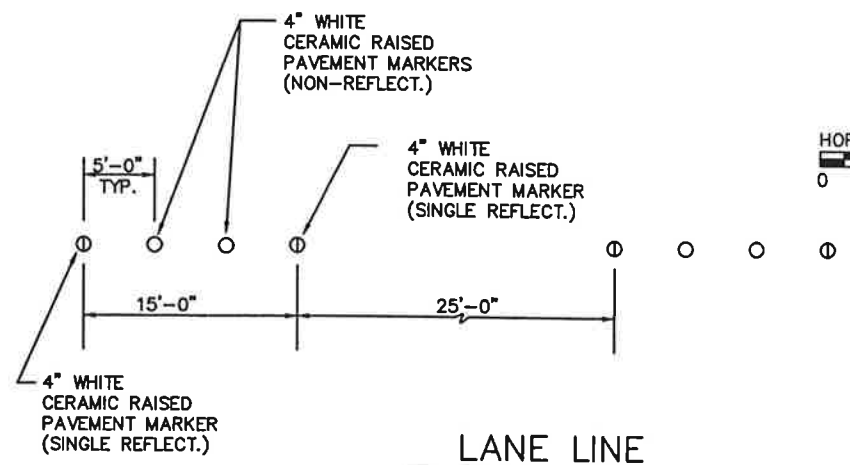
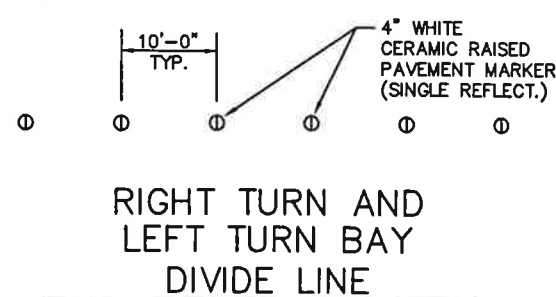
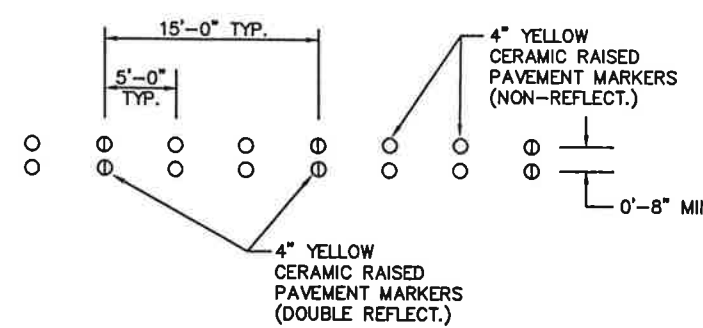
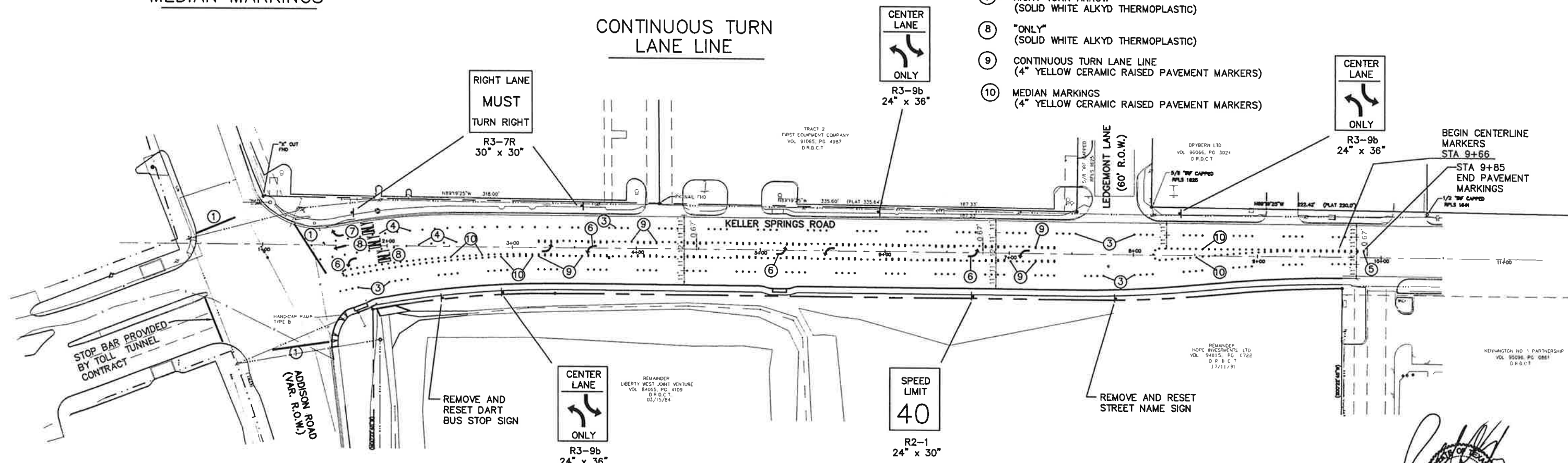

HORIZONTAL SCALE : 1" = 40'  
0 20 40 60 80 100 120



REV. 1 - MODIFY NOTES AND LEGEND 3/5/99

5  
16

<b>SIGNING AND MARKINGS PLAN</b>					
<b>KELLER SPRINGS ROAD</b>					
<b>FROM ADDISON ROAD TO LEDGEMONT LANE</b>					
<b>DEPARTMENT OF PUBLIC WORKS</b>					
<b>TOWN OF ADDISON, TEXAS</b>					
DESIGN	DRAWN	DATE	SCALE	NOTES	FILE NUMBER
PTG	PTG	5-98	1"=40' H		