

p:\0106keller\traff\plan\sh3.dgn 01 MAY 2001

MATCHLINE STATION 19+00

MATCHLINE STATION 21+00

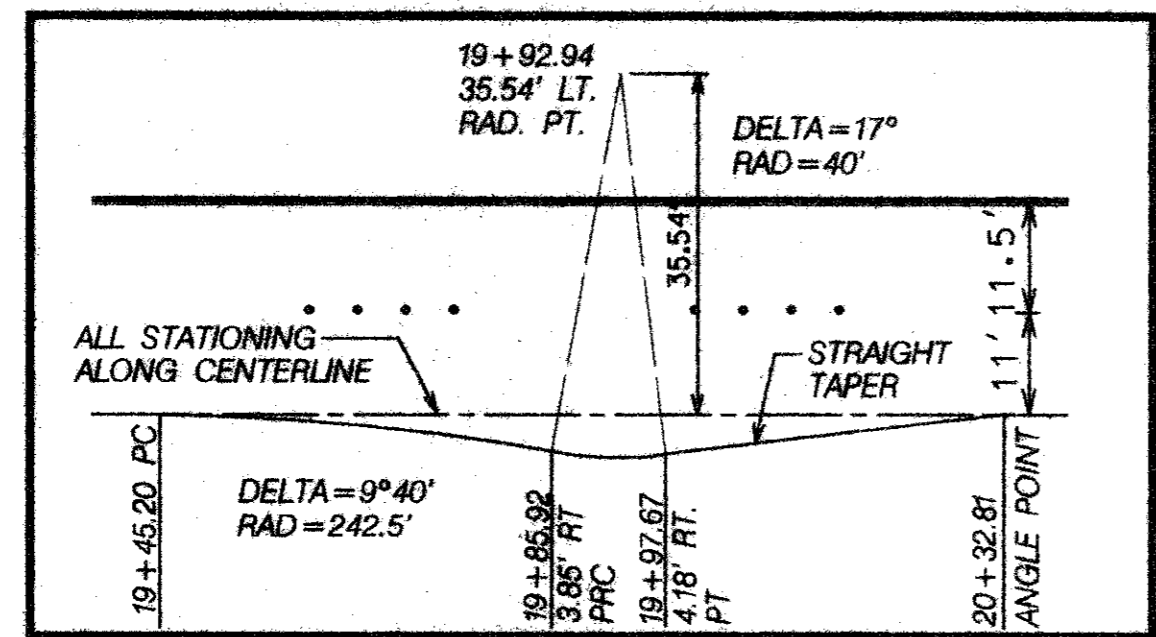
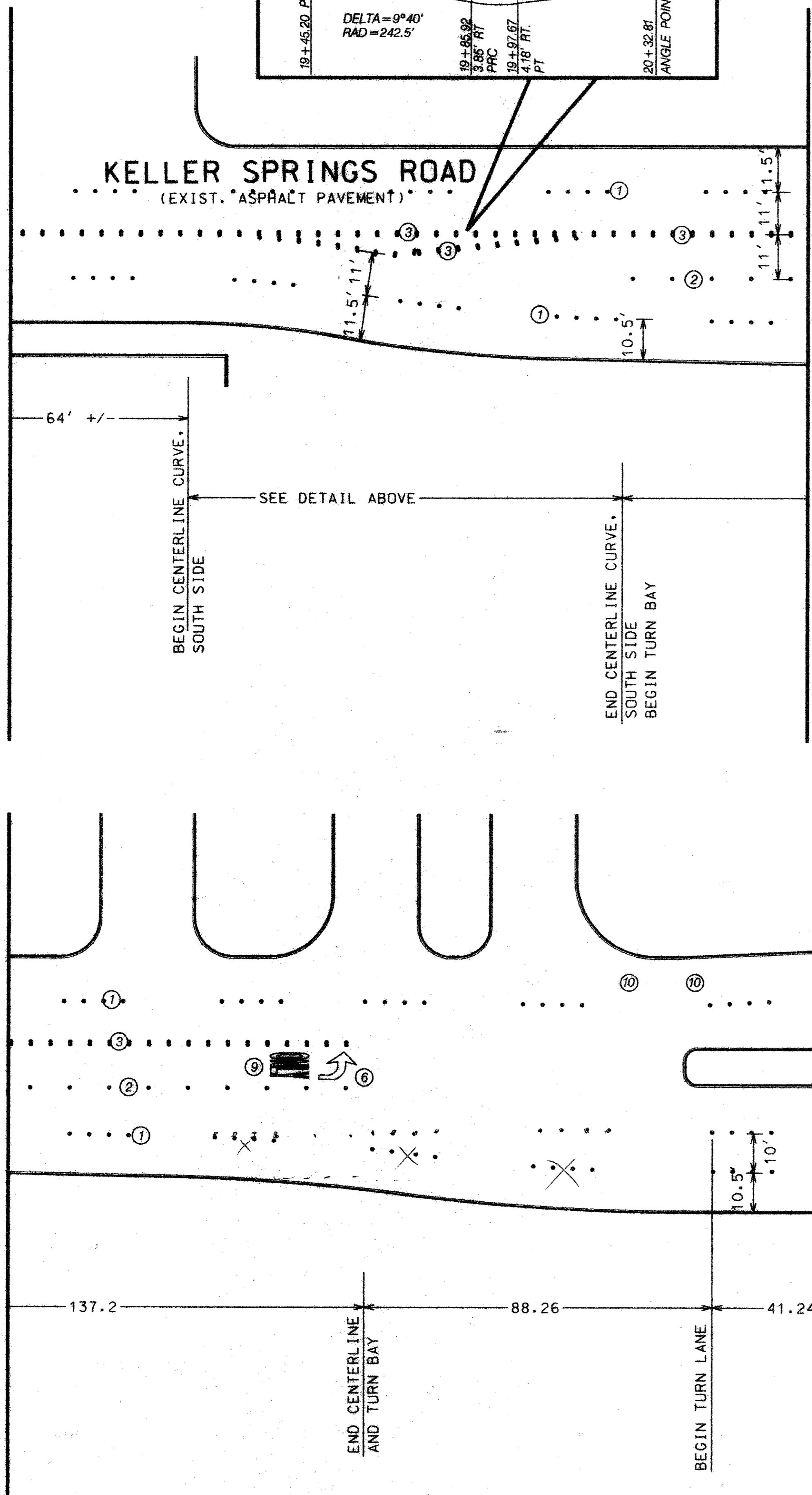

MATCHLINE STATION 21+00

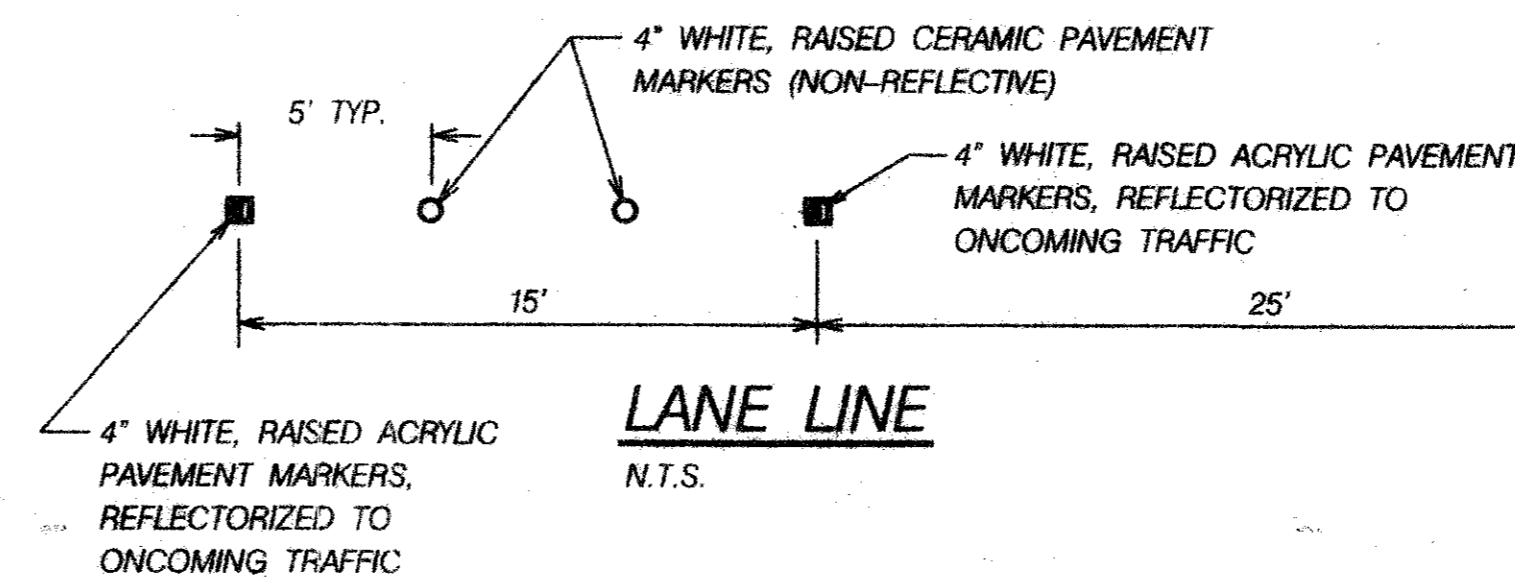
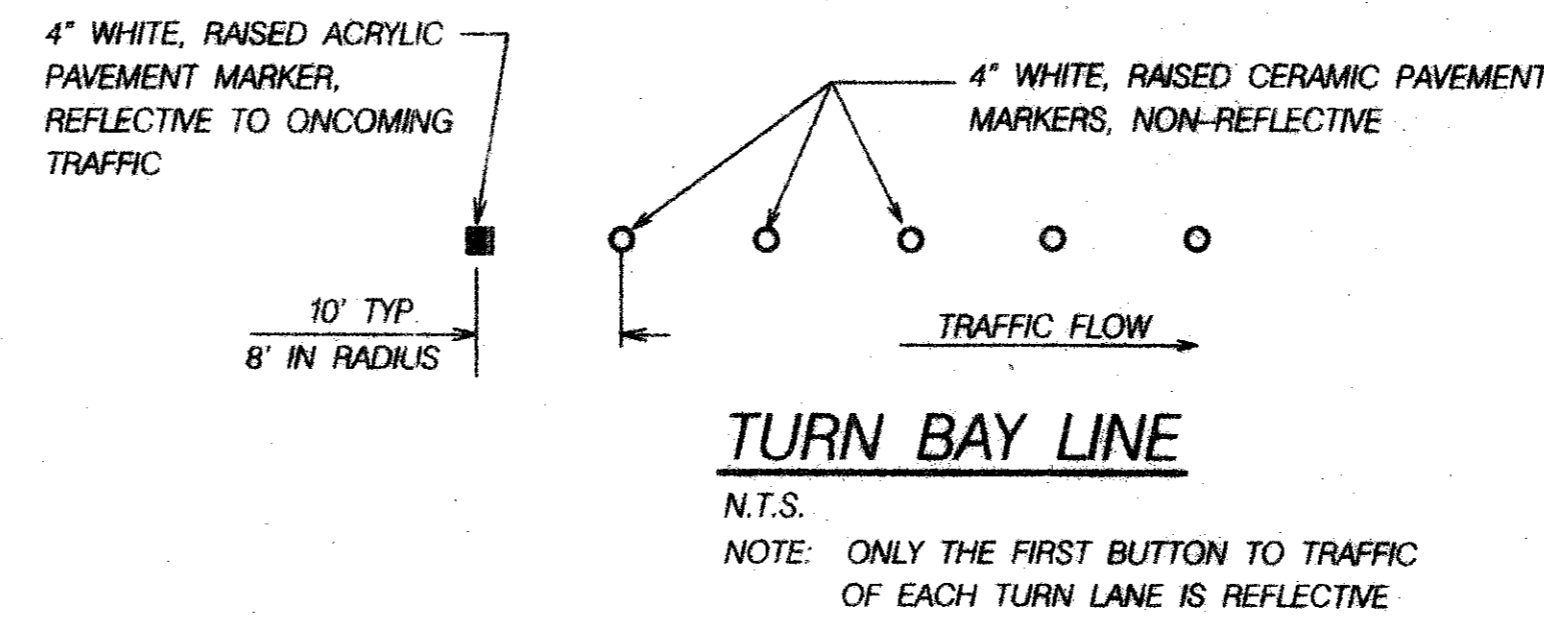
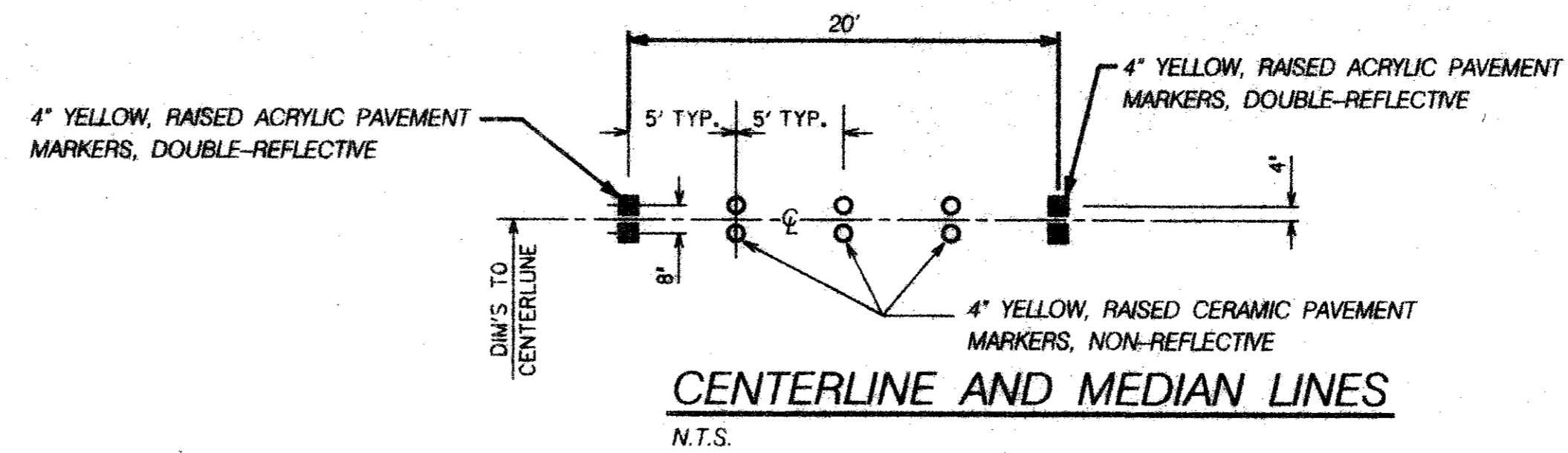

LEGEND	
①	LANE STRIPE - 4" WHITE RAISED PAVEMENT MARKERS, ACRYLIC SINGLE REFLECTIVE AND CERAMIC NON-REFLECTIVE
②	TURN LANE BAY DIVIDE - 4" WHITE, RAISED PAVEMENT MARKERS, ACRYLIC SINGLE REFLECTIVE AND CERAMIC NON-REFLECTIVE
③	CENTERLINE / MEDIAN - 4" YELLOW RAISED PAVEMENT MARKERS, ACRYLIC DOUBLE REFLECTIVE AND CERAMIC NON-REFLECTIVE
④	RIGHT TURN ARROW SOLID WHITE ALKYD THERMOPLASTIC
⑤	THRU / RIGHT TURN ARROW SOLID WHITE ALKYD THERMOPLASTIC
⑥	LEFT TURN ARROW SOLID WHITE ALKYD THERMOPLASTIC
⑦	THRU ONLY ARROW SOLID WHITE ALKYD THERMOPLASTIC
⑧	STOP BAR 24" WIDE, WHITE ALKYD THERMOPLASTIC
⑨	"ONLY" LANE MARKING SOLID WHITE ALKYD THERMOPLASTIC

DALLAS PARKWAY

26+00 END PROJECT

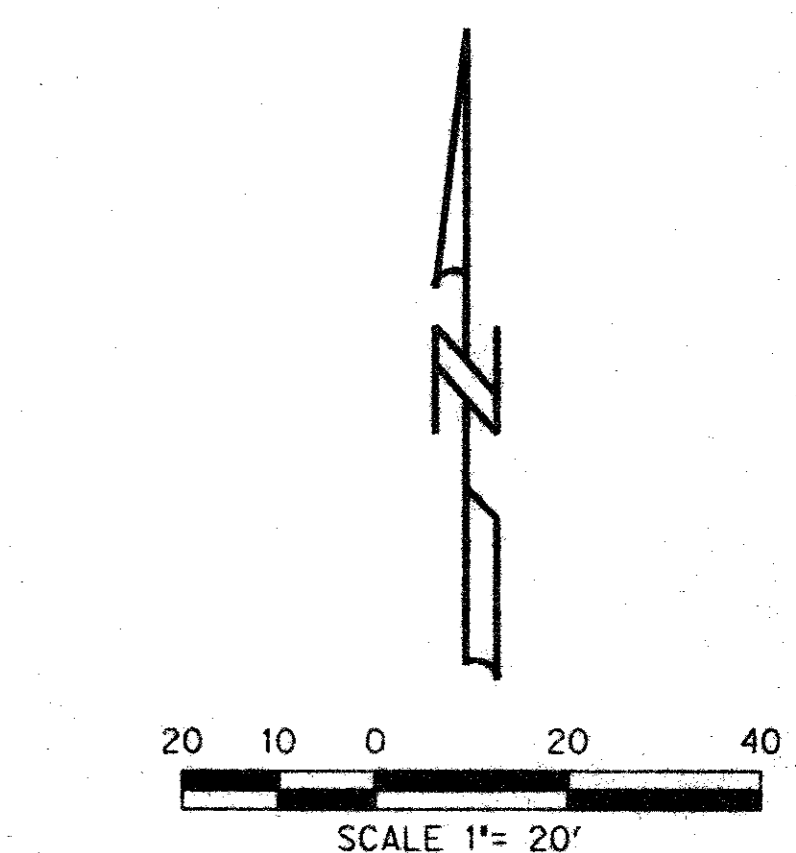

- NOTE: ALL ALKYD THERMOPLASTIC TO BE HOT-APPLIED.
- NOTE: ALL DIMENSIONS ARE TO BACK-OF-CURB.
- NOTE: PLACE TRAFFIC SIGNS TWO FEET CLEAR OF SIDEWALK OR AS DIRECTED BY THE ENGINEER.
- NOTE: ELEVATED SIGNAGE TO BE PROVIDED BY TOWN OF ADDISON.
- NOTE: MATERIAL SPECIFICATION PER TOWN OF ADDISON

KELLER SPRINGS ROAD
(EXIST. ASPHALT PAVEMENT)

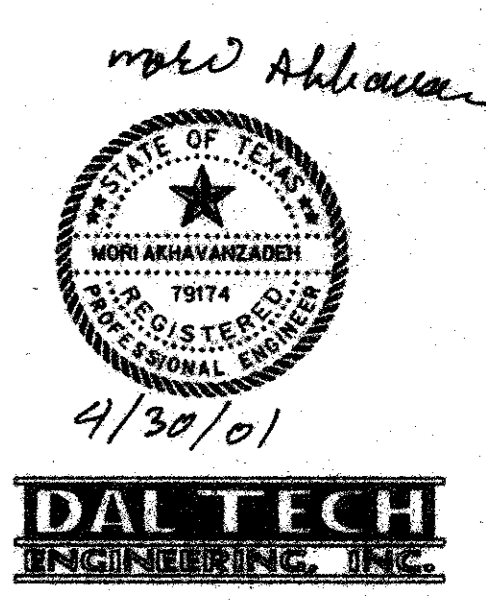
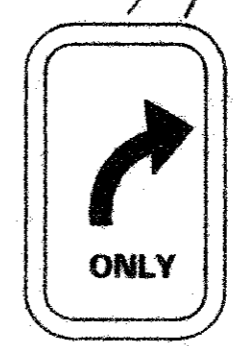
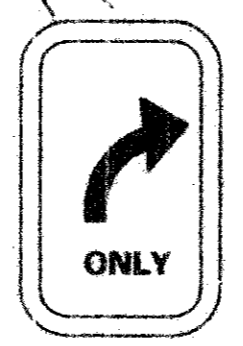

PAVEMENT MARKINGS						
KELLER SPRINGS ROAD						
from Addison Road to Dallas Parkway						
STREETS DIVISION						
TOWN OF ADDISON, TEXAS						
DESIGN	DRAWN	DATE	SCALE	NOTES	FILE	NO.
DTE	S.H	APR 01	1"=20'			3/3