

TOWN OF ADDISON

KELLER SPRINGS ROAD - DALLAS NORTH TOLLWAY INTERSECTION IMPROVEMENTS

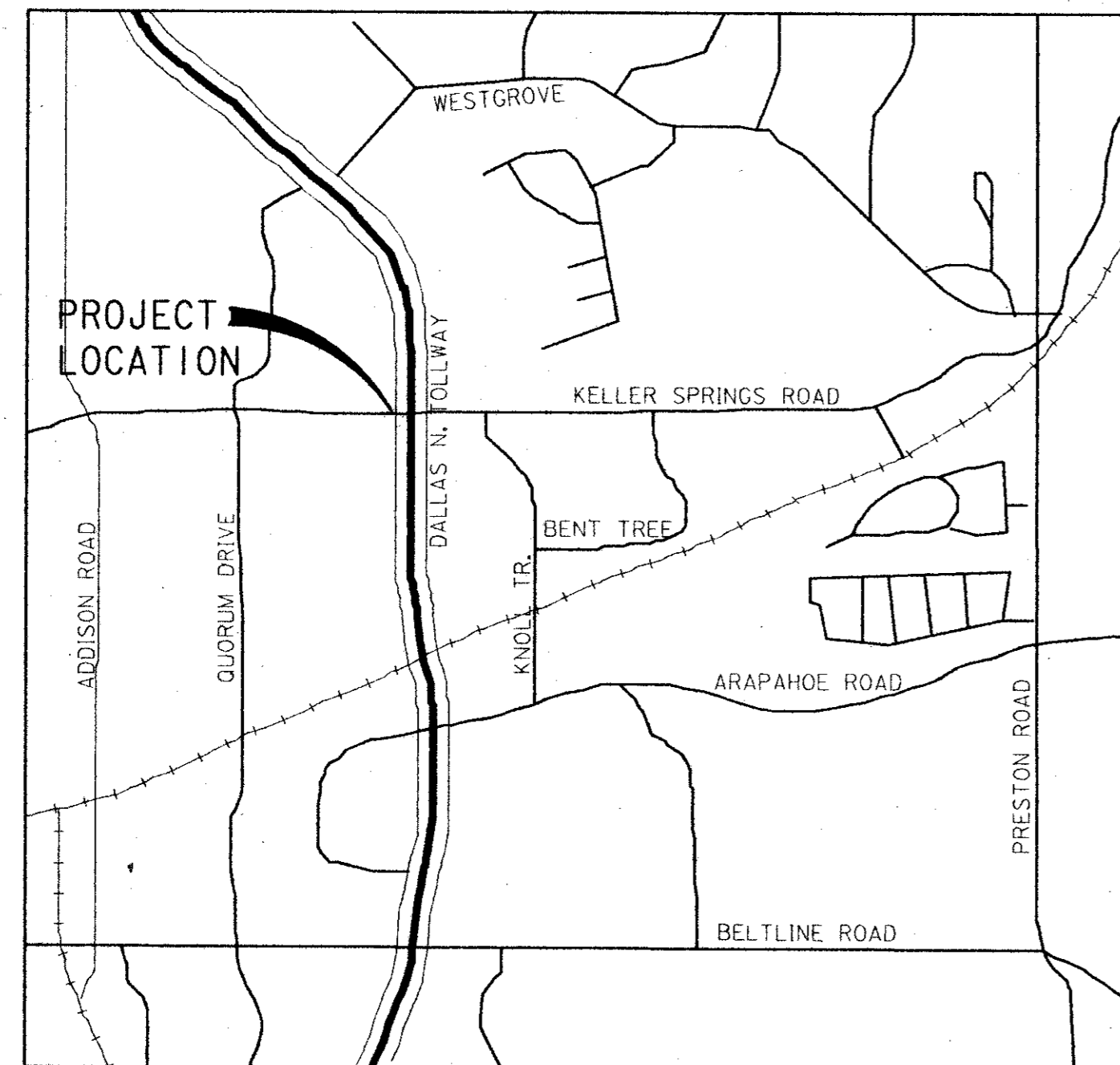

LOCATION MAP
N. T. S.



INDEX

- 1 COVER SHEET
- 2 TYPICAL SECTION
- 3 TRAFFIC CONTROL PLAN
- 4 RIGHT OF WAY PLAN
- 5 PLAN AND PROFILE
- 6 PLAN AND PROFILE
- 7 UTILITY LAYOUT
- 8 SIGNING & STRIPING PLAN
- 9 MISCELLANEOUS DETAILS
- 10 INLET DETAILS
- 11 SIDEWALK & RAMP DETAILS
- 12 EMBEDMENT DETAILS
- 13 WATER DETAILS
- 14 FIRE HYDRANT & VALVE DETAILS

LANDSCAPING

- 1 LANDSCAPING PLAN
- 2 IRRIGATION DETAILS

RUST LICHLITER/JAMESON

Environment & Infrastructure
Consulting Engineers, Scientists and Planners
1420 W. Mockingbird Lane, Suite 300, Dallas, Texas 75247-4906

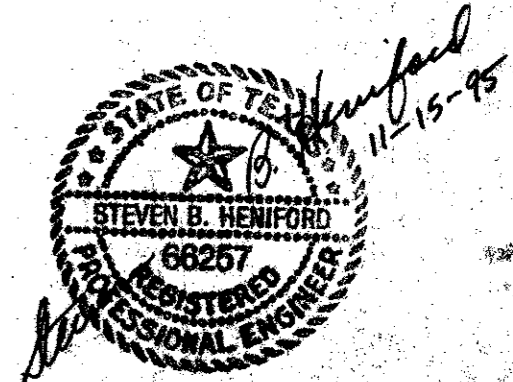

AGC Plan Room
1083 - Dec 1 10:30 AM '95

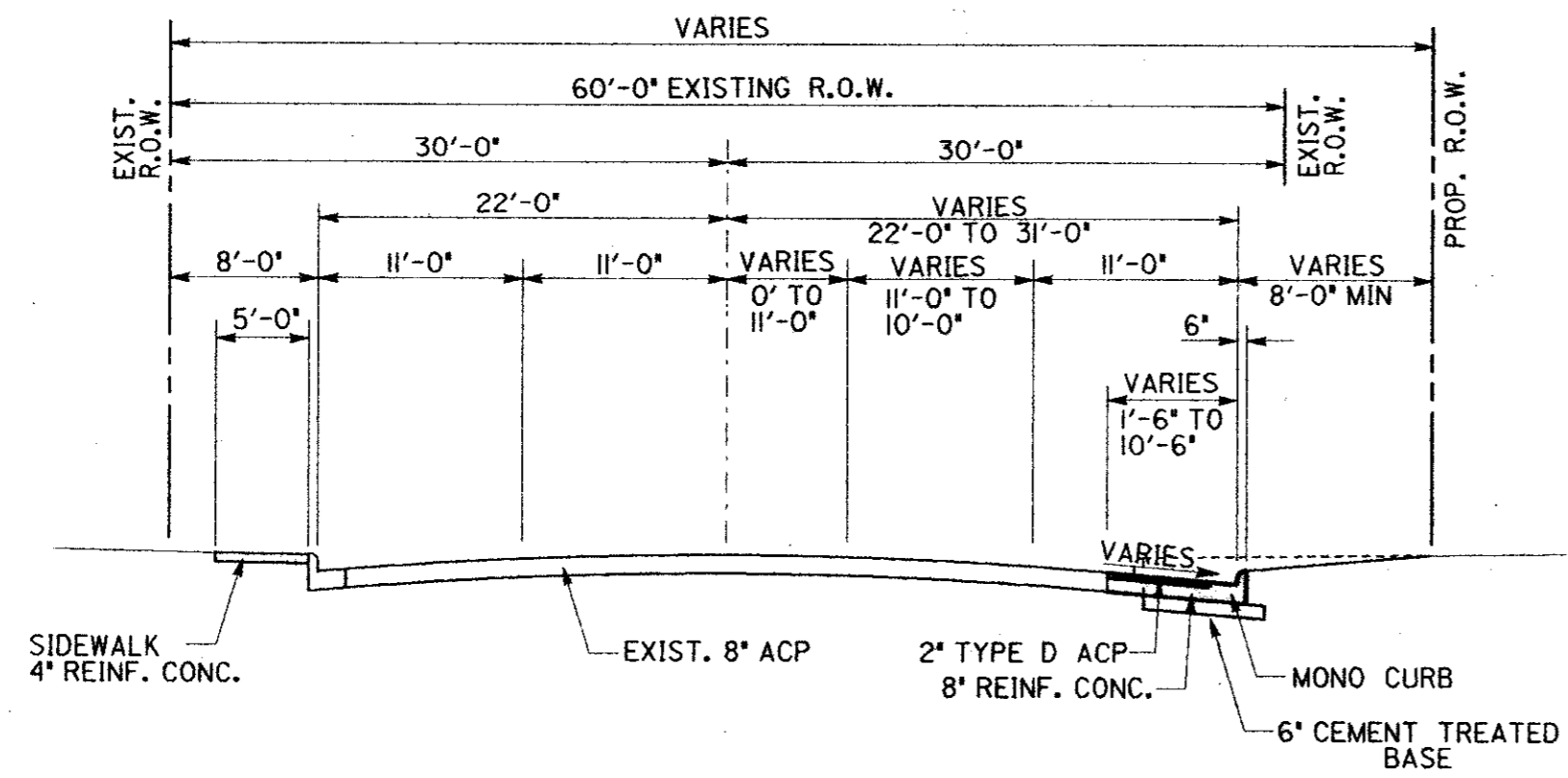

TYPICAL SECTION
KELLER SPRINGS ROAD
STA 18+72.88 TO STA 20+60.00

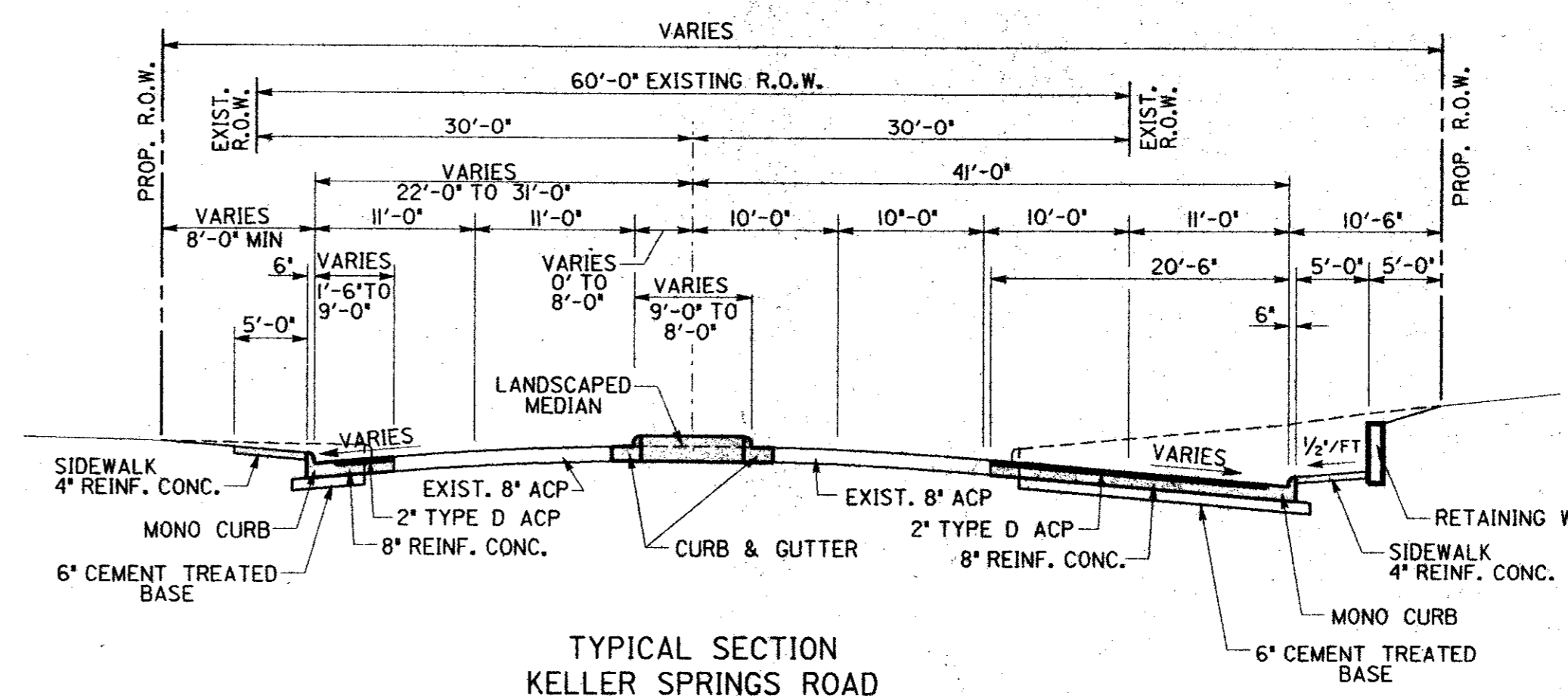

TYPICAL SECTION
KELLER SPRINGS ROAD
STA 22+51.22 TO STA 24+26.18

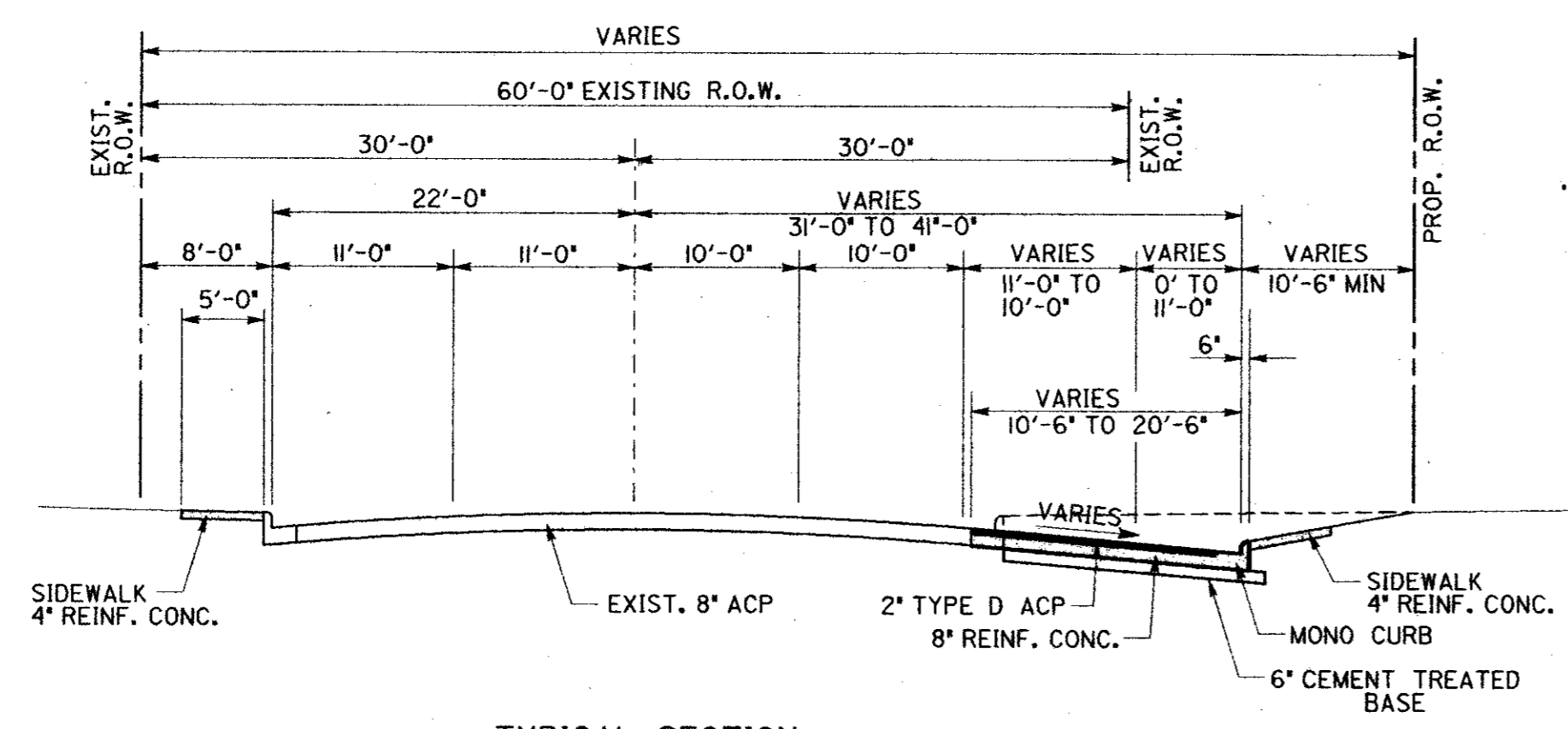

TYPICAL SECTION
KELLER SPRINGS ROAD
STA 20+60.00 TO STA 22+51.22

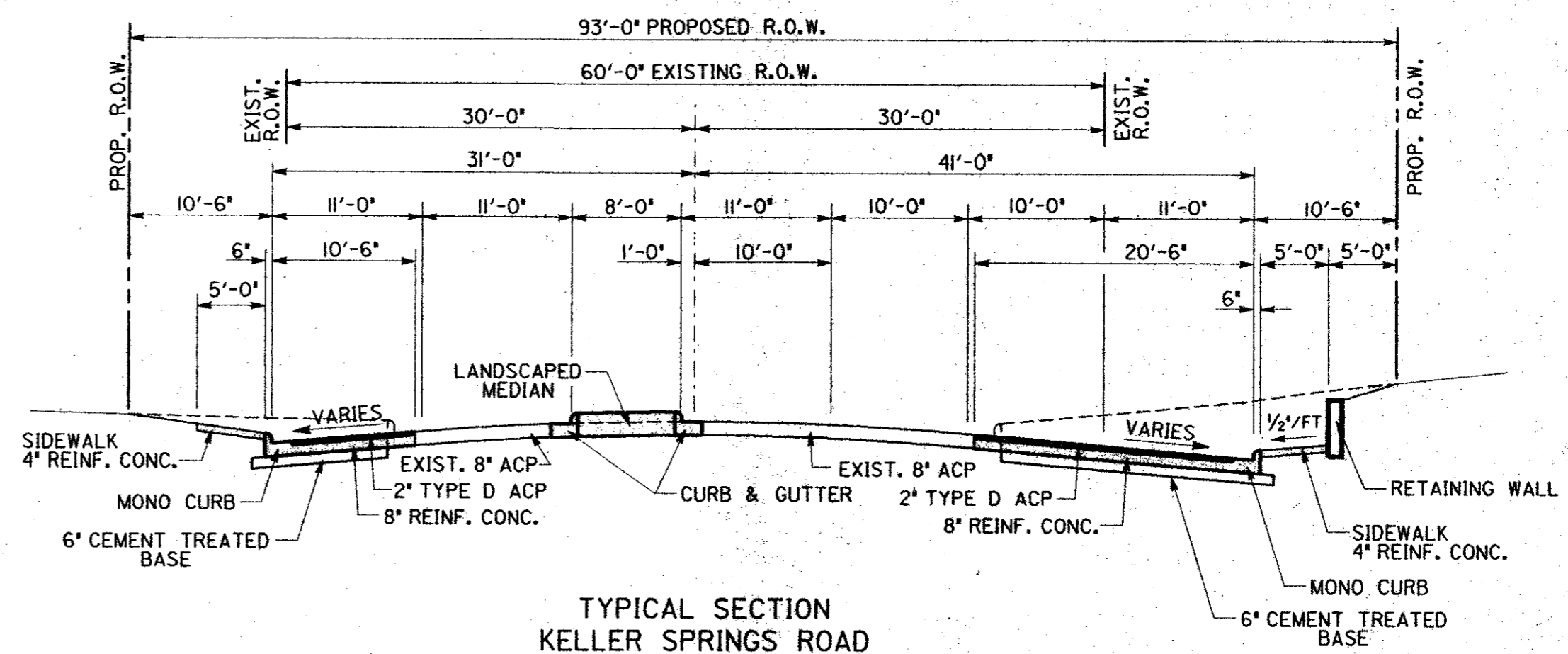

TYPICAL SECTION
KELLER SPRINGS ROAD
STA 24+26.18 TO STA 25+20.00

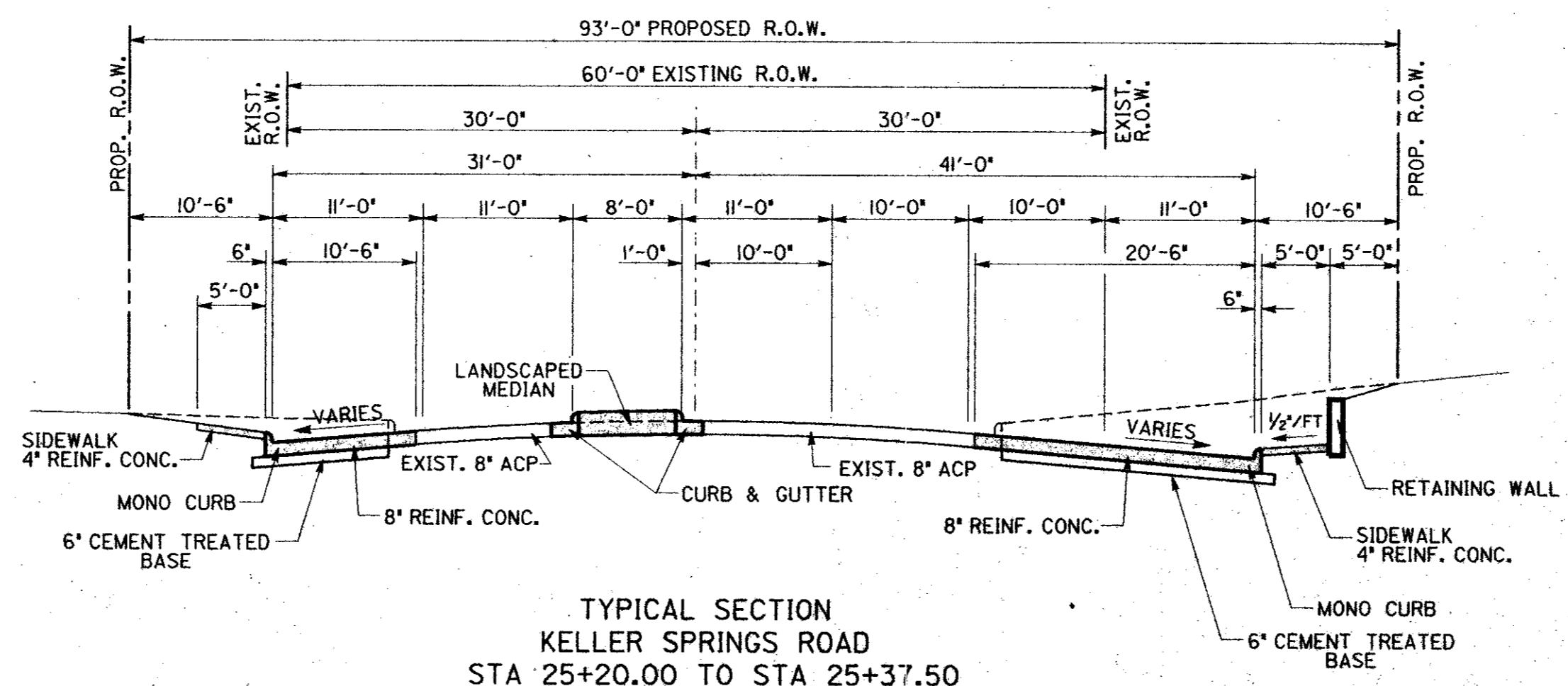

TYPICAL SECTION
KELLER SPRINGS ROAD
STA 25+20.00 TO STA 25+37.50

- GENERAL NOTES:
1. STREET CONCRETE IS TO BE 3600 p.s.i.
 2. C.T.B. IS TO BE CLASS A, 400 p.s.i. AT SEVEN DAYS.
 3. SIDEWALK CONCRETE IS TO BE 3000 p.s.i.

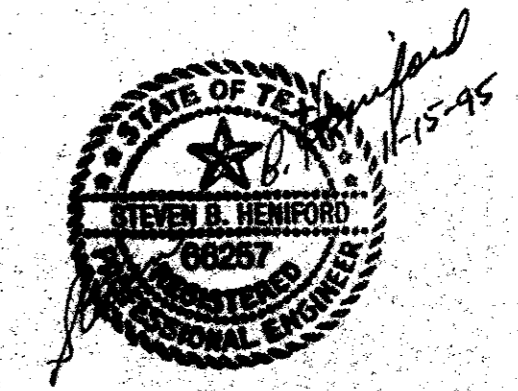

**KELLER SPRINGS ROAD
NORTH DALLAS TOLLWAY
INTERSECTION IMPROVEMENTS
TYPICAL SECTIONS**

TOWN OF ADDISON, TEXAS

JUST LICHLITER/JAMESON

Professional Engineers, Architects and Planners
400 W. McDougal Ave., Suite 200, Dallas, Texas 75201-2998

JOB NO. 67515.001	DATE Nov 8 1995	DESIGNED BY C.H.B.	CHECKED BY T.S.B.
CAD FILE KS-TYP.dgn	CAD DATE Nov 8 1995	SCALE 1" = 10'	SHEET 2 OF 14

GENERAL NOTES:

1. CONSTRUCTION ACTIVITY REQUIRING LANE CLOSURES MUST BE PERFORMED BETWEEN THE HOURS OF 8:30 AM AND 4:00 PM.
2. A MINIMUM OF 2 LANES IN EACH DIRECTION MUST BE OPEN ON ALL ROADWAYS EXCEPT DURING THE HOURS SPECIFIED IN NOTE 1.
3. ANY EXISTING OR PROPOSED SIGNAGE THAT IS IN CONFLICT WITH THE TRAFFIC CONTROL PLAN SHALL BE COVERED DURING THE HOURS OF TRAFFIC CONTROL OPERATION.
4. EXISTING PAVEMENT MARKINGS ARE TO REMAIN IN PLACE DURING PHASE I CONSTRUCTION.
5. FINAL PAVEMENT MARKINGS AND SIGNAGE IS TO BE IN PLACE AS SHOWN BEFORE PHASE II CONSTRUCTION BEGINS.
6. PLAN SHOWS LANE CLOSURES ALLOWED ONLY DURING HOURS CONTRACTOR IS WORKING. TWO LANES OF TRAFFIC IN EACH DIRECTION SHALL BE MAINTAINED WHEN CONTRACTOR IS NOT WORKING.

7. PLAN SHOWS MINIMUM REQUIREMENTS FOR BARRICADING. TOWN OF ADDISON RESERVES THE RIGHT TO REQUIRE CONTRACTOR TO PLACE ADDITIONAL SIGNS AND BARRICADES IF TOWN DEEMS NECESSARY DURING CONSTRUCTION.
8. CONTRACTOR MAY MODIFY PLAN BY SUBMITTING A REVISED DRAWING TO TOWN OF ADDISON FOR REVIEW AND APPROVAL. CONTRACTOR MAY NOT DEVIATE FROM PLAN WITHOUT APPROVAL OF THE TOWN.
9. THE CONTRACTOR SHALL TAKE CARE TO ASSURE THAT ALL TRAFFIC CONTROL DEVICES AND WORK ZONE PAVEMENT MARKINGS BE KEPT IN A HIGHLY VISIBLE CONDITION (CLEAN, UPRIGHT, AND PROPER LOCATION).
10. THE CONTRACTOR IS RESPONSIBLE FOR CONTINUED PROPERTY ACCESS DURING ALL CONSTRUCTION PHASES. A MINIMUM OF ONE DRIVEWAY MUST REMAIN OPEN TO EACH PROPERTY.
11. THE CONTRACTOR IS RESPONSIBLE FOR PROPER DRAINAGE DURING ALL CONSTRUCTION PHASES. WATER WILL NOT BE ALLOWED TO POND ON ANY ROADWAY SURFACE AND RUNOFF FROM ADJACENT PROPERTIES SHALL NOT BE IMPEDED.
12. ANY DEVICE PLACED BY THE CONTRACTOR SHALL BE LOCATED IN SUCH A MANNER AS NOT TO INTERFERE WITH THE SIGHT DISTANCE OF DRIVERS ENTERING THE ROADWAY.
13. CONSTRUCTION OF THE 21" STORM SEWER LATERAL SHALL COMMENCE AT THE BEGINNING OF PHASE I AND FINISH AS QUICKLY AS POSSIBLE TO MINIMIZE THE CLOSURE OF TWO LANES ON SOUTHBOUND DALLAS PARKWAY.

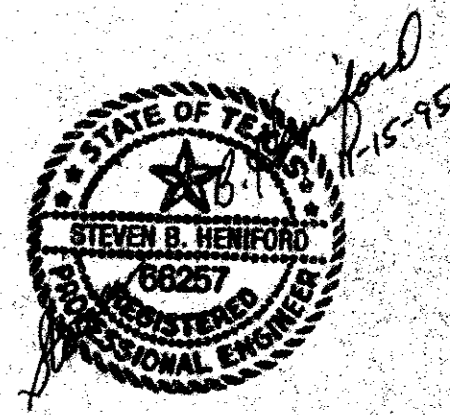
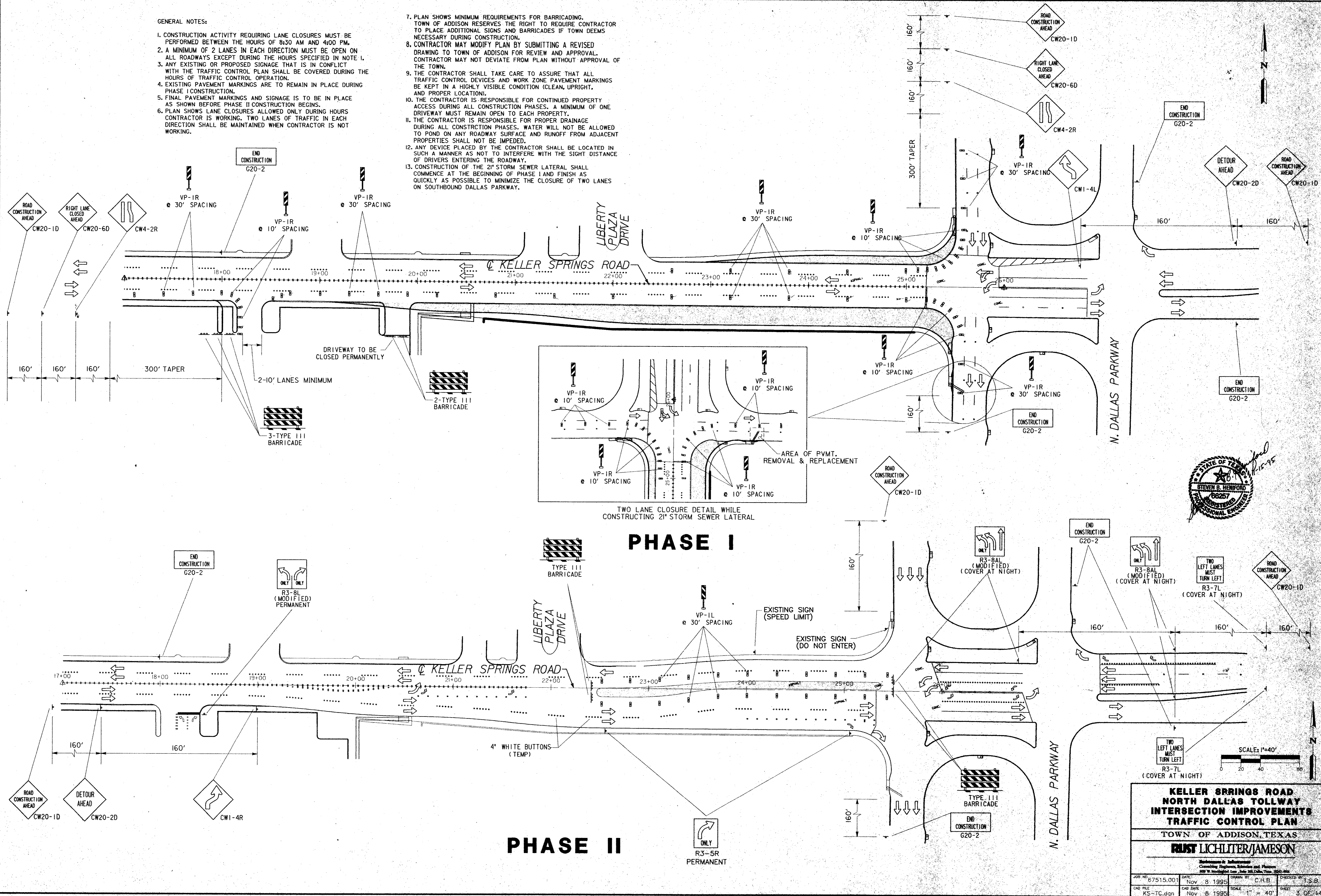

**KELLER SPRINGS ROAD
NORTH DALLAS TOLLWAY
INTERSECTION IMPROVEMENTS
TRAFFIC CONTROL PLAN**

TOWN OF ADDISON, TEXAS

RUST LICHLITER/JAMESON

Engineering & Infrastructure
Consulting Engineers, Scientists and Planners
389 W. Henderson Lane, Suite 200, Dallas, Texas 75242-4040

JOB NO. 67515.001	DATE Nov 8 1995	CREATED BY C.H.B.	CHECKED BY T.S.B.
CAD FILE KS-TC.dwg	CAD DATE Nov 8 1995	SCALE 1" = 40'	SHEET 5 OF 14

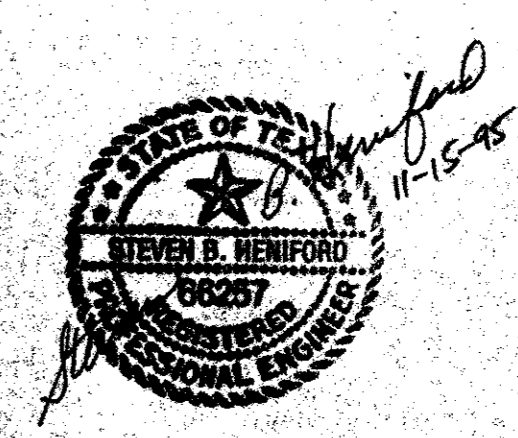
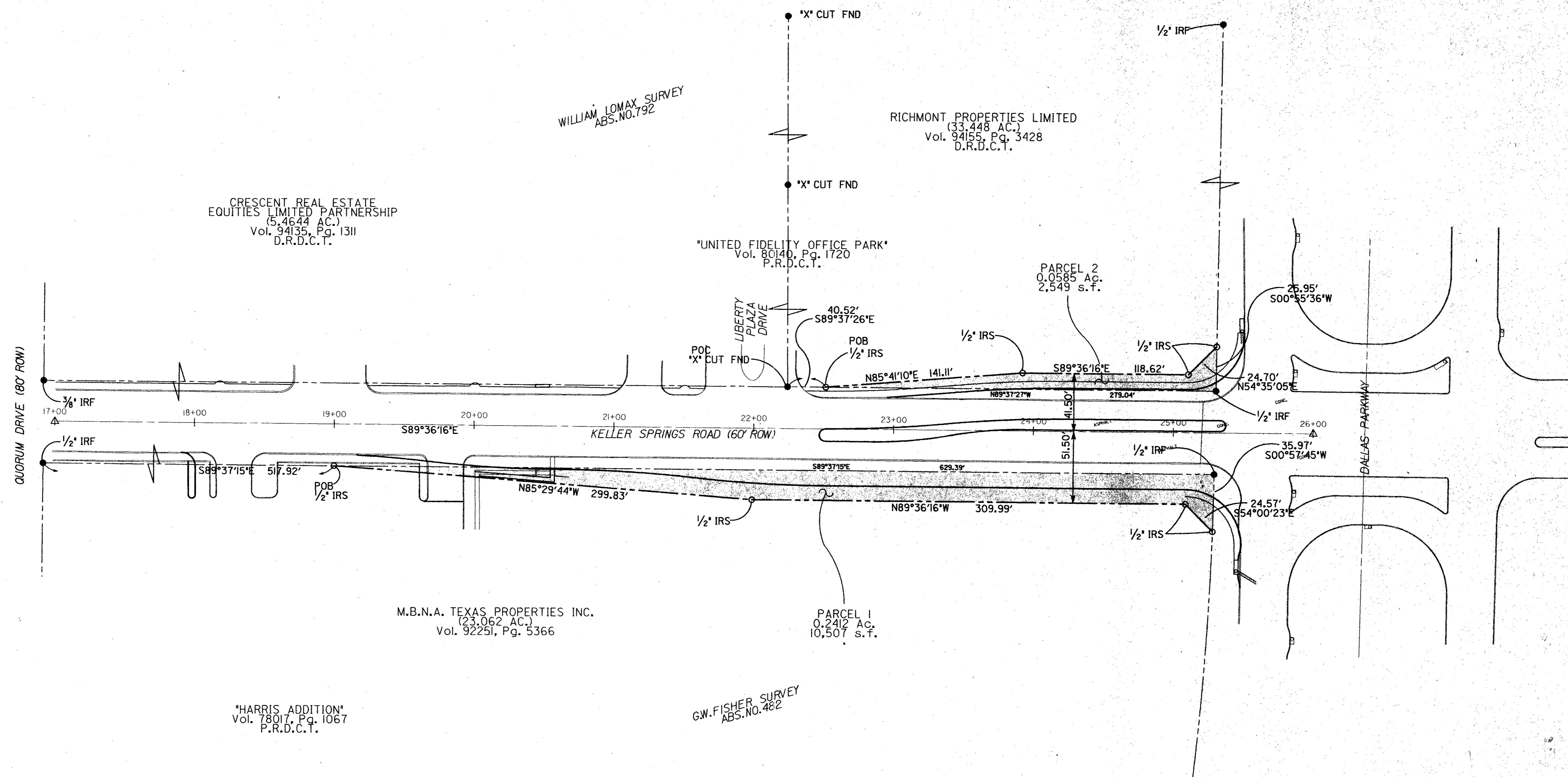

KELLER SPRINGS ROAD NORTH DALLAS TOLLWAY INTERSECTION IMPROVEMENTS R.O.W. PLAN			
TOWN OF ADDISON, TEXAS			
RUST LICHLITER/JAMESON			
<small>Business & Professional Consulting Engineers, Scientists and Planners 402 W. Montfort Lane, Suite 200, Dallas, Texas 75243-1099</small>			
JOB NO. 67515.001	DATE Nov 8 1995	DRAWN BY C.H.B.	CHECKED BY T.S.B.
CAD FILE KS-ROWPL.dgn	CAD DATE Nov 8 1995	SCALE 1" = 40'	SHEET 4 OF 14

NO.	DATE	DESCRIPTION	BY

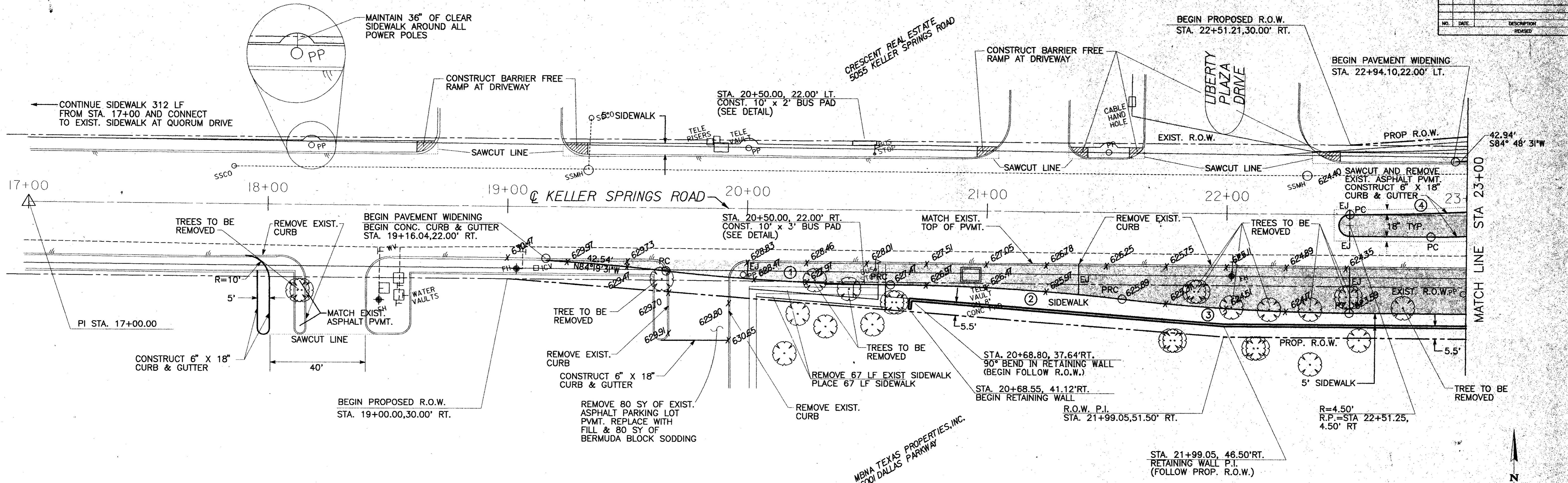

<p>CURVE DATA 1 PC STA 19+66.22, 26.11' RT. PI STA 20+31.42, 31.00' RT. PT STA 20+59.85, 31.00' RT. $\Delta=05^{\circ}58'17''$ R=900.00 L=93.80 T=46.94</p>	<p>CURVE DATA 2 PC STA 20+59.85, 31.00' RT. PI STA 21+08.33, 30.90' RT. PT STA 21+56.53, 36.00' RT. $\Delta=06^{\circ}09'58''$ R=900.00 L=96.86 T=48.48</p>	<p>CURVE DATA 3 PC STA 21+56.53, 36.00' RT. PI STA 22+03.77, 41.00' RT. PT STA 22+51.27, 41.00' RT. $\Delta=06^{\circ}02'32''$ R=900.00 L=94.91 T=47.50</p>	<p>CURVE DATA 4 PC STA 22+51.18, 22.00' LT. PI STA 22+94.10, 22.18' LT. PT STA 23+36.80, 26.45' LT. $\Delta=05^{\circ}27'37''$ R=900.00 L=85.77 T=42.92</p>
--	--	--	--

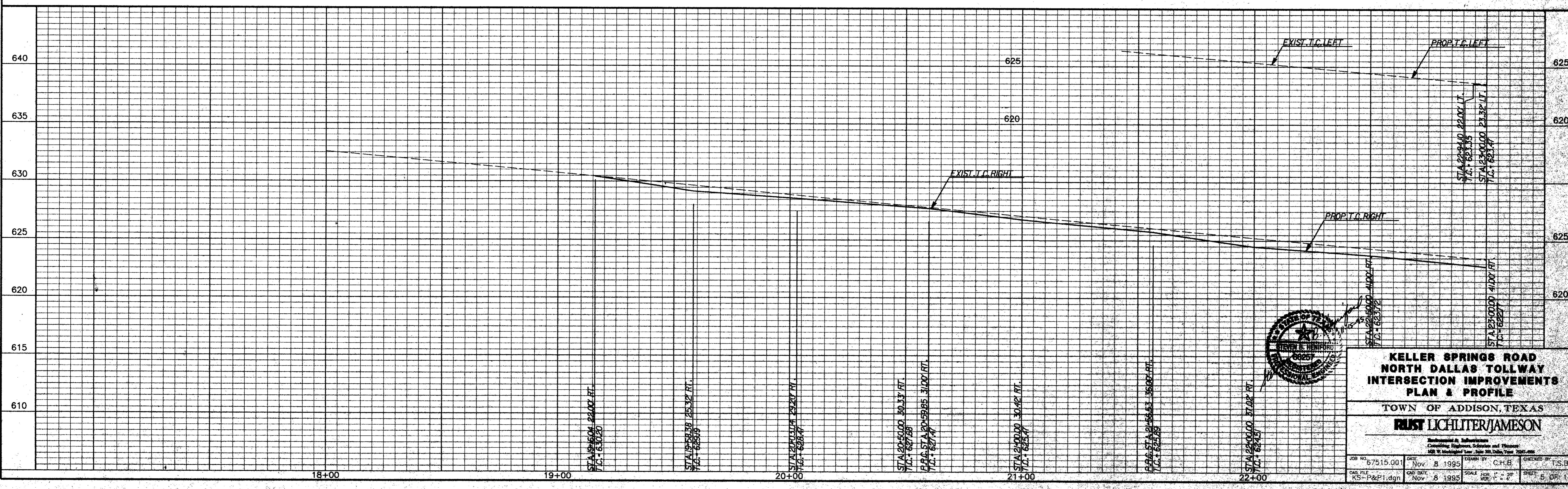
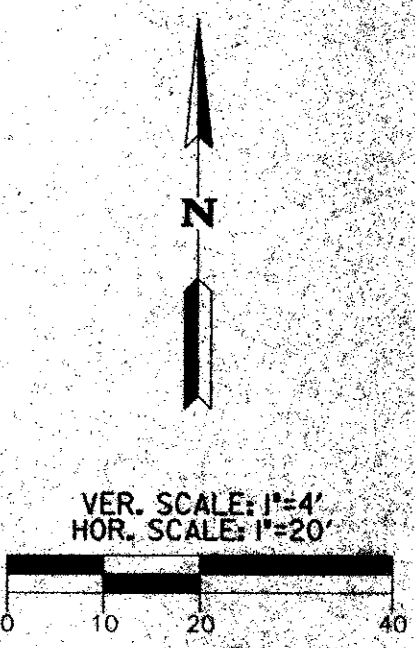

**KELLER SPRINGS ROAD
 NORTH DALLAS TOLLWAY
 INTERSECTION IMPROVEMENTS
 PLAN & PROFILE**

TOWN OF ADDISON, TEXAS

JUST LICHLITER/JAMESON

Professional Engineer
 Consulting Engineers, Architects and Planners
 100 W. Main Street, Suite 500, Dallas, Texas 75201

JOB NO. 67515.001	DATE Nov. 8 1995	DRAWN BY C.H.B.	CHECKED BY T.S.B.
CAD FILE KS-P&P1.dgn	CAD DATE Nov. 8 1995	SCALE HOR. 1"=20'	SHEET 6 OF 14

NO.	DATE	DESCRIPTION	BY

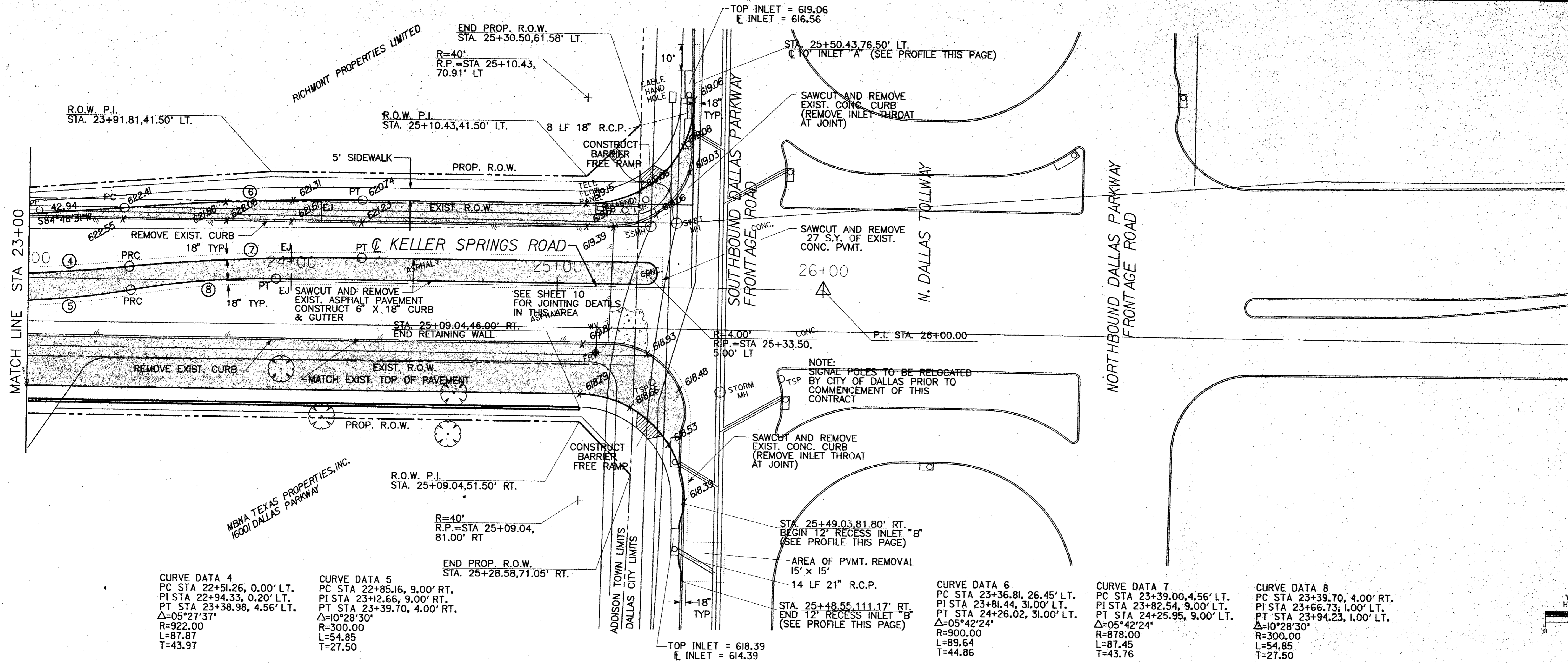

- CURVE DATA 4**
 PC STA 22+51.26, 0.00' LT.
 PI STA 22+94.33, 0.20' LT.
 PT STA 23+38.98, 4.56' LT.
 $\Delta=05^{\circ}27'37''$
 R=922.00
 L=87.87
 T=43.97
- CURVE DATA 5**
 PC STA 22+85.16, 9.00' RT.
 PI STA 23+12.66, 9.00' RT.
 PT STA 23+39.70, 4.00' RT.
 $\Delta=10^{\circ}28'30''$
 R=300.00
 L=54.85
 T=27.50
- CURVE DATA 6**
 PC STA 23+36.81, 26.45' LT.
 PI STA 23+81.44, 31.00' LT.
 PT STA 24+26.02, 31.00' LT.
 $\Delta=05^{\circ}42'24''$
 R=900.00
 L=89.64
 T=44.86
- CURVE DATA 7**
 PC STA 23+39.00, 4.56' LT.
 PI STA 23+82.54, 9.00' LT.
 PT STA 24+25.95, 9.00' LT.
 $\Delta=05^{\circ}42'24''$
 R=878.00
 L=87.45
 T=43.76
- CURVE DATA 8**
 PC STA 23+39.70, 4.00' RT.
 PI STA 23+66.73, 1.00' LT.
 PT STA 23+94.23, 1.00' LT.
 $\Delta=10^{\circ}28'30''$
 R=300.00
 L=54.85
 T=27.50

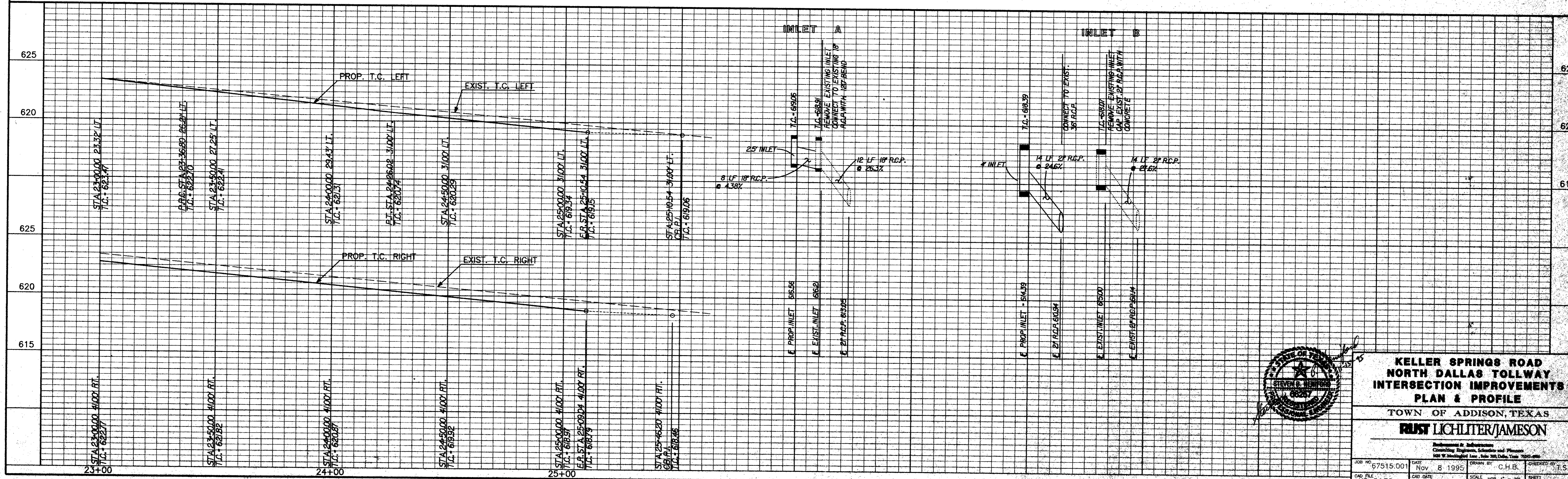
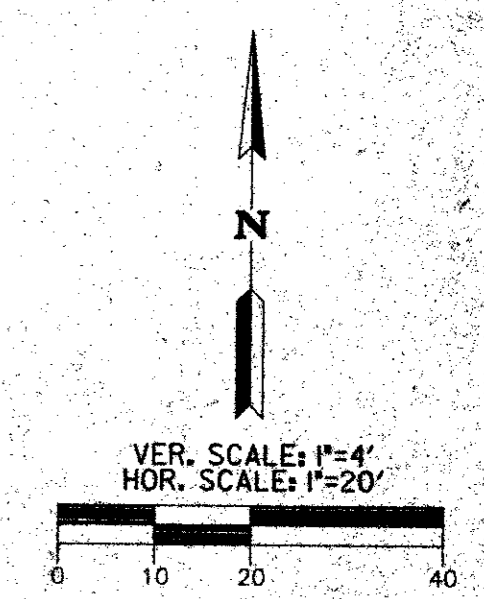

**KELLER SPRINGS ROAD
 NORTH DALLAS TOLLWAY
 INTERSECTION IMPROVEMENTS
 PLAN & PROFILE**
 TOWN OF ADDISON, TEXAS
RUST LICHLITER/JAMESON

Engineering & Architecture
 Consulting Engineers, Scientists and Planners
 1800 W. McPherson Ave., Suite 200, Dallas, Texas 75207-4900

JOB NO. 67515.001 DATE Nov 8 1995 DRAWN BY C.H.B. CHECKED BY T.S.B.
 CAD FILE KS-P&P2.dgn CAD DATE Nov 8 1995 SCALE 1" = 20' SHEET 6 OF 14

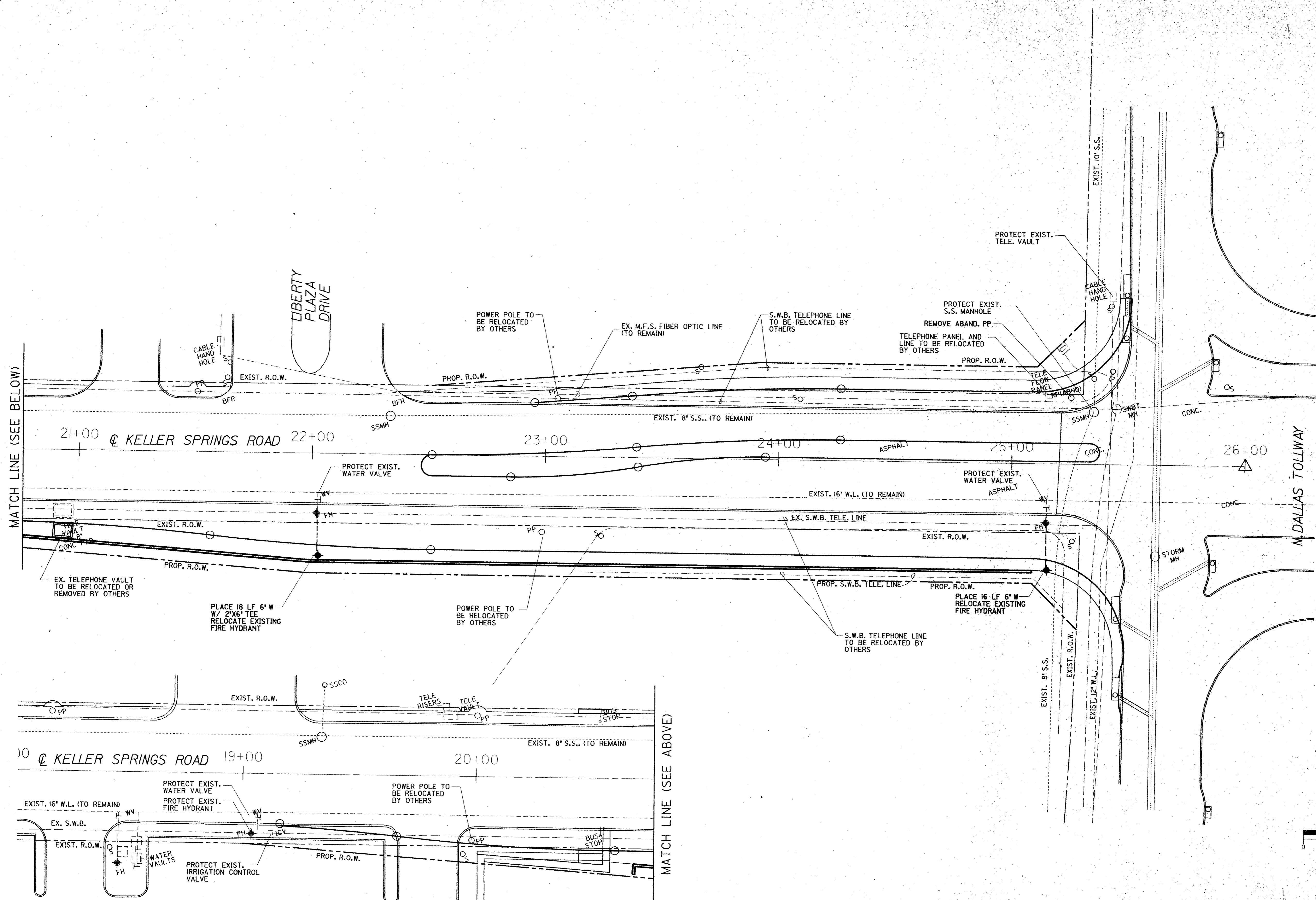

MATCH LINE (SEE BELOW)

MATCH LINE (SEE ABOVE)

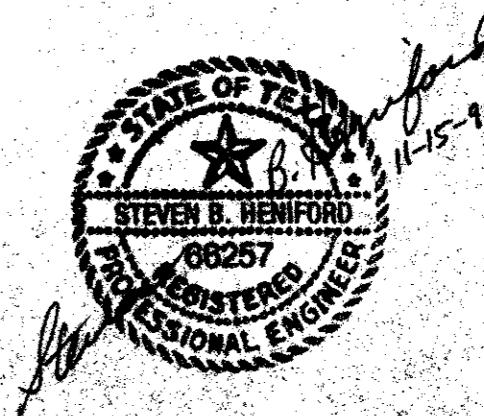
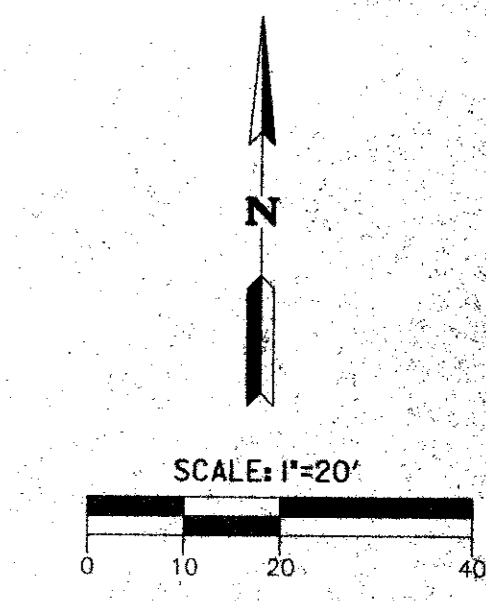

KELLER SPRINGS ROAD NORTH DALLAS TOLLWAY INTERSECTION IMPROVEMENTS UTILITY LAYOUT			
TOWN OF ADDISON, TEXAS			
RUST LICHLITER/JAMESON			
<small>Consulting Engineers, Scientists and Planners 400 W. Mockingbird Lane, Suite 500, Dallas, Texas 75245</small>			
JOB NO. 87515.001	DATE Nov. 8 1995	DRAWN BY C.H.B.	CHECKED BY T.S.B.
CAD FILE KS-UTIL.dgn	DATE Nov. 8 1995	SCALE 1" = 20'	SHEET 7 OF 14

KELLER SPRINGS ROAD

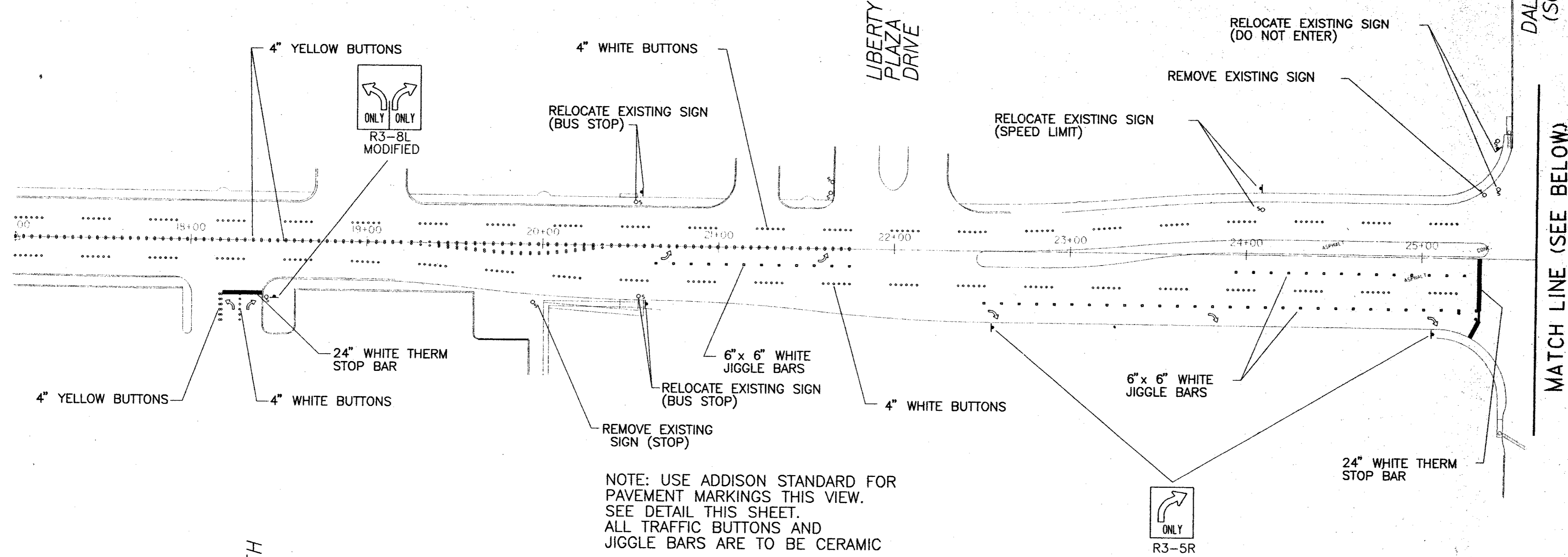

NOTE: USE ADDISON STANDARD FOR PAVEMENT MARKINGS THIS VIEW. SEE DETAIL THIS SHEET. ALL TRAFFIC BUTTONS AND JIGGLE BARS ARE TO BE CERAMIC

DALLAS NORTH TOLLWAY

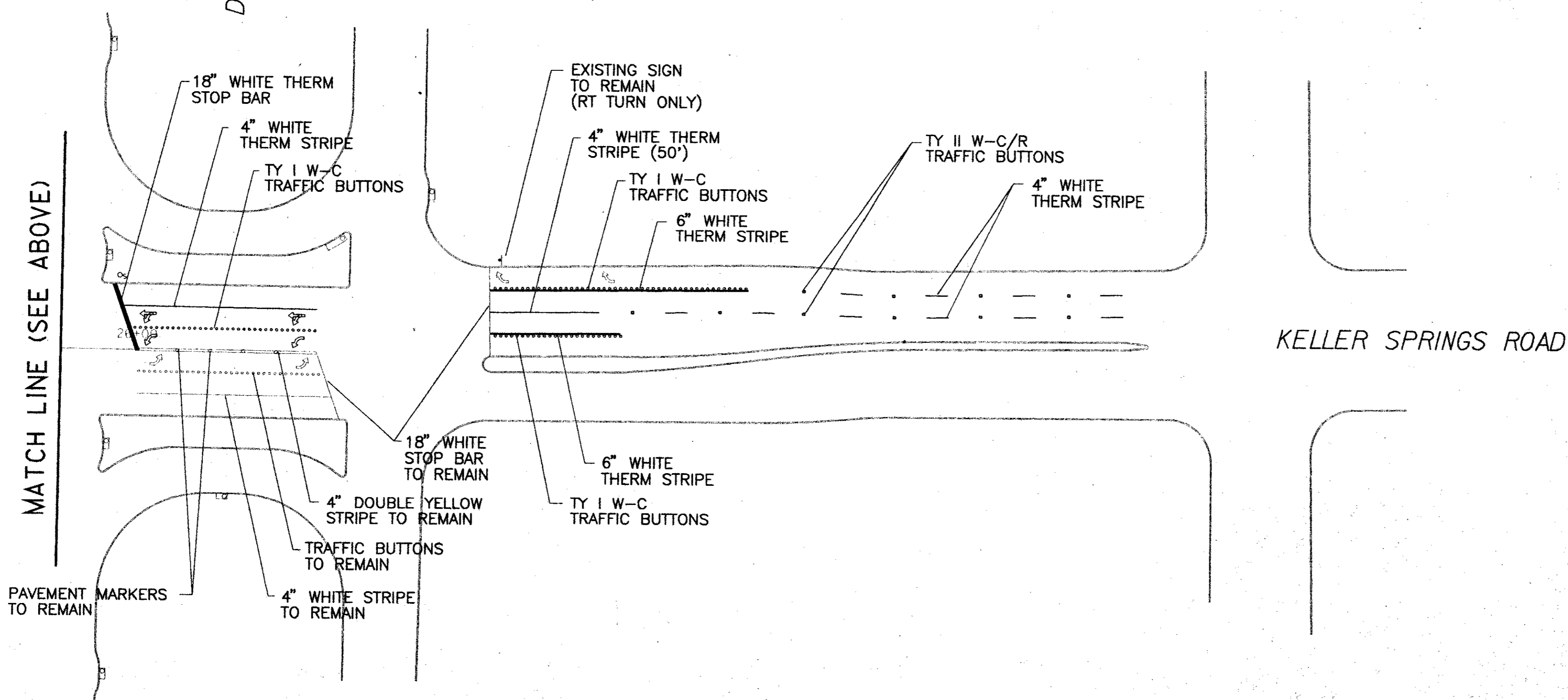

NOTE: USE DALLAS STANDARD FOR PAVEMENT MARKINGS THIS VIEW. SEE MISCELLANEOUS DETAILS SHEET.

DALLAS PARKWAY (SOUTHBOUND)

MATCH LINE (SEE BELOW)

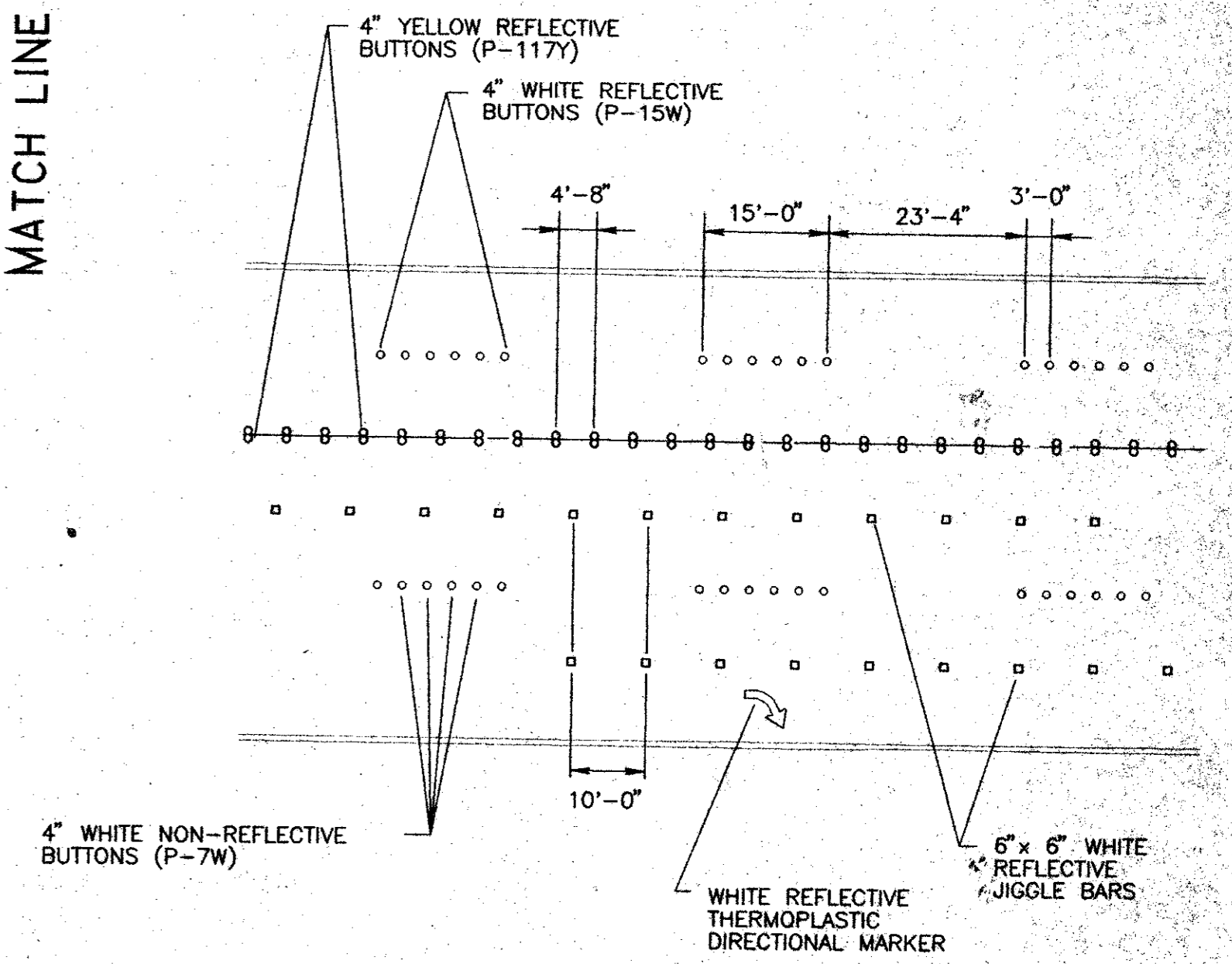

ADDISON PAVEMENT MARKING DETAIL (N.T.S.)

KELLER SPRINGS ROAD

MATCH LINE (SEE ABOVE)

PAVEMENT MARKERS TO REMAIN

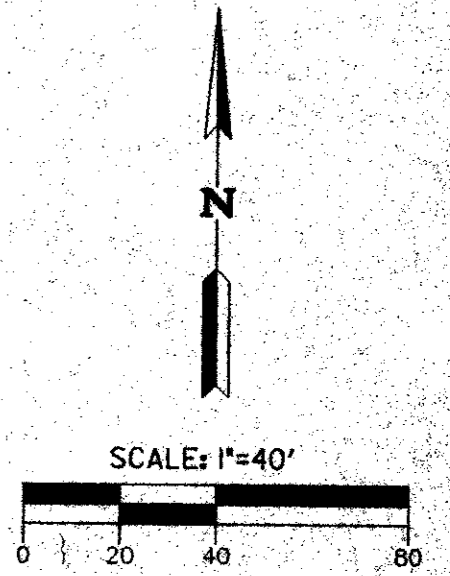
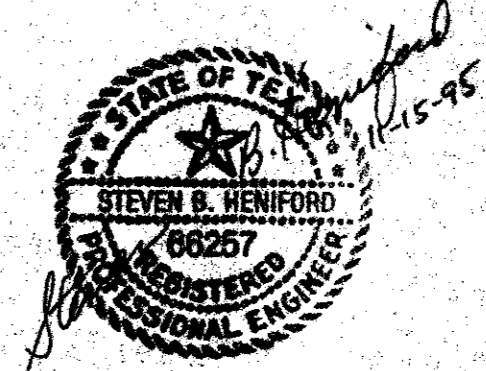

KELLER SPRINGS ROAD NORTH DALLAS TOLLWAY INTERSECTION IMPROVEMENTS SIGNING AND STRIPING PLAN			
TOWN OF ADDISON, TEXAS			
ROST LICHLITER/JAMESON			
<small>Professional Engineer Consulting Engineer, Surveyor and Planner 1407 W. Woodbridge Lane, Suite 200, Dallas, Texas 75201-2000</small>			
JOB NO: 87515-001	DATE: Nov 8 1995	DRAWN BY: C.H.B.	CHECKED BY: T.S.B.
CAD FILE: KS-STRP.dgn	SCALE: 1" = 40'	SHEET: 8 OF 14	

NO.	DATE	DESCRIPTION	BY

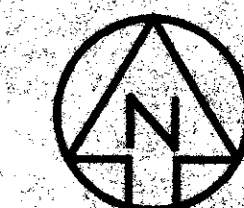

PLANT LIST

BOTANICAL NAME	COMMON NAME	QTY.	SIZE
TREES:			
QUERCUS SHUMARDII	SHUMARD RED OAK	22	5" CALIPER
ILEX X ATTENUATA 'FOSTERI'	FOSTER HOLLY	9	65 GALLON
SHRUBS:			
ILEX VOMITORIA NANA	DWARF YAUPON HOLLY	107	5 GALLON
JUNIPERUS SABINA TAMARISCIFOLIA	TAM JUNIPER	197	5 GALLON
GROUND COVER:			
SEASONAL COLOR	SEASONAL COLOR	250	4" POTS
LIRIOPE MUSCARI	GREEN LIRIOPE	450	4" POTS
TURF	SOLID SOD BERMUDA		

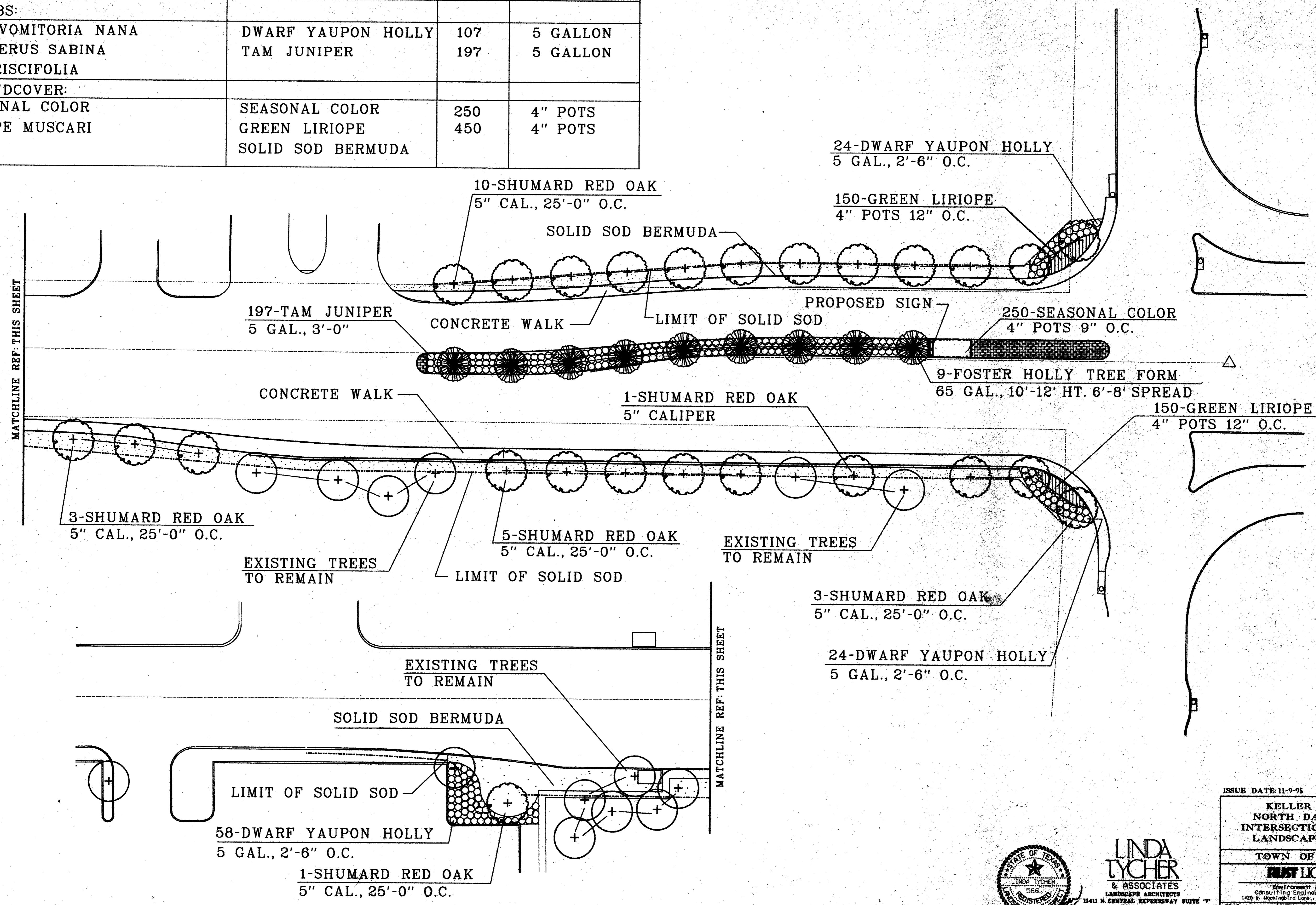

MATCHLINE REF. THIS SHEET

MATCHLINE REF. THIS SHEET

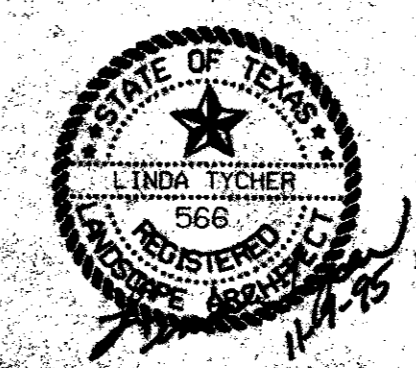

LINDA TYCHER & ASSOCIATES
 LANDSCAPE ARCHITECTS
 1420 W. Mockingbird Lane, Suite 300, Dallas, Texas 75247-4906
 DALLAS, TEXAS 75243
 PH: 214-750-1810 FAX: 214-381-0727

ISSUE DATE: 11-9-95			
KELLER SPRINGS ROAD NORTH DALLAS TOLLWAY INTERSECTION IMPROVEMENTS LANDSCAPE MASTER PLAN			
TOWN OF ADDISON, TEXAS			
RUST LICHTER/JAMESON			
<small>Environment & Infrastructure Consulting Engineers, Scientists and Planners</small>			
JOB NO. 67916.001	DATE 8-22-95	DRAWN BY JB	CHECKED BY LT
CAD FILE	CAD DATE	SCALE 1" = 20'-0"	SHEET 1 OF 3

NO.	DATE	DESCRIPTION	BY

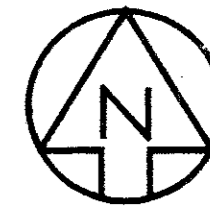

IRRIGATION NOTES

1. LINE LAYOUT IS DIAGRAMMATIC - ADJUST HEAD AND LINE LOCATIONS ON SITE TO ACCOMMODATE EXISTING JOB CONDITIONS AND TO ACHIEVE COMPLETE COVERAGE.
2. ALL MAIN LINE PIPING SHALL BE BURIED TO HAVE A MINIMUM COVER OF 18". ALL LATERAL PIPING DOWNSTREAM OF THE MAIN LINE SHALL BE BURIED TO HAVE A MINIMUM COVER OF 12".
3. ALL MAINS ARE TO DRAIN TO LOW POINTS AT A MINIMUM ONE HALF (1/2%) PERCENT SLOPE. AT LOW POINTS, INSTALL GATE VALVE TO FACILITATE DRAINAGE OF SYSTEM DURING FREEZING TEMPERATURES.
4. CONTRACTOR SHALL MAKE MINOR ADJUSTMENTS TO SYSTEM LAYOUT IN THE FIELD TO INSURE POSITIVE DRAINAGE OF MAINS AND LATERALS.
5. CONTRACTOR SHALL INSTALL AUTOMATIC DRAIN VALVES AT LOW POINTS IN THE IRRIGATION LINES AS REQUIRED TO PREVENT FREEZE DAMAGE.
6. ALL VALVE BOXES SHALL BE BLACK IN COLOR (BODY AND LID). SIZES SHALL BE TEN (10) INCHES BY FIFTEEN (15) INCHES (RECTANGULAR) FOR REMOTE CONTROL VALVES AND NINE (9) INCHES (ROUND) FOR GATE AND QUICK COUPLER VALVES.
7. CONTRACTOR SHALL NOTIFY THE LANDSCAPE ARCHITECT, IF THE STATIC PRESSURE IS LESS THAN THE DESIGN STATIC PRESSURE OF 80PSI.
8. ALL WIRING FROM THE IRRIGATION CONTROLLER TO THE REMOTE CONTROL VALVES SHALL BE #14 DIRECT BURIAL CABLE. ALL WIRE SPLICES SHALL BE MADE IN 1" ROUND VALVE BOXES AND Y USING KING CONNECTORS AND SEALANT. PROVIDE SLEEVES FOR WIRE UNDER PAVED AREAS AS REQUIRED.
9. ALL IRRIGATION INSTALLATION SHALL CONFORM TO THE LOCAL CODES AND REGULATIONS.
10. PLACE 4 EXTRA 14 GA WIRES (DIFFERENT COLORS) FROM CONTROLLER TO A VALVE BOX ADJACENT TO DOUBLE CHECK VALVE ASSEMBLY FOR CENTRAL CONTROL INSTALLATION AT A LATER DATE (VERIFY WITH THE TOWN OF ADDISON'S CONSTRUCTION REPRESENTATIVE).
11. USE CLEAN AND APPROVED LOAM TO BACKFILL ALL PIPE TO A DEPTH OF AT LEAST 6" ABOVE TOP OF PIPE. ALL HEADS AND BOXES ARE TO BE BACKFILLED TO GRADE WITH LOAM. REMAINDER OF TRENCH MAY BE FILLED USING CLEAN AND APPROVED SOIL. NO ROCKS GREATER THAN 1" ARE ALLOWED. COMPACT TRENCHES TO ALEVATE SETTLING.
12. USE APPROPRIATE AND APPROVED PVC SOLVENT. AVOID EXCESSIVE USE AND WIPE ALL JOINTS AND FITTINGS CLEAN.
13. THE INSTALLER IS RESPONSIBLE FOR RESETTING HEAD AND/OR BOX HEIGHT DUE TO SETTLING. CONTRACTOR MUST OBTAIN A WORKMANSHIP WARRANTY FOR (1) ONE YEAR FROM DATE OF COMPLETION.
14. ALL WORK IS TO BE ACCOMPLISHED BY OR DIRECTLY SUPERVISED BY AN ON-SITE IRRIGATOR LICENSED BY THE STATE OF TEXAS.
15. PRIOR TO ANY BACKFILLING OF TRENCHES, AN INSPECTION BY THE TOWN OF ADDISON'S REPRESENTATIVE MUST TAKE PLACE AND IMPLEMENT ANY NECESSARY CHANGES.
16. ALL INSTALLATION AND EQUIPMENT SHALL BE CONSISTENT WITH THE TOWN OF ADDISON SPECIFICATIONS (VERIFY WITH TOWN OF ADDISON CONSTRUCTION REPRESENTATIVE).

IRRIGATION LEGEND

- ▲ TOROMAR DIE POP-UP SHRUB SPRAY HARDIE HSN-7 1/2" FULL NOZZLE ON A TORO #4P SI BODY (1.86 GPM)
- △ TORO POP-UP SHRUB SPRAY 570Z SERIES MP1 1/2" FULL HALF, & QUARTER NOZZLE ON A #12P SI BODY (2.19, 1.09, .5 GPM)
- ▲ TORO SHRUB SPRAY 570Z SERIES MP1 1/2" FULL HALF, & QUARTER NOZZLE ON A 1/2" COPPER RISER WITH 570 SHRUB ADAPTER (2.19, 1.09, .5 GPM)
- ⊕ WEATHERMATIC WITH FLOW CONTROL 6000 SERIES ELECTRIC REMOTE CONTROL VALVE
- SCHEDULE 40 PVC MAINLINE
- CLASS 200 PVC LATERAL LINE, EXCEPT 1/2 INCH DIAMETER SHALL BE CLASS 315. NOTE: ALL DIRECTLY BURIED LINE BENEATH PAVING SHALL BE SCHEDULE 40 PVC
- ⊕ GPM THROUGH VALVE
- ⊕ VALVE SEQUENCING NUMBER
- ⊕ SIZE OF VALVE
- ⊕ MANUAL GATE VALVE - LINE SIZE
- ⊕ ELECTRIC CONTROLLER MANUFACTURER AND MODEL AS SHOWN ON PLAN
- PVC SLEEVE (EXISTING - U.N.C.)
- ⊕ FREEZE SENSOR PENN A-15ANC
- ⊕ MOISTURE SENSOR (REUSE EXISTING)
- ⊕ 1/2" IRRIGATION WATER METER & TAPPING SLEEVE (EXISTING)
- ⊕ FERCO DOUBLE CHECK VALVE 1/2" 8005 Y IN FLUSH CONCRETE VALVE BOX (EXISTING)

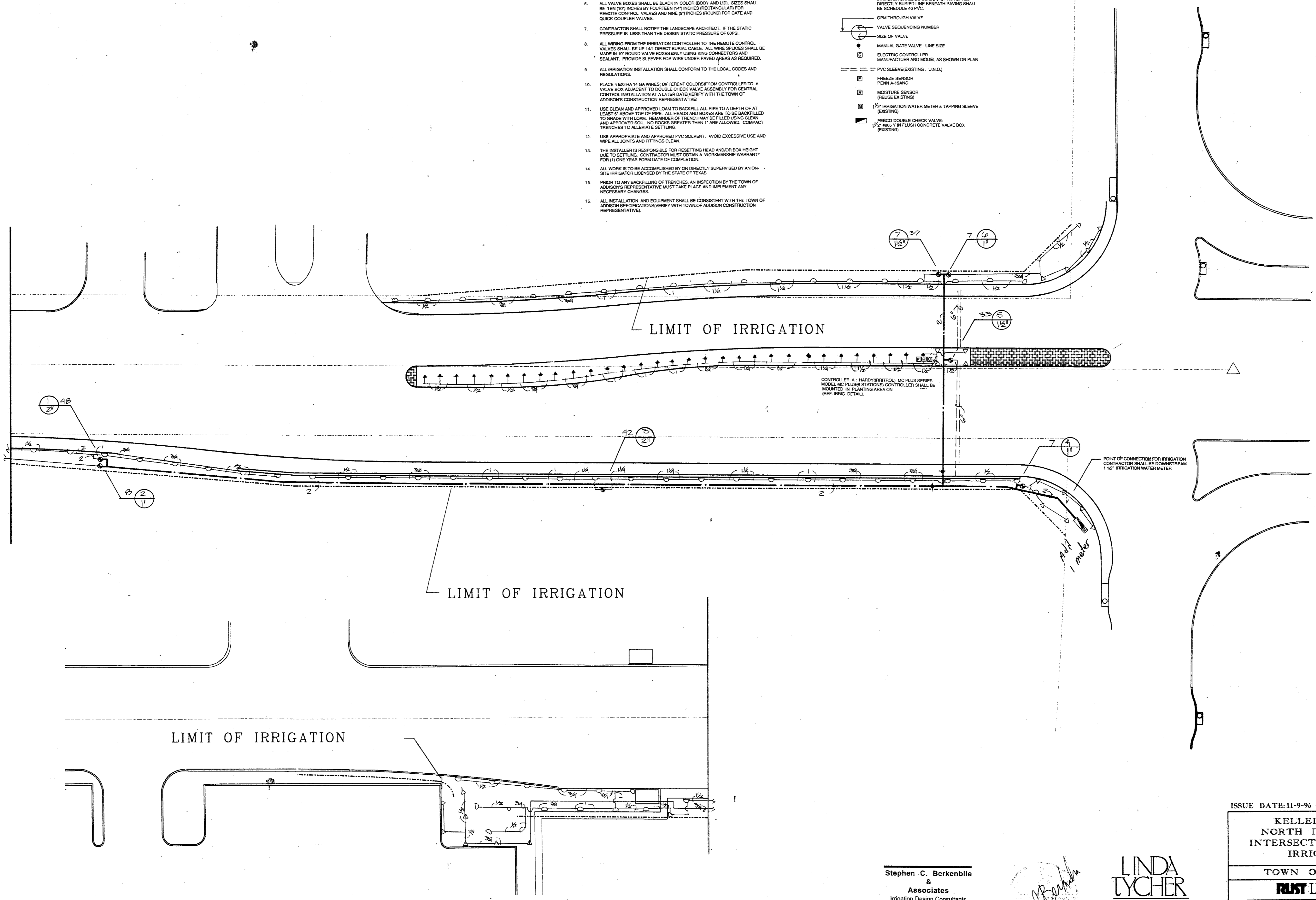

Stephen C. Berkenbile
 & Associates
 Irrigation Design Consultants
 411 Hyde Park Place
 Duncanville, Texas 75117
 (214) 296-2724 Fax (214) 296-2724

Stephen C. Berkenbile

LINDA
 TYCHER
 & ASSOCIATES
 LANDSCAPE ARCHITECTS
 11411 N. CENTRAL EXPRESSWAY SUITE "V"
 DALLAS, TEXAS 75243
 PH: 214-750-1210 FAX: 214-381-8727

ISSUE DATE: 11-9-95

KELLER SPRINGS ROAD
 NORTH DALLAS TOLLWAY
 INTERSECTION IMPROVEMENTS
 IRRIGATION PLAN

TOWN OF ADDISON, TEXAS

JUST LICHLITER/JAMESON
 Environment & Infrastructure
 Consulting Engineers, Scientists and Planners
 1420 W. Mockingbird Lane, Suite 300, Dallas, Texas 75247-4906

JOB NO. 67515-001	DATE	DRAWN BY	CHECKED BY
CAD FILE	CAD DATE	SCALE	SHEET

KELLER SPRINGS @ DALLAS PARKWAY IRRIGATION 11/95