

TBM - " " cut on S.E. top curb corner, the back side parking lot, Building 15950 Midway Road. Elevation 637.75

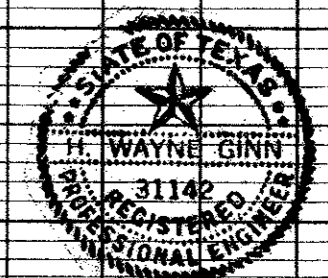
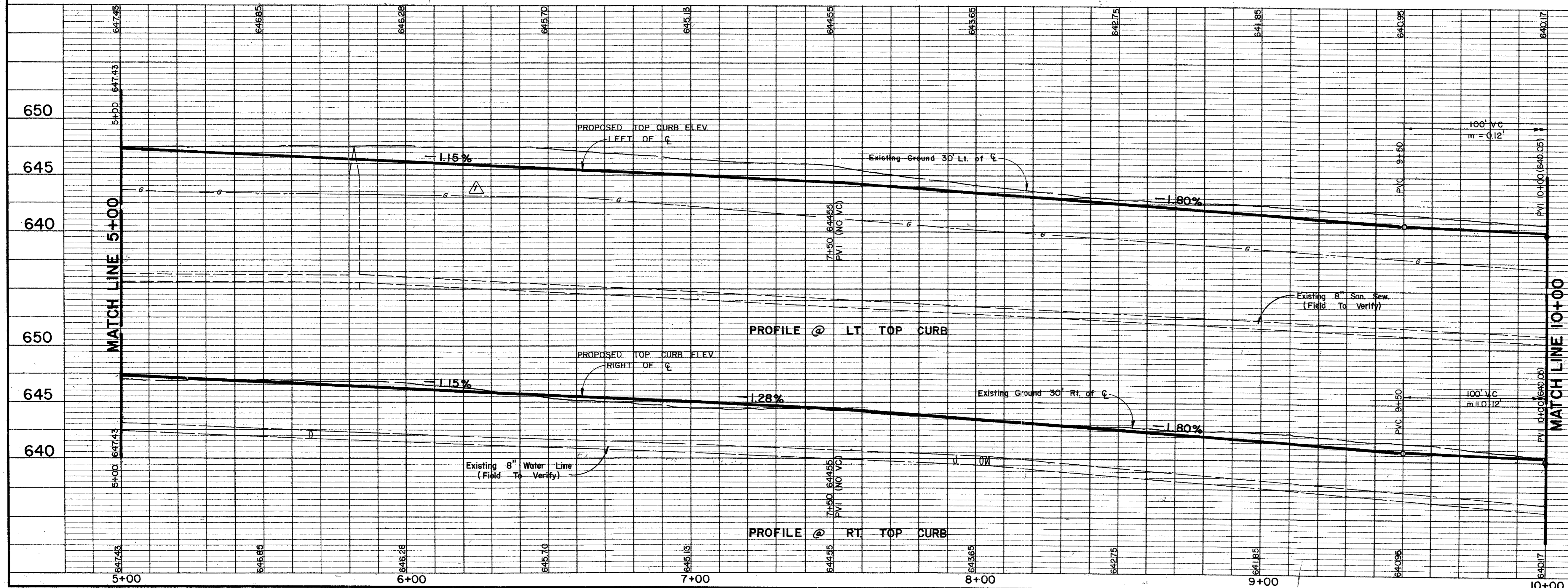

Added Exist. Gas Line Location		RLG	8/18/86
No.	Revision	By	Date
TOWN OF ADDISON DALLAS COUNTY, TEXAS			
KELLER SPRINGS/DOOLEY RD. IMPROVEMENTS			
DOOLEY ROAD		PLAN & PROFILE	
PAVING STA 5+00 TO 10+00			
GINN, INC.			
Consulting Engineers Dallas, Texas			
Designed - GF/JK	Drawn - R.L.O.	Date - DECEMBER, 1985	Job No. - 263
Approved - HWG	Checked - JCK	Scale - 1"=20'H/1"=5'V	Sheet 5 Of 30