

Addison Airport

FBM - " " cut on N.W. top curb, corner of parking lot, Building 15950 Midway Road, Elevation 634.57

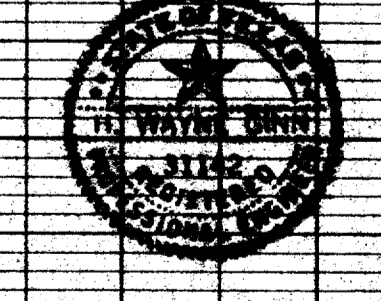
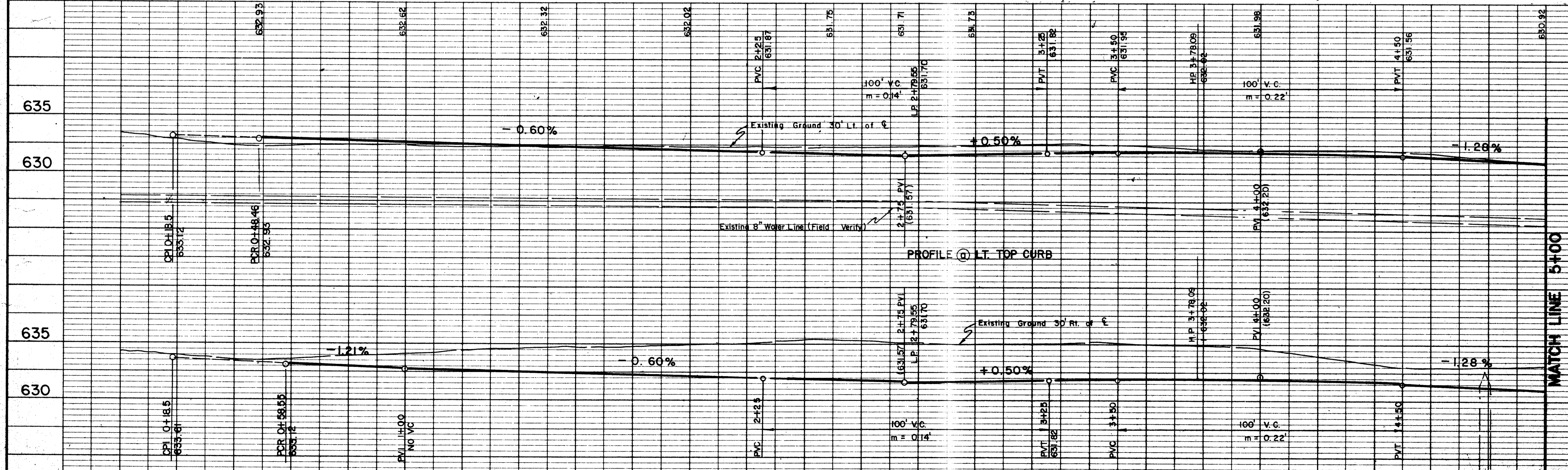

No.	Revision	By	Date
TOWN OF ADDISON DALLAS COUNTY, TEXAS			
KELLER SPRINGS/DOOLEY RD. IMPROVEMENTS			
DOOLEY RD. NORTH			
STA. 0+00 TO 5+00			
GINN, INC.			
Consulting Engineers Dallas, Texas			
Designed - GJ/HK	Drawn - RLO	Date - DECEMBER, 1985	Job No. - 289
Approved - MMB	Checked - JCK	Scale - 1"=20'H/1"=5'V	Sheet 9 of 30