

CITY OF CARROLLTON
VOL 92074
Pg 1163

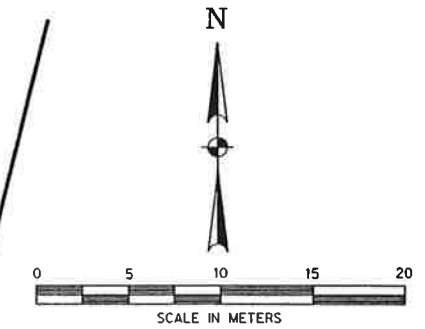
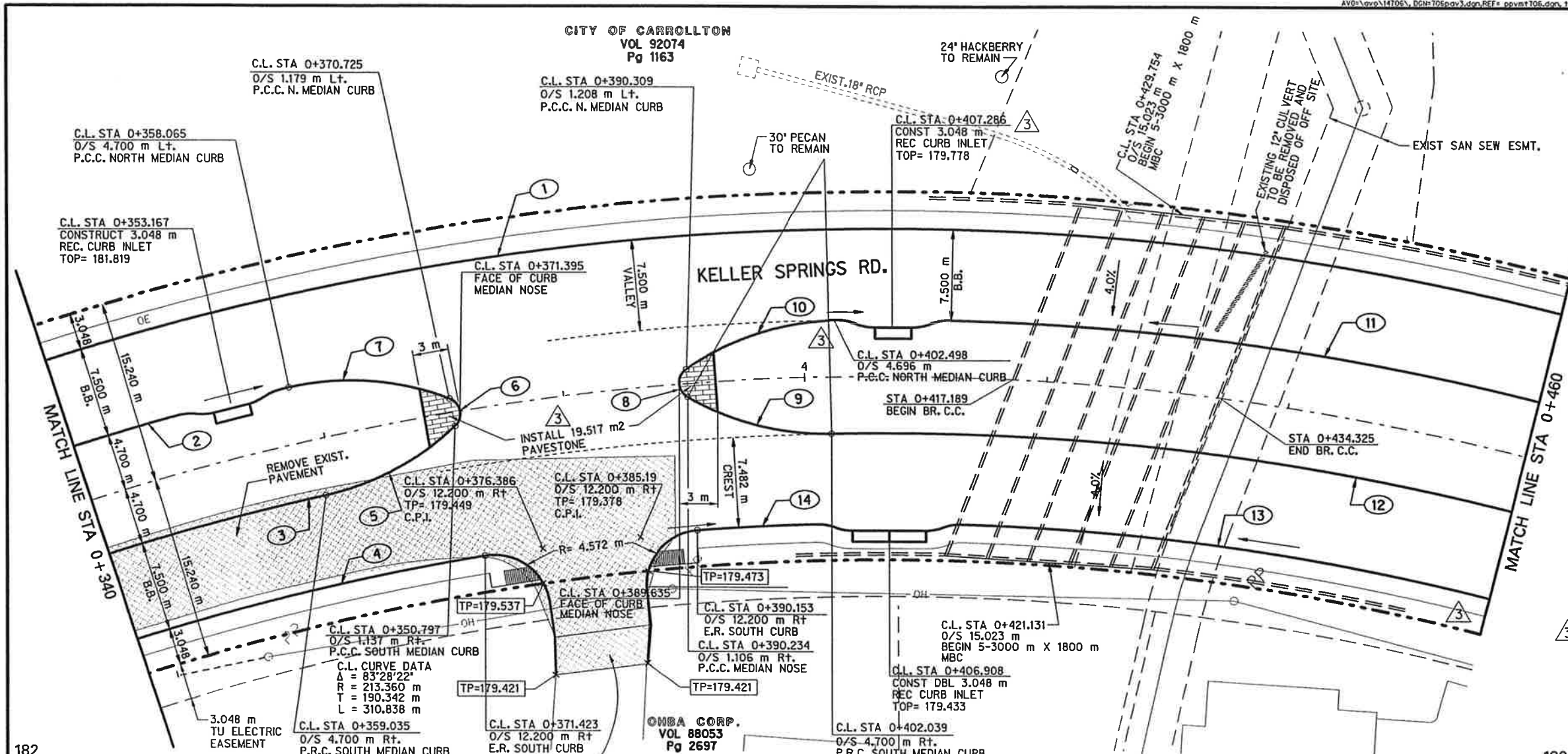

CURVE DATA				
CV.	Δ	R	T	L
1	70°08'47"	225.56m	158.36m	276.15m
2	11°55'58"	218.06m	22.78m	45.41m
3	10°25'54"	208.66m	19.05m	37.98m
4	21°00'26"	201.16m	37.29m	73.75m
5	30°59'21"	22.70m	6.29m	12.28m
6	115°11'42"	1.37m	2.16m	2.75m
7	34°04'35"	22.70m	6.95m	13.50m
8	115°12'40"	1.37m	2.16m	2.75m
9	31°08'08"	22.70m	6.32m	12.33m
10	32°51'08"	22.70m	6.69m	13.01m
11	23°17'41"	218.06m	44.94m	88.65m
12	17°49'30"	208.66m	32.72m	64.91m
13	33°00'30"	201.16m	59.60m	115.88m
14	2°47'30"	201.16m	4.90m	9.80m

CHANGE ORDER NO. 3
MAY 22, 1998 -
OMIT LEFT TURN LANE
ADJUST CURB INLET
OMIT DRIVEWAY AT 0+463 RT
EDIT CURVE DATA TABLE

5/22/98

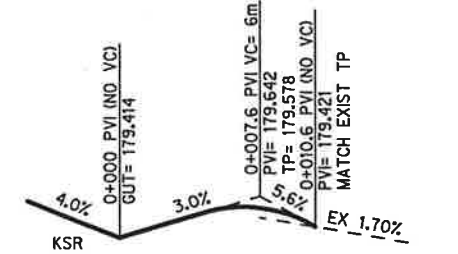
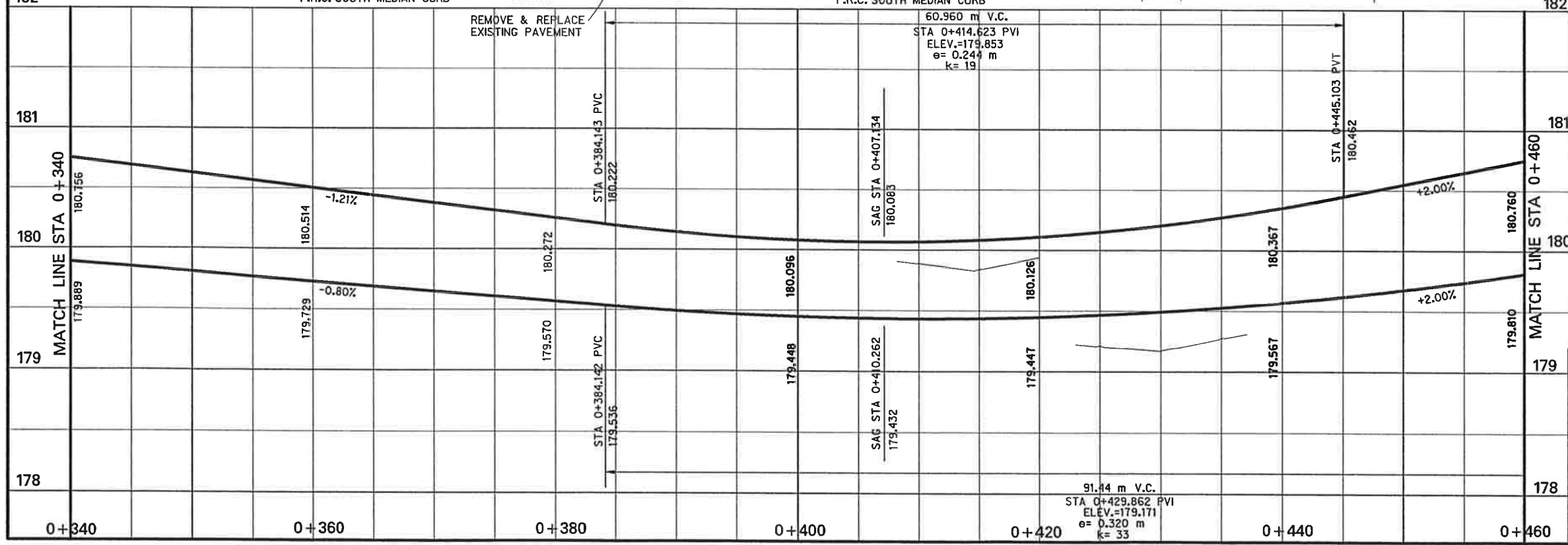

PROFILE OF DRIVEWAY AT
C.L. STA 0+380.789 RT

PAVEMENT REMOVAL, TYPICAL

PAVING PLAN / PROFILE
STA 0+340 TO STA 0+460
KELLER SPRINGS ROAD
DALLAS COUNTY, TEXAS
TEXAS DEPARTMENT OF TRANSPORTATION

Half Associates
ENGINEERS, ARCHITECTS, SCIENTISTS, PLANNERS, SURVEYORS

DESIGN	DRAWN	NOTES	STATE	FEDERAL AID PROJECT NO.	SHEET NO.
			TEXAS	STP NO. 1000 I&M	
DATE	FILE	SCALE	COUNTY	SECTION NO.	JOB NO.
JULY 1998	709P493	1:200 HORIZ 1:30 VERT	DALLAS	09B	46 222