

TARPLEY ROAD
C.L. CURVE DATA
Δ = 43°30'35"
R = 120.00'
T = 47.89'
L = 91.13'

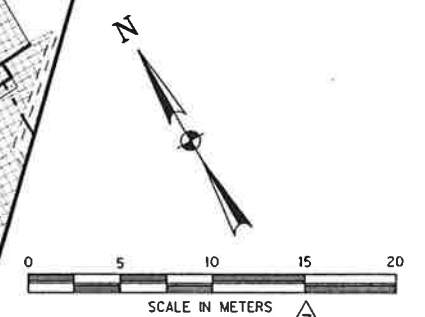
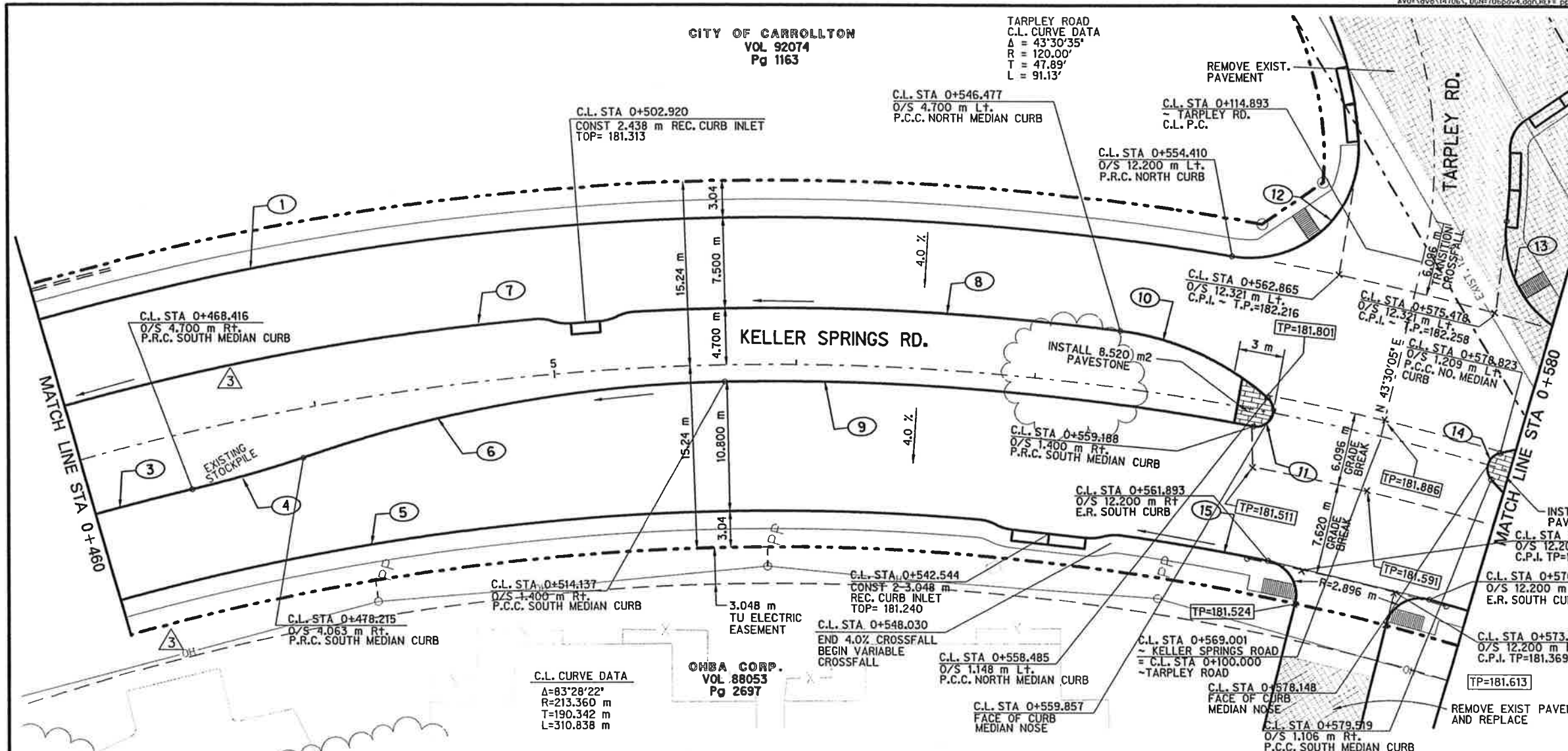

CURVE DATA				
CV.	Δ	R	T	L
1	70°08'47"	225.56m	158.36m	276.15m
3	17°49'30"	208.66m	32.72m	64.91m
4	4°55'19"	112.00m	4.81m	9.62m
5	33°00'30"	201.16m	59.60m	115.88m
6	18°12'51"	112.20m	17.98m	35.66m
7	23°17'41"	218.06m	44.94m	88.65m
8	10°34'53"	218.06m	20.19m	40.27m
9	11°54'34"	211.96m	22.10m	44.05m
10	34°13'29"	22.70m	6.99m	13.56m
11	149°00'00"	1.37m	4.94m	3.56m
12	101°41'08"	8.99m	11.04m	15.95m
13	79°51'28"	8.99m	7.52m	12.53m
14	115°11'02"	1.37m	2.16m	2.75m
15	3°29'18"	201.16m	6.12m	12.24m

C.L. CURVE DATA
Δ=83°28'22"
R=213.360 m
T=190.342 m
L=310.838 m

CHBA CORP.
VOL 88053
Pg 2697

CHANGE ORDER NO. 3
MAY 22, 1998
OMIT LEFT TURN LANE
OMIT DRIVEWAY AT 0+463 RT
EDIT CURVE DATA TABLE

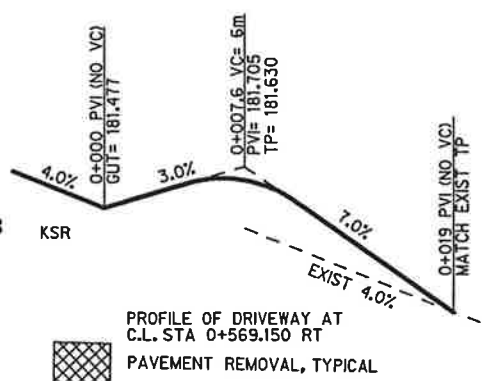
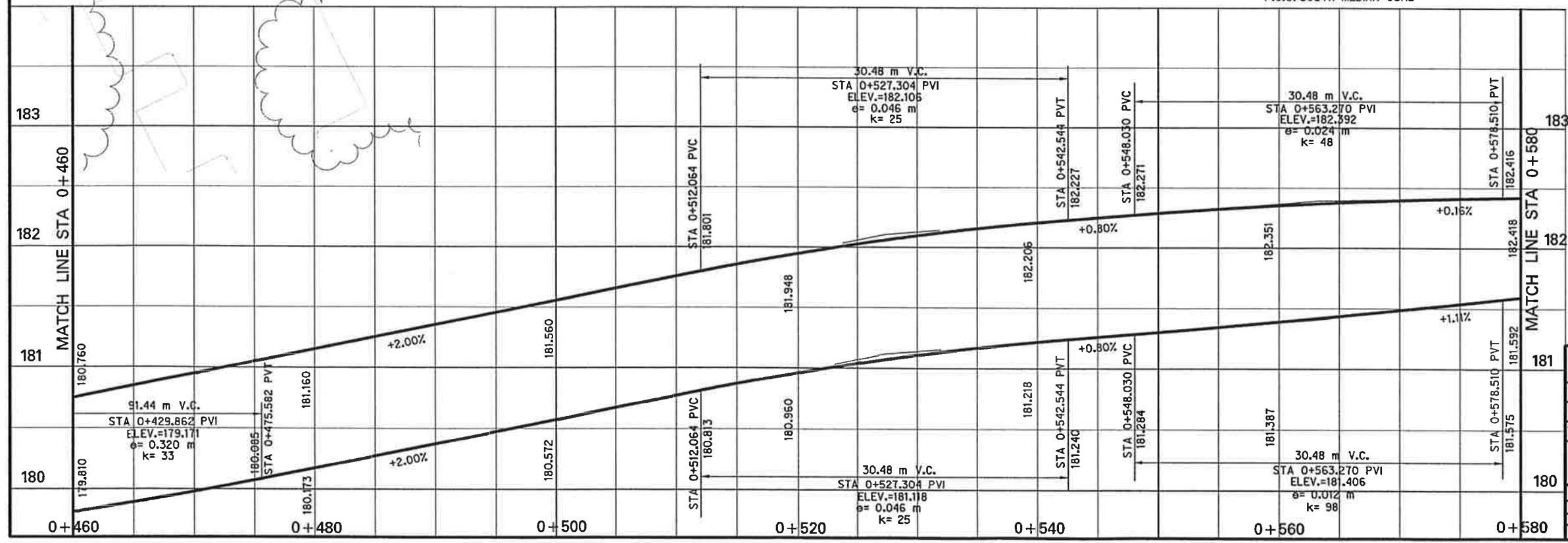

PAVING PLAN / PROFILE STA 0+460 TO STA 0+580 KELLER SPRINGS ROAD DALLAS COUNTY, TEXAS TEXAS DEPARTMENT OF TRANSPORTATION									
Half Associates ENGINEERS - ARCHITECTS - SCIENTISTS - PLANNERS - SURVEYORS									
DESIGN	DRAWN	NOTES	FED. NO. 100	STATE	FEDERAL AID PROJECT NO.	SHEET NO.			
DATE	FILE	SCALE	STATE	COUNTY	SECTION NO.	JOB NO.		HIGHWAY NO.	
APR 98	708PVA4	1:30 HORIZ 1:20 VERT	TX	DALLAS	09B	46	222	CS	