

CONCRETE RIPRAP

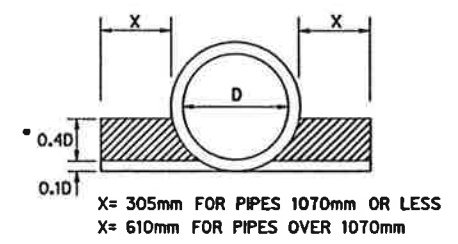

CEMENT STABILIZED BACKFILL FOR STORM SEWERS ON SLOPES GREATER THAN 8%

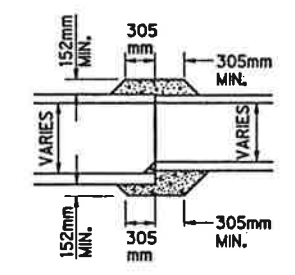

CONCRETE COLLAR FOR PIPE CONNECTION

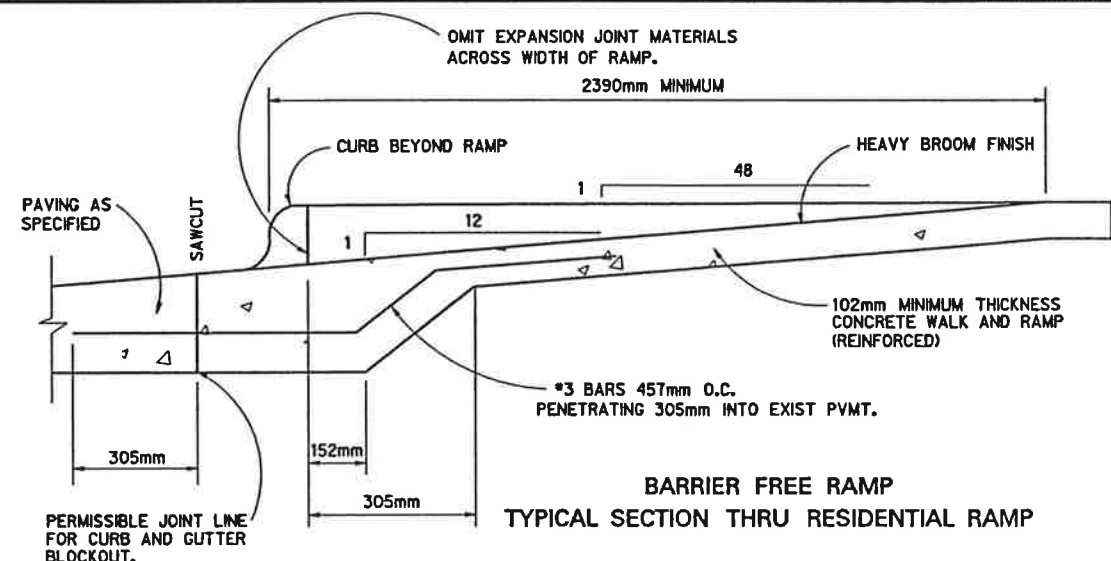

BARRIER FREE RAMP TYPICAL SECTION THRU RESIDENTIAL RAMP

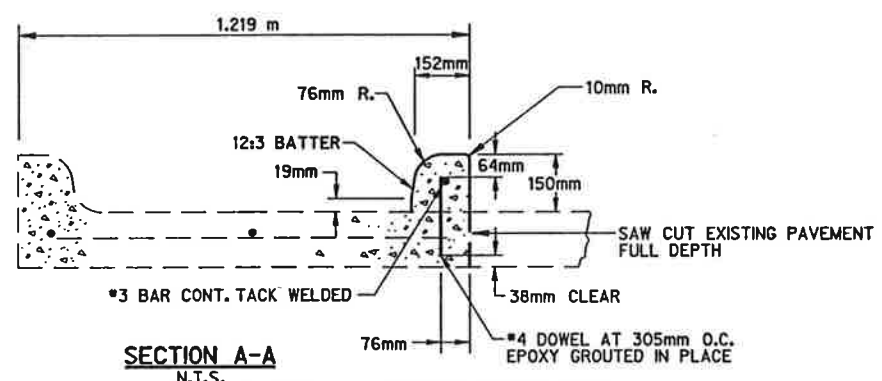

SECTION A-A N.T.S. CONCRETE FLUME DETAIL

NOTE FOR DOWELED CURB: COAT EXIST. PAVEMENT WITH EPOXY BONDING AGENT BEFORE POURING CURB

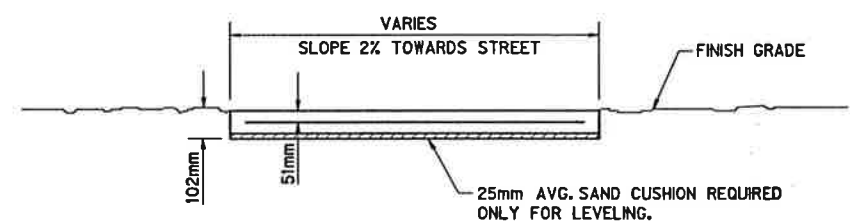

TYPICAL SIDEWALK SECTION

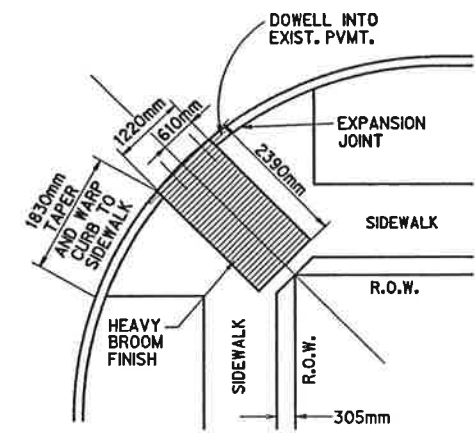

BARRIER FREE RAMP STREET INTERSECTION PLAN VIEW

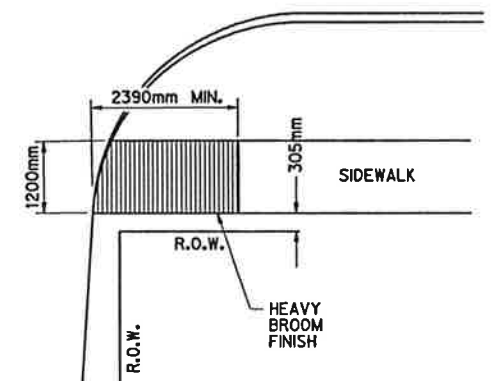

BARRIER FREE RAMP RESIDENTIAL ALLEY & DRIVEWAY INTERSECTION PLAN VIEW

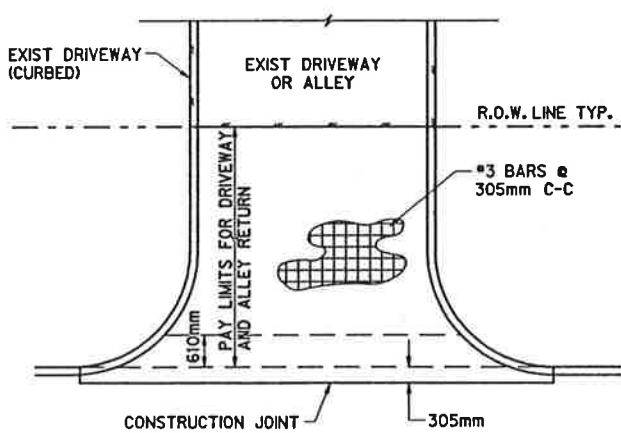

DRIVEWAY AND STREET RETURNS PLAN VIEW

DRIVEWAY NOTES:

1. DRIVEWAY LOCATIONS MAY BE SHIFTED AT TIME OF CONSTRUCTION AS DIRECTED BY THE ENGINEER TO MATCH EXISTING CONDITIONS.
2. OMT PAYMENT FOR CURB WITHIN LIMITS OF DRIVEWAY. CURBS ON DRIVEWAYS SHALL BE CONSIDERED SUBSIDIARY TO THE PRICE BID PER SQUARE YARD FOR DRIVEWAY AND WILL NOT BE PAID FOR DIRECTLY.

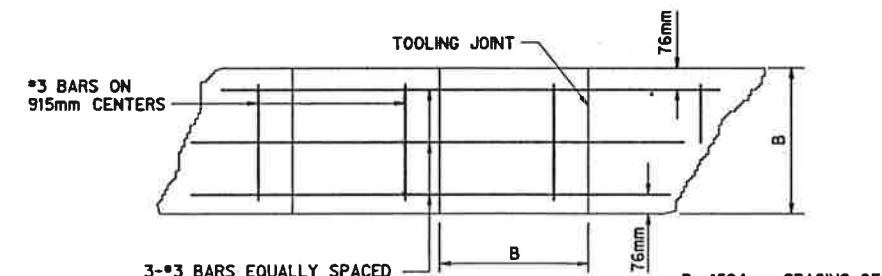

TYPICAL SIDEWALK MARKING

SIDEWALK NOTES:

1. ALL MARKINGS SHALL BE CUT 25mm DEEP, FOLLOWED BY GROOVING TOOL. 13mm PREMOLDED EXPANSION JOINT MATERIAL SHALL BE PLACED WHERE NEW WORK ABUTS OLD OR NEW WORK IS ADJACENT TO OTHER CONCRETE WORK, WALL, FOUNDATIONS, CURBS, ETC... MAXIMUM SPACING OF TRANSVERSE EXPANSION JOINTS SHALL BE 12.192 m.
2. CONCRETE STRENGTH SHALL BE A MINIMUM OF 3000 P.S.I. AT 28 DAYS.
3. EXPANSION JOINTS SHALL BE 13mm THICK REDWOOD FOR FULL DEPTH OF SIDEWALK AND SHALL INCLUDE GREASED 610mm SMOOTH 13mm DIA. DOWEL STEEL BARS WITH CAPS.

RAMP NOTES:

- BARRIER FREE RAMPS SHALL BE CONSTRUCTED AS EXTENSIONS OF STANDARD CONCRETE SIDEWALKS EXCEPT AS NOTED IN THESE DETAILS.
- MAXIMUM SLOPE ON BARRIER FREE RAMPS SHALL NOT EXCEED 8.0% AT ANY LOCATION.
- DESIGNS SHOWN ARE FOR 150mm CURBS. FOR CURBS WITH HEIGHT GREATER THAN 150mm, DIMENSIONS SHALL BE INCREASED PROPORTIONATELY.
- STREETS ON STEEP GRADE WILL REQUIRE LONGER TRANSITIONS ON UPGRADE SIDE.
- LOCATION OF BARRIER FREE RAMP MAY BE SHIFTED TO CLEAR OBSTRUCTIONS WITH THE APPROVAL OF THE CITY ENGINEER.

M.E. ROMANOWSKI
7/7/97

MISCELLANEOUS DETAILS									
KELLER SPRINGS ROAD									
DALLAS COUNTY, TEXAS									
TEXAS DEPARTMENT OF TRANSPORTATION									
Half Associates									
ENGINEERS, ARCHITECTS, SCIENTISTS, PLANNERS, SURVEYORS									
DESIGN	DRAWN	NOTED	FED. PROJ. NO.	STATE	FEDERAL AID PROJECT NO.	SHEET NO.			
CADD			NO.	TEXAS		1			
DATE	FILE	SCALE	STATE DIST. NO.	COUNTY	CONTROL NO.	SECTION NO.	JOB NO.	HIGHWAY NO.	
JULY 1997	70MBBC	N.T.S.	18	DALLAS	019	48	222	CS	