

# NORTH TEXAS TOLLWAY AUTHORITY

## CONTRACT NO. DNT-260

# SIGNING, PAVEMENT MARKING, AND ILLUMINATION PLANS

SECTION XIII

VOL. 4

# ADDISON AIRPORT TUNNEL

STANDARD DRAWINGS

SHEET NO.	NTTA STANDARDS
27	CANTILEVER OVERHEAD SIGN SUPPORTS (STD. NO. SS-23)
28	CANTILEVER OVERHEAD SIGN SUPPORT DETAILS (STD. NO. SS-24)
29	CANTILEVER OVERHEAD SIGN SUPPORT FOUNDATION (STD. NO. SS-25)
30	SIGN LIGHTING (ELECTRICAL DETAILS) (STD. NO. SS-26)
31	SUPPORT BRACKETS FOR SIGNS, WALKWAY & LIGHTS (STD. NO. SS-27)
TxDOT STANDARDS	
32	1M(2)-93 (MOD.)
33	1M(5)-93
34	PM(1)-95
35	PM(3)-92
36	RPM(1)-92
37	R(1)-95 (MOD.)
38	R(2)-95 (MOD.)
39	R(3)-95 (MOD.)
40	R(4)-95A (MOD.)
41	W(1)-95 (MOD.)
42	W(2)-95 (MOD.)
43	SMD(1-1)-95 (MOD.)
44	SMD(1-2)-95 (MOD.)
45	SMD(1-3)-95
46	SMD(1-4)-95 (MOD.)
47	SMD(2-1)-95
48	SMD(2-2)-95
49	SMD(2-3)-95 (MOD.)
50	SMD(P-1) (MOD.)
51	SB(SWL-1) (MOD.)
52	TCP NOTES-95

INDEX OF SHEETS

SHEET NO.	DESCRIPTION
1	TITLE SHEET
2	ESTIMATE & QUANTITY SUMMARY
3,4	QUANTITY/ITEM SUMMARIES
5	SUMMARY OF LARGE SIGNS
6,7	SUMMARY OF SMALL SIGNS
8-10	SIGNING & PAVEMENT MARKING LAYOUT
11,12	SIGN DETAILS
13,14	CANTILEVER OVERHEAD SIGN STRUCTURE
15,16	PORTAL OVERHEAD SIGN ATTACHMENT LOCATION
17	TUNNEL PORTAL SIGN MOUNTING DETAILS
18-23	ROADWAY ILLUMINATION LAYOUT
24-26	MISCELLANEOUS ELECTRICAL DETAILS

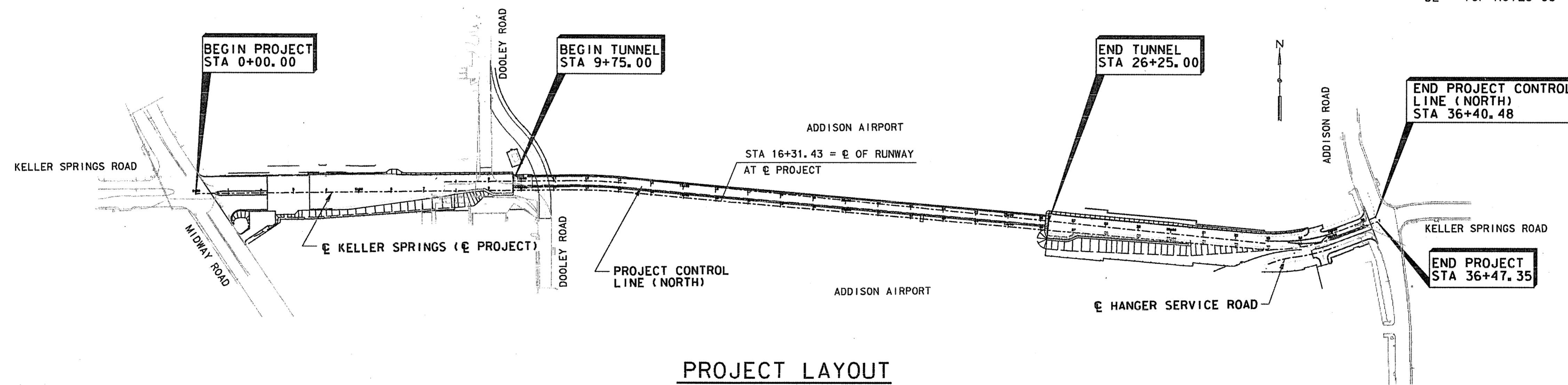

PROJECT LAYOUT

SCALE: 1" = 200'

AT ANY LOCATION WITHIN THESE PLANS AND ACCOMPANYING SPECIFICATIONS, PROPOSALS, AND CONTRACT WHERE THE WORDS "TEXAS TURNPIKE AUTHORITY" APPEAR, THESE WORDS SHALL, BY DEFINITION, MEAN THE "NORTH TEXAS TOLLWAY AUTHORITY", A BODY POLITIC AND CORPORATE AND A POLITICAL SUBDIVISION OF THE STATE OF TEXAS.

THE STANDARD SHEETS SPECIFICALLY IDENTIFIED ABOVE HAVE BEEN SELECTED BY ME, OR UNDER MY RESPONSIBLE SUPERVISION, AS BEING APPLICABLE TO THE PROJECT.

*RK Laird* P. E. 1/12/99  
DATE

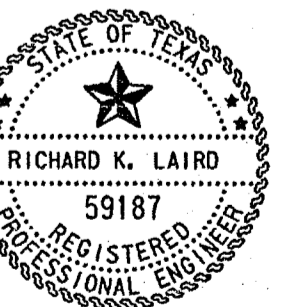

Prepared by:  
MATEO CONSULTING ENGINEERS, INC.

Recommended by:  
HNTB CORPORATION

Recommended by:  
THE GINN CORPORATION

Recommended by:  
NORTH TEXAS TOLLWAY AUTHORITY

Approved by:  
NORTH TEXAS TOLLWAY AUTHORITY

*Mateo Foy*  
Project Manager  
Date: 1/14/99

*Daniel B. Baker*  
Consulting Engineer  
Date: 01/15/99

*Ed Wagner* P.E.  
Project Engineer  
Date: 1/18/99

*Maria Bourne*  
Project Engineer  
Date: 1-15-99

*Christina*  
Executive Director  
Date: 1/15/99

FINAL RECORD  
DRAWING  
Date: 12/25/99