

MATCH LINE STA. 64+00

S.P. R.R.

CONCRETE REMOVAL & REPLACEMENT

STA 64+28.53  
CONST. 4" DIA MANHOLE  
CONST. TO MAINT. ACCESS  
IN DRIVE

VAULT

MATCH LINE STA. 68+00

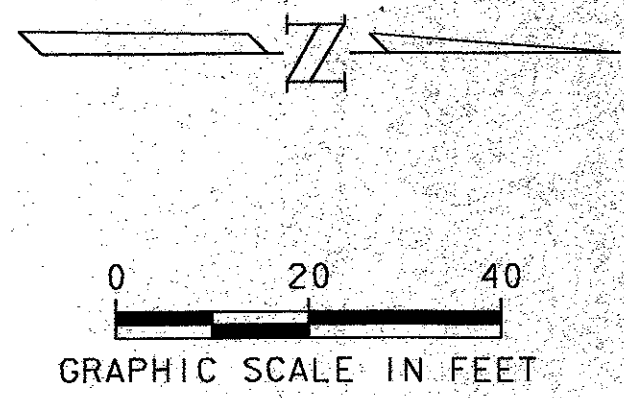

NOTE:

- CONTRACTOR SHALL REMOVE AND REPLACE WEST ROW OF EXISTING TREES AS NECESSARY TO INSTALL PROPOSED SEWER LINE AND SHALL CONSTRUCT TEMPORARY FENCING TO PROTECT EXIST ROW OF TREES. NOT A SEPERATE PAY ITEM.

6435  
-0051  
384  
12854 @ 350 x 80,000

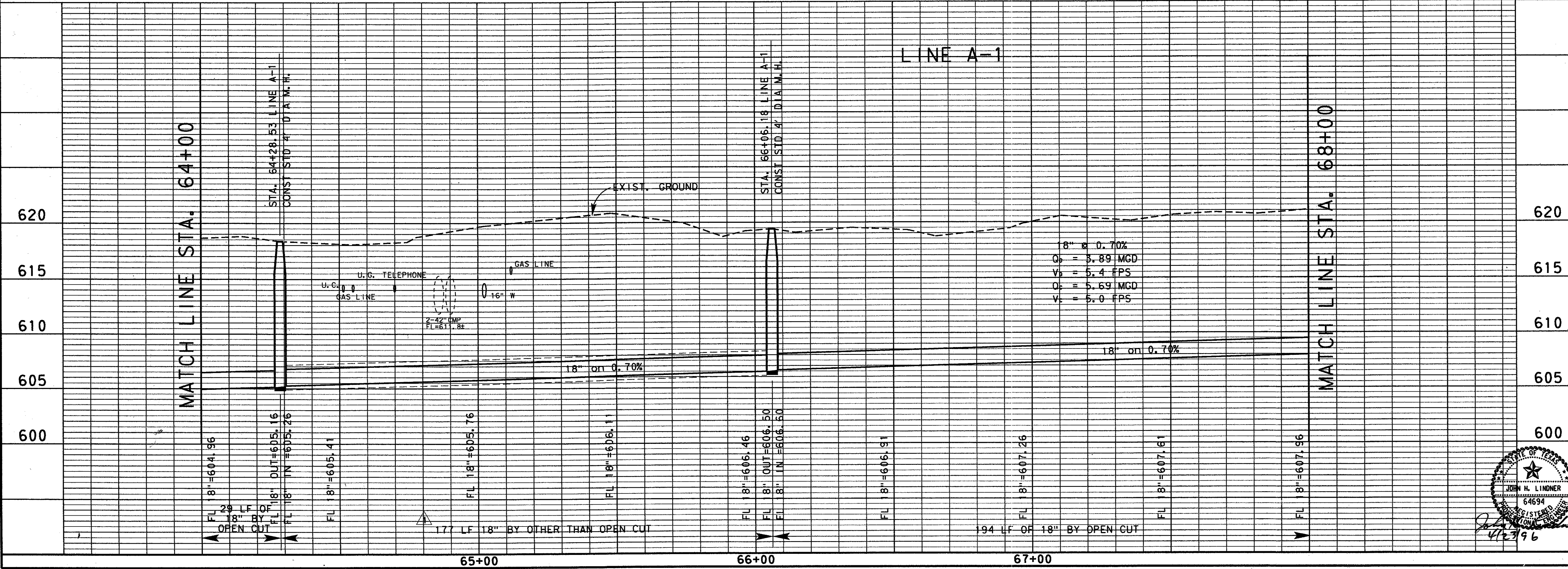
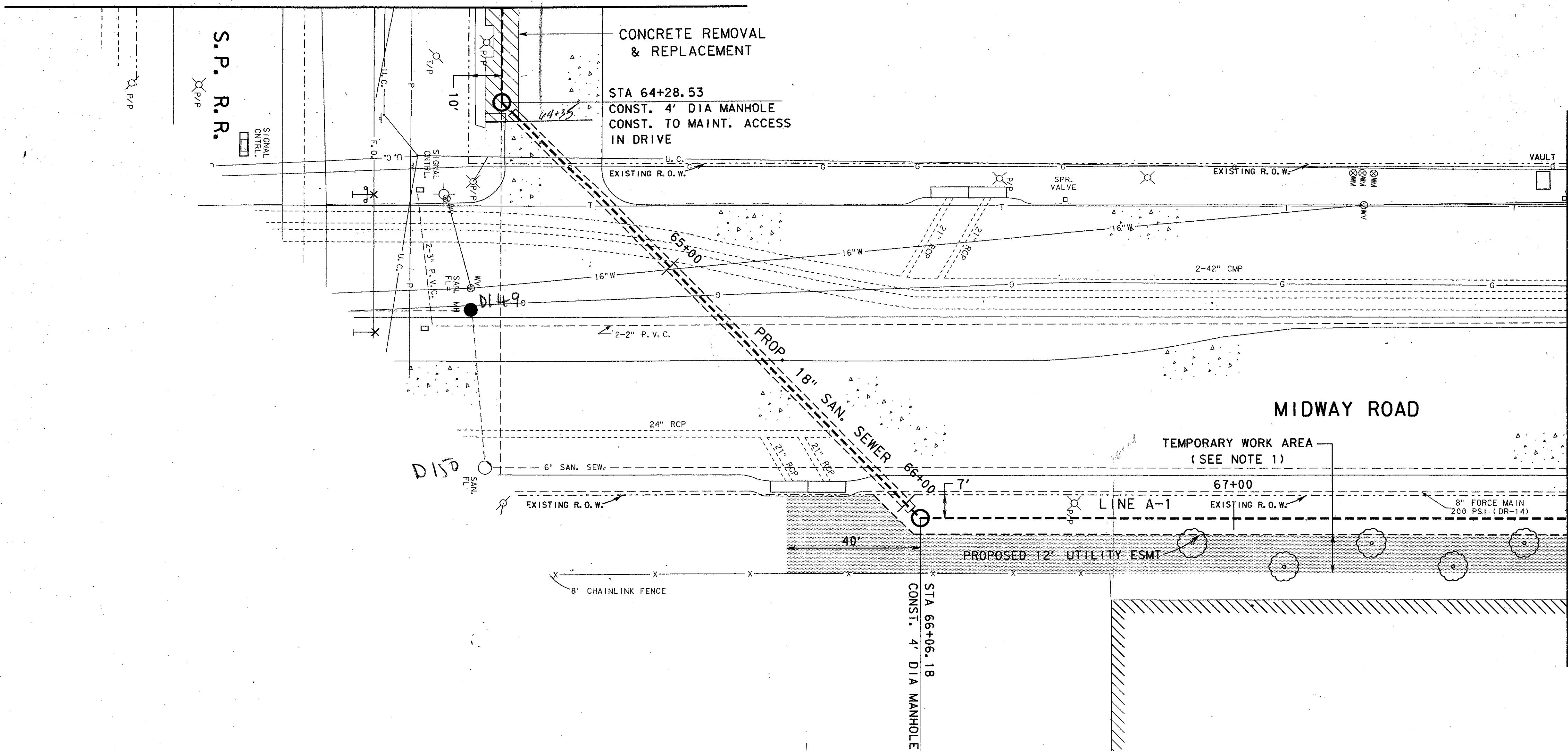

4			
3			
2			
1	4-23-98	ADDENDUM NO. 1	J. H. L.
NO.	DATE	REVISION	APPROV.
TOWN OF ADDISON, TEXAS			
MIDWAY/BELTLINE SANITARY SEWER PHASE II			
LINE A-1 FROM STATION 64+00 TO STATION 68+00			
 Consultants in Engineering, Architecture, Planning and the Environment CARTER & BURGESS, INC. 7950 ELMBROOK DRIVE, SUITE 250 DALLAS, TX 75247-4963			
Unit	Scale	Horiz. 1"=20' Vert. 1"=5'	Date 04-05-98
Designed	J. Lindner	Checked	J. Lindner
Drawn	R. Howman	Approved	J. Lindner
Job No.	93327601D		Sheet 19 of 63
			32765516.DGN

