

**A SECTION**  
 SCALE: 1/4" = 1'-0"

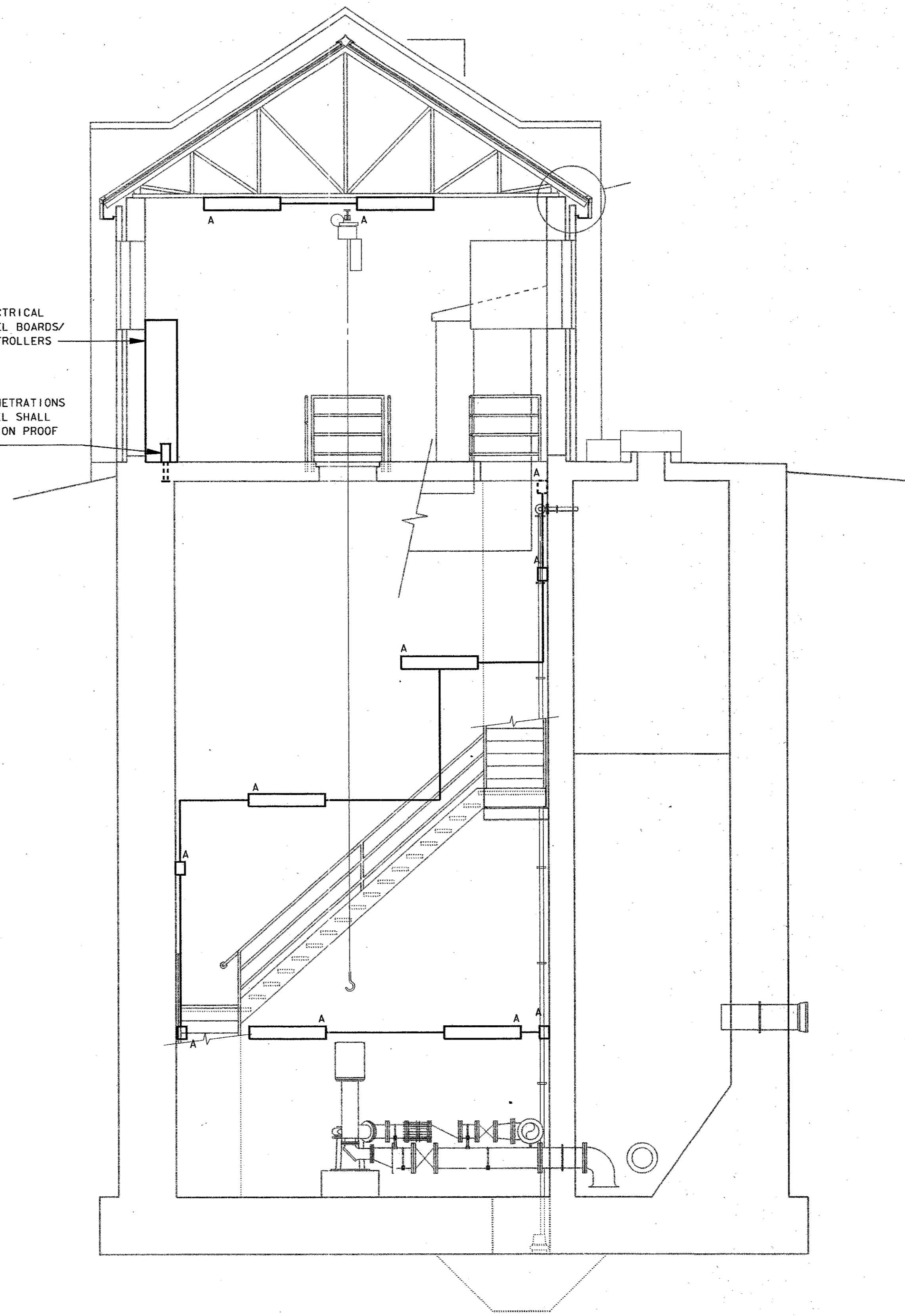

**B SECTION**  
 SCALE: 1/4" = 1'-0"

**GENERAL NOTES**

1. REFERENCE DWG. 56 FOR BRANCH CIRCUIT DESIGNATIONS.

NO.	DATE	REVISION	APPROV.
4			
3			
2			
1			

TOWN OF ADDISON, TEXAS  
 MIDWAY/BELTLINE SANITARY SEWER  
 PHASE II  
 LIFT STATION  
 ELECTRICAL BUILDING SECTIONS

**Carter-Burgess**  
 Consultants in Engineering, Architecture,  
 Planning and the Environment  
 CARTER & BURGESS, INC.  
 7950 ELMBROOK DRIVE, SUITE 250  
 DALLAS, TX 75247-4961

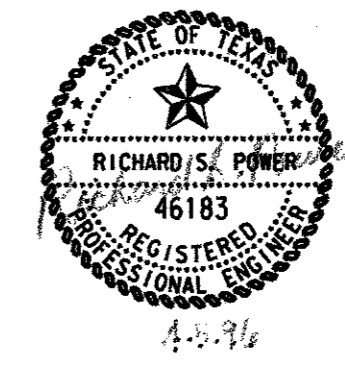

Unit	Scale	Date
Designed R. FRISCH	Checked R. FRISCH	Job No. 93327601D
Drawn J. WEBB	Approved J. Lindner	Sheet 57 of 63

REVISIONS: 1. 04-05-95  
 2. 04-05-95  
 3. 04-05-95  
 4. 04-05-95  
 5. 04-05-95  
 6. 04-05-95  
 7. 04-05-95  
 8. 04-05-95  
 9. 04-05-95  
 10. 04-05-95  
 11. 04-05-95  
 12. 04-05-95  
 13. 04-05-95  
 14. 04-05-95  
 15. 04-05-95  
 16. 04-05-95  
 17. 04-05-95  
 18. 04-05-95  
 19. 04-05-95  
 20. 04-05-95  
 21. 04-05-95  
 22. 04-05-95  
 23. 04-05-95  
 24. 04-05-95  
 25. 04-05-95  
 26. 04-05-95  
 27. 04-05-95  
 28. 04-05-95  
 29. 04-05-95  
 30. 04-05-95  
 31. 04-05-95  
 32. 04-05-95  
 33. 04-05-95  
 34. 04-05-95  
 35. 04-05-95  
 36. 04-05-95  
 37. 04-05-95  
 38. 04-05-95  
 39. 04-05-95  
 40. 04-05-95  
 41. 04-05-95  
 42. 04-05-95  
 43. 04-05-95  
 44. 04-05-95  
 45. 04-05-95  
 46. 04-05-95  
 47. 04-05-95  
 48. 04-05-95  
 49. 04-05-95  
 50. 04-05-95  
 51. 04-05-95  
 52. 04-05-95  
 53. 04-05-95  
 54. 04-05-95  
 55. 04-05-95  
 56. 04-05-95  
 57. 04-05-95  
 58. 04-05-95  
 59. 04-05-95  
 60. 04-05-95  
 61. 04-05-95  
 62. 04-05-95  
 63. 04-05-95  
 64. 04-05-95  
 65. 04-05-95  
 66. 04-05-95  
 67. 04-05-95  
 68. 04-05-95  
 69. 04-05-95  
 70. 04-05-95  
 71. 04-05-95  
 72. 04-05-95  
 73. 04-05-95  
 74. 04-05-95  
 75. 04-05-95  
 76. 04-05-95  
 77. 04-05-95  
 78. 04-05-95  
 79. 04-05-95  
 80. 04-05-95  
 81. 04-05-95  
 82. 04-05-95  
 83. 04-05-95  
 84. 04-05-95  
 85. 04-05-95  
 86. 04-05-95  
 87. 04-05-95  
 88. 04-05-95  
 89. 04-05-95  
 90. 04-05-95  
 91. 04-05-95  
 92. 04-05-95  
 93. 04-05-95  
 94. 04-05-95  
 95. 04-05-95  
 96. 04-05-95  
 97. 04-05-95  
 98. 04-05-95  
 99. 04-05-95  
 100. 04-05-95