

DATE: 11/14/95  
 DRAWN BY: J. LINDNER  
 CHECKED BY: D. MOORE  
 PROJECT NO.: 93327601D

DATE: 11/14/95  
 DRAWN BY: J. LINDNER  
 CHECKED BY: D. MOORE  
 PROJECT NO.: 93327601D

ALLEN  
 BUREAU  
 PROFILE

DATE: 11/14/95  
 DRAWN BY: J. LINDNER  
 CHECKED BY: D. MOORE  
 PROJECT NO.: 93327601D

DATE: 11/14/95  
 DRAWN BY: J. LINDNER  
 CHECKED BY: D. MOORE  
 PROJECT NO.: 93327601D

DATE: 11/14/95  
 DRAWN BY: J. LINDNER  
 CHECKED BY: D. MOORE  
 PROJECT NO.: 93327601D

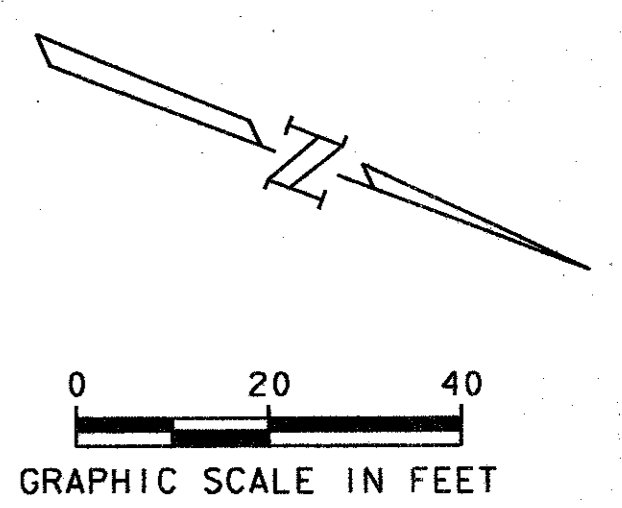
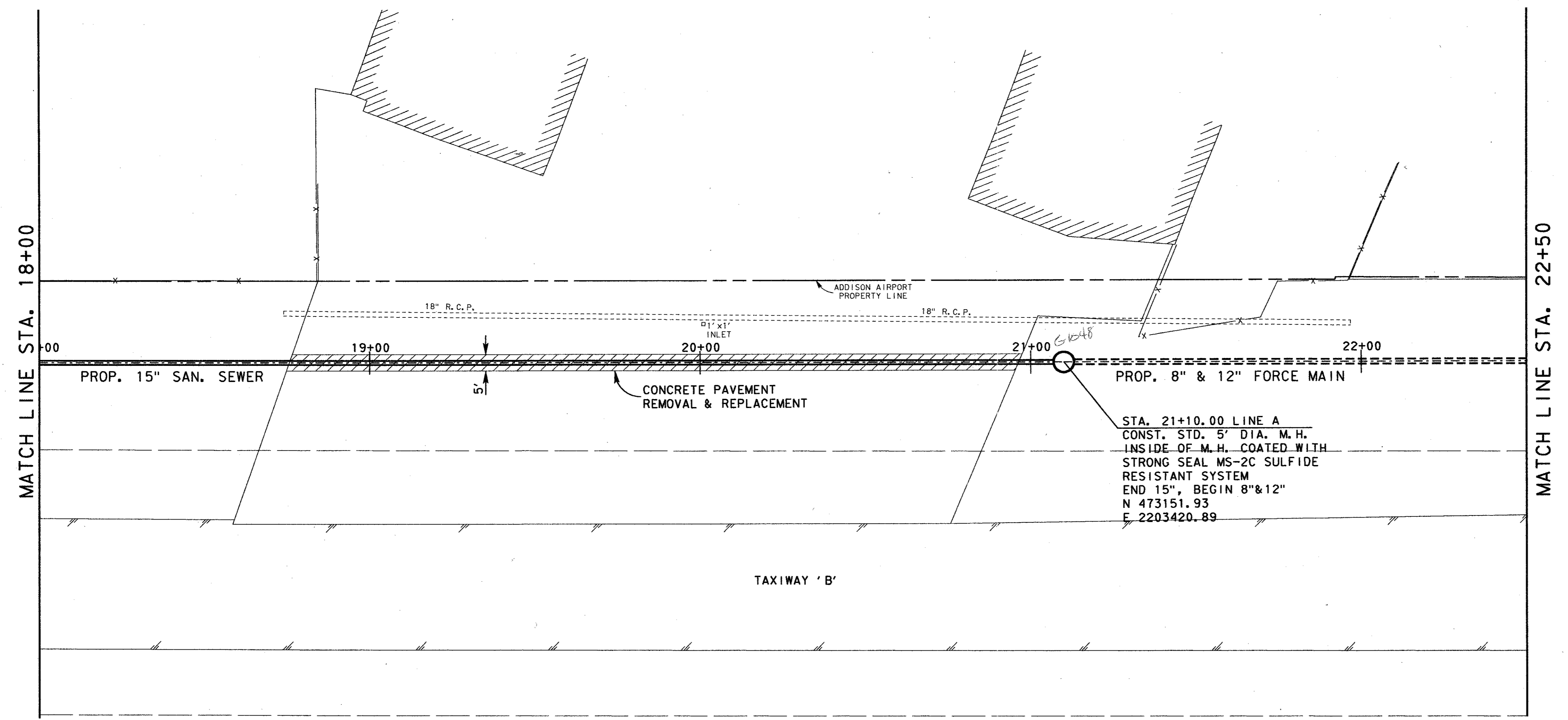

- NOTES:
- CONTRACTOR SHALL BE PROHIBITED FROM ACCESSING OR CONDUCTING ANY ACTIVITIES WITHIN THE T/W SAFETY AREA.
  - CONTRACTOR SHALL RESTRICT ACCESS TO CONSTRUCTION AREA FROM WILEY POST RD.

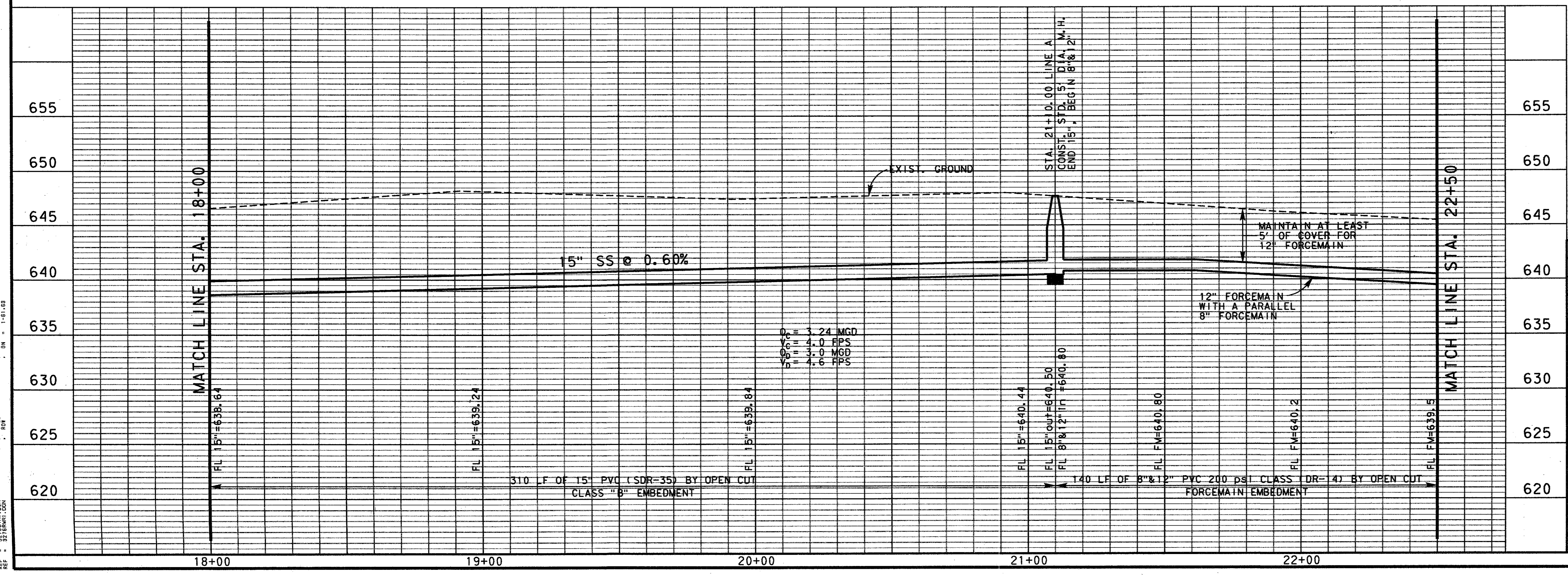

NO.	DATE	REVISION	APPROV.
4			
3			
2			
1			

TOWN OF ADDISON, TEXAS  
 MIDWAY/BELTLINE SANITARY SEWER  
 SANITARY SWR. PLAN & PROFILE  
 FROM STATION 18+00 TO STATION 22+50

**Carter Burgess**  
 Consultants in Engineering, Architecture,  
 Planning and the Environment.  
 CARTER & BURGESS, INC.  
 7950 ELMBROOK DRIVE, SUITE 250  
 DALLAS, TX 75247-4961

Unit	Scale	Horiz. 1"=20'	Vert. 1"=5'	Date	03-23-95
Designed	D. Moore	Checked	J. Lindner	Job No.	93327601D
Drawn	B. Sowell	Approved	J. Lindner	Sheet	7 of 11

3276s25.DGN

