

EDI CAPE HOPKINS CLEMENT, INC.
 PLANNING · ARCHITECTURE · INTERIOR DESIGN
 TWO NORTH PARK EAST, 120 · DALLAS · 214 / 750-1945
 AMERICAN INSTITUTE OF ARCHITECTS · AMER. SOC. CONSULTING PLANNERS

Sidewalks for Brookhaven Club Drive
 Addison, Texas

ISSUE DATE	11/21/74
REVISIONS	

SHEET NUMBER
1

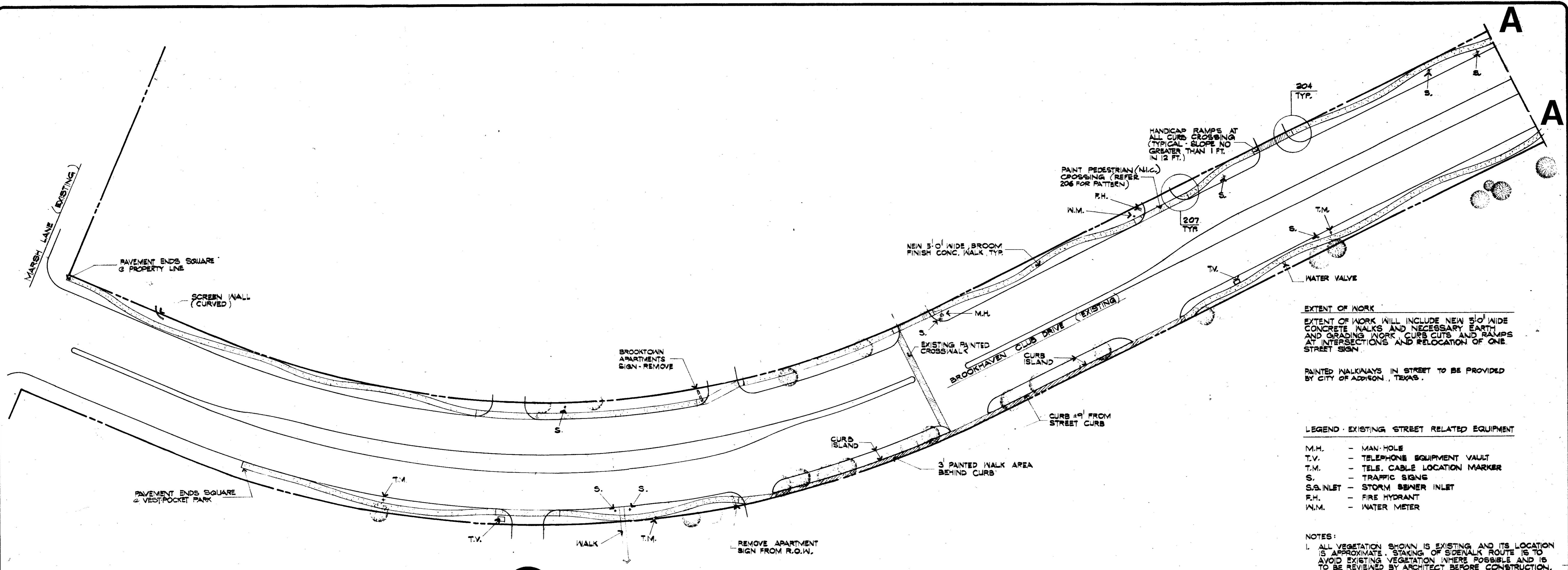

101 RIGHT OF WAY PLAN (BROOKHAVEN CLUB DR.)
 1" = 40'-0"

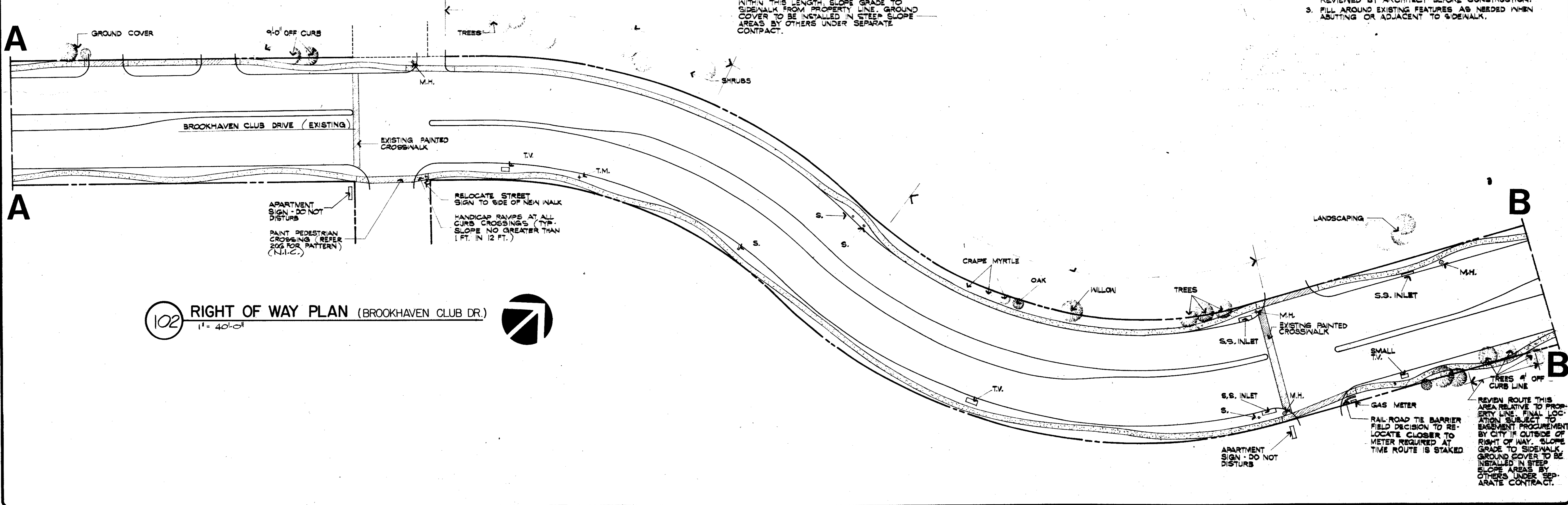

102 RIGHT OF WAY PLAN (BROOKHAVEN CLUB DR.)
 1" = 40'-0"

EXTENT OF WORK
 EXTENT OF WORK WILL INCLUDE NEW 5'-0" WIDE CONCRETE WALKS AND NECESSARY EARTH AND GRADING WORK, CURB CUTS AND RAMPS AT INTERSECTIONS AND RELOCATION OF ONE STREET SIGN.

PAINTED WALKWAYS IN STREET TO BE PROVIDED BY CITY OF ADDISON, TEXAS.

LEGEND - EXISTING STREET RELATED EQUIPMENT

- M.H. - MAN-HOLE
- T.V. - TELEPHONE EQUIPMENT VAULT
- T.M. - TELE. CABLE LOCATION MARKER
- S. - TRAFFIC SIGN
- S.S. INLET - STORM SEWER INLET
- F.H. - FIRE HYDRANT
- W.M. - WATER METER

- NOTES:**
- ALL VEGETATION SHOWN IS EXISTING AND ITS LOCATION IS APPROXIMATE. STAKING OF SIDEWALK ROUTE IS TO AVOID EXISTING VEGETATION WHERE POSSIBLE AND IS TO BE REVIEWED BY ARCHITECT BEFORE CONSTRUCTION.
 - LOCATIONS OF ALL EXISTING FEATURES SHOWN SUCH AS MANHOLES, FIRE HYDRANTS, WATER METERS, TELEPHONE EQUIPMENT VAULTS, TELEPHONE CABLE LOCATION MARKERS, TRAFFIC SIGNS & STORM SEWER INLETS ARE APPROXIMATE. STAKING OF SIDEWALK ROUTE IS TO AVOID SUCH EXISTING FEATURES WHERE POSSIBLE AND IS TO BE REVIEWED BY ARCHITECT BEFORE CONSTRUCTION.
 - FILL AROUND EXISTING FEATURES AS NEEDED WHEN ABUTTING OR ADJACENT TO SIDEWALK.

WITHIN THIS LENGTH, SLOPE GRADE TO SIDEWALK FROM PROPERTY LINE. GROUND COVER TO BE INSTALLED IN STEEP SLOPE AREAS BY OTHERS UNDER SEPARATE CONTRACT.

REVIEW ROUTE THIS AREA RELATIVE TO PROPERTY LINE. FINAL LOCATION SUBJECT TO EASEMENT PROCUREMENT BY CITY IF OUTSIDE OF RIGHT OF WAY. SLOPE GRADE TO SIDEWALK. GROUND COVER TO BE INSTALLED IN STEEP SLOPE AREAS BY OTHERS UNDER SEPARATE CONTRACT.