

NOTE: All work to be performed in accordance with City of Addison Specifications

NOTE: Water & Sewer line embedment shall be 6" sand cushion on all sides of pipe. Remaining trench shall be backfilled and compacted with "select" material in accordance with City of Addison Specifications.

NOTE: Municipal water main distribution pipe 12" in diameter and less shall be P.V.C. with integral thickened wall bells and shall be a minimum of 150 P.S.I. pressure classification S.D.R. - 18.

NOTE: Water Valve Riser Boxes and Sanitary Sewer Cleanouts shall have a 18" x 18" x 6" concrete pad poured around top.

NOTE: Number 16 copper plastic locator wire shall be laid on top of P.V.C. water pipe and be connected to all fire hydrants and valves, in accordance with City of Addison specifications. (Alt. - Locator tape may be laid in pipe trench).

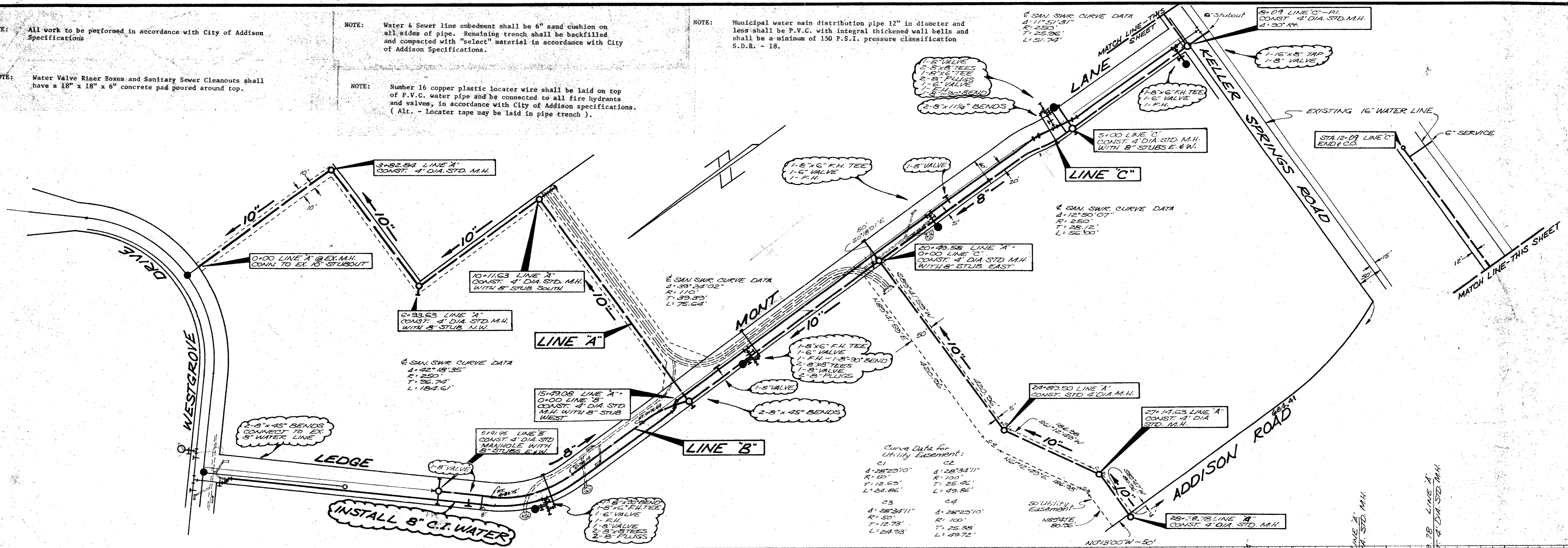

Curve Data for Utility Easement:

Curve	Stationing	Radius (R)	Tangent (T)	Length (L)
C1	4+28'20.10"	R: 50'	T: 12.63'	L: 24.86'
C2	4+28'34.11"	R: 100'	T: 25.42'	L: 49.86'
C3	4+28'34.11"	R: 50'	T: 12.78'	L: 24.93'
C4	4+28'25.10"	R: 100'	T: 25.38'	L: 49.72'

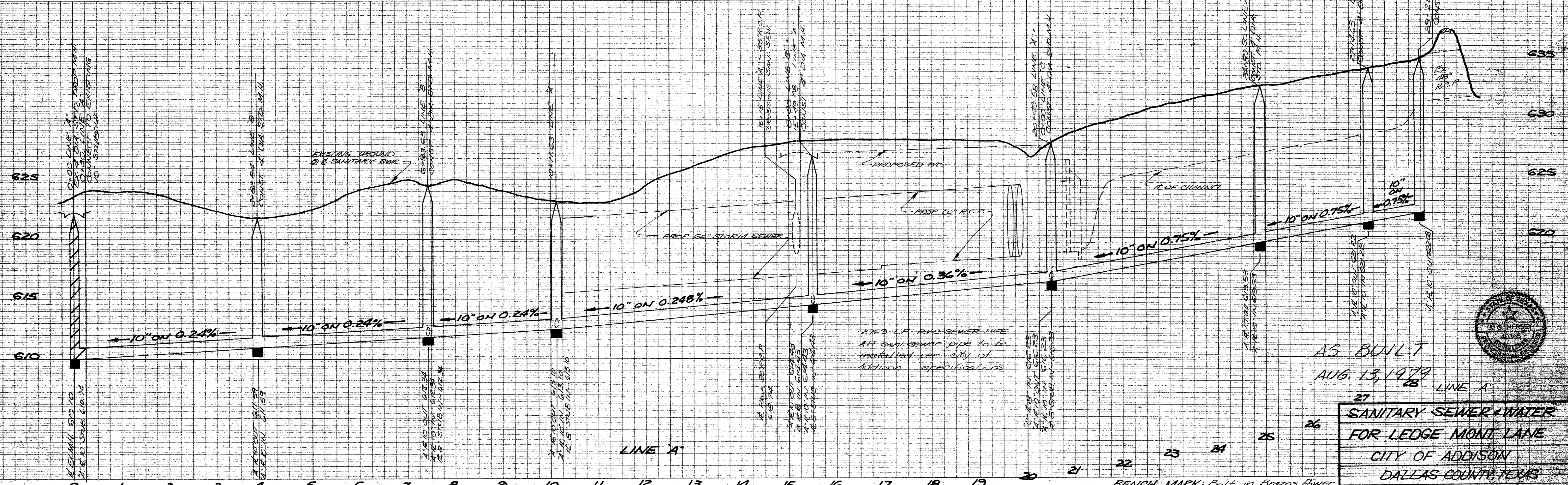

2769 L.F. P.V.C. SEWER PIPE
 ALL sanitary sewer pipe to be installed per city of Addison specifications

AS BUILT
 AUG. 13, 1979

27
 LINE A

SANITARY SEWER & WATER FOR LEDGE MONT LANE
 CITY OF ADDISON
 DALLAS COUNTY, TEXAS

THREADGILL - DOWDEY and ASSOCIATES
 CONSULTING ENGINEERS
 DALLAS, TEXAS

DESIGN	DRAWN	CHECKED	DATE	SCALE	JOB	SHEET
ARW	HTM	DMD	4/78	1"=100'	493-E	1/2

BENCH MARK: Bolt in Brazos Power Pole (No. 16-12-6) on the south side of Keller Springs Rd ±350' west of the West line of Ledge Mont Lane.

Elev. 636.67



NO. 1265-PLAN PROFILE PLATE A
 "CLEARPRINT PAPER CO."
 MADE IN U.S.A.

Revised 8/13/79

PLATE No.