

1. Railroad spike in 17" Willow 250' feet East Centerline Old Marsh Lane & 75' feet North Centerline Belt Line. Elev. 576.32
2. "□" Top of curb at the center of a 10' inlet and 75' feet West of Centerline Commercial at the North Side of Belt Line Road. Elev. 580.83
3. "□" Top of Concrete Footing at Southeast Corner Tower #13N-3M-7287. Elev. 597.83
4. "□" Top of Concrete Footing at Northwest Corner Tower #12N-3M-7288. Elev. 605.20
5. "□" Top of Concrete Footing at Northwest Corner Tower #12N-3M-7290 at angle point in Tower line. Elev. 613.16
6. "□" Top of Concrete Footing at Southwest Corner Tower #12N-3M-7291. Elev. 619.46
7. "□" Out at top of Concrete Footing at Tower #12N-3M-7294. Elev. 607.46

AS BUILT  
 DATE 3/29/82

Δ 11/29/81 Revised Line "S40"  
 Added Line "S41"  
 Δ 2/10/82 Revised Line "S41" & "S50"

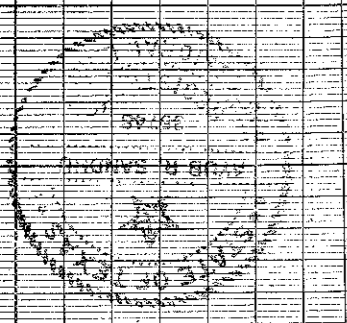
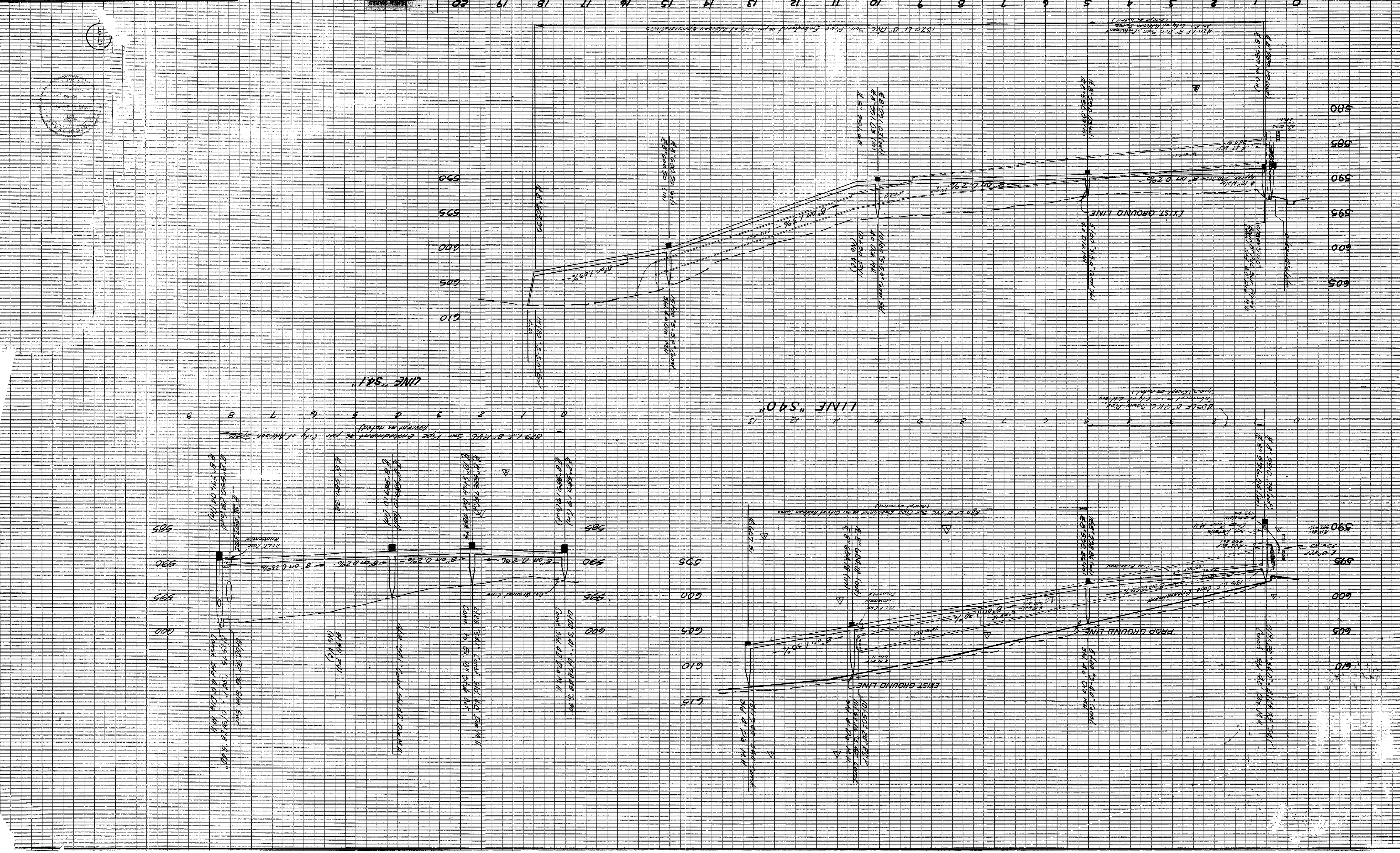

19