

DATE	
BY	
REVISION	
NO.	
PLAN	
NOTE BOOK	
NO.	

DATE	
BY	
REVISION	
NO.	
PROFILE	
NOTE BOOK	
NO.	

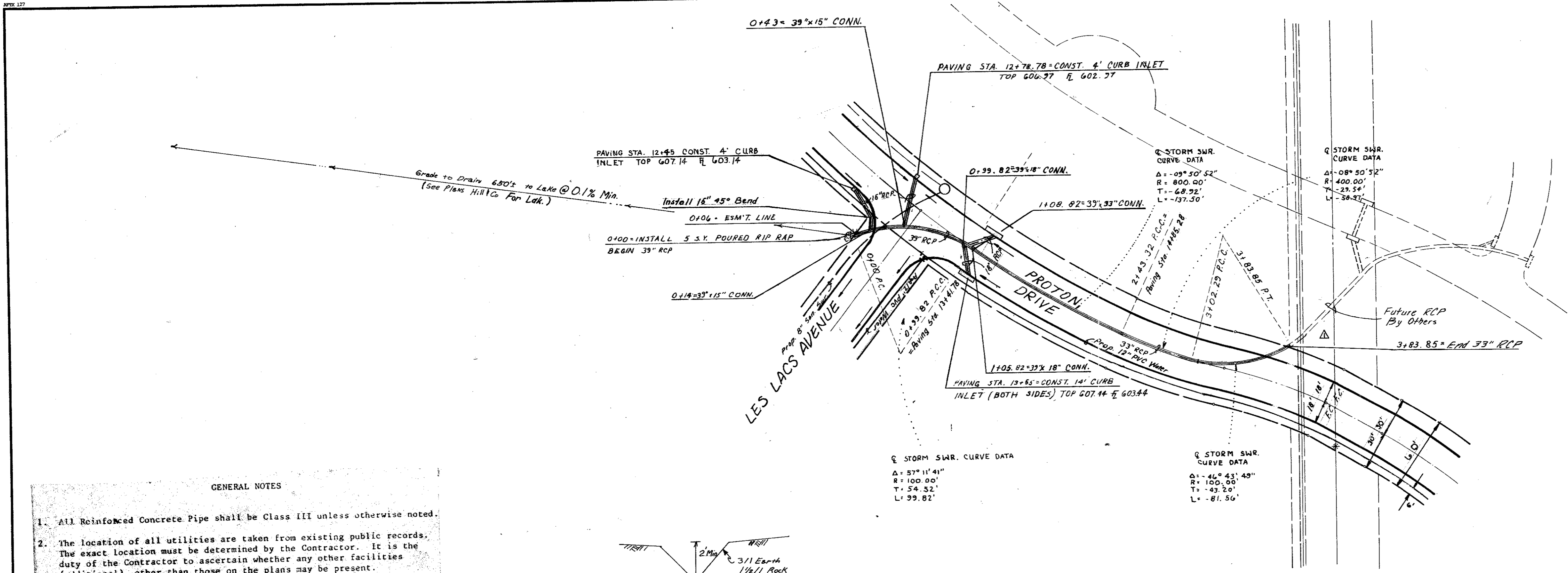

- BENCH MARKS**
1. Railroad Spike in 12" Willow 250' East Centerline Old Marsh Lane & 75' West Centerline Belt Line. Elev. 576.32
  2. "□" Top of Curb at the Center of a 10' inlet and 75' West of Centerline Commercial at the North Side of Belle Line Road. Elev. 580.83
  3. "□" Top of Concrete Footing at Southeast Corner Tower #12N-3W-1287. Elev. 597.83
  4. "□" Top of Concrete Footing at Northwest Corner Tower #12N-3W-1288. Elev. 605.20
  5. "□" Top of Concrete Footing at Northwest Corner Tower #12N-3W-1290 at a Le point in Tower line. Elev. 613.16
  6. "□" Top of Concrete Footing at Southwest Corner Tower #12N-3W-1291. Elev. 619.46
  7. "□" Cut at top of Concrete Footing at Tower #12N-3W-1294. Elev. 607.46

- GENERAL NOTES**
1. All Reinforced Concrete Pipe shall be Class III unless otherwise noted.
  2. The location of all utilities are taken from existing public records. The exact location must be determined by the Contractor. It is the duty of the Contractor to ascertain whether any other facilities (additional), other than those on the plans may be present.
  3. Embedment is subsidiary to RCP.
  4. All backfill shall be compacted to 90% Standard Proctor Density in a maximum of six 8-inch lifts.
  5. All work and materials shall be in accordance with the City of Addison Standards and Specifications and to contract specifications and documents.

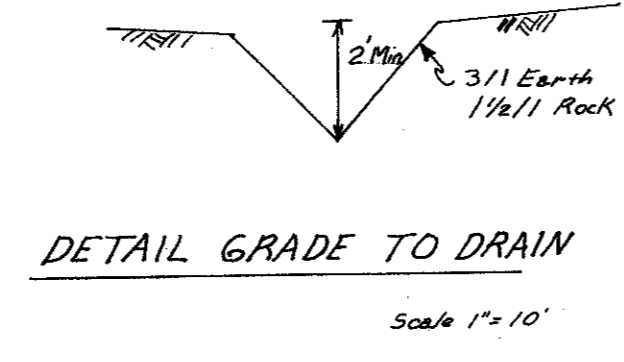

11/23/01 Revised Deleted Headwall

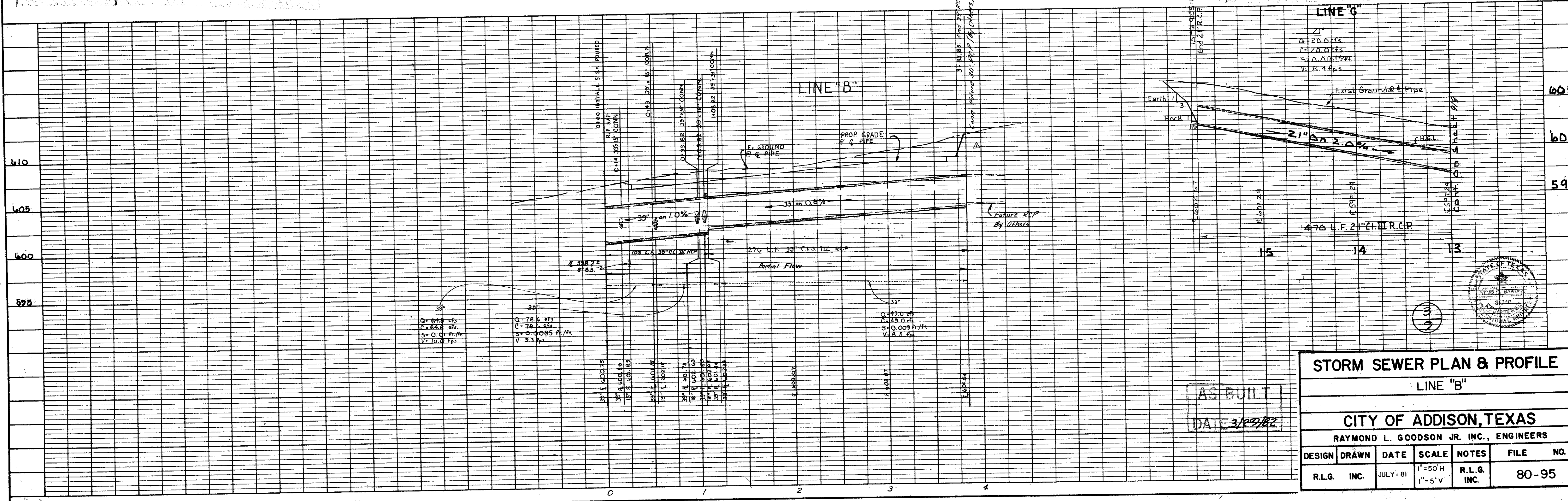

AS BUILT  
DATE 3/22/82

**STORM SEWER PLAN & PROFILE**  
LINE "B"

**CITY OF ADDISON, TEXAS**  
RAYMOND L. GOODSON JR. INC., ENGINEERS

DESIGN	DRAWN	DATE	SCALE	NOTES	FILE NO.
R.L.G. INC.	INC.	JULY-81	1"=50'H 1"=5'V	R.L.G. INC.	80-95

