

Note:  
Contractor will field locate  
& notify Engineer of any  
conflicts between ex. utilities  
& prop. utilities prior to  
construction.

**WARNING!!!**  
(Maintain Adequate Clearance  
From D.P.E.L. Electrical Line  
To Prevent Injury or Damage  
To Persons or Property.)  
  
(Contractor or His Representative  
Should not Use Boom Type  
Equipment On D.P.E.L. B.O.M.  
In Connection With Construction  
Unless Special Arrangements  
Have Been Made With D.P.E.L.  
Contact  
1 Week Prior To Construction)

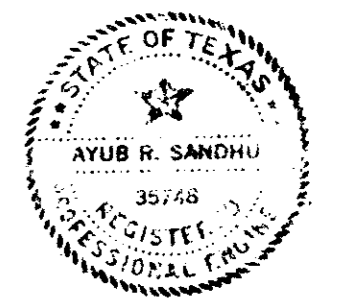
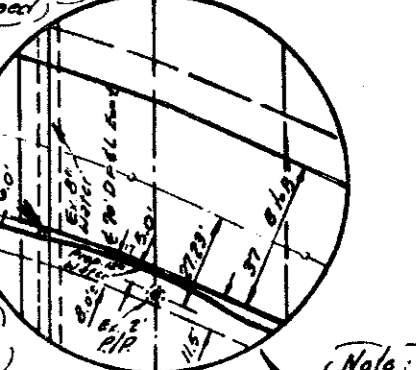

3/20/82

2/9

WATER & SANITARY SEWER PLAN						
RAYMOND L. GOODSON JR., INC., CONSULTING ENGINEERS						
CITY OF ADDISON, TEXAS						
DESIGN	DRAWN	DATE	SCALE	NOTES	FILE NO.	
Raymond L. Goodson			1" = 100'	R.L.G.		

Revised F.H. Line "W-20"  
Revised M.H. Line "S-30"  
Deleted S.S. Line "S-32"  
11/23/81  
Revised As Per As Built  
3/27/82

9/1/81 Revised alignment and stations and  
Added M.H. to Sanitary Sur. Line "S-10", and  
Revised Location exist. 16" Water on Marsh Ln.  
Added 18 LF 12" P.V.C.  
3/30/81 Revised Locations Sanitary Sewer