

18.00 L.F. 8\"/>

18.00 L.F. 8\"/>

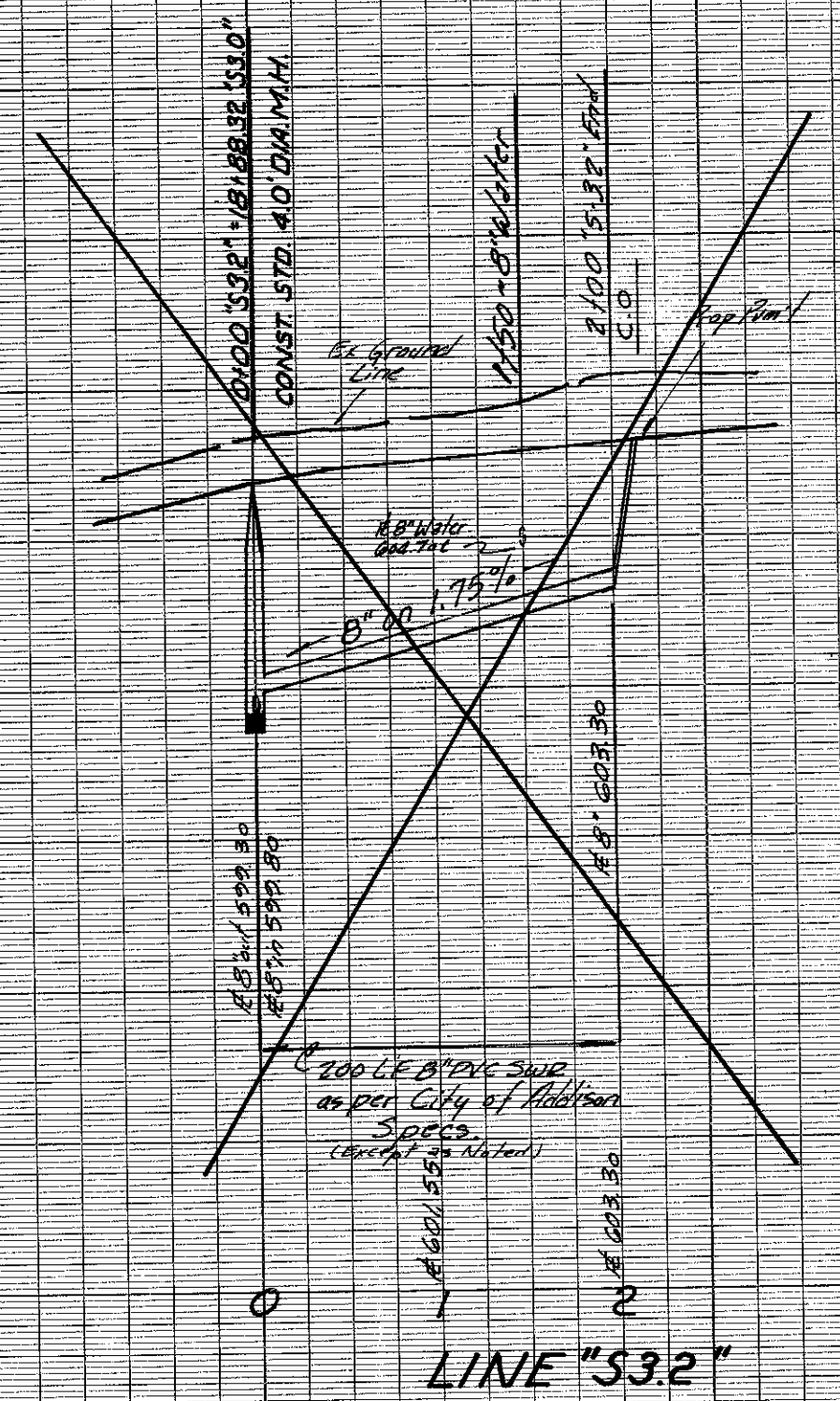

LINE "S3.2"

11/18/81 Eliminate Line "S3.2"
 Relocated End of Line "S3.0"
 Added 30 L.F. Corr. Encasement

AS BUILT
 DATE 3/29/82

- BENCH MARKS
1. Railroad Spike in 12" Willow 250+ feet East Centerline Old Marsh Lane & 75+ feet North Centerline Belt Line. Elev. 576.32
 2. "□" Top of Curb at the Center of a 10' inlet and 75+ feet West of Centerline Commercial at the North Side of Belt Line Road. Elev. 580.83
 3. "□" Top of Concrete Footing at Southeast Corner Tower #13N-3W-T287. Elev. 597.83
 4. "□" Top of Concrete Footing at Northwest Corner Tower #12N-3W-T288. Elev. 605.20
 5. "□" Top of Concrete Footing at Northwest Corner Tower #12N-3W-T290 at angle point in Tower line. Elev. 613.16
 6. "□" Top of Concrete Footing at Southwest Corner Tower #12N-3W-T291. Elev. 619.46
 7. "□" Cut at top of Concrete Footing at Tower #12N-2W-T294. Elev. 607.46

SANITARY SEWER PROFILES
LINES S3.0, S3.1, S3.2, & S3.3

RAYMOND L. GOODSON JR., INC. ENGINEERS
CITY OF ADDISON, TEXAS

DESIGN	DRAWN	DATE	SCALE	NOTES	FILE	NO.
R.L.G.	R.L.G.	JULY 1981	1" = 100' 1" = 60'	R.L.G.	80	95

