

PLAN
 DATE: _____ BY: _____
 CHECKED: _____
 NOTE BOOK: _____
 No. _____

PROFILE
 DATE: _____ BY: _____
 CHECKED: _____
 NOTE BOOK: _____
 No. _____

GENERAL NOTES

1. All areas to receive fill shall be scarified to a depth of 6 inches and compacted to a density of 95% Standard Proctor Density. All fill shall be placed in horizontal layers not exceeding 8 inches (loose depth) and compacted to a density of 95% Standard Proctor with the moisture content within 4% of optimum.
2. The Contractor shall be entirely responsible for damage to existing utilities, streets, curbs, sidewalks and other structures of any kind during the execution of this work and shall be liable for damage to public or private property resulting therefrom.
3. All materials and workmanship shall conform to the City of Addison Standards and Specifications, and to the contract specifications and documents.
4. Contractor shall be solely responsible for the location, and protection during construction, of any existing utilities or structures whatsoever. Those utilities shown herein are for the location, nature or type of existing utilities or structures that may be found on the field.
5. Class III reinforced concrete pipe shall be used on all storm sewer systems.
6. Concrete cushion will be provided when rock is encountered in storm sewer trenches.

Bench Mark

- 1) "I" T.C. at the Center of a 10' Inlet and 75' West of Centerline Commercial at N. Side of Beltline Road
Elevation: 580.83
- 2) "I" Top of Concrete Footing at N.W. Corner Tower #12N-3W-7286
Elevation: 605.20

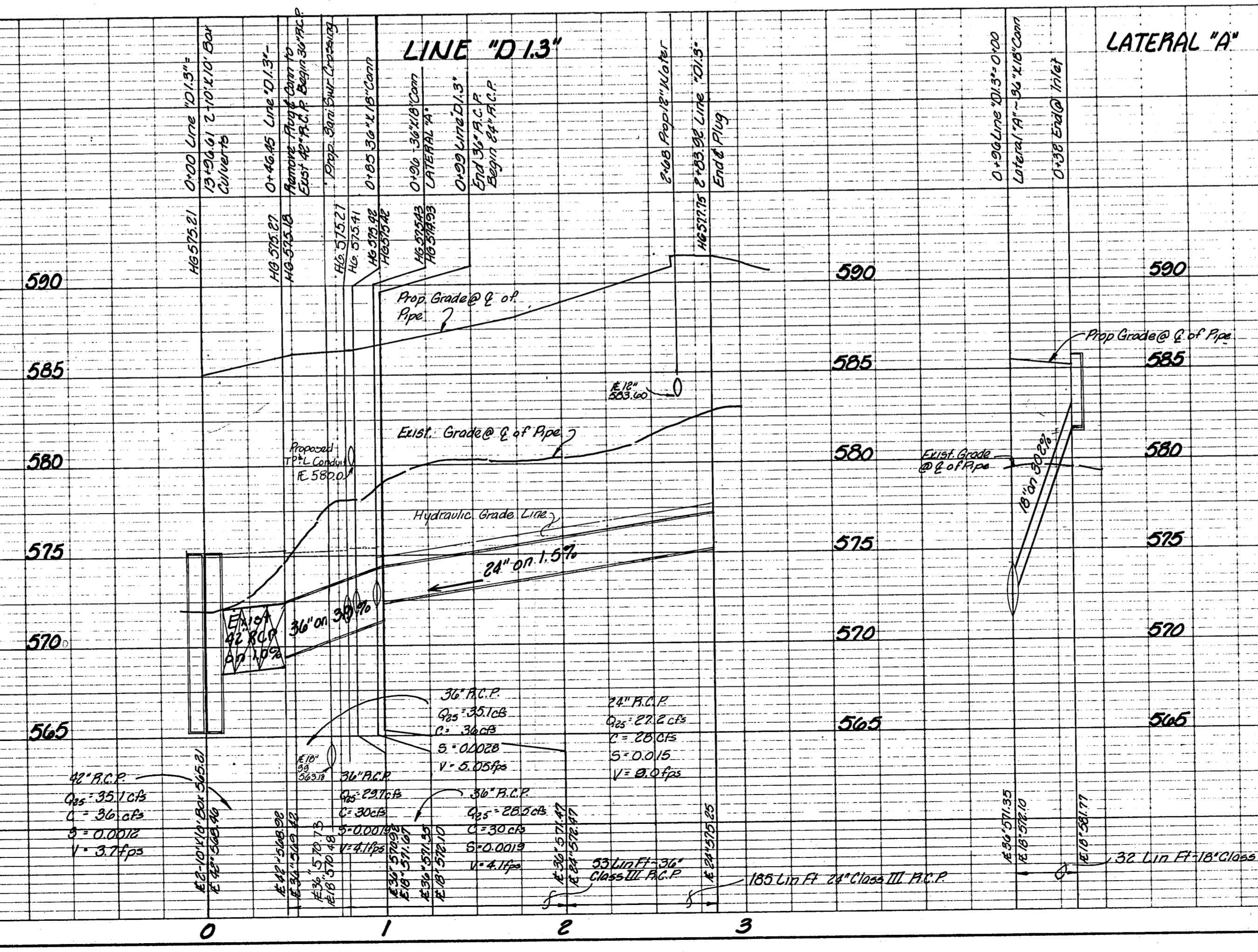
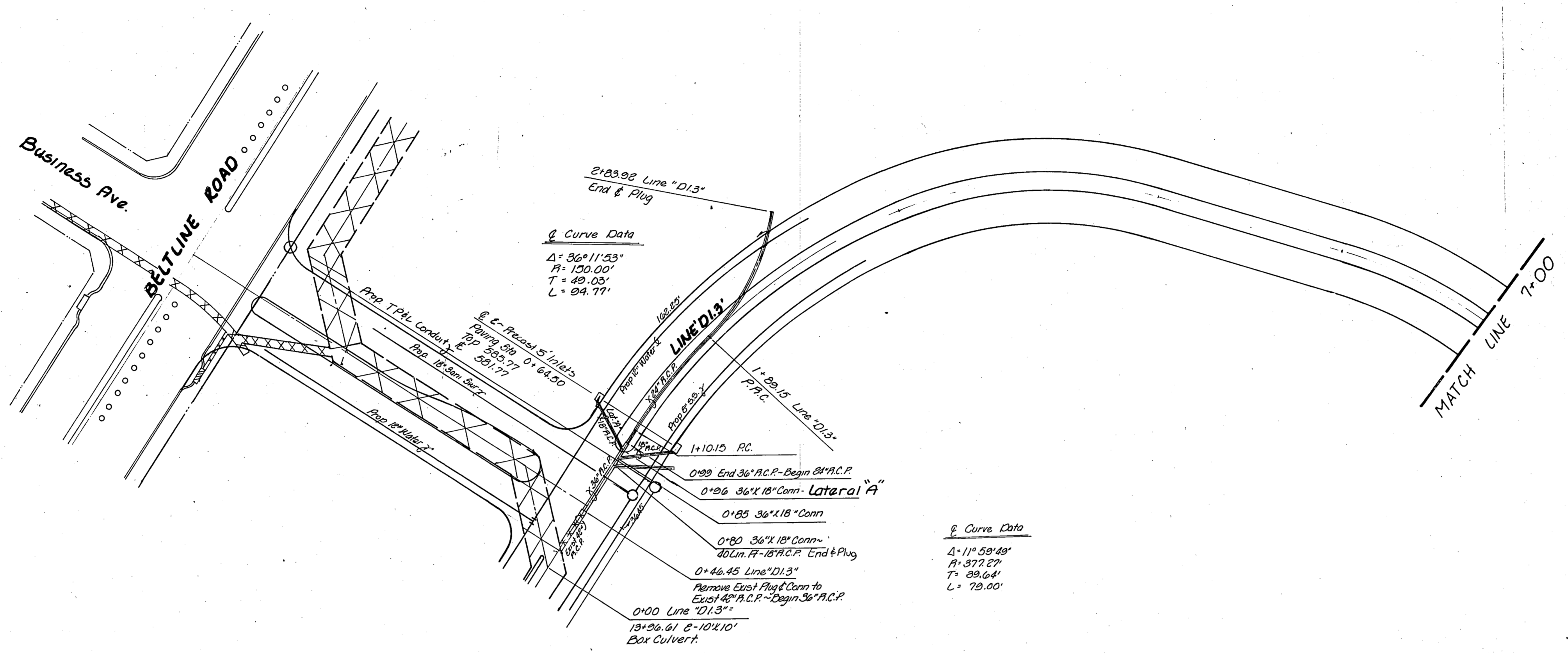

DATE 11/23/83

24

STORM SEWER PLAN & PROFILE					
LINE "D 1.3"					
LES LACS PLAZA					
CITY OF ADDISON, TEXAS					
RAYMOND L. GOODSON JR. INC., ENGINEERS					
DESIGN	DRAWN	DATE	SCALE	NOTES	FILE NO.
R.L.G.	INC.	APRIL 1983	1"=50'H 1"=5'V	R.L.G. INC.	80 - 95