

EXISTING UTILITY LOCATIONS SHOWN ARE SCHEMATIC IN NATURE AND MAY NOT ACCURATELY REFLECT THE SIZE AND LOCATION OF EACH PARTICULAR UTILITY. SOME UTILITY LINES MAY NOT BE SHOWN. CONTRACTOR SHALL ASSUME RESPONSIBILITY FOR ACTUAL FIELD LOCATION AND PROTECTION OF ALL EXISTING UTILITIES WHETHER SHOWN OR NOT. CONTRACTOR SHALL ALSO ASSUME RESPONSIBILITY FOR REPAIRS TO EXISTING UTILITIES, WHETHER SHOWN OR NOT, DAMAGED BY CONTRACTOR'S ACTIVITIES. DIFFERENCES IN HORIZONTAL OR VERTICAL LOCATION OF EXISTING UTILITIES SHALL NOT BE A BASIS FOR ADDITIONAL COMPENSATION. CALL TEXAS811 TWO WORKING DAYS PRIOR TO CONSTRUCTION FOR ONSITE LOCATIONS.

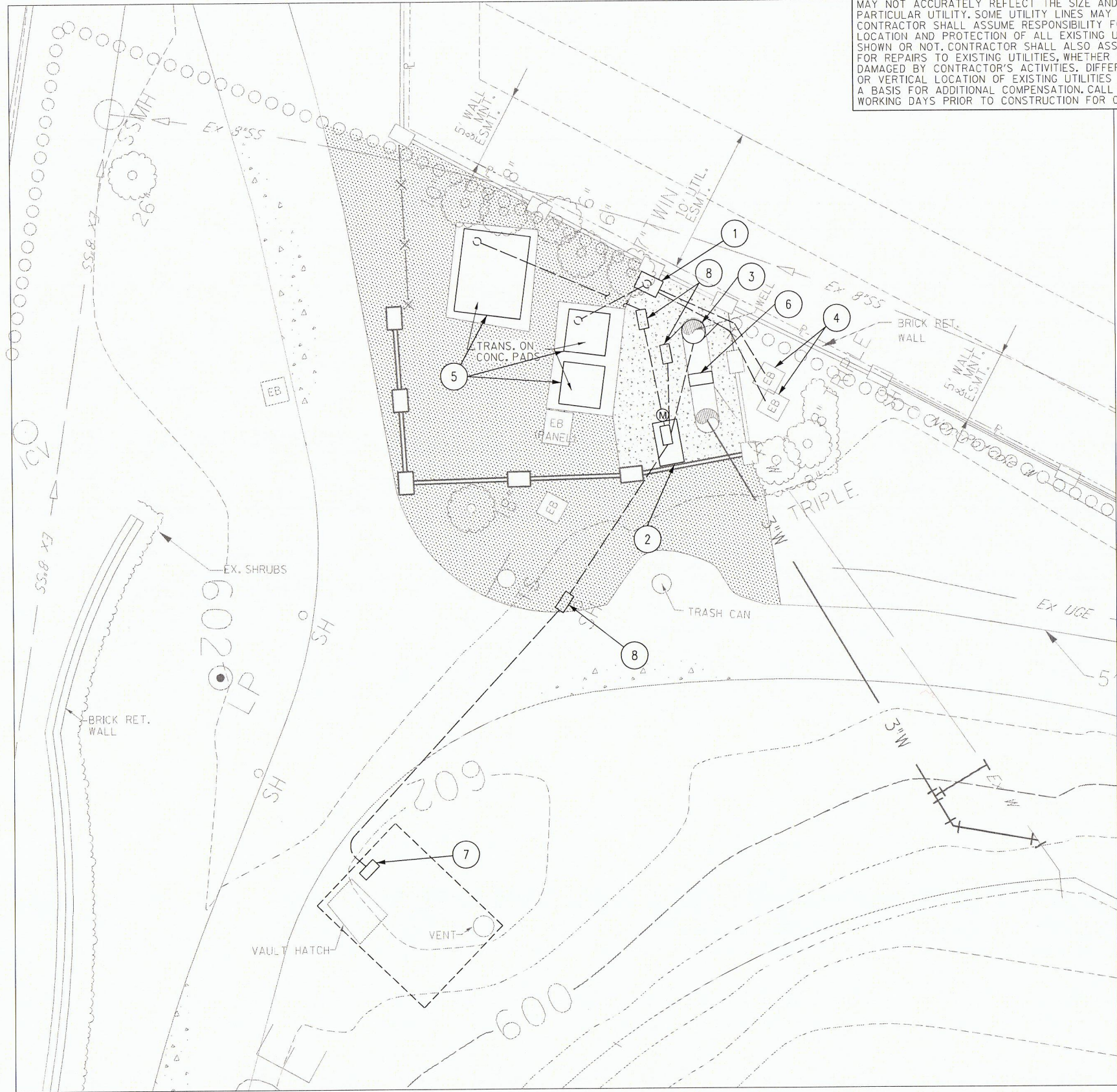
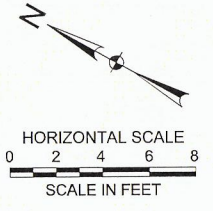

KEY NOTES:

1. IRRIGATION PEDESTAL WITH ELECTRIC METER AND 120/240V PANELBOARD.
2. POWER DISTRIBUTION PEDESTAL WITH ELECTRIC METER AND 277/480V PANELBOARD.
3. WELL PUMP, 30HP, 480V, 3-PH.
4. IRRIGATION CONTROLLERS, EXISTING.
5. UTILITY TRANSFORMERS, EXISTING.
6. MAGNETIC FLOWMETER.
7. ELECTRIC PANEL IN VAULT, EXISTING.
8. GROUND BOX TO INTERCEPT EXISTING CONDUIT. FIELD VERIFY BEST LOCATION.

PROPOSED SITE PLAN  
SCALE 1":4'

LES LACS POND  
WATER WELL REBUILDING PROJECT  
TOWN OF ADDISON  
DALLAS COUNTY, TEXAS



Revision No.	Date	Description



The seal appearing on this document was authorized by JAMES J. WOMACK, PE #55291 on 01-21-16. Fabrication of a sealed document without proper notification to the responsible engineer is an offense under the Texas Engineering Practice Act. The record copy of this drawing is on file at the office of Halff Associates, Inc., Texas 75081. TBPE FORM #P-312.

Project No.:	29751 - WA14
Issued:	1/22/2016
Drawn By:	HALFF
Checked By:	HALFF
Scale:	AS SHOWN
Sheet Title	ELECTRICAL SITE PLAN

E1.01  
Sheet Number