

IRRIGATION LEGEND

- HUNTER MODEL POP ROTOR WITH #9 NOZZLE AT 180 UNLESS OTHERWISE NOTED (P=#12 NOZZLE AT 360, Q=#6 NOZZLE AT 90)
- RAINBIRD MODEL 1804-PRS-SAM POP-UP SPRAY HEAD WITH 15 SERIES NOZZLE
- RAINBIRD MODEL 1812-PRS-SAM POP-UP SPRAY HEAD WITH 15 SERIES NOZZLE
- RAINBIRD 15 SERIES NOZZLE ATOP AN 18" COPPER RISER
- RAINBIRD MODEL 1804-PRS-SAM POP-UP SPRAY HEAD WITH 12 SERIES NOZZLE
- RAINBIRD MODEL 1812-PRS-SAM POP-UP SPRAY HEAD WITH 12 SERIES NOZZLE
- RAINBIRD 12 SERIES NOZZLE ATOP AN 18" COPPER RISER
- RAINBIRD MODEL 1804-PRS-SAM POP-UP SPRAY HEAD WITH 10 SERIES NOZZLE
- RAINBIRD MODEL 1812-PRS-SAM POP-UP SPRAY HEAD WITH 10 SERIES NOZZLE
- RAINBIRD 10 SERIES NOZZLE ATOP AN 18" COPPER RISER
- RAINBIRD MODEL 1804-PRS-SAM POP-UP SPRAY HEAD WITH 8 SERIES NOZZLE
- RAINBIRD MODEL 1812-PRS-SAM POP-UP SPRAY HEAD WITH 8 SERIES NOZZLE
- RAINBIRD MODEL 1804-PRS-SAM POP-UP SPRAY HEAD WITH 15 SST NOZZLE
- RAINBIRD MODEL 1812-PRS-SAM POP-UP SPRAY HEAD WITH 15 SST NOZZLE
- RAINBIRD MODEL 1804-PRS-SAM POP-UP SPRAY HEAD WITH 17 SST NOZZLE
- RAINBIRD MODEL 1812-PRS-SAM POP-UP SPRAY HEAD WITH 17 SST NOZZLE
- RAINBIRD FEB SERIES VALVE, SIZED AS SHOWN
- 4" GATE VALVE
- 2" FIBCO 865 Y DOUBLE CHECK VALVE ASSEMBLY
- 2" WATER METER
- RAINBIRD 3RC QUICK COUPLER VALVE
- RAINBIRD ESC-SAT-B+-SS SERIES, 24 STATION CONTROLLER/FIELD SATELLITE UNIT
- LATERAL LINE
- 2" MAIN LINE

MATCH LINE C

Marsh Lane

Plaza A Enlargement
Scale 1" = 10'-0"

Gardenbrook Drive

Beltway Drive

Chatham Court

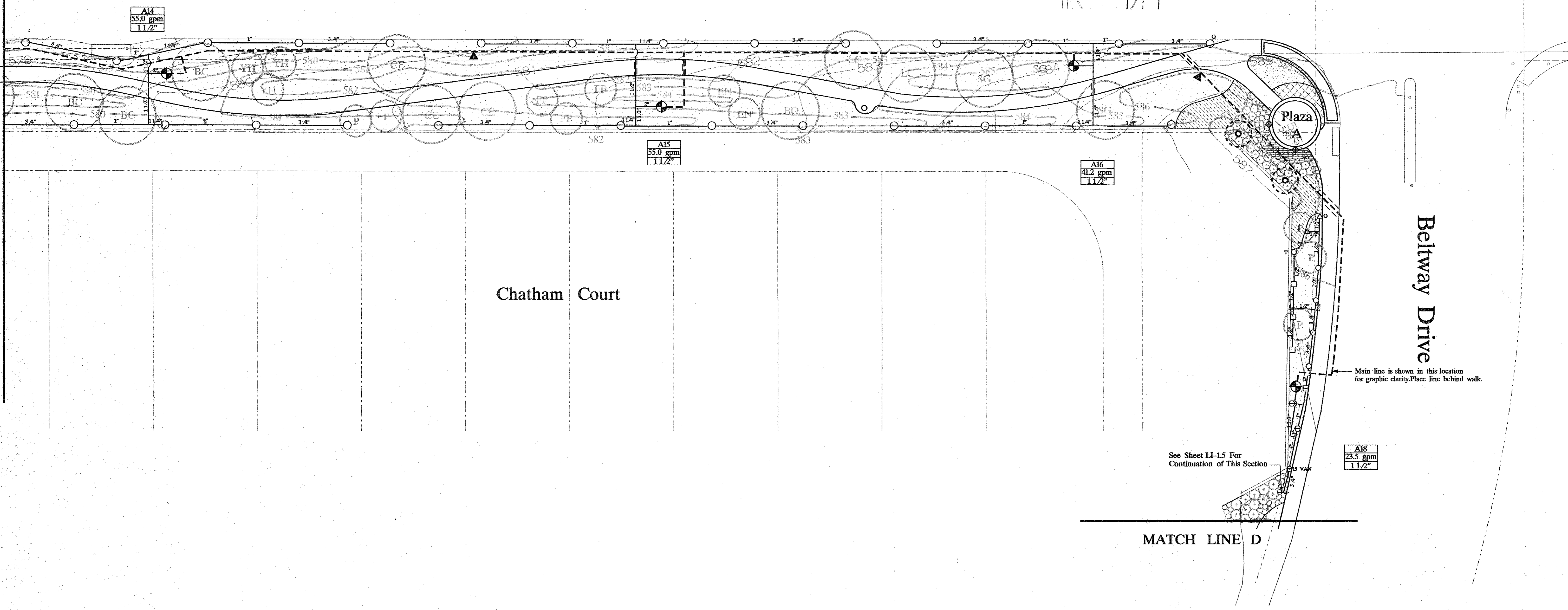

See Sheet LI-1.5 For Continuation of This Section

MATCH LINE D

Main line is shown in this location for graphic clarity. Place line behind walk.

1518P-AN LANDPLAN 93324001A 240 IRDDA.DGN - 08/11/94 11:35:38
 1418P-AN LANDPLAN 93324001A 240 IRDDA.DGN - 08/11/94 11:35:38
 1318P-AN LANDPLAN 93324001A 240 IRDDA.DGN - 08/11/94 11:35:38
 1218P-AN LANDPLAN 93324001A 240 IRDDA.DGN - 08/11/94 11:35:38
 1118P-AN LANDPLAN 93324001A 240 IRDDA.DGN - 08/11/94 11:35:38
 1018P-AN LANDPLAN 93324001A 240 IRDDA.DGN - 08/11/94 11:35:38
 918P-AN LANDPLAN 93324001A 240 IRDDA.DGN - 08/11/94 11:35:38
 818P-AN LANDPLAN 93324001A 240 IRDDA.DGN - 08/11/94 11:35:38
 718P-AN LANDPLAN 93324001A 240 IRDDA.DGN - 08/11/94 11:35:38
 618P-AN LANDPLAN 93324001A 240 IRDDA.DGN - 08/11/94 11:35:38
 518P-AN LANDPLAN 93324001A 240 IRDDA.DGN - 08/11/94 11:35:38
 418P-AN LANDPLAN 93324001A 240 IRDDA.DGN - 08/11/94 11:35:38
 318P-AN LANDPLAN 93324001A 240 IRDDA.DGN - 08/11/94 11:35:38
 218P-AN LANDPLAN 93324001A 240 IRDDA.DGN - 08/11/94 11:35:38
 118P-AN LANDPLAN 93324001A 240 IRDDA.DGN - 08/11/94 11:35:38
 018P-AN LANDPLAN 93324001A 240 IRDDA.DGN - 08/11/94 11:35:38
 DON-AN LANDPLAN 93324001A 240 IRDDA.DGN - 08/11/94 11:35:38

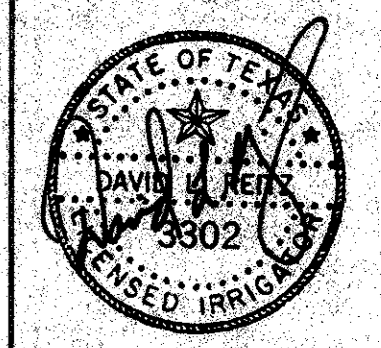

LES LACS LINEAR PARK
 TOWN OF ADDISON PARKS & LEISURE SERVICES DEPARTMENT 16801 WESTGROVE ROAD ADDISON, TEXAS 75001 214/450-2851
 7800 BLAIRBROOK DRIVE SUITE 250 DALLAS, TEXAS 75247-4885
 (214) 688-1846 FAX (214) 688-0447

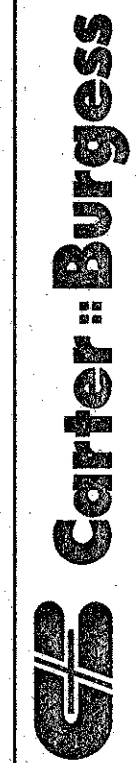

REVISIONS	
JOB NUMBER	93324001D
DESIGNED	SLA
DRAWN	SLA
CHECKED	DLR/LEO
ISSUE DATE	August 18, 1994
SHEET NUMBER	LI-1.4

Irrigation Plan Area Four