



SCALE: 1" = 30'

FOR PROPOSED CHANNEL, SEE SHEET 2

FOR MARSH LANE DITCH SECTION & HYDRAULICS SEE SHEET 2

4 x 36" R.C.P. (ON 3.0%) & HEADWALLS

PEBBLE BEACH DRIVE

MARSH LANE

MARSH LANE

SIDNEY (UNPAVED)

DRIVE (UNPAVED)

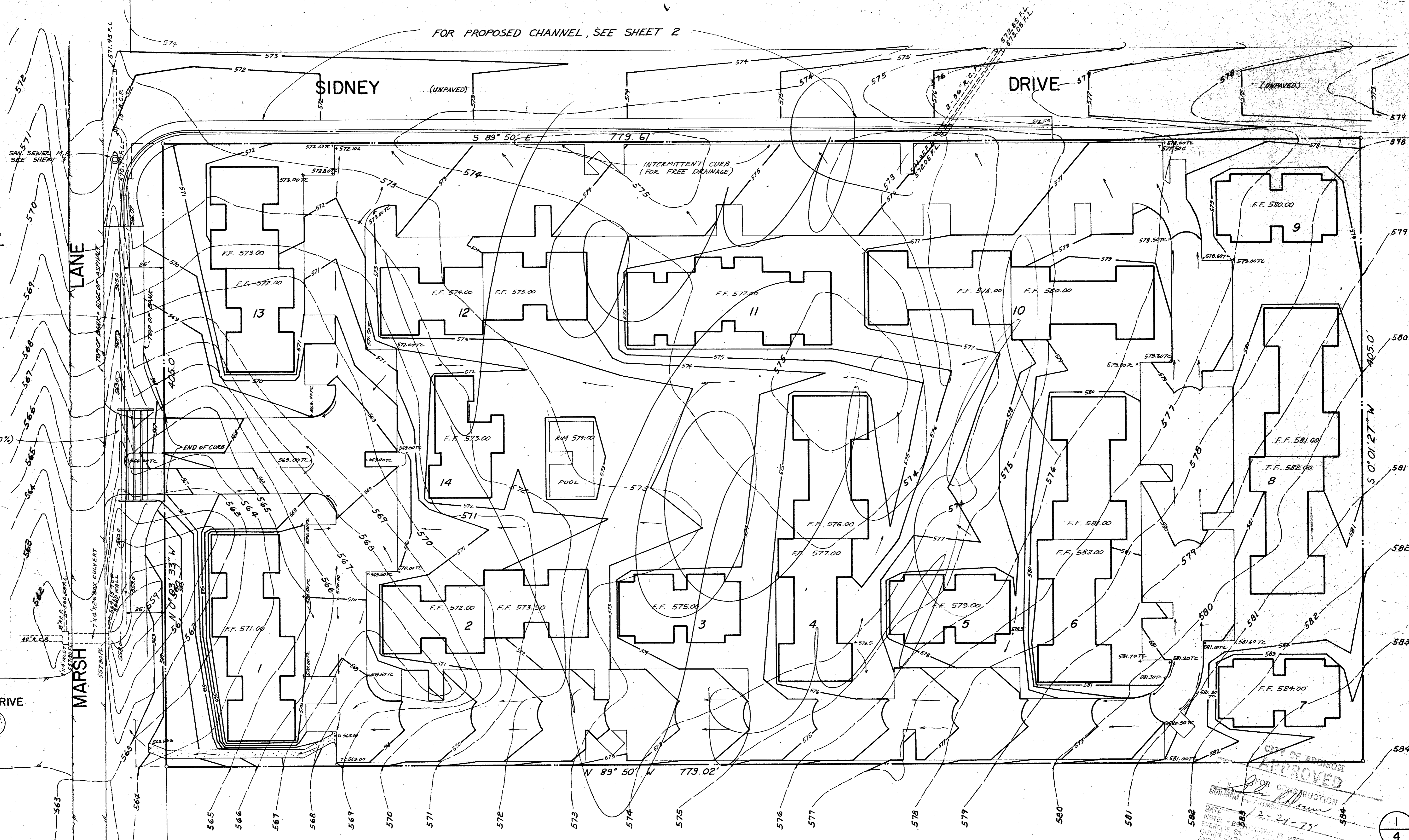

NOTES:

1. ALL EXISTING INFORMATION (INCLUDING BOUNDARY & TOPO.) ARE FROM SURVEYS BY FREEMAN GRIZZARD, DATED DEC. 3 & 6, 1975

BENCH MARK

SQUARE CUT TOP LIGHT STANDARD BASE. ELEVATION = 564.33' SEE B.M., NEAR MARSH LANE, LOWER LEFT.

CITY OF ADDISON APPROVED FOR CONSTRUCTION

*[Signature]*

DATE: 12-24-75

NOTE: CONTRACTOR IS HEREBY INSTRUCTED TO OBTAIN NECESSARY PERMITS AND APPROVALS OF THE CITY OF ADDISON AND THE STATE OF TEXAS BEFORE COMMENCING WORK. THIS PLAN IS NOT TO BE CONSIDERED A GUARANTEE OF ACCURACY OR LIABILITY.

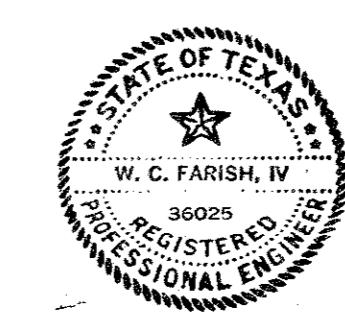

SITE GRADING PLAN

**MARSH LANE PROJECT**

FOR CARL SUMMERS

ADDISON, TEXAS

JOB NO. CI975 DATE DEC. 3, 75

REV. *Carl Somers*

**DONALD E. DAVIS**  
CONSULTING ENGINEERS  
511-9380

1000 McKinney Ave., Dallas, Texas 75202

