

THE NELSON CORPORATION • DALLAS, TEXAS

| REVISION | DATE | DESCRIPTION | DRAWN BY | CHECKED BY |
|----------|------|-------------|----------|------------|
| | | | | |
| | | | | |
| | | | | |

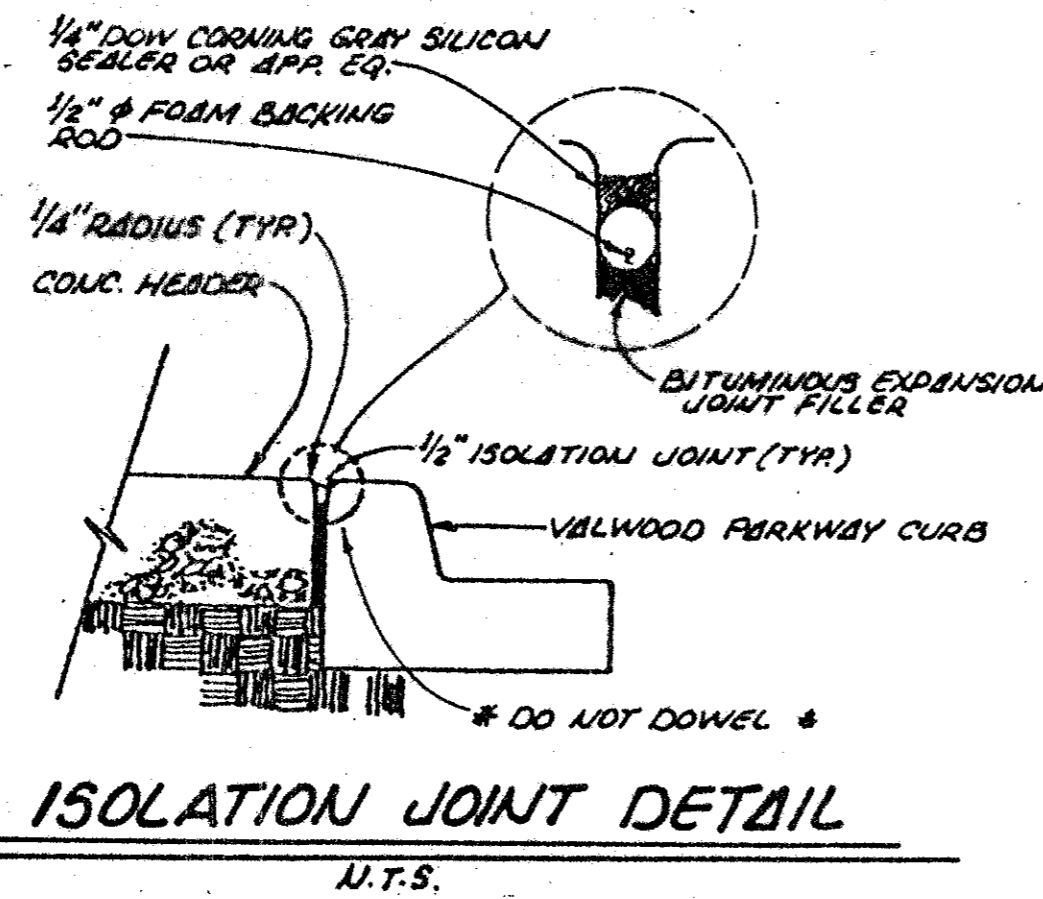

TANGLEWOOD DRIVE

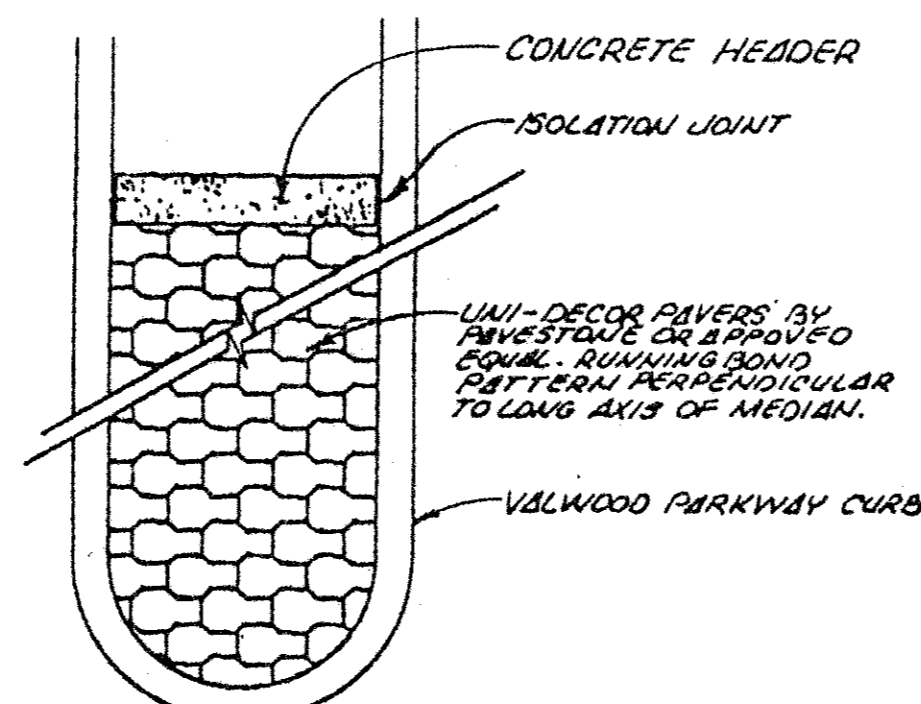
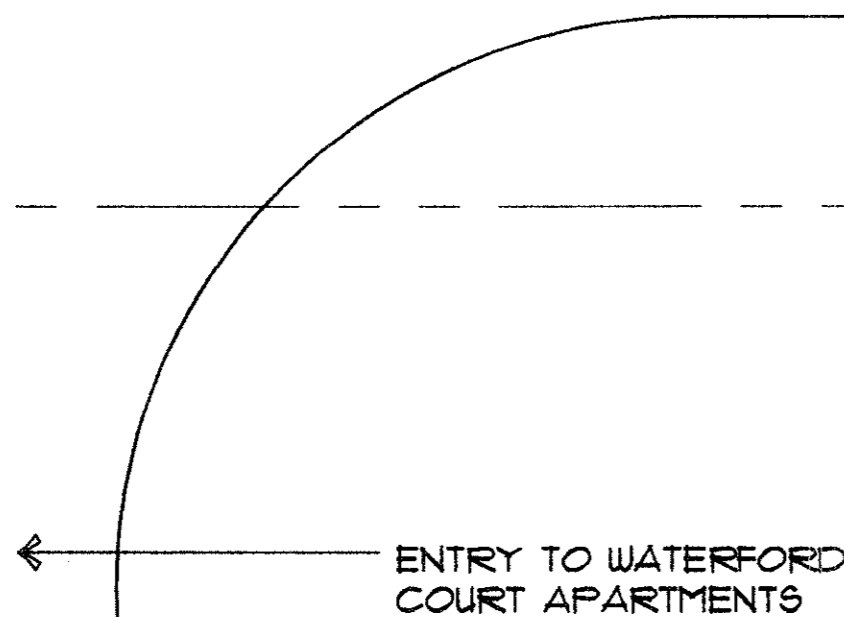
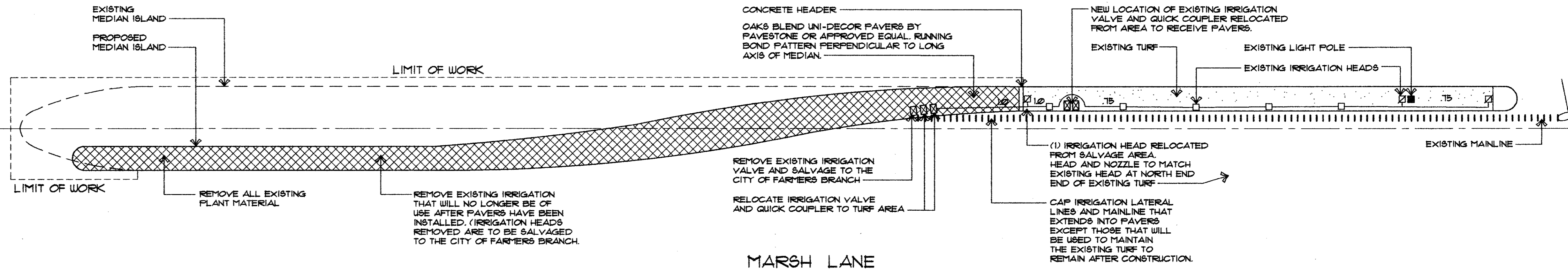

NOTE: CONCRETE HEADER SHALL HAVE AN "X" CHISELED WHERE EACH CONDUIT SLEEVE IS LOCATED.

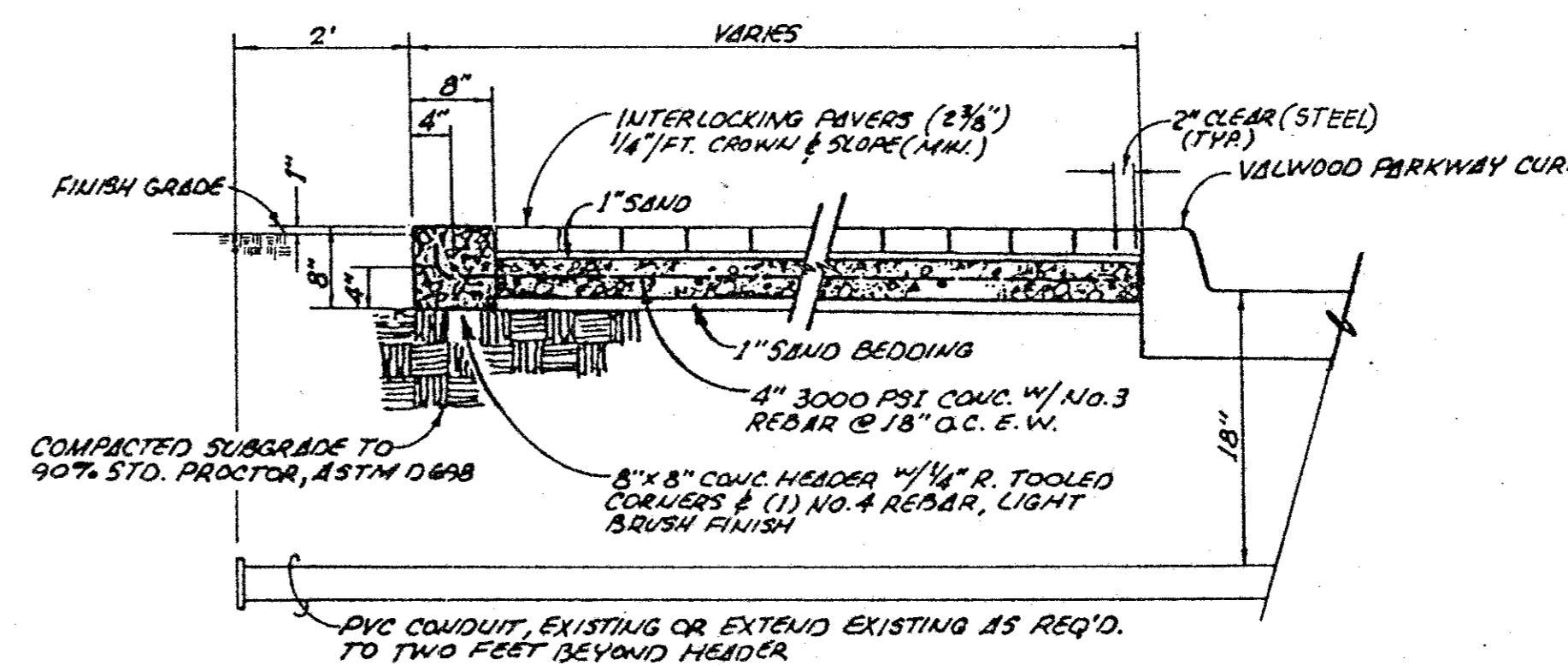

AS BUILTS
THE INTENT OF THE OWNER AND ENGINEER WAS TO CONSTRUCT THE FACILITIES ACCORDING TO THESE PLANS AS APPROVED BY THE CITY OF ADDISON. THE LINES AND GRADES WERE SET ON THE GROUND FOR CONSTRUCTION ACCORDING TO SAID PLANS. THE CITY OF ADDISON INSPECTED THE CONSTRUCTION. THE OWNER OR ENGINEER DID NOT VERIFY LINES OR GRADES AFTER CONSTRUCTION. WE ARE NOT AWARE OF ANY CHANGES OR REVISIONS TO THESE PLANS DURING CONSTRUCTION EXCEPT AS NOTED.

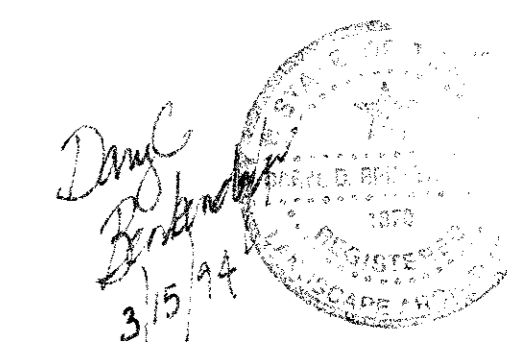
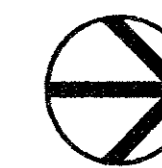

| | | | | | |
|---|-------|--------------|-----------|----------|-----------|
| MEDIAN IMPROVEMENT PLAN | | | | | |
| WATERFORD COURT APARTMENTS | | | | | |
| CITY OF FARMERS BRANCH | | | | | |
| THE NELSON CORPORATION | | | | | |
| <small>PLANNING ENGINEERING SURVEYING LANDSCAPE ARCHITECTURE CONSTRUCTION MANAGEMENT</small> | | | | | |
| <small>5999 SUMMERSIDE DRIVE SUITE 202 DALLAS, TEXAS 75252 (214) 980-2605</small> | | | | | |
| DESIGN | DRAWN | DATE | SCALE | FILE | SHEET NO. |
| TNC | TNC | DEC. 8, 1993 | 1"=10'-0" | 68126.10 | 11 |