

BELT LINE ROAD

POINT OF COMMENCING

PART OF LOT 1, BLOCK A
LES LACS PLAZA SUBDIVISION
VOL. 83064, PG. 2724

LOT 1, BLOCK A
BOSTON CHICKEN ADDITION
VOL. 94102, PG. 1418

ZONED PD 625
TOWN OF ADDISON ZONING MAP
REVISED JULY 15, 1993

ONE STORY BRICK BLDG.
[15050 MARSH LANE]

NEW
FAZOLI'S
RESTAURANT

LOT 3, BLOCK D
TOWN CENTER ADDITION

VICINITY MAP:

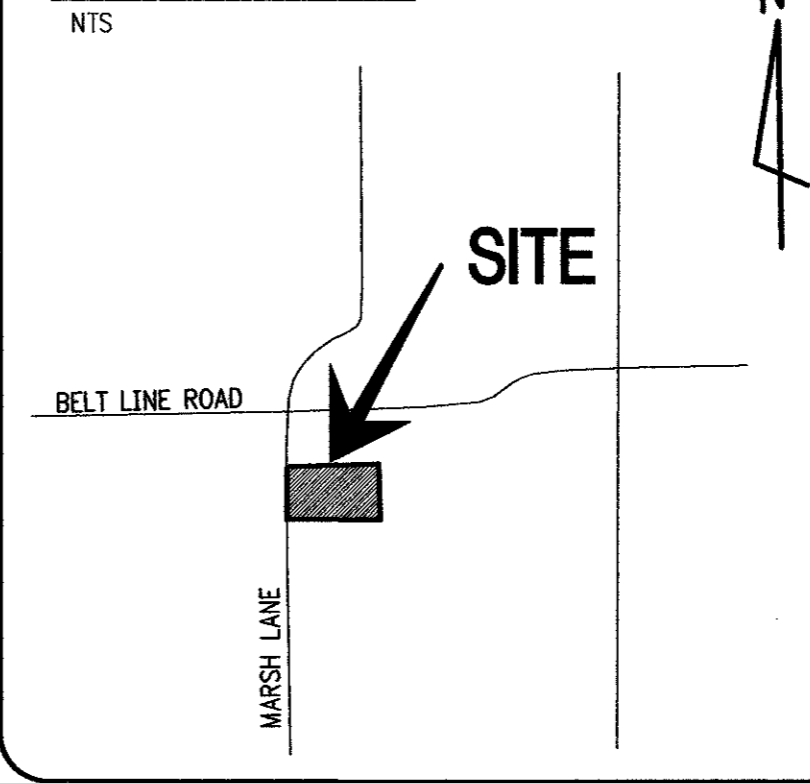

OWNER:

NTS
PASTA PROPERTIES
7432 WEST SAHARA
SUITE 183
LAS VEGAS, NV 89117
702-254-7400

UTILITY NOTES:

ELECTRIC SERVICE

- TXU ELECTRIC AND GAS
(972) 323-8913
THE G.C. SHALL BE RESPONSIBLE FOR ALL COSTS RELATED TO PROVIDING ELECTRIC SERVICE FOR THE NEW FAZOLI'S FACILITY. THE G.C. SHALL CONFIRM ALL COSTS PRIOR TO BIDDING.
- NEW ELECTRIC CONNECTION POINT FOR UNDERGROUND ELECTRIC SERVICE AT THIS LOCATION. (SEE SHT. E-1.)
 - NEW SECONDARY ELECTRIC CABLE AS REQUIRED BY G.C. G.C. TO CONFIRM \forall UTILITY CO. PRIOR TO BIDDING. G.C. IS RESPONSIBLE FOR ALL COSTS ASSOCIATED WITH NEW ELECTRIC SERVICE (CONDUIT, CABLE, ETC.)
 - NEW ELEC. CONNECTION LOCATION VERIFY WITH UTILITY COMPANY. G.C. TO PROVIDE (2) 4" SCH 40 CONDUITS W/ PULL STRING, 39" DEEP MIN. ALL BENDS ARE TO BE LONG SWEEP 36" RADIUS GALV. IRON.
 - NEW CONDUIT AND WIRE BY G.C. TO NEW SIGNS, REMOTE STORAGE ROOM AND LIGHTS, SEE E-SHEETS IN THIS SET.
 - G.C. TO PROVIDE WIRING & CONDUIT FOR MENU BOARD, COMMUNICATION AND TIMING SYSTEMS AS REQUIRED. SEE ELECTRICAL SHEET E-4 IN THIS SET.
 - NEW ELECTRIC SERVICE (PRIMARY). G.C. TO INSTALL & VERIFY NEW POURED IN PLACE PAD LOCATION \forall UTILITY.
 - G.C. TO INSTALL OWNER PROVIDED LOOP DETECTOR IN CONC. SLAB PER MANUF. REQUIREMENTS. G.C. TO COORDINATE W/ OWNER FOR TIMELY DEL.
 - G.C. TO PROVIDE TRANSFORMER PAD, CONDUITS, ETC. AS REQUIRED BY UTILITY COMPANY.

WATER SERVICE

- TOWN OF ADDISON, PUBLIC WORKS
(972) 458-2871 MIKE MURPHY
THE G.C. SHALL BE RESPONSIBLE FOR ALL COSTS RELATED TO PROVIDING WATER SERVICE FOR THE NEW FAZOLI'S FACILITY. THE G.C. SHALL CONFIRM ALL COSTS PRIOR TO BIDDING. THE NEW METER SHOULD BE SIZED BASED ON THE NEW 1/2" WATER SERVICE.
- 1/2" WATER BLDG. CONNECTION POINT, SEE NOTE 2. EXISTING WATER METER, FIELD VERIFY IF REQUIRED.
 - 1" DOMESTIC METER VAULT.
 - NEW WATER CONNECTION BY UTILITY OR G.C., G.C. TO CONFIRM.
 - 1/2" TYPE "K" DOMESTIC WATERLINE BY G.C.
 - COUBLE CHECK VALVE VAULT PER CITY SPEC'S.
 - 1" IRRIGATION METER VAULT.
 - 4" C900 PVC FIRE WATER LINE.
 - 6" C900 PVC FIRE WATER LINE.

SANITARY SEWER

- TOWN OF ADDISON, PUBLIC WORKS
(972) 458-2871 MIKE MURPHY
- THE G.C. SHALL BE RESPONSIBLE FOR ALL COSTS RELATED TO PROVIDING SANITARY SEWER SERVICE FOR THE NEW FAZOLI'S FACILITY. THE G.C. SHALL CONFIRM ALL COSTS PRIOR TO BIDDING.
 - THE CONTRACTOR IS ADVISED A TRENCH SHIELD AND/OR SHORING DESIGNED IN ACCORDANCE WITH OSHA STANDARDS SHALL BE USED IN ALL OPEN TRENCH EXCAVATIONS.
 - 4" SCH 40 PVC NON-GREASE SAN. LINE
 - CLEAN OUT. G.C. TO PROVIDE PER THIS SHEET, P1, AND AS REQD. BY CODE.
 - 4" SCH 40 PVC GREASE LADEN SAN. LINE TO GREASE INTERCEPTOR
 - 6" SDR35 SAN. LINE TO EX. MH.
 - 1000 GALLON GREASE INTERCEPTOR BY G.C. PER LOCAL CODE STDS., ONLY IF REQUIRED BY CODE.

GAS SERVICE

- TXU ELECTRIC AND GAS
(972) 323-8913
THE G.C. SHALL BE RESPONSIBLE FOR ALL COSTS RELATED TO PROVIDING GAS SERVICE FOR THE NEW FAZOLI'S FACILITY. THE G.C. SHALL CONFIRM ALL COSTS PRIOR TO BIDDING. SEE DETAILS & SPEC'S SHT. C-7.
- NEW GAS METER LOCATION BY G.C. COORDINATE \forall UTILITY.
 - NEW GAS SERVICE LINE BY UTILITY CO. MUST HAVE MIN. 2" PIPE OUTSIDE OF BUILDING FOR CONNECTION.
 - G.C. TO VERIFY \forall UTILITY GAS LINE LOCATION.

TELEPHONE SERVICE

- SOUTHWESTERN BELL
(800) 499-7928
THE G.C. SHALL BE RESPONSIBLE FOR ALL COSTS RELATED TO PROVIDING TELEPHONE SERVICE FOR THE NEW FAZOLI'S FACILITY. THE G.C. SHALL CONFIRM ALL COSTS PRIOR TO BIDDING.
- TELEPHONE CONNECTION LOCATION SEE E1. COORDINATE \forall APPROPRIATE UTILITY COMPANY.
 - NEW TELEPHONE LINE/ CONDUIT IN ELEC. TRENCH. CONFIRM REQUIREMENTS W/ UTILITY CO. PRIOR TO BIDDING.

LIGHTING SCHEDULE:

- 1ASB RS MH1000 28, SINGLE HEAD, 1/1000W, 28' POLE
- 2ASB RS MH1000 28, DUAL HEAD, 90° BRACKET, 2/1000W, 28' POLE
- 2ASB RS MH1000 28, DUAL HEAD, 45° BRACKET, 2/1000W, 28' POLE
- 3ASB RS MH1000 28, TRIPLE HEAD, 3/1000W, 28' POLE

- NOTES:
1. ALL LIGHT FIXTURES, POLES, BRACKETS, ANCHOR BOLTS, ETC., ARE PROVIDED BY THE E.C. NO SUBSTITUTIONS ARE ALLOWED. LIGHTING MATERIALS CAN BE OBTAINED FROM ACCUSERVE, MR. RAY ZIMMERER, 582-961-0096. G.C. SHALL INSTALL ALL LIGHTING EQUIPMENT & PROVIDE CONCRETE BASES PER 6/C-6.

SITE UTILITY PLAN

SCALE: 1" = 20'-0"

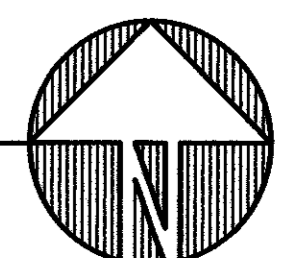
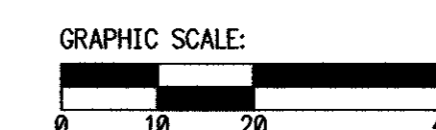

REVISIONS:	
1	11/15/99
2	12/22/99
3	01/17/00 AS-BUILT CLOUDED SECTION ONLY
4	
5	
6	
7	
8	
9	
10	
11	
12	

JOB NO.:
99154

FAZOLI'S RESTAURANT
MARSH LANE AT BELT LINE ROAD
ADDISON, TX

The Roberts Group, P.S.C.
239 Southland Drive
Suite C
Lexington, KY 40503
(606) 276-2006

THESE PLANS AND DETAILS ARE TRAINED HEREIN ARE FAZOLI'S AND CANNOT BE USED, CHANGED IN ANY WAY WITHOUT THE EXPRESS PERMISSION OF FAZOLI'S

DATE: 09/30/99

DRAWN BY: TRC

CHECKED BY: TRC



SITE UTILITY PLAN

SHEET NO.

C-3

AS-BUILT DRAWINGS:
THE INTENT OF THE OWNER AND ENGINEER WAS TO CONSTRUCT THE FACILITIES ACCORDING TO THESE PLANS AS APPROVED BY THE TOWN OF ADDISON. THE OWNER OR ENGINEER DID NOT VERIFY LINES OR GRADES AFTER CONSTRUCTION AND ARE NOT AWARE OF ANY CHANGES OR REVISIONS TO THESE PLANS DURING CONSTRUCTION EXCEPT AS NOTED BASED ON INFORMATION PROVIDED BY THE CONTRACTOR.

VAUGHN R. HILL PE # 65493

DATE

2/4/00