

VICINITY MAP

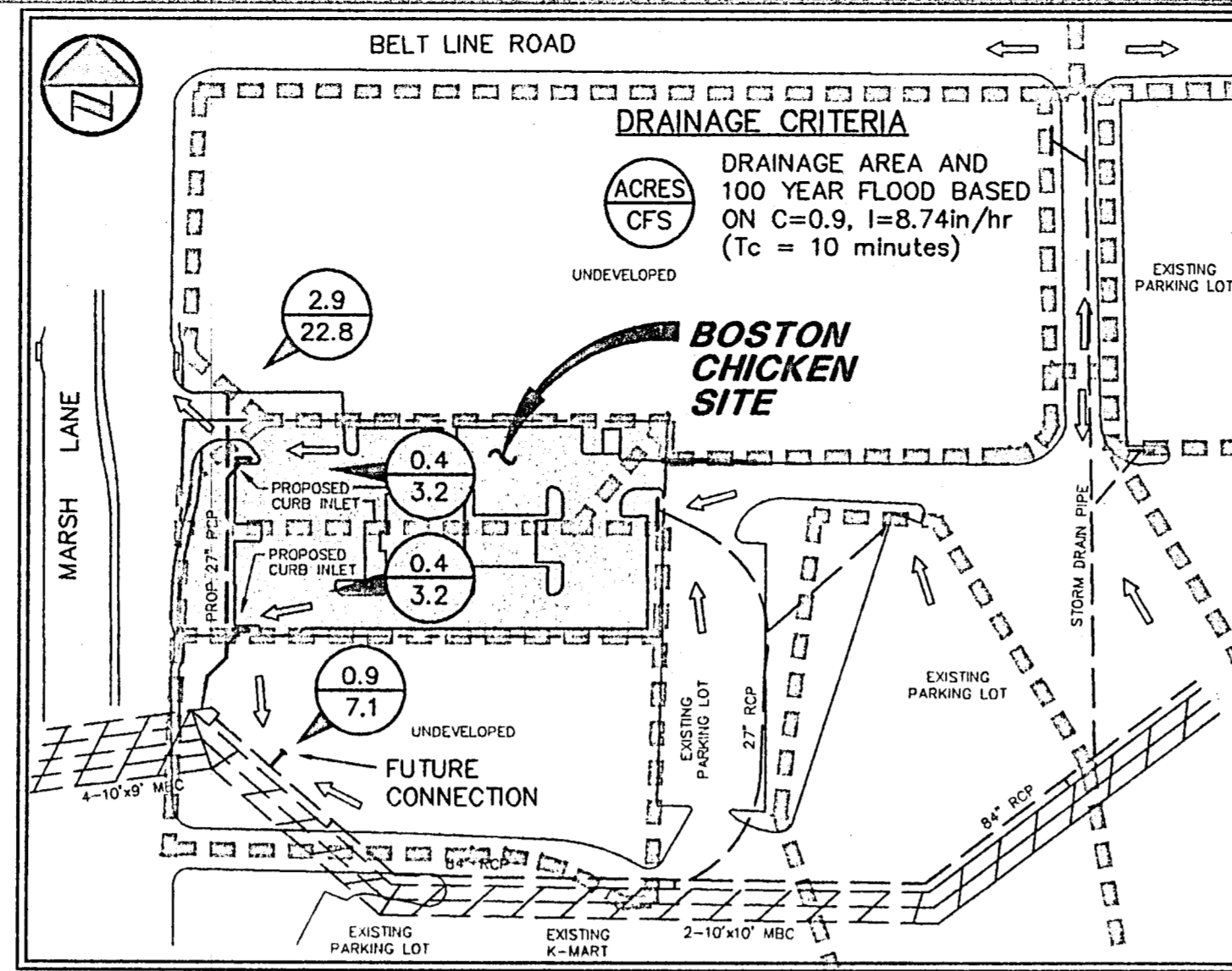

DRAINAGE AREA MAP

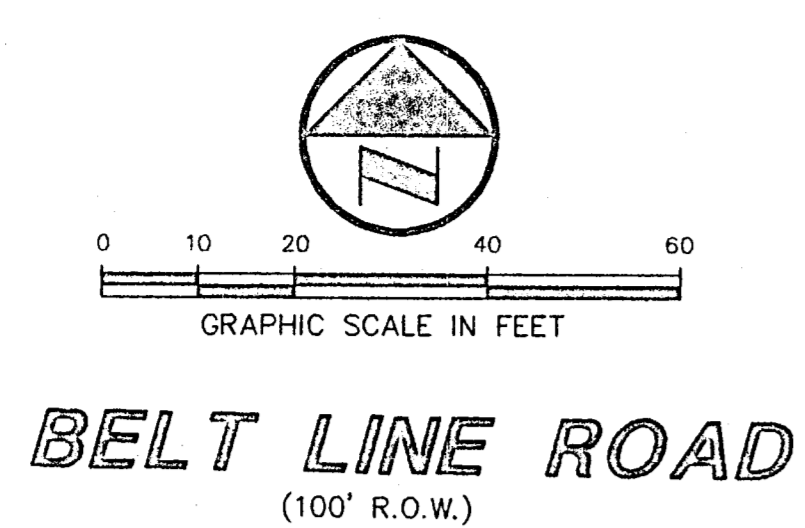
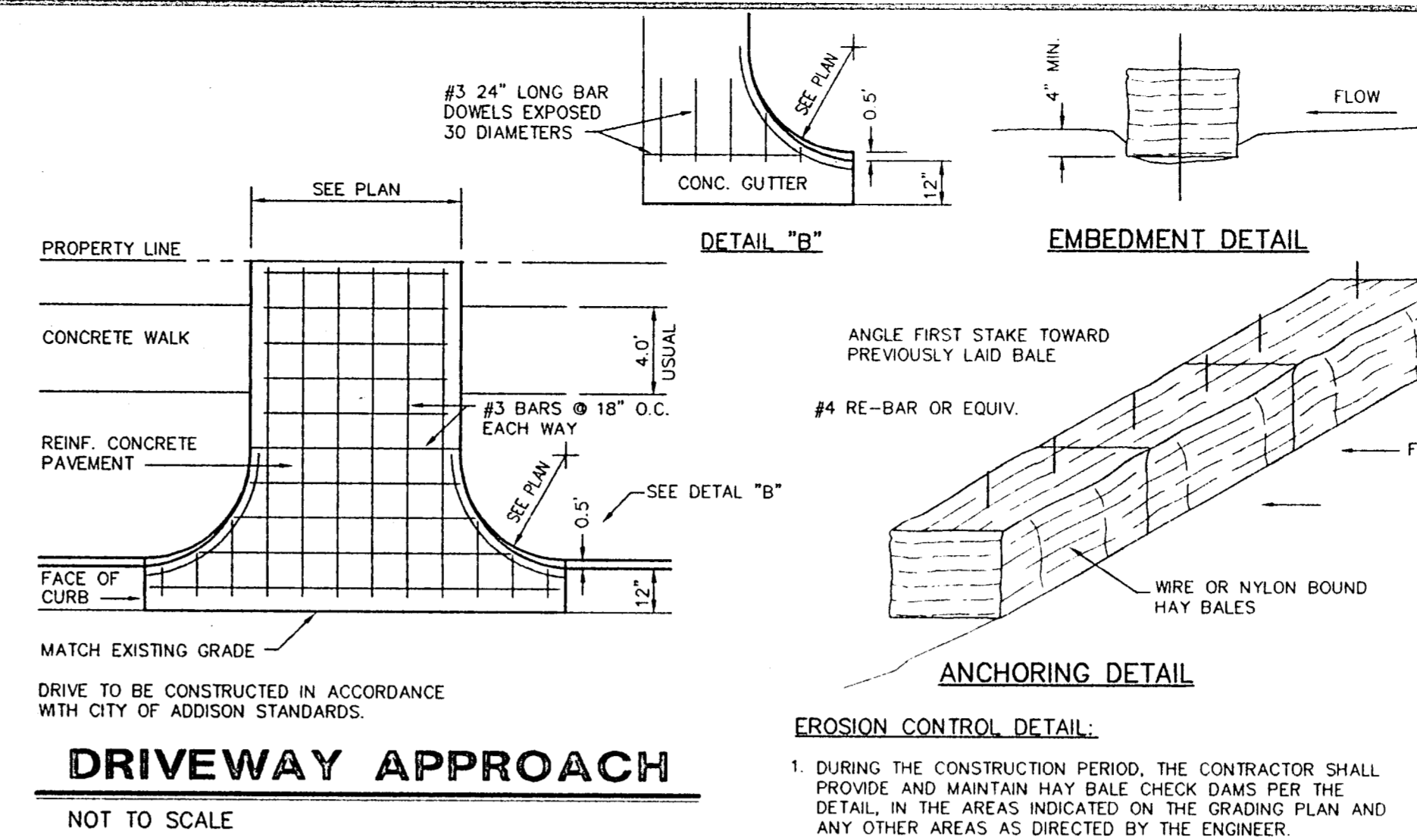

DRIVEWAY APPROACH

NOT TO SCALE

LEGEND

- GM GAS METER
- FH FIRE HYDRANT
- WM MANHOLE
- CO CLEAN OUT
- WM DALLAS POWER MANHOLE
- WV WATER VALVE
- WM WATER METER
- LS LIGHT STANDARD
- FL FLOOD LIGHT
- PP POWER POLE
- PL PROPERTY LINE
- EX EXISTING CONTOUR
- PR PROPOSED CONTOUR
- EX EXISTING ELEVATIONS
- PR PROPOSED ELEVATIONS
- DR DRAINAGE DIVIDE
- EC EROSION CONTROL

EROSION CONTROL DETAIL

NOT TO SCALE

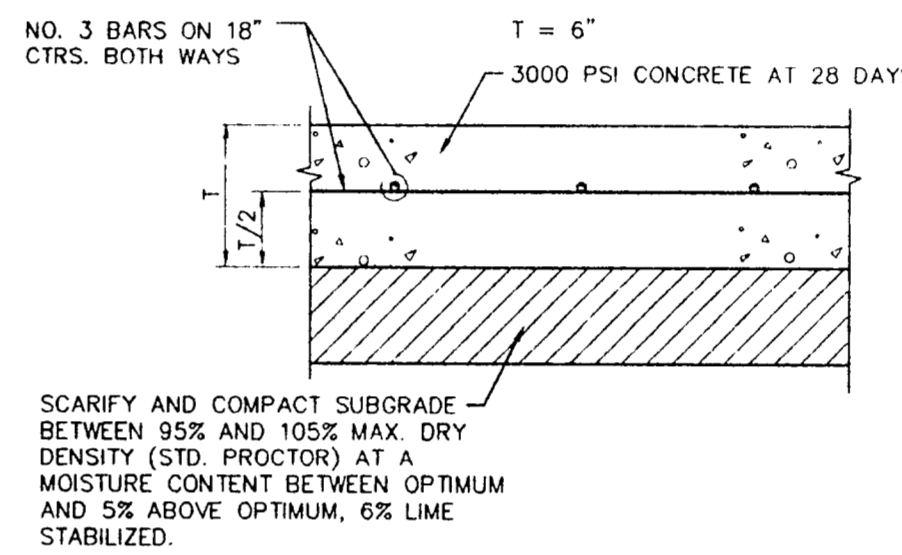

PAVEMENT SECTION

NOT TO SCALE

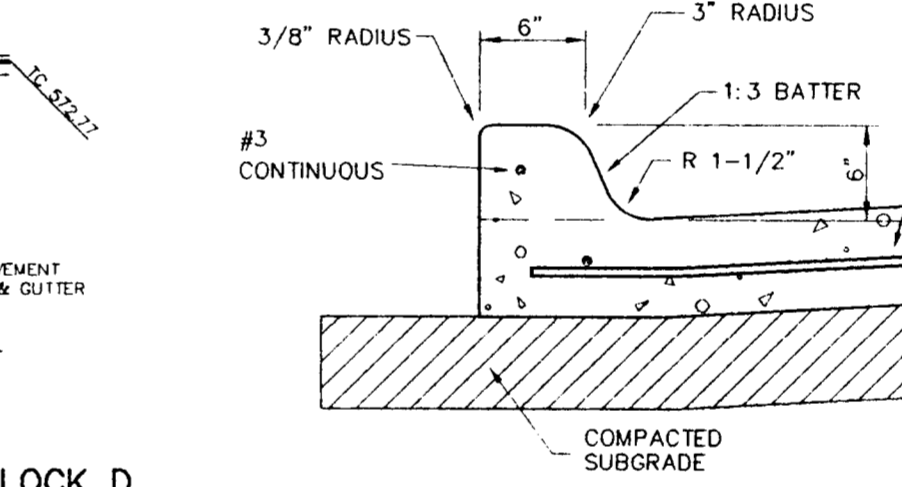

CONCRETE WALK

NOT TO SCALE

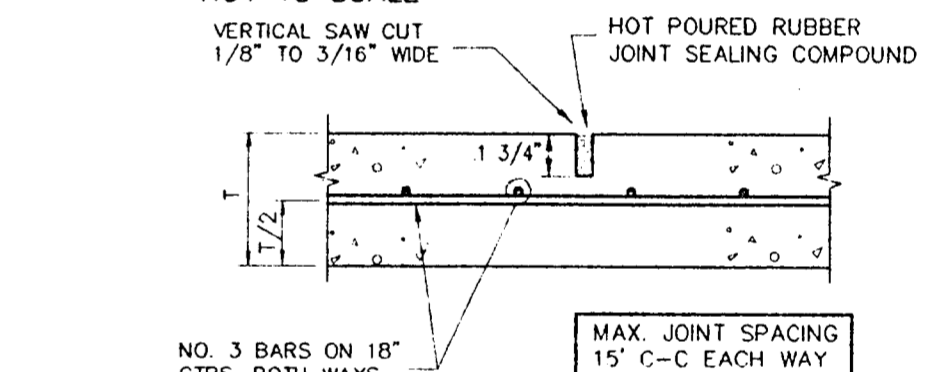

SAWED DUMMY JOINT

NOT TO SCALE

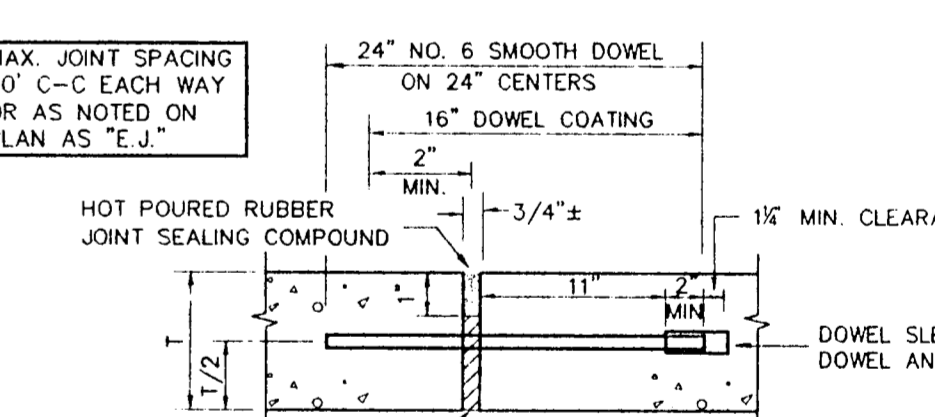

INTEGRAL CURB

NOT TO SCALE

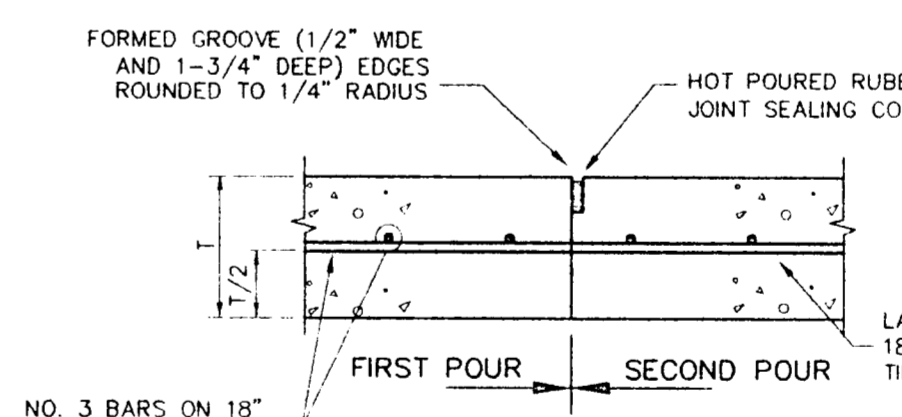

CONSTRUCTION JOINT

NOT TO SCALE

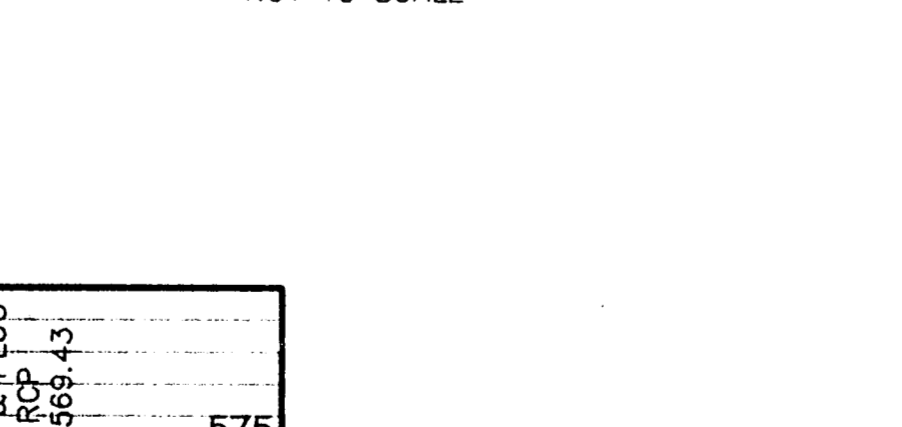

EXPANSION JOINT

NOT TO SCALE

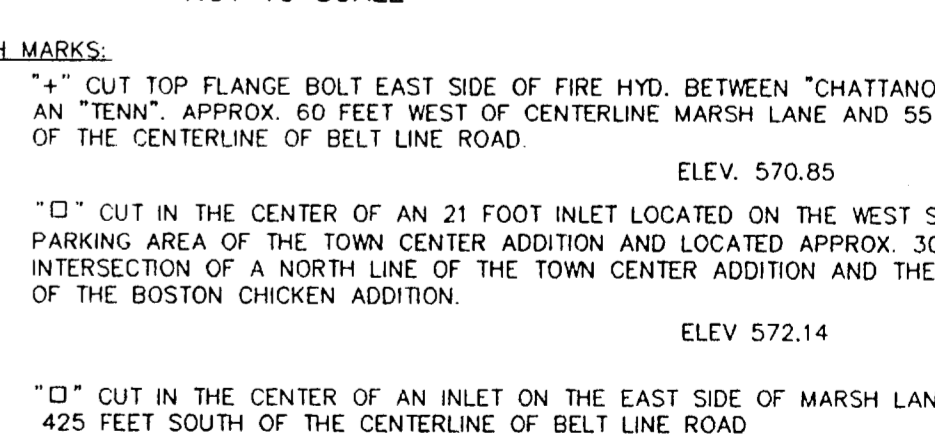

- NOTES:
- BEARING SYSTEM BASED ON PLAT OF LE LACS PLAZA, AN ADDITION TO THE TOWN OF ADDISON AS RECORDED IN VOLUME 83064, PAGE 2724, DEED RECORDS, DALLAS COUNTY, TEXAS.
 - THE LOCATION AND SIZES OF UNDERGROUND UTILITIES PORTRAYED HAVE BEEN BASED ON INFORMATION ON FILE WITH THE TOWN OF ADDISON.

PART OF LOT 1, BLOCK A
LES LACS PLAZA SUBDIVISION
V 83064, P 2724

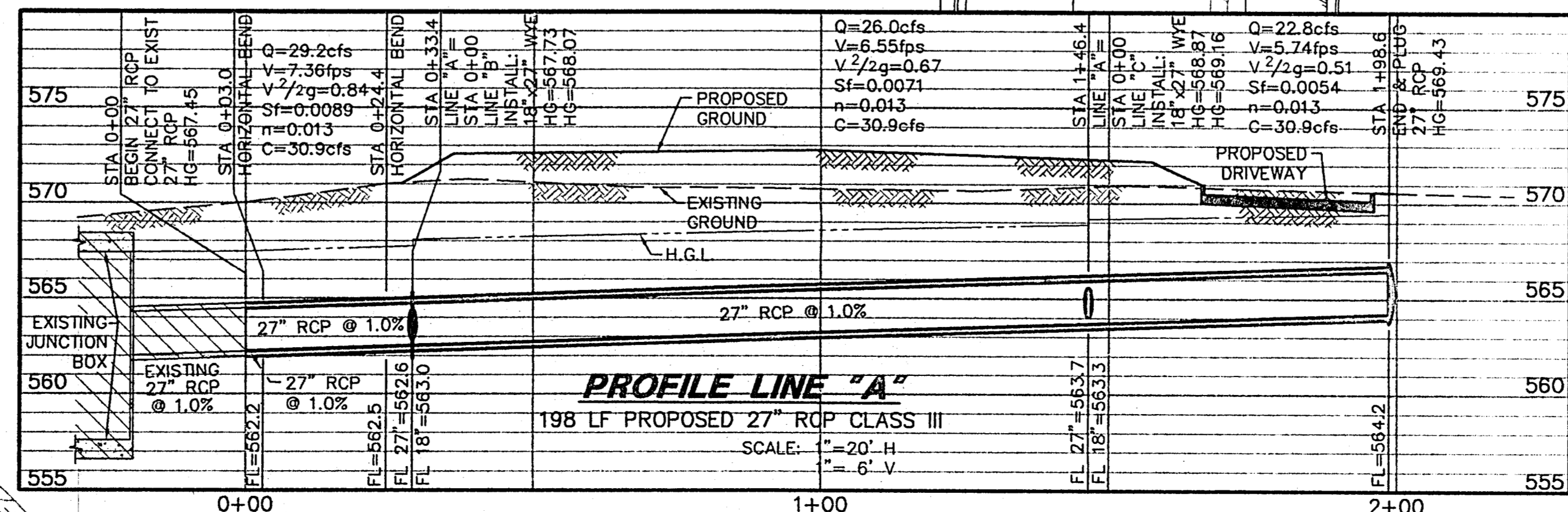
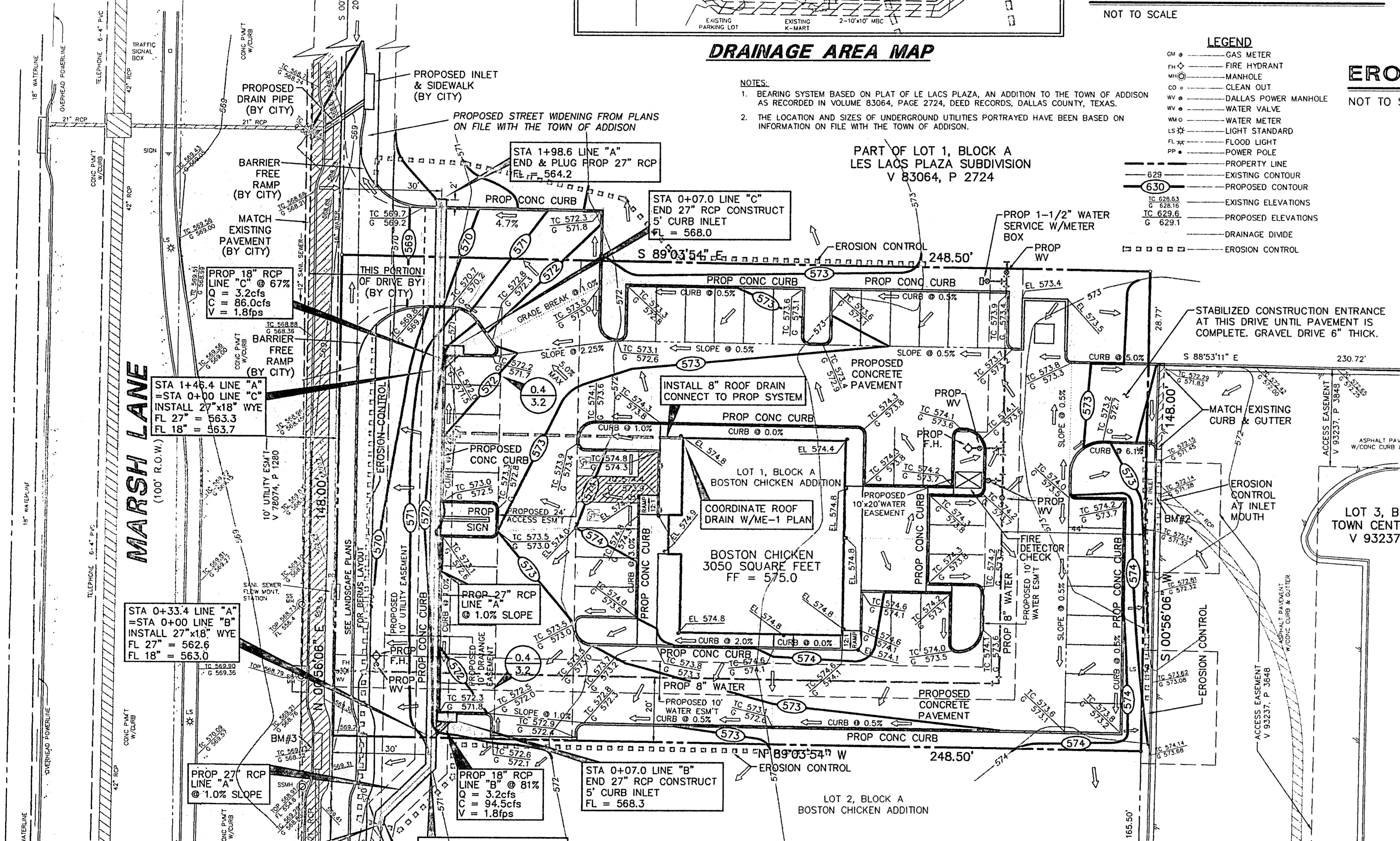

PROFILE LINE "A"

198 LF PROPOSED 27" RCP CLASS III

SCALE: 1"=20' H
1"=6' V

- PAVING AND DRAINAGE GENERAL NOTES
- ALL WORK, UNLESS OTHERWISE NOTED, SHALL CONFORM TO THE STANDARD SPECIFICATIONS FOR PUBLIC WORKS CONSTRUCTION, ISSUED BY THE NORTH CENTRAL TEXAS COUNCIL OF GOVERNMENTS, AND CITY OF ADDISON STANDARD CONSTRUCTION SPECIFICATIONS.
 - UNLESS OTHERWISE NOTED, ALL CONCRETE SHALL BE CLASS "A", (3000 PSI).
 - THE HORIZONTAL AND VERTICAL LOCATIONS OF EXISTING SUBSURFACE UTILITIES HAVE BEEN DETERMINED FROM DATA RECORDED BY OTHERS. CONTRACTOR SHALL VERIFY THAT NECESSARY CROSSING CLEARANCES BETWEEN EXISTING AND PROPOSED UTILITIES EXIST PRIOR TO CONSTRUCTION OF ANY SUCH CROSSING. IT WILL BE THE RESPONSIBILITY OF THE CONTRACTOR TO PROTECT ALL PUBLIC UTILITIES IN THE CONSTRUCTION OF THIS PROJECT.
 - CONTRACTOR SHALL MAINTAIN ONE SET OF "RECORD DRAWINGS" ON SITE WHICH WILL BE SUBMITTED TO OWNER OR ENGINEER UPON COMPLETION OF THE PROJECT. RECORD DRAWINGS SHALL INDICATE THE LOCATION OF ALL SUBTERRANEAN UTILITY IMPROVEMENTS, AND INDICATE TIES TO ALL MANHOLES, CULVERTS, INLETS, JUNCTION BOXES, ETC.
 - THE CONTRACTOR IS RESPONSIBLE FOR COMPLIANCE WITH ALL FEDERAL, STATE AND LOCAL REGULATIONS REGARDING TRENCH SAFETY.
 - STORM DRAIN LINES MAY BE OF THE FOLLOWING MATERIALS:
 - a. RCP C-76, CLASS III
 INSTALLED IN ACCORDANCE WITH MANUFACTURER'S SPECIFICATIONS.
 - BARRICADING AND PROJECT SIGNS SHALL CONFORM TO "STATE DEPARTMENT OF HIGHWAYS AND PUBLIC TRANSPORTATION BARRICADING AND CONSTRUCTION STANDARDS."
 - PRIOR TO COMMENCEMENT OF CONSTRUCTION, BONDS AND THREE-WAY CONTRACTS SHALL BE SUBMITTED TO THE CITY AS REQUIRED.
 - CONTRACTOR TO HYDROMULCH ALL DISTURBED AREAS NOT IDENTIFIED ON THE LANDSCAPE PLANS.
 - ROOF DRAIN LINES MT BE OF THE FOLLOWING MATERIALS:
 - Mancor - HI-0
 - ADS - N-12

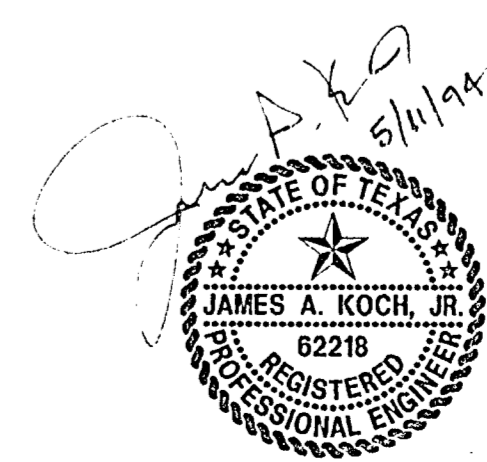

PACHECO KOCH 9401 LBJ Freeway, Suite 300
Consulting Engineers, Inc. Dallas, Texas 75248 (214) 235-8091

GRADING & DRAINAGE
BOSTON CHICKEN ADDITION
MARSH LANE @ BELT LINE ROAD
TL CHENOWETH SURVEY, ABST No. 273
ADDISON, DALLAS COUNTY, TEXAS

DESIGN	DRAWN	DATE	SCALE	NOTES	FILE	NO.
BB	JAK	MAY 1994	1"=20'			