

**TOWN OF ADDISON  
GENERAL NOTES**

- PRIOR TO FINAL ACCEPTANCE BY THE TOWN OF ADDISON, A TEXAS REGISTERED ENGINEER SHALL CERTIFY THAT THE PROJECT WAS CONSTRUCTED IN ACCORDANCE WITH THE PLANS AND SPECIFICATIONS APPROVED BY THE TOWN OF ADDISON.
  - THE OWNER SHALL PROVIDE ONE REPRODUCIBLE SET OF AS-BUILT (SEALED AND CERTIFIED BY A TEXAS REGISTERED ENGINEER) AND TWO BLUELINE SETS TO THE TOWN OF ADDISON.
  - A FIVE FOOT SIDEWALK SHALL BE INSTALLED ALONG THE PUBLIC STREETS. SEE ATTACHED DETAIL DRAWINGS.
  - A ONE YEAR 10% MAINTENANCE BOND IS REQUIRED FOR THE PUBLIC INFRASTRUCTURE.
  - CONTRACTOR SHALL DEMONSTRATE THAT THE WATER AND SANITARY SEWER SYSTEMS MEET THE PROPER PRESSURE, BACTERIA, AND MANDREL TESTS IN ADDITION, THE OWNER SHALL PROVIDE A VHS FORMAT VIDEO TAPE OF THE SANITARY SEWER.
- B. PRIOR TO STARTING CONSTRUCTION, THE CONTRACTOR SHALL CONTACT THE UTILITY COMPANIES TO LOCATE EXISTING FACILITIES. THESE INCLUDE BUT MAY NOT BE LIMITED TO THE FOLLOWING:**
- TOWN OF ADDISON
  - LONG STAR GAS
  - SOUTHWESTERN BELL
  - STORER CABLE
  - PLANNED CABLE SYSTEMS
  - TO ELECTRIC
  - 1-800-05-TESS
- C. PRIOR TO BEGINNING CONSTRUCTION, THE OWNER OR HIS AUTHORIZED REPRESENTATIVE SHALL COVENE A PRECONSTRUCTION CONFERENCE AMONG THE TOWN OF ADDISON, CONSULTING ENGINEERS, CONTRACTORS, UTILITY COMPANIES AND ANY OTHER AFFECTED PARTIES. NOTIFY BRUCE ELLIS (972) 450-2847 AT LEAST 48 HOURS PRIOR TO BEGINNING OF CONSTRUCTION.**
- D. ANY EXISTING PAVEMENT, CURBS, AND/OR SIDEWALKS DAMAGED OR REMOVED WILL BE REPAIRED BY THE CONTRACTOR AT THEIR EXPENSE.**
- E. LOT PINS SHALL BE INSTALLED AFTER CONSTRUCTION AND PRIOR TO FINAL ACCEPTANCE. CONCRETE MONUMENTS SHALL BE PLACED AS SHOWN ON THE FINAL PLAT AND IRON PINS SHALL BE PLACED AT BLOCK CORNERS, CURVE POINTS AND ANGLE POINTS IN PUBLIC RIGHT-OF-WAY. CONCRETE MONUMENTS SHALL BE SIX (6) INCHES IN DIAMETER AND TWENTY-FOUR (24) INCHES LONG. AN IRON ROD ONE-HALF (1 1/2) INCH IN DIAMETER EMBEDDED AT LEAST THREE (3) INCHES IN THE MONUMENT AT THE EXACT INTERSECTION POINT OF THE MONUMENT. THE MONUMENTS SHALL BE SET AT SUCH AN ELEVATION THAT AFTER CONSTRUCTION, THE TOP OF THE MONUMENT WILL BE NOT LESS THAN TWELVE (12) INCHES BELOW THE GROUND SURFACE.**
- F. THE CONTRACTOR SHALL STAMP A 2-INCH "S" AND A 2-INCH "W" IN THE CURB AT THE LOCATION OF THE SEWER SERVICE AND WATER SERVICE LINES RESPECTFULLY.**
- G. AT INTERSECTIONS THAT HAVE VALLEY DRAINAGE, THE CROWN OF THE INTERSECTING STREETS WILL CULMINATE IN A DISTANCE OF 40 FEET FROM THE INTERSECTING CURB LINE UNLESS OTHERWISE NOTED.**
- H. TEMPORARY OR PERMANENT STREET BARRICADES SHALL REMAIN AT ALL POINTS OF INGRESS AND EGRESS TO PREVENT PUBLIC USE UNTIL SUCH STREET RECEIVES FINAL ACCEPTANCE.**
- I. CONTRACTOR SHALL OBTAIN A RIGHT-OF-WAY PERMIT FROM THE TOWN OF ADDISON FOR WORKING WITHIN THE PUBLIC RIGHT-OF-WAY.**
- J. DURING CONSTRUCTION, THE OWNER SHALL PROVIDE A QUALIFIED GEOTECHNICAL LAB TO PERFORM MATERIALS TESTING DURING THE CONSTRUCTION AT THE REQUEST OF THE TOWN OF ADDISON.**
- K. THE CONTRACTOR SHALL SUBMIT MATERIAL SHEETS TO THE TOWN OF ADDISON FOR APPROVAL PRIOR TO INCORPORATING MATERIALS INTO THE JOB.**
- L. THE UTILITY CONTRACTOR SHALL SUBMIT TO THE TOWN OF ADDISON FOR APPROVAL A TRENCH SAFETY PLAN SEALED BY A REGISTERED PROFESSIONAL ENGINEER FOR THE INSTALLATION OF UTILITIES GREATER THAN FIVE(5) FEET IN DEPTH.**
- M. ALL EXISTING AND PROPOSED IMPROVEMENTS (VALVES, MANHOLES, FIRE HYDRANTS, WATER METERS, ETC.) SHALL BE ADJUSTED TO FINISHED GRADE BY THE CONTRACTOR.**

**SITE PLAN NOTES**

- ALL DIMENSIONS ARE TAKEN TO FACE OF CURB OR BUILDING UNLESS OTHERWISE NOTED.
- CONTRACTOR SHALL VERIFY DIMENSIONS AND NOTIFY ENGINEER OF ANY DISCREPANCIES.
- USE DIMENSIONAL INFORMATION GIVEN. DO NOT SCALE DRAWINGS.
- CONTRACTOR SHALL VERIFY EXACT LOCATIONS AND PROTECT ALL EXISTING SITE IMPROVEMENTS AND UTILITIES DURING CONSTRUCTION OPERATIONS.
- ALL WALKWAYS LEADING TO ENTRANCES ARE TO BE CENTERED ON DRIVEWAYS UNLESS OTHERWISE NOTED.
- AT LOCATIONS WHERE EXISTING PAVEMENT ABUTS NEW PAVEMENT, CONTRACTOR SHALL BLEND NEW PAVEMENT TO EXISTING CONDITIONS. PAVEMENTS SHALL ALIGN BOTH VERTICALLY AND HORIZONTALLY. PONDING AT JOINTS WILL NOT BE ACCEPTABLE.
- PROVIDE MINIMUM 1/8" PER FOOT CROSS SLOPE IN DIRECTION OF SURFACE DRAINAGE ON ALL WALKWAYS.
- WHERE NEW CONCRETE PAVEMENT MEETS EXISTING CONCRETE OR VERTICAL SURFACES PROVIDE 1/2" EXPANSION JOINT. WHERE NEW CONCRETE PAVEMENT MEETS EXISTING ASPHALT, SAW CUT EDGE OF ASPHALT AND BUTT NEW PAVEMENT TIGHT. SCORING JOINTS SHALL MATCH EXISTING CONDITION WHERE NEW CONCRETE PAVEMENT REPLACES EXISTING OR ABUTS EXISTING CONSTRUCTION.
- FINISH ON CONCRETE SHALL BE PERPENDICULAR TO TRAFFIC FLOW.
- WHERE NEW ASPHALT PAVEMENT MEETS EXISTING ASPHALT, SAW CUT EXISTING ASPHALT. ALL NEW PAVEMENTS SHALL MEET EXISTING FLUSH.
- PARKING LOT LINES AND TRAFFIC CONTROL MARKINGS SHALL BE PAINTED ON PAVEMENT WITH MINIMUM 4" WIDE LINES OR AS SHOWN ON PLANS.
- PROVIDE EXPANSION JOINT MATERIAL AT ALL LOCATIONS WHERE CURB AND GUTTER ABUTS OR IS ADJACENT TO WALLS.
- AUTOMATIC UNDERGROUND IRRIGATION SYSTEM WILL BE PROVIDED. CONTRACTOR TO PROVIDE SLEEVING FOR UNDERGROUND IRRIGATION SYSTEM AND COORDINATE WITH IRRIGATION PLAN.
- ALL HANDICAP PARKING SPACES SHALL HAVE SIGNS AS INDICATED ON THE PLANS AND AS PER DETAILS.
- LIGHT POLES OR SIGN POLES ARE NOT ALLOWED IN PARKING DRIVEWAY PAVEMENT AREAS. COORDINATE LOCATIONS WITH LANDSCAPE PLAN.
- PIERS FOR LIGHT POLES SHALL NOT BE ABOVE CURB.
- ALL LIGHT POLES WILL BE A MINIMUM THREE (3) FEET BEHIND ANY CURB.
- CONTRACTOR TO ADJUST ALL EXISTING MANHOLES, PULLBOXES, AND OTHER UTILITIES WHERE NECESSARY TO BE FLUSH WITH FINISH GRADE.
- FOR PAVEMENT DESIGN AND CONSTRUCTION REF. TO GEOTECHNICAL STUDY PREPARED FOR TACO CABANA BY RADA-HISTNER-BRYTEST INC. PROJECT NO. AA97-047-00. CONCRETE PAVING IS REQUIRED.

**LEGEND**

- TG TOP OF GRATE
- INV INVERT
- FL FLOW LINE
- HP HIGH POINT
- BC BOTTOM OF CURB
- TC TOP OF CURB
- TW TOP OF WALL
- BOC BACK OF CURB
- FOC FACE OF CURB
- RETAINING WALL
- MORTAR STACK ROCK WALL
- WATER LINE
- WASTE WATER LINE
- STORM SEWER LINE
- FIRE HYDRANT
- WATER METER
- POWER POLE
- OVERHEAD ELECTRIC
- +100.00 EXISTING SPOT ELEVATION
- +100.00 PROPOSED SPOT ELEVATION
- MISC. CONCRETE PAVING
- LIMITS OF CONSTRUCTION
- PROPERTY LINE
- SILT FENCE
- DRAINAGE AREA
- DRAINAGE AREA BOUNDARY
- FILTER DIKE
- TREE PROTECTION FENCE
- EXISTING CONTOUR
- PROPOSED CONTOUR
- EXISTING TREE TO REMAIN
- EXISTING TREE TO BE REMOVED
- TRAFFIC GUARD RAIL
- FIRE LANE DESIGNATION
- HAND RAILS

**PAVEMENT PAINT SPECIFICATION:**  
 FIRE LANE PAVEMENT PAINT SHALL BE GLODEN #4520 OIL ENAMEL "SAFETY RED"  
 TRAFFIC ARROW PAVEMENT PAINT SHALL BE GLODEN #22893 OIL ENAMEL "TRAFFIC WHITE"  
 CROSSWALK PAVEMENT PAINT SHALL BE GLODEN #22893 OIL ENAMEL "TRAFFIC WHITE"  
 YELLOW TRAFFIC STRIPE PAVEMENT PAINT SHALL BE GLODEN #22892 OIL ENAMEL "TRAFFIC YELLOW"

**SITE DATA**

TOTAL LOT AREA	45,460 S.F.
IMPERVIOUS COVER	1,0436 ac.
% OF SITE AREA	34,738 S.F.
BUILDING AREA	3,383 S.F.
PROPOSED USE	RESTAURANT W/ DRIVE-THROUGH
STORIES	1
HEIGHT	16'-8"
FINISH FLOOR	604.00
ZONING	PD

**PARKING**

USE	REQUIRED	PROVIDED		
		STANDARD	HANDICAP	TOTAL
RESTAURANT (3,383 S.F.) ① 1 SPACE/70S.F.	48	46	2	48
PATIO (839 S.F.) ① 1 SPACE/70S.F.	12	11	1	12
<b>TOTAL</b>	<b>60</b>	<b>57</b>	<b>3</b>	<b>60</b>

**FOR METER VAULT PRODUCTS CONTACT:**  
 BROOKS PRODUCTS, INC.  
 2001 W. MAYFIELD  
 ARLINGTON, TEXAS 76015  
 (817) 467-2783 or (817) 465-0080  
 FAX (817) 465-6909

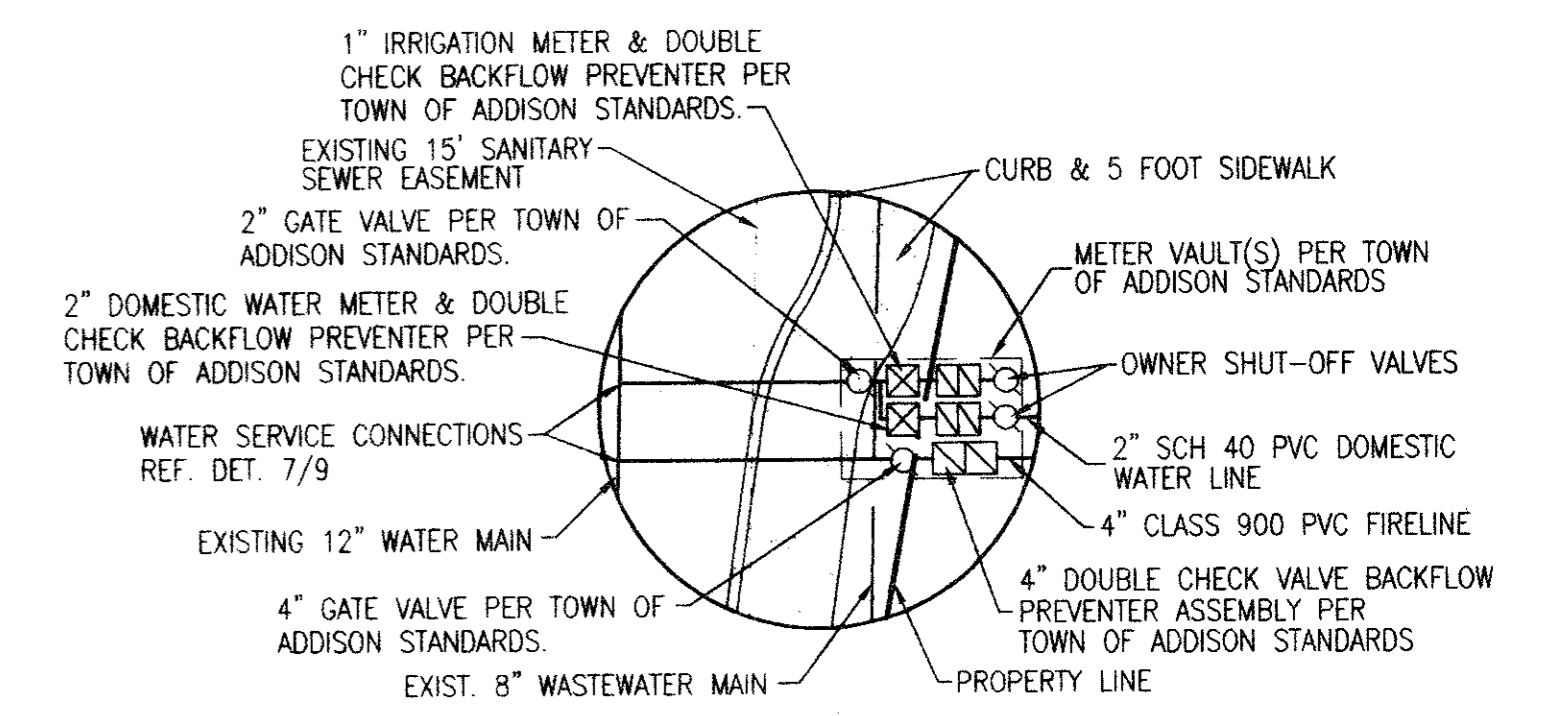

**NOTE:**  
 PROPOSED INLETS, STORM SEWER, AND WATER LINE BY OTHERS. REFER MARSH/BELTLINE SHOPPING CENTER PLANS BY BROCKETTE, DAVIS, & DRAKE, INC., 8-14-97.

NOTE: REFER TO GEOTECHNICAL STUDY PREPARED BY RADA-HISTNER-BRYTEST INC. FOR ALL PAVEMENT DESIGN, SPECIFICATIONS, AND CONSTRUCTION.

CLASSIFICATION	CONSTRUCTED ON	RIGID PAVEMENT SECTIONS
LIGHT DUTY (LIGHT VEHICLES & PARKING)	CLAY SOILS STRUCTURAL FILL	5
HEAVY DUTY (HEAVY TRUCKS & BUS DRIVES)	CLAY SOILS STRUCTURAL FILL	6

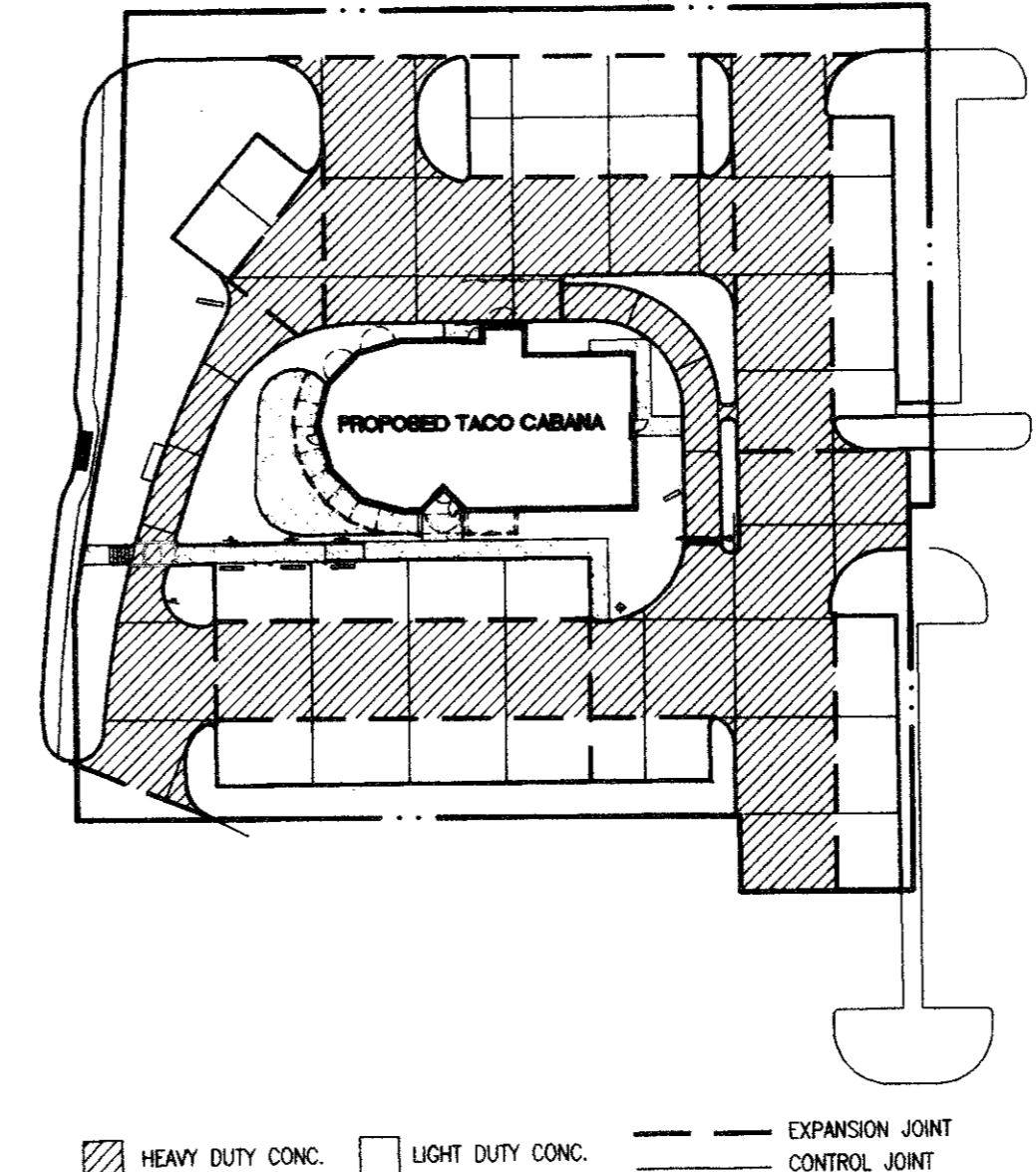

*Chris R. Mele*  
 3-10-98  
 NORTH

**SITE, PAVING, AND UTILITY PLAN AS BUILT**

**TACO CABANA**  
 3801 BELT LINE ROAD

**SHT. 2 OF 10**

DATE: 9-23-97 SCALE: 1" = 20' DRAWN BY:

REVISIONS: 11-14-97



**MARSH LANE**

**ATTENTION**  
 THE ENGINEER ASSUMES NO RESPONSIBILITY FOR THE EXISTENCE OR LOCATION OF ANY SURFACE OR SUBSURFACE STRUCTURES. THE CONTRACTOR IS RESPONSIBLE FOR CONTACTING ALL AGENCIES AND/OR OWNERS TO VERIFY THIS INFORMATION.  
 ALL CONSTRUCTION MATERIALS AND TECHNIQUES SHALL CONFORM TO CURRENT TOWN OF ADDISON STANDARD SPECIFICATIONS.