

**TOWN OF ADDISON
GENERAL NOTES**

- A. PRIOR TO FINAL ACCEPTANCE BY THE TOWN OF ADDISON, THE PROJECT WAS CONSTRUCTED IN ACCORDANCE WITH THE PLANS AND SPECIFICATIONS APPROVED BY THE TOWN OF ADDISON.
1. THE OWNER SHALL PROVIDE ONE REPRODUCIBLE SET OF AS-BUILT (SEALED AND CERTIFIED BY A TEXAS REGISTERED ENGINEER) AND TWO BLUELINE SETS TO THE TOWN OF ADDISON.
2. A 4" PVC SIDEWALK SHALL BE INSTALLED ALONG THE PUBLIC STREETS. SEE ATTACHED DETAIL.
3. A ONE YEAR 10% MAINTENANCE BOND IS REQUIRED FOR THE PUBLIC INFRASTRUCTURE.
4. CONTRACTOR SHALL DEMONSTRATE THAT THE WATER AND SANITARY SEWER SYSTEMS MEET THE PROPER PRESSURE, BACTERIA, AND MANDEREL TESTS. IN ADDITION, THE OWNER SHALL PROVIDE A VHS FORMAT VIDEO TAPE OF THE SANITARY SEWER.
- B. PRIOR TO STARTING CONSTRUCTION, THE CONTRACTOR SHALL CONTACT THE UTILITY COMPANIES TO LOCATE EXISTING FACILITIES. THESE INCLUDE BUT NOT BE LIMITED TO THE FOLLOWING:
 1. TOWN OF ADDISON
 2. ONE STAR GAS
 3. SOUTHWESTERN BELL
 4. STORER CABLE
 5. PLANNED CABLE SYSTEMS
 6. TUI ELECTRIC
 7. 1-800-093-TESS
- C. PRIOR TO BEGINNING CONSTRUCTION, THE OWNER OR HIS AUTHORIZED REPRESENTATIVE SHALL CONDUCT A PRECONSTRUCTION CONFERENCE AMONG THE TOWN OF ADDISON, CONSULTING ENGINEERS, CONTRACTOR(S), UTILITY COMPANIES AND ANY OTHER AFFECTED PARTIES. NOTIFY BRUCE ELLIS (972) 400-2847 AT LEAST 48 HOURS PRIOR TO BEGINNING OF CONSTRUCTION.
- D. ANY EXISTING PAVEMENT, CURBS, AND/OR SIDEWALKS DAMAGED OR REMOVED WILL BE REPAIRED BY THE CONTRACTOR AT THEIR EXPENSE.
- E. LOT PINS SHALL BE INSTALLED AFTER CONSTRUCTION AND PRIOR TO FINAL ACCEPTANCE. CONCRETE MONUMENTS SHALL BE PLACED AS SHOWN ON THE FINAL PLAN AND IRON PINS SHALL BE PLACED AT BLOCK CORNERS, CURVE POINTS AND ANGLE POINTS IN PUBLIC RIGHT-OF-WAY. CONCRETE MONUMENTS SHALL BE SIX (6) INCHES IN DIAMETER AND TWENTY-FOUR (24) INCHES LONG. AN IRON ROD ONE-HALF (1/2) INCH IN DIAMETER EMBEDDED AT LEAST THREE (3) INCHES IN THE MONUMENT AT THE EXACT INTERSECTION POINT OF THE MONUMENT. THE MONUMENTS SHALL BE SET AT SUCH AN ELEVATION THAT AFTER CONSTRUCTION, THE TOP OF THE MONUMENT WILL BE NOT LESS THAN TWELVE (12) INCHES BELOW THE GROUND SURFACE.
- F. THE CONTRACTOR SHALL STAMP A 2-INCH "S" AND A 2-INCH "W" IN THE CURB AT THE LOCATION OF THE SEWER SERVICE AND WATER SERVICE RESPECTIVELY.
- G. AT INTERSECTIONS THAT HAVE VALLEY DRAINAGE, THE CROWN OF THE INTERSECTING STREETS WILL CULMATE IN A DISTANCE OF 40 FEET FROM THE INTERSECTING CURB LINE UNLESS OTHERWISE NOTED.
- H. TEMPORARY OF PERMANENT STREET BARRICADES SHALL REMAIN AT ALL POINTS OF INGRESS AND EGRESS TO PREVENT PUBLIC USE UNTIL SUCH STREET RECEIVES FINAL ACCEPTANCE.
- I. CONTRACTOR SHALL OBTAIN A RIGHT-OF-WAY PERMIT FROM THE TOWN OF ADDISON FOR WORKING WITHIN THE PUBLIC RIGHT-OF-WAY.
- J. DURING CONSTRUCTION, THE OWNER SHALL PROVIDE A QUALIFIED GEOTECHNICAL LAB TO PERFORM MATERIALS TESTING DURING THE CONSTRUCTION AT THE REQUEST OF THE TOWN OF ADDISON.
- K. THE CONTRACTOR SHALL SUBMIT MATERIAL SHEETS TO THE TOWN OF ADDISON FOR APPROVAL PRIOR TO INCORPORATING MATERIALS INTO THE JOB.
- L. THE UTILITY CONTRACTOR SHALL SUBMIT TO THE TOWN OF ADDISON FOR APPROVAL A TRENCH SAFETY PLAN SEALED BY A REGISTERED PROFESSIONAL ENGINEER FOR THE INSTALLATION OF UTILITIES GREATER THAN FIVE(5) FEET IN DEPTH.
- M. ALL EXISTING AND PROPOSED IMPROVEMENTS (VALVES, MANHOLES, FIRE HYDRANTS, WATER METERS, ETC.) SHALL BE ADJUSTED TO FINISHED GRADE BY THE CONTRACTOR.
- N. CONTRACTOR SHALL COORDINATE ACTIVITIES TO PROVIDE FOR THE EFFICIENT CONSTRUCTION OF THE WORK BEING DONE BY OTHERS.
- O. WORK BY OTHERS SHALL BE COMPLETED PRIOR TO ISSUANCE OF A CERTIFICATE OF OCCUPANCY. THIS INCLUDES TURN LANE, DRIVEWAY, STORM SEWER, AND WATER LINES ADJACENT TO THE STREET.
- P. ALL WORK ASSOCIATED WITH STORM AND UTILITY CONNECTIONS IN MARSH LANE SHALL BE COMPLETED AT NIGHT OR ON THE WEEKEND. CLOSURE OF TWO LANES IS PERMITTED FROM 10 PM TO 6 AM AND ONLY ONE LANE MAY BE CLOSED FROM 6 AM TO 10 PM ON SATURDAY OR SUNDAY. ALL THREE LANES SHALL BE OPEN FOR TRAFFIC ON MONDAY THROUGH FRIDAY FROM 6 AM TO 10 PM.
- Q. CONCRETE SAW CUTS SHALL OCCUR PERPENDICULAR OR PARALLEL TO THE ROADWAY AND OCCUR ON EXISTING JOINTS WHEN DIRECTED BY THE TOWN.

SITE PLAN NOTES

1. ALL DIMENSIONS ARE TAKEN TO FACE OF CURB OR BUILDING UNLESS OTHERWISE NOTED.
2. CONTRACTOR SHALL VERIFY DIMENSIONS AND NOTIFY ENGINEER OF ANY DISCREPANCIES.
3. USE DIMENSIONAL INFORMATION GIVEN. DO NOT SCALE DRAWINGS.
4. CONTRACTOR SHALL VERIFY EXACT LOCATIONS AND PROTECT ALL EXISTING IMPROVEMENTS AND UTILITIES DURING CONSTRUCTION OPERATIONS.
5. ALL WALKWAYS LEADING TO ENTRANCES ARE TO BE CENTERED ON DOORWAYS UNLESS OTHERWISE NOTED.
6. AT LOCATIONS WHERE EXISTING PAVEMENT ABUTS NEW PAVEMENT, CONTRACTOR SHALL BLEND NEW PAVEMENT TO EXISTING CONDITIONS. PAVEMENTS SHALL ALIGN BOTH VERTICALLY AND HORIZONTALLY. PONDING AT JOINTS WILL NOT BE ACCEPTABLE.
7. PROVIDE MINIMUM 1/8" PER FOOT CROSS SLOPE IN DIRECTION OF SURFACE DRAINAGE ON ALL WALKWAYS.
8. WHERE NEW CONCRETE PAVEMENT MEETS EXISTING CONCRETE OR VERTICAL SURFACES, PROVIDE 1/2" EXPANSION JOINT. WHERE NEW CONCRETE PAVEMENT MEETS EXISTING ASPHALT, SAW CUT EDGE OF ASPHALT AND BUTT NEW PAVEMENT TIGHT. SCORING JOINTS SHALL MATCH EXISTING CONDITION WHERE NEW CONCRETE PAVEMENT REPLACES EXISTING OR ABUTS EXISTING CONCRETE PAVEMENT.
9. FINISH ON CONCRETE SHALL BE PERPENDICULAR TO TRAFFIC FLOW.
10. WHERE NEW ASPHALT PAVEMENT MEETS EXISTING ASPHALT, SAW CUT EXISTING ASPHALT. ALL NEW PAVEMENTS SHALL MEET EXISTING FLUSH.
11. PARKING LOT LINES AND TRAFFIC CONTROL MARKINGS SHALL BE PAINTED ON PAVEMENT WITH MINIMUM 4" WIDE LINES OR AS SHOWN ON PLANS.
12. PROVIDE EXPANSION JOINT MATERIAL AT ALL LOCATIONS WHERE CURB AND GUTTER ABUTS OR IS ADJACENT TO WALLS.
13. AUTOMATIC UNDERGROUND IRRIGATION SYSTEM WILL BE PROVIDED. CONTRACTOR TO PROVIDE SLEEVING FOR UNDERGROUND IRRIGATION SYSTEM AND COORDINATE WITH IRRIGATION PLAN.
14. ALL HANDICAP PARKING SPACES SHALL HAVE SIGNS AS INDICATED ON THE PLANS AND AS PER DETALS.
15. LIGHT POLES OR SIGN POLES ARE NOT ALLOWED IN PARKING OR DRIVEWAY PAVEMENT AREAS. COORDINATE LOCATIONS WITH LANDSCAPE PLAN.
16. PIERS FOR LIGHT POLES SHALL NOT BE ABOVE CURB.
17. ALL LIGHT POLES WILL BE A MINIMUM THREE (3) FEET BEHIND ANY CURB.
18. CONTRACTOR TO ADJUST ALL EXISTING MANHOLES, PULLBOXES, AND OTHER UTILITIES WHERE NECESSARY TO BE FLUSH WITH FINISH GRADE.
19. FOR PAVEMENT DESIGN AND CONSTRUCTION REF. TO GEOTECHNICAL STUDY PREPARED FOR TACO CABANA BY RABA-KISTNER-BRYTEST INC. PROJECT NO. AA97-047-00. CONCRETE PAVING IS REQUIRED.

NOTE:
PROPOSED INLETS, STORM SEWER, AND WATER LINE BY OTHERS. REFER MARSH/BELTLINE SHOPPING CENTER PLANS BY BROCKETTE, DAVIS, & DRAKE, INC., 8-14-97.

NOTE: REFER TO GEOTECHNICAL STUDY PREPARED BY RABA-KISTNER-BRYTEST INC. FOR ALL PAVEMENT DESIGN, SPECIFICATIONS, AND CONSTRUCTION.

CLASSIFICATION	CONSTRUCTED ON	RIGID PAVEMENT SECTIONS
LIGHT DUTY (LIGHT VEHICLES & PARKING)	CLAY SOILS	5
	STRUCTURAL FILL	5
HEAVY DUTY (HEAVY TRUCKS & BUS DRIVES)	CLAY SOILS	8
	STRUCTURAL FILL	8

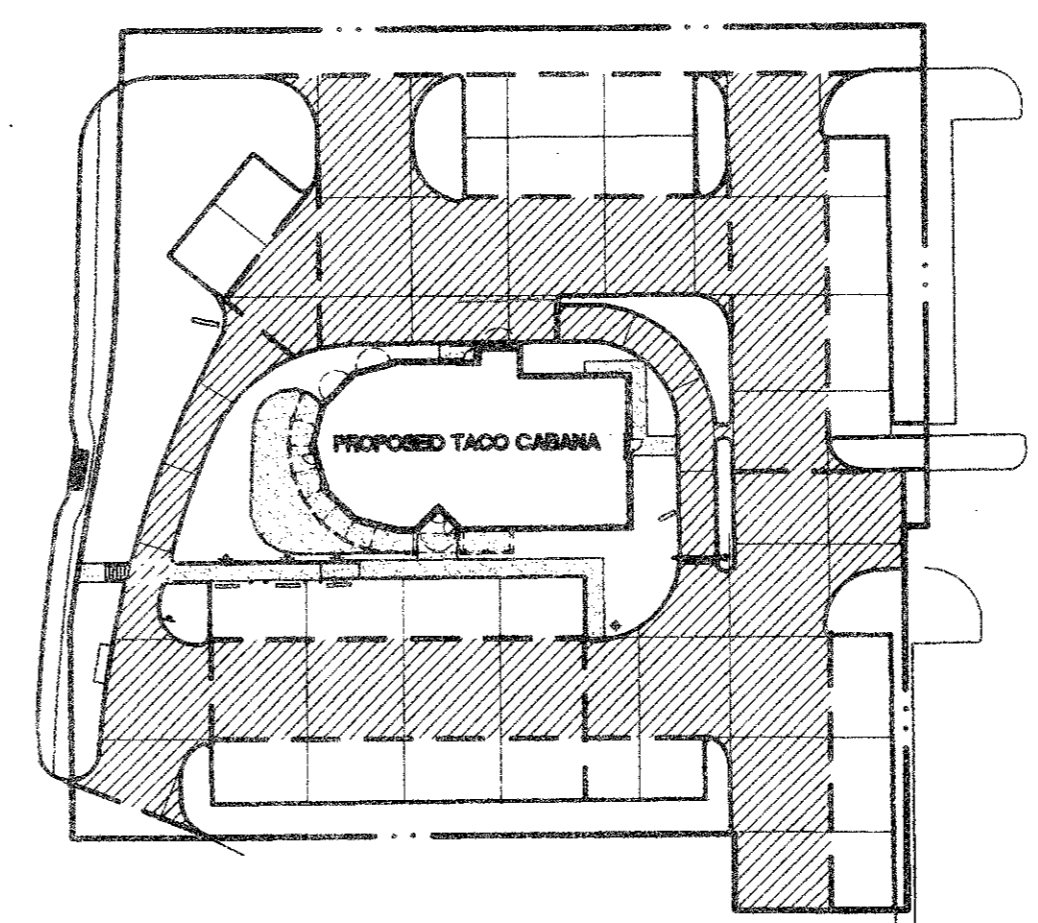

PAVING PLAN

SCALE: 1" = 50'

LEGEND

- TG TOP OF GRATE
- INV INVERT
- FL FLOW LINE
- HP HIGH POINT
- BC BOTTOM OF CURB
- TC TOP OF CURB
- TW TOP OF WALL
- BCW BACK OF CURB
- FOC FACE OF CURB
- RETAINING WALL
- MORTAR STACK ROCK WALL
- WATER LINE
- - - WASTE WATER LINE
- STORM SEWER LINE
- FIRE HYDRANT
- WATER METER
- POWER POLE
- OVERHEAD ELECTRIC
- +100.00 EXISTING SPOT ELEVATION
- +100.00 PROPOSED SPOT ELEVATION
- MISC. CONCRETE PAVING
- LIMITS OF CONSTRUCTION
- PROPERTY LINE
- SILT FENCE
- DRAINAGE AREA
- DRAINAGE AREA BOUNDARY
- FILTER DIKE
- TREE PROTECTION FENCE
- EXISTING CONTOUR
- PROPOSED CONTOUR
- EXISTING TREE TO REMAIN
- EXISTING TREE TO BE REMOVED
- TRAFFIC GUARD RAIL
- FIRE LANE DESIGNATION
- HAND RAILS

PAVEMENT PAINT SPECIFICATION:
FIRE LANE PAVEMENT PAINT SHALL BE GLODEN #22683 OIL EMUL. "SAFETY RED"
CLAREN #22683 OIL EMUL. "TRAFFIC WHITE"
TRAFFIC ARROW PAVEMENT PAINT SHALL BE GLODEN #22683 OIL EMUL. "TRAFFIC WHITE"
CROSSWALK PAVEMENT PAINT SHALL BE GLODEN #22683 OIL EMUL. "TRAFFIC WHITE"
YELLOW TRAFFIC STRIPE PAVEMENT PAINT SHALL BE GLODEN #22682 OIL EMUL. "TRAFFIC YELLOW"

SITE DATA

TOTAL LOT AREA	45,460 S.F.
IMPERVIOUS COVER	1,0436 ac.
% OF SITE AREA	76 %
BUILDING AREA	3,383 S.F.
PROPOSED USE	RESTAURANT W/ DRIVE-THROUGH
STORIES	1
HEIGHT	16'-8"
FINISH FLOOR	604.00
ZONING	PD

PARKING

USE	REQUIRED	PROVIDED		TOTAL
		STANDARD	HANDICAP	
RESTAURANT (3,383 S.F.) @ 1 SPACE/70S.F.	48	46	2	48
PATIO (839 S.F.) @ 1 SPACE/70S.F.	12	11	1	12
TOTAL	60	57	3	60

FOR METER VAULT PRODUCTS CONTACT:

BROOKS PRODUCTS, INC.
2001 W. MAYFIELD
ARLINGTON, TEXAS 76015
(817) 467-2703 or (817) 465-0060
FAX (817) 465-6909

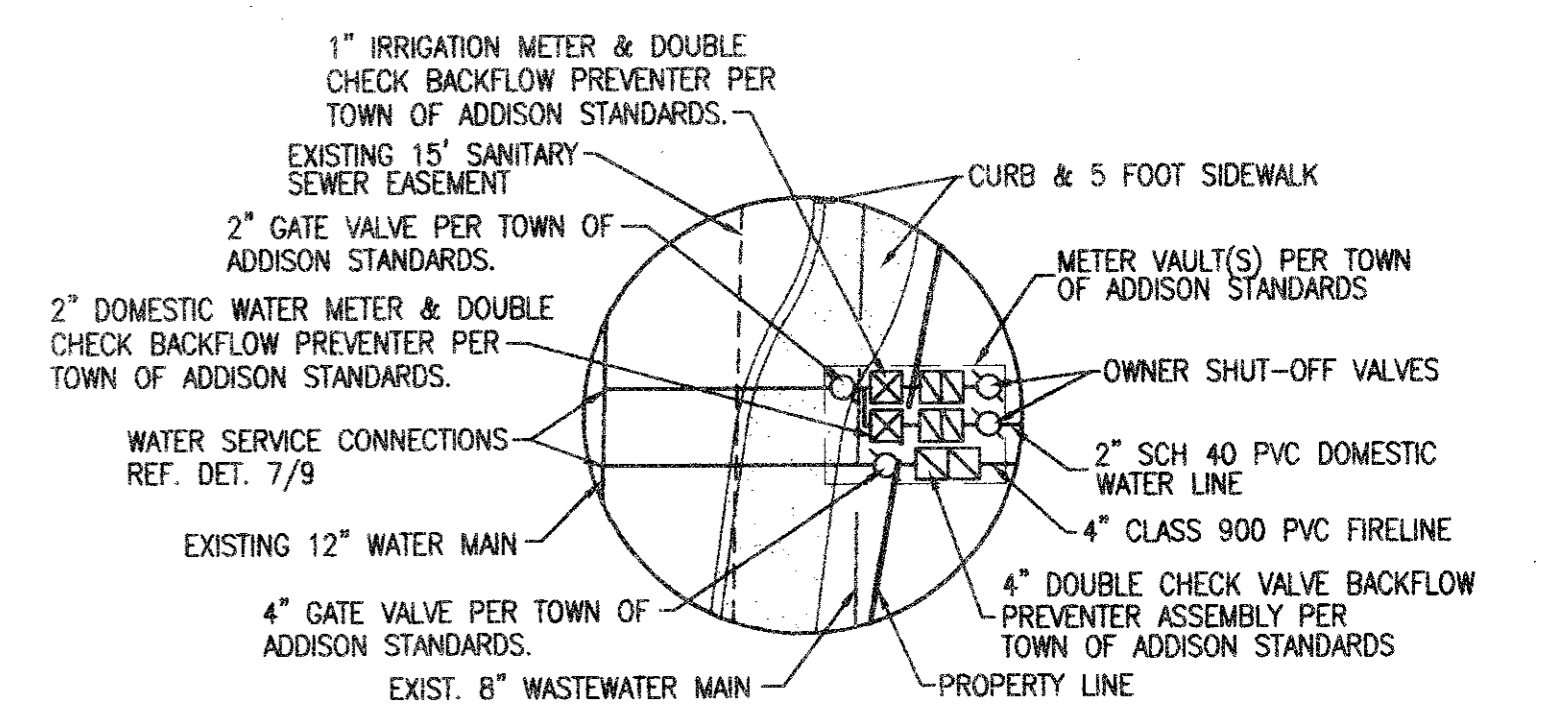

WATER CONNECTION DETAIL

**TOWN OF ADDISON
BUILDER'S COPY OF PLANS**

This set of plans contains various corrections and comments made by the City Staff. All trades will be required to comply with these corrections and comments; failure to inform reason to approve construction which is in violation of local ordinance. This set of plans is to be kept on the job site at all times and is to be made available for use by city inspectors at their request. Failure to have these plans available may delay approval of a requested inspection.

Anne R. Mele
10-20-97

SITE, PAVING, AND UTILITY PLAN

TACO CABANA 3801 BELT LINE ROAD		SHT. 2 OF 10
DATE: 9-23-97	SCALE: 1" = 20'	DRAWN BY:
REVISIONS:		
315 Bowie / Austin, TX 78703 / (512) 469-0500		

ATTENTION
THE ENGINEER ASSUMES NO RESPONSIBILITY FOR THE EXISTENCE OR LOCATION OF ANY SURFACE OR SUBSURFACE STRUCTURES. THE CONTRACTOR IS RESPONSIBLE FOR CONTACTING ALL AGENCIES AND/OR OWNERS TO VERIFY THIS INFORMATION.
ALL CONSTRUCTION MATERIALS AND TECHNIQUES SHALL CONFORM TO CURRENT TOWN OF ADDISON STANDARD SPECIFICATIONS.