

1 CATCH CURB DETAIL @ CONCRETE SLAB
SD1 NTS

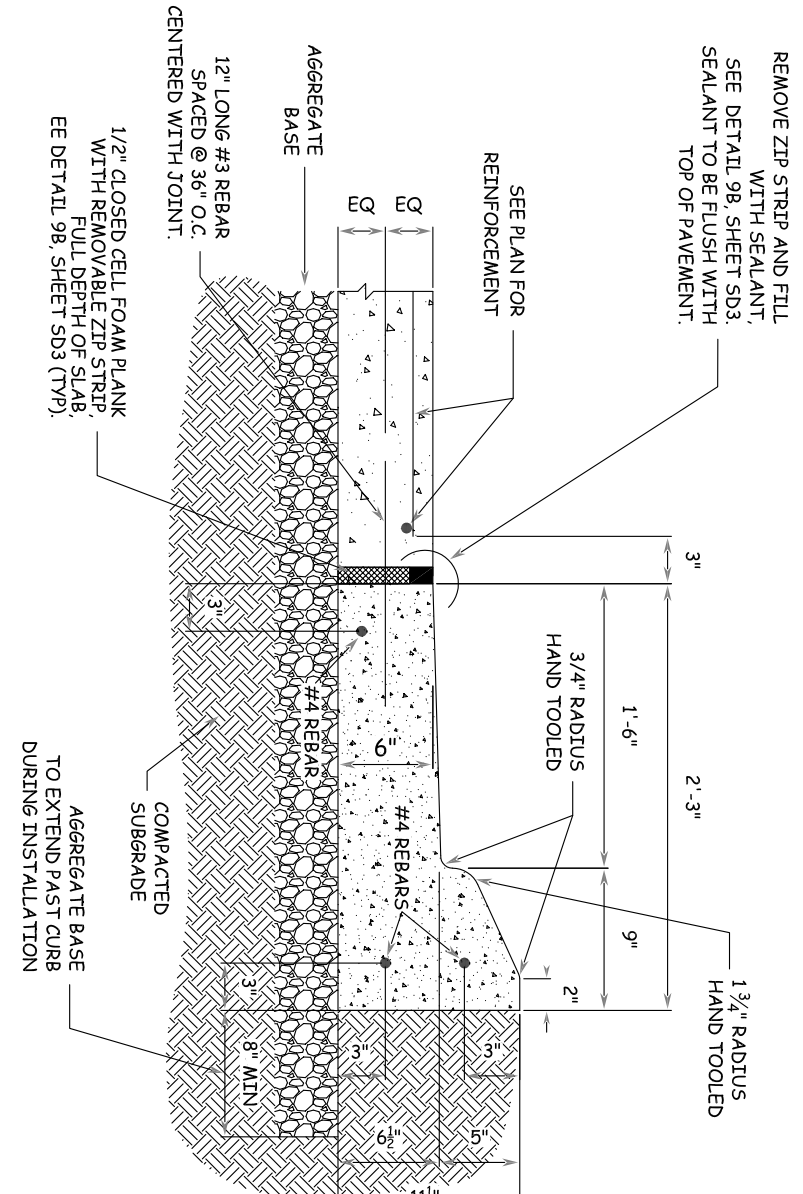

2 SHED CURB DETAIL @ CONCRETE SLAB
SD1 NTS

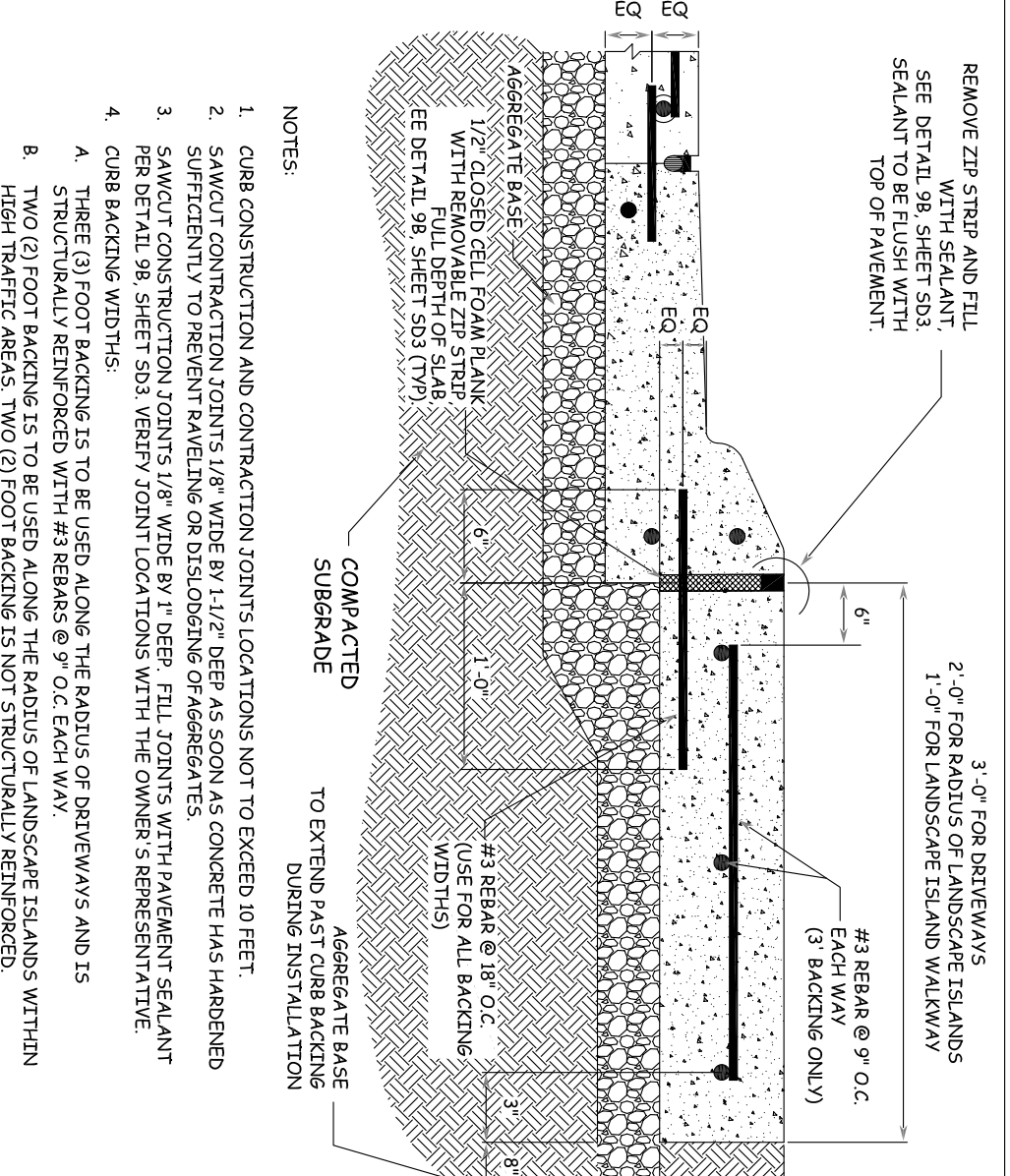

5 CONCRETE BACKING FOR ON-SITE CURB
SD1 NTS

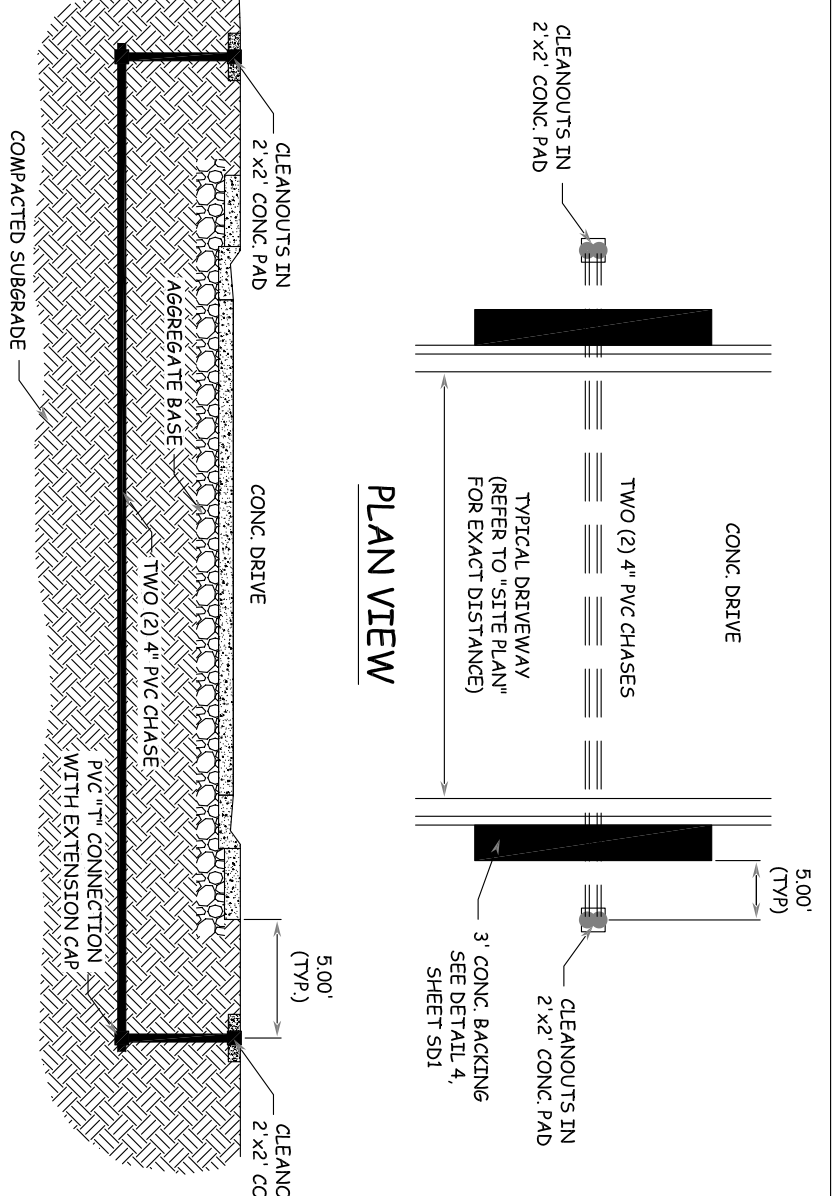

9 PVC CHASE DETAIL
SD1 NTS

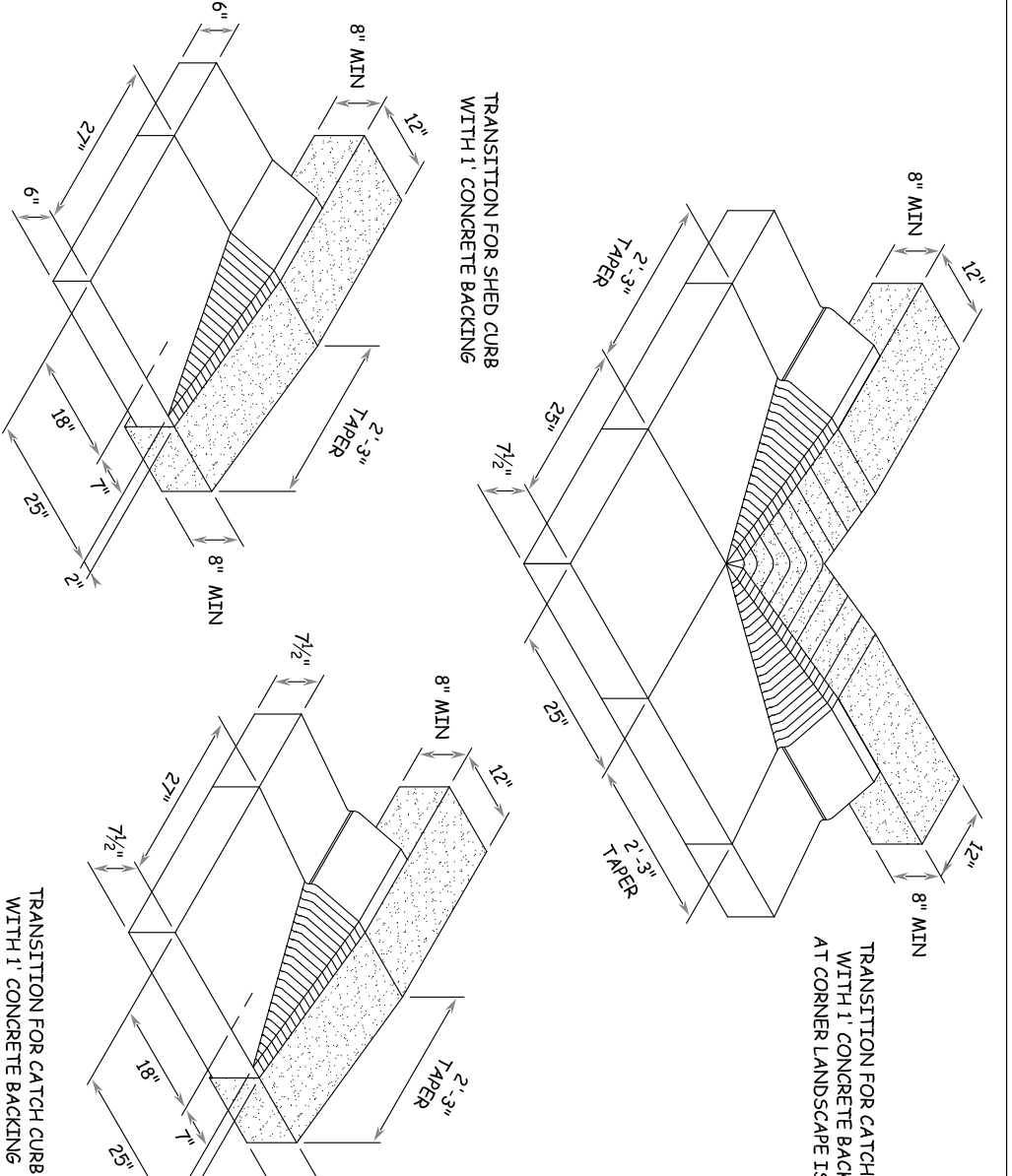

6 CURB TRANSITION DETAILS
SD1 NTS

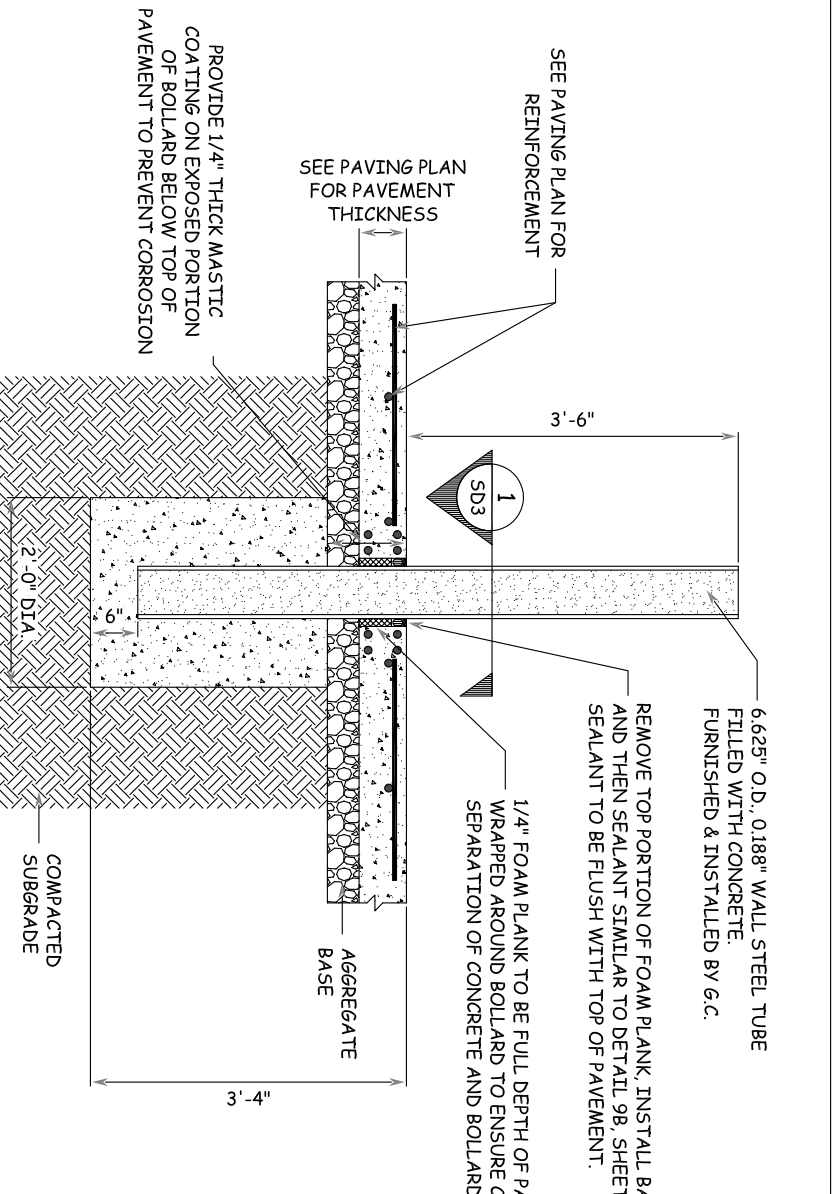

10 CANOPY BOLLARD DETAIL
SD1 NTS

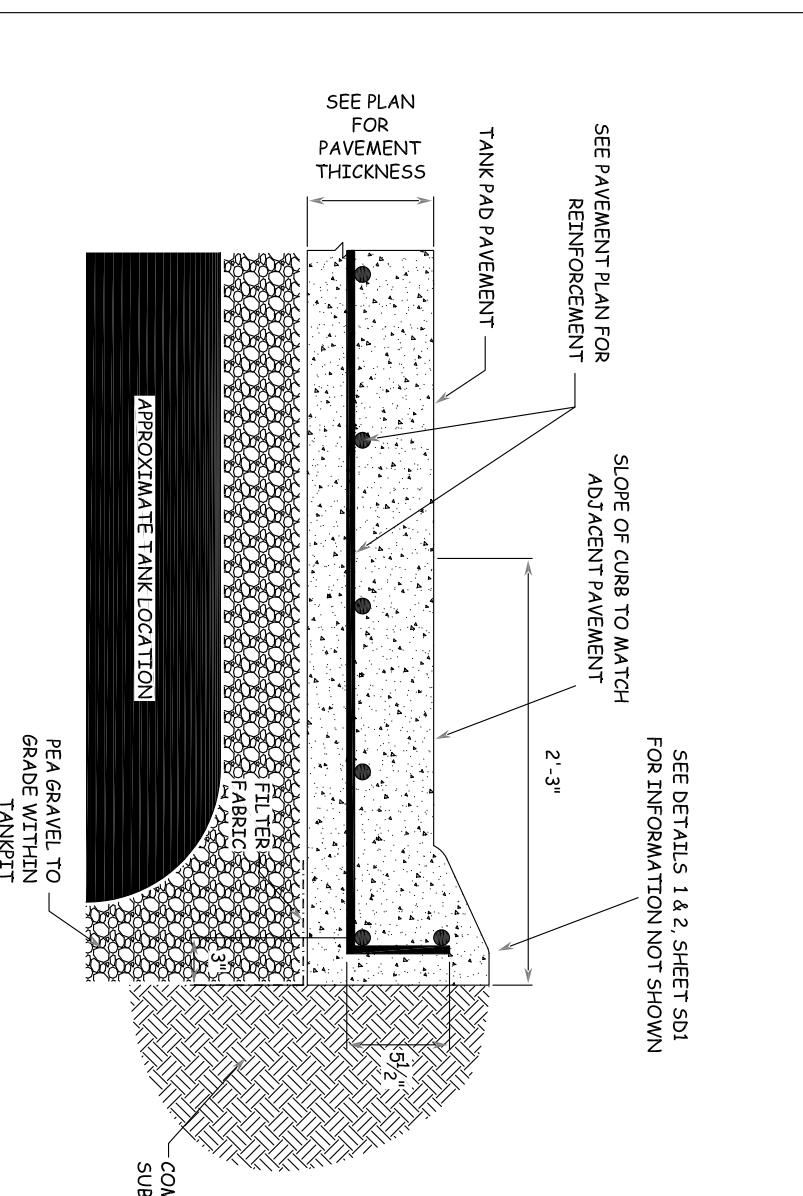

3 TANK AREA CURB DETAIL
SD1 NTS

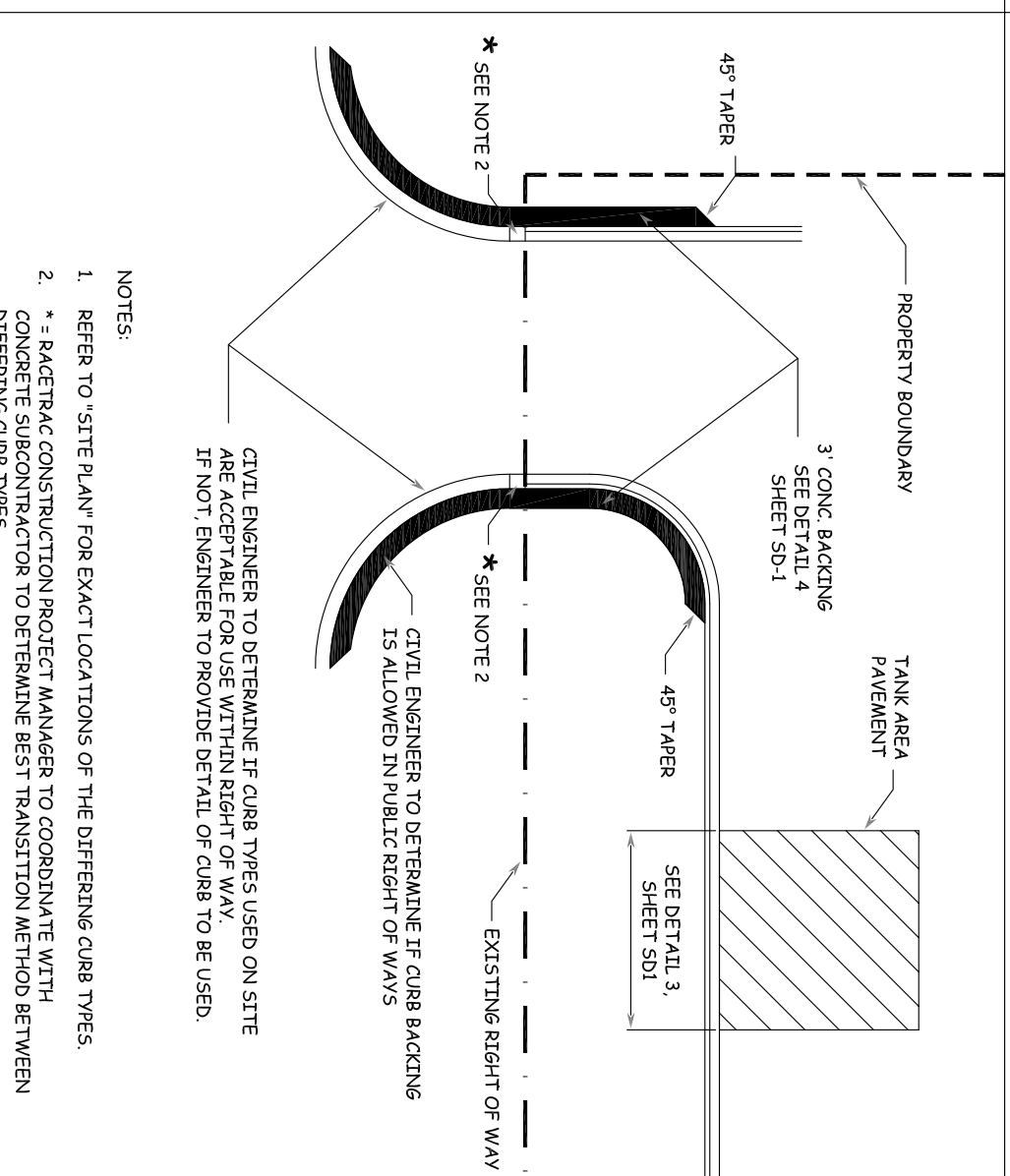

7 CURB LAYOUT PLAN VIEW
SD1 NTS

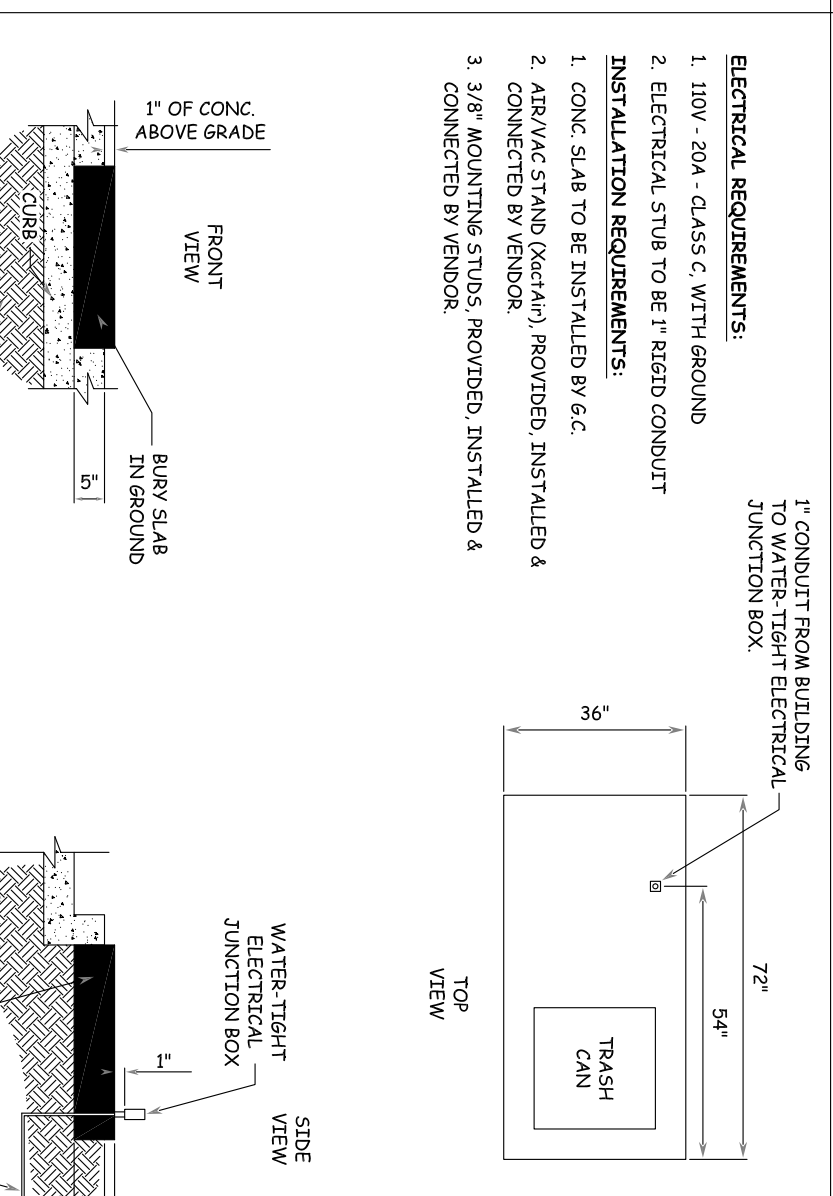

11 AIR/VAC SERVICE DETAIL
SD1 NTS

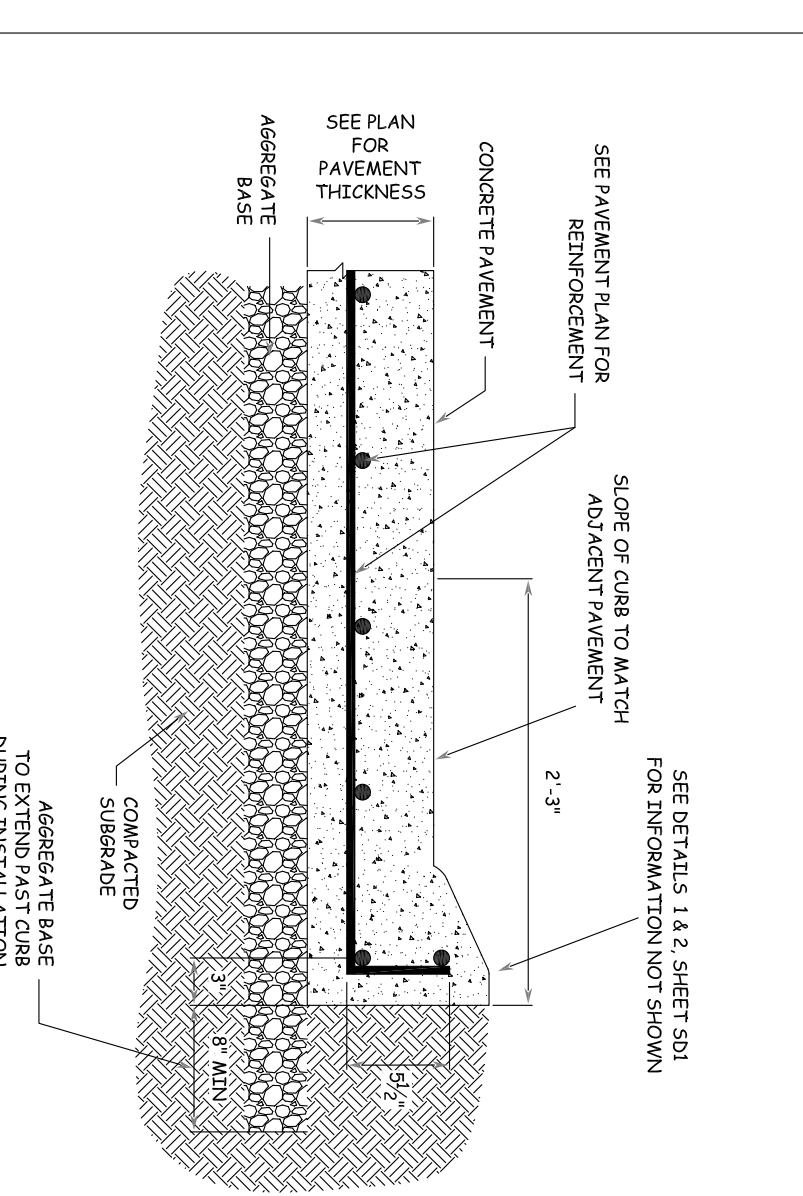

4 MONOLITHIC CURB DETAIL
SD1 NTS

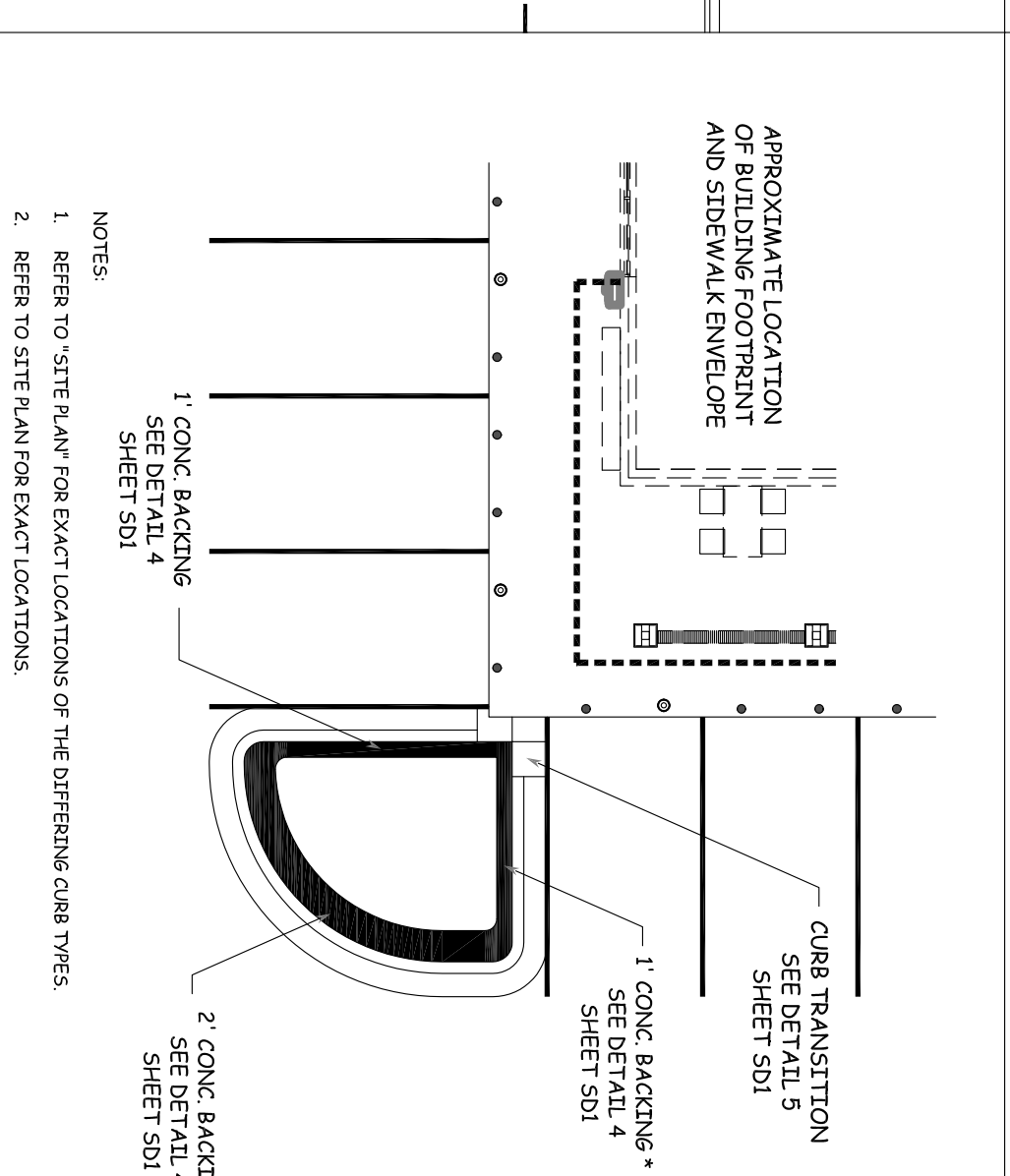

8 CONCRETE BACKING PLAN VIEW
SD1 NTS

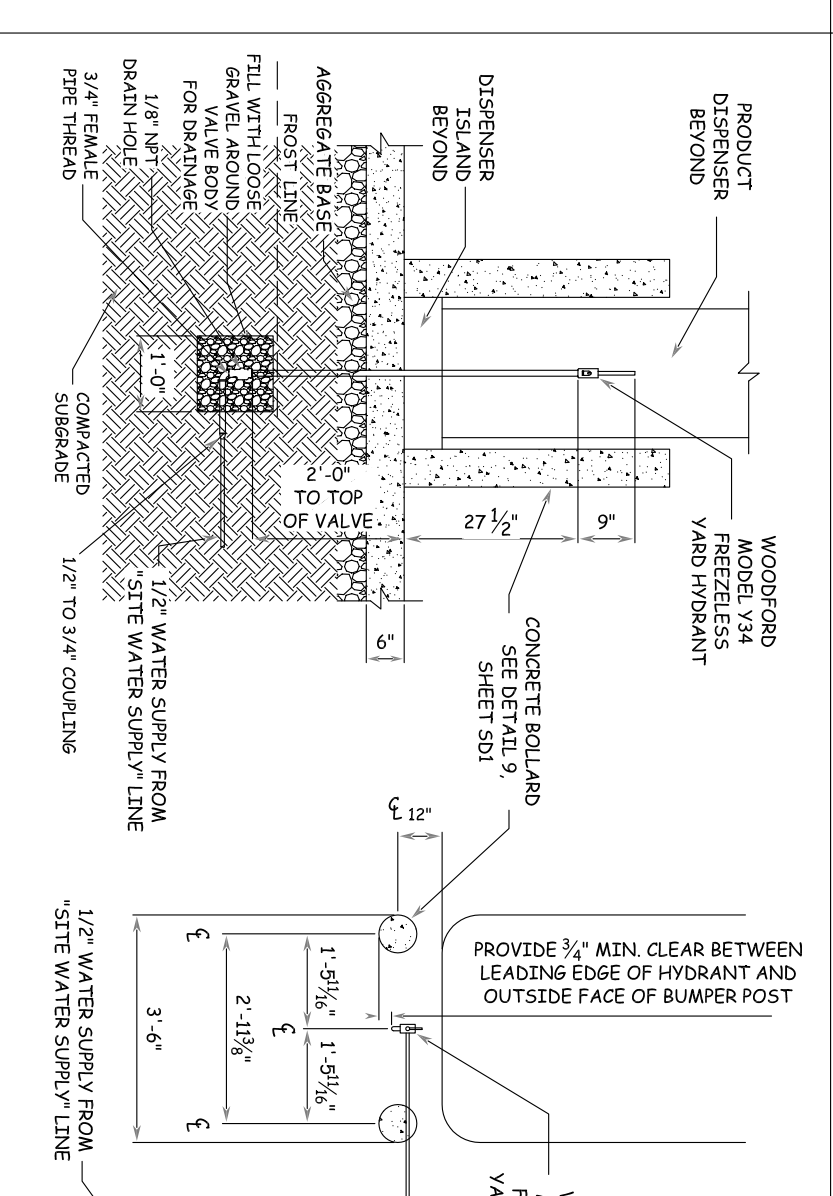

12 YARD HYDRANT DETAIL
SD1 NTS

NO.	DESCRIPTION	DATE
8	As-Built to City	05/22/20
7	Modification to sidewalk along Arapaho	04/16/20
6	Additional Spot elevations to GC	11/07/19
5	REVISED PLANS TO TOWN	08/23/2019
4	TOWN SUBMITTAL	04/05/2019
3	TOWN SUBMITTAL	08/30/2018
2	TOWN SUBMITTAL	08/28/2018
1	TOWN SUBMITTAL	02/12/2018

JONES CARTER
Texas Board of Professional Engineers Registration No. F-439
4300 Mercedre Plaza Drive, Suite 210 - Fort Worth, TX 76137 - 682.268.2200

TRAVIS J. BOUSQUET
85084
PEMS

05/22/20

RaceTrac
RACETRAC PETROLEUM, INC.
3225 CUMBERLAND BOULEVARD
SUITE 100 ATLANTA, GA 30339
(770) 431-7600

DETAIL SHEET 1 (PRIVATE)
RACETRAC
Beltline/Marsh Business Park
Lot 2, Block 1
3.133 Ac. - Zoned: Light Retail
Addison, Texas

AS-BUILTS
TJTB
May 22, '20
Date

SD1
SHEET NO. VERSION