

GENERAL NOTES FOR WATER AND SEWER

- All sanitary sewer lines shall be vitrified clay tile with Class C embedment or PVC pipe SDR 35 as per ASTM 3033 & 3034 Class B-1 embedment.
- Provide a water stop at sanitary manhole.
- All water mains shall be ductile iron poly (C.I. 50) wrap pipe, or PVC SDR 18 (blue brute with wire tracers).
- All water mains shall have minimum cover below finished grades or deeper if required to clear other utilities, as follows:
12" - 5' cover
8" - 4' cover
- All fire hydrants shall be Mueller Centurion.
- All gate valves shall be Mueller or approved equal.
- Streamer nozzles on fire hydrants shall be 18" above the top of curb, or finished grade, and shall face the centerline of the street. Fire hydrants shall usually be located 3 feet, but not less than 2 feet, or more than 5 feet behind the curb.
- Water main installations shall conform to the minimum requirements of the Texas State Department of Health rules and regulations covering plans and specifications for Public Waterworks Projects.
- Bedding for water lines shall be sand 6" below pipe to top of pipe.
- All construction within easements and rights of way belonging to the City of Addison and/or any construction for which the City must assume maintenance responsibility shall conform to the City of Addison standard specifications for construction.
- All Fire Hydrants, Manhole Castings, and Cleanouts shall be adjusted to final paving grades by Utility Contractor.

- BENCH MARK: "BM" on conc. East end of headwall North side Beltline Rd. and 500' west of Southeast corner of Addition. Elev. 581.51 (set)
- BENCH MARK: R.R. Spike in P.P. North side Beltline Rd. and 500' East of existing Marsh Lane. Elev. 579.27 (set)



AS BUILT

WATER AND SANITARY SEWER

DAL-MAC DEVELOPMENT CORPORATION
MAYES & BROCKETTE, INC. CONSULTING ENGINEERS

CITY OF ADDISON, TEXAS

DESIGN	DRAWN	DATE	SCALE	NOTES	FILE	NO.
M.G.	C.Z.	4-15-78	1"=100'	B.J.	C 7787	

REVISIONS:
REV. 7/7/78: BASEMENT UTILITIES ADDED FROM MARKET TO MARSH.
8/1/78: SAN. LATERAL ADDED ON MARKET.

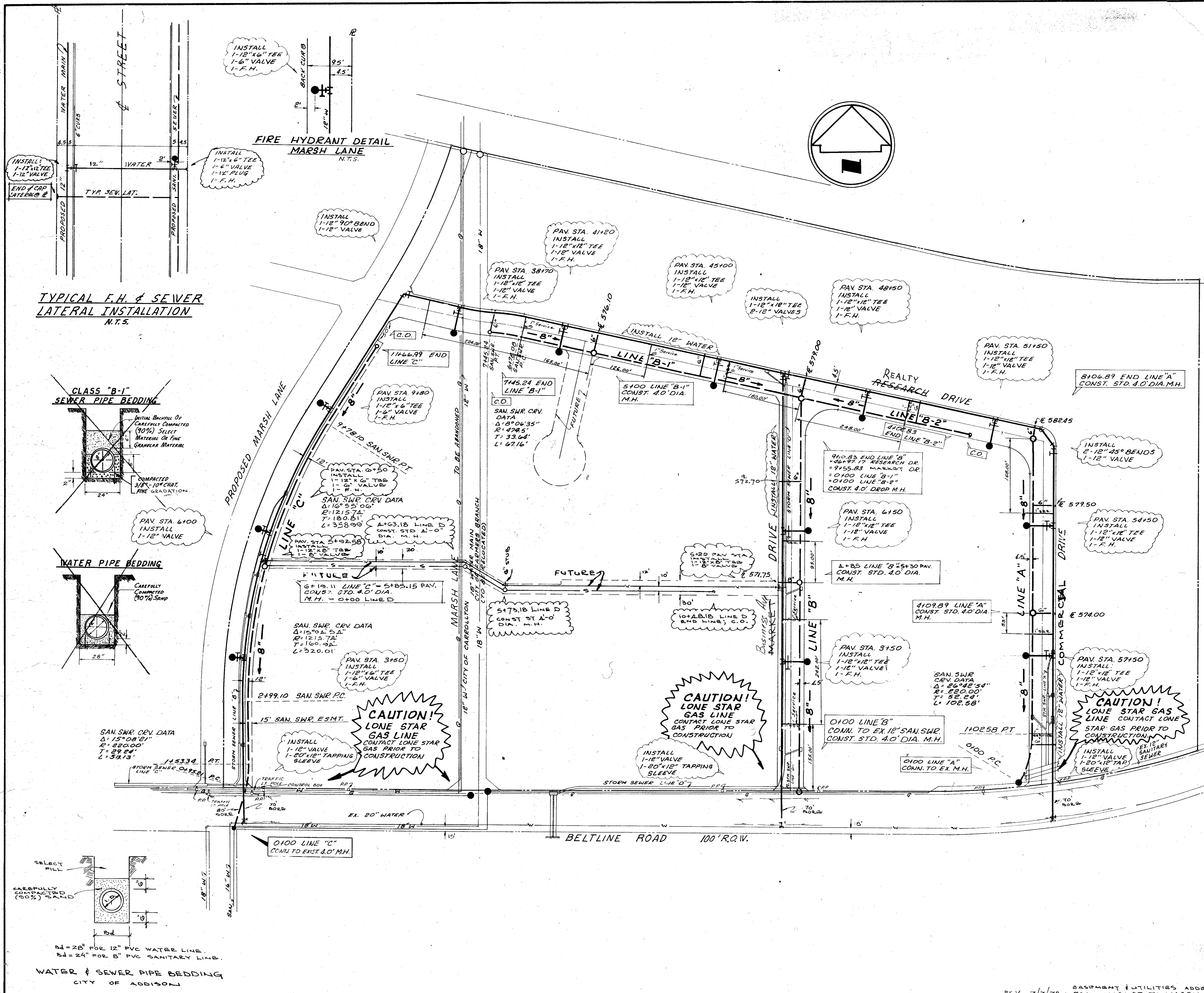

TYPICAL F.H. & SEWER LATERAL INSTALLATION N.T.S.

CLASS "B-1" SEWER PIPE BEDDING

WATER PIPE BEDDING

WATER & SEWER PIPE BEDDING CITY OF ADDISON