

MATCH LINE STA. S 0+75.71  
SEE SHEET 3

- NOTES**
1. CONTRACTOR SHALL DETERMINE THE LOCATION OF, AND REMOVE AND/OR RELOCATE, ALL AFFECTED SPRINKLER SYSTEMS INCLUDING HEADS, METERS, LINES AND OTHER APPURTENANCES AS DIRECTED BY THE TOWN OF ADDISON. (NO SEPARATE PAY ITEM)
  2. CONTRACTOR SHALL REMOVE AND/OR RELOCATE ALL EXISTING LANDSCAPING IMPROVEMENTS INCLUDING TREES, SHRUBS, BOULDERS AND STEEL EDGING AS DIRECTED BY THE TOWN OF ADDISON. (NO SEPARATE PAY ITEM)
  3. CONTRACTOR SHALL MATCH EXISTING PAVEMENT ELEVATION AT SAWCUT LINE.
  4. ALL DIMENSIONS ARE TO FACE OF CURB UNLESS OTHERWISE NOTED.

**!! WARNING !!**  
 LOCATION OF EXISTING UTILITIES SHOWN ARE APPROXIMATE! CONTRACTOR SHALL FIELD VERIFY LOCATIONS OF ALL EXISTING UTILITIES PRIOR TO CONSTRUCTION.  
 CONTRACTOR SHALL CONTACT:  
 LONE STAR GAS CO. 263-DIGG  
 SOUTHWESTERN BELL 998-4102  
 T.U. ELECTRIC 323-8910  
 STORER CABLE 840-2388

**LEGEND**

	REMOVE EXISTING PAVEMENT AND SIDEWALK
	CONSTRUCT NEW PAVEMENT
	CONSTRUCT NEW SIDEWALK
	EXISTING CURB
	PROPOSED CURB
	+636.23 EXISTING ELEVATION

**BENCHMARK**  
 FOUND "E" ON TOP OF CURB AT CENTER NOSE OF MEDIAN OF MARSH LANE, 50'± NORTH OF CENTERLINE OF BELTLINE ROAD.  
 ELEV. 571.55

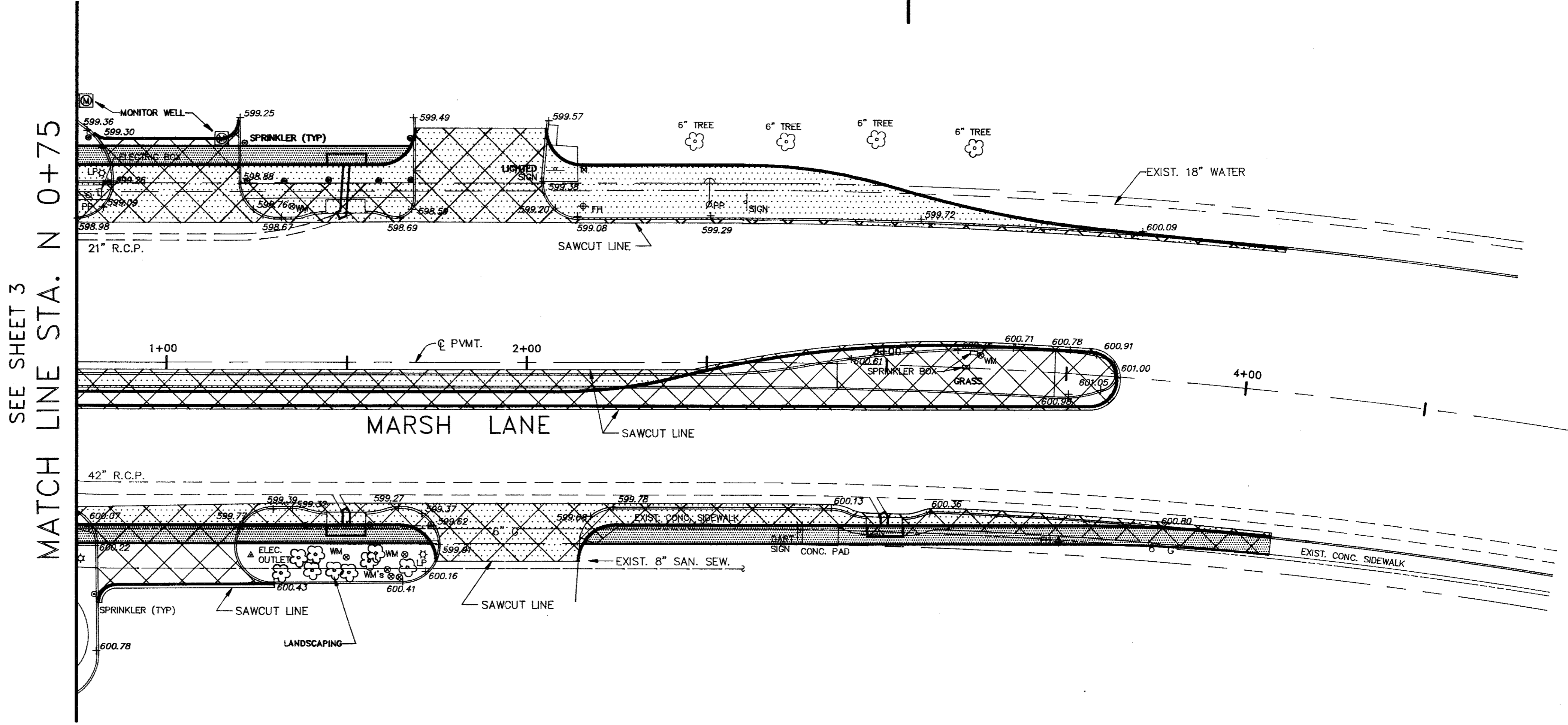

SEE SHEET 3  
MATCH LINE STA. N 0+75

NO.	REVISION	BY	DATE

DESIGNED BY: J. WALDBAUER  
 DRAWN BY: EH&A  
 CHECKED BY: B. GRANTHAM  
 SCALE: 1" = 20'  
 DATE: AUGUST 1992  
 FILE: \ADDISON\PROJECT2\BELTMAR2

**eh** ESPEY, HUSTON & ASSOCIATES, INC.  
 Engineering & Environmental Consultants  
 13800 Montfort Drive Suite 230 Dallas, Texas 75240  
 (214) 387-0771

**PAVING PLAN**  
 INTERSECTION IMPROVEMENTS  
 BELT LINE ROAD AT MARSH LANE  
 for  
 THE TOWN OF ADDISON

SHEET NO. 4  
 OF 16 SHEETS  
 JOB NO. 13921