

ITEM	DESCRIPTION	UNIT	QTY.
100	Preparing ROW	Sta	3.3
104SP	Remove Old Conc (Pvmt)	S.Y.	902
160SP	Furn. & Plac Topsoil	C.Y.	83
164SP	Broadcast Seeding	S.Y.	650
260	Lime Treated Subgrade	S.Y.	970
264	Lime Slurry	Ton	16
360SP	8" Reinf Conc Pavement	S.Y.	865
360SP	6" Mono Curb	L.F.	630
400SP	Uncl Struc Ex (Box Cul)	C.Y.	2,686
421SP	Cl A Conc for Struct.	C.Y.	792.4
432	Riprap, Cl B	C.Y.	9
440SP	Reinf. Steel	Lbs.	109,953
496SP	Remove Old Str, Small	Each	2
524	6" Concrete Driveways	S.Y.	67
568SP	Chain Link Fence, 4 ft.	L.F.	80
SS-3	12" Water Main Adj.	L.F.	49
SS-11	6" Sanitary Sewer	L.F.	105
SS-12	Cleanouts	Each	1

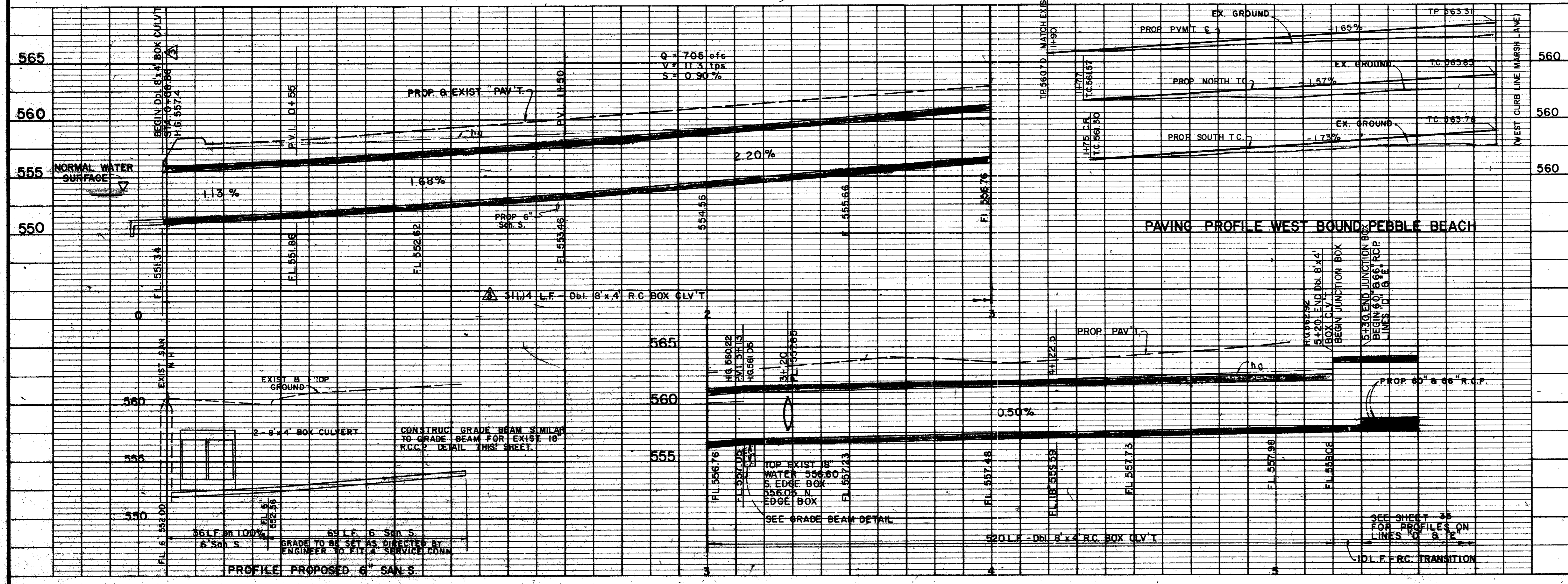
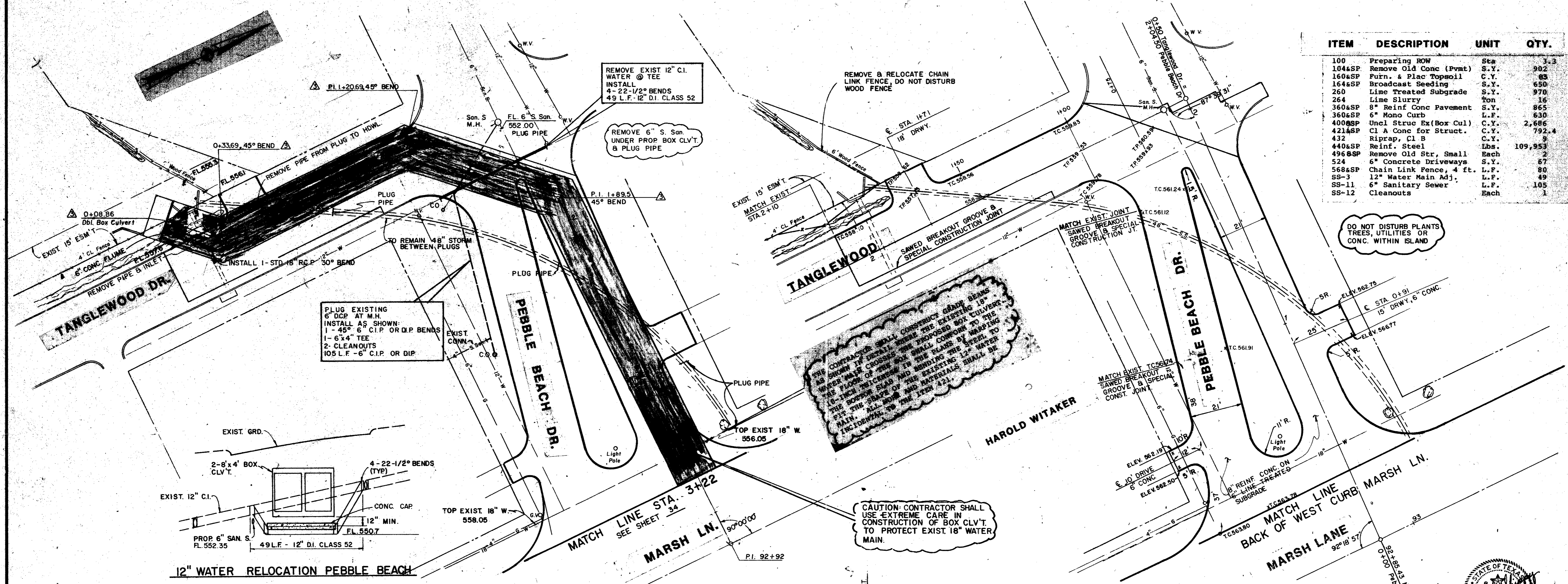

NOTE: ALL WORK AND MATERIALS TO CONSTRUCT GRADE BEAMS SHALL BE INCIDENTAL TO ITEM 421.

10" BOTTOM SLAB OF 2 SPAN 8' x 4' BOX

FILL WITH SAND

#3 BARS @ 10" O.C.

#3 BARS @ 18" O.C.

GRADE BEAM DETAILS AT EXISTING 18" RCCP WATER MAIN

*As Built 11-22-83*

NO.	DATE	REVISION	APPROV.
4			
9/82		REVISED ALIGNMENT 2-SPAN 8'x4' R.C. BOX CULVERT	
2	8/82	REVISED PER CHANGE ORDER NO. 2.	
1	5/82	AS PER ADDENDUM NO. 2, ART. 3.	

**CITIES OF ADDISON AND FARMERS BRANCH, TEXAS**

**MARSH LANE**

BROOKHAVEN CLUB DRIVE TO BELT LINE ROAD

Unit	PAL	Scale:	Horz. 1" = 20' Vert. 1" = 5'	Date	FEB 1982
Designed	GGG	Checked	GGG	Job No.	6042-010
Drawn	MAB	Approved	PAL	Contract	
			Sheet 15 of 66		