

CURVE DATA
 R = 75.00'
 Δ = 30° 00' 00"
 L = 39.27'
 T = 20.10'

ITEM	DESCRIPTION	UNIT	QTY.
249	Flex Base, Ty A, CI 2	Ton	190
310	Prime Coat (MC-30)	Gal	343
340&SP	HMAC, CI A Type D	Ton	151
465&SP	24" Rein Conc Pipe	L.F.	73
470&SP	24" Inlet	Each	1
568&SP	Chain Link Fence, 6-ft	L.F.	275

NOTE:
 TOP 18" WATER ±554.0 FROM EXIST. PLANS
 TOP 12" SAN.S. ±554.0
 VERIFY EXACT LOCATION IN FIELD
 PRIOR TO INSTALLATION OF 24" STORM

T.C. 566.08
 'Y' INLET
 F.L. (OPENING) 565.00
 F.L. 561.50
 73 L.F. - 24" R.C.P. on 2.00%

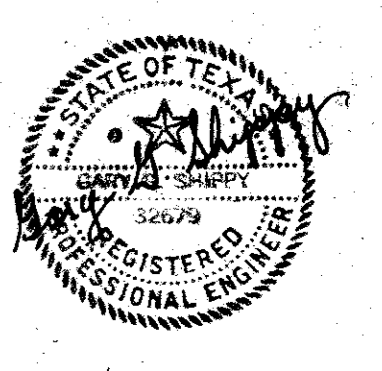
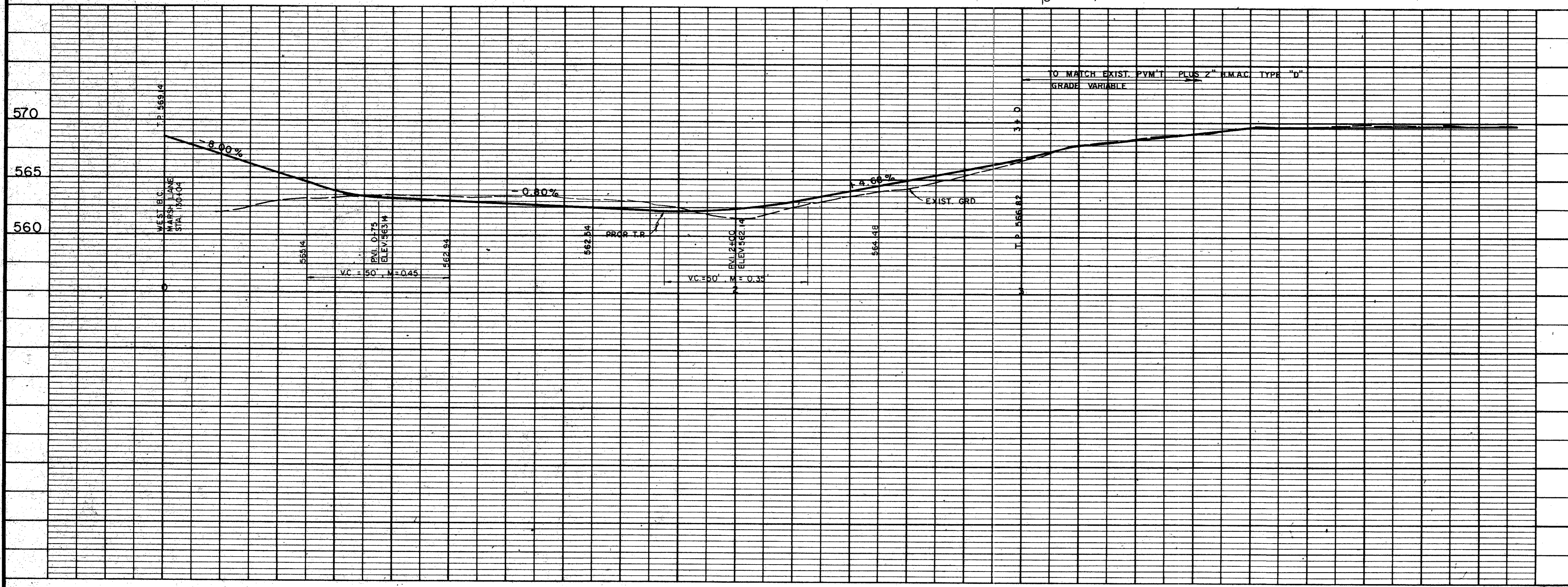

AS BUILTS 11-22-83

4			
3			
2			
1			
NO.	DATE	REVISION	APPROV.
CITIES OF ADDISON AND FARMERS BRANCH, TEXAS MARSH LANE BROOKHAVEN CLUB DRIVE TO BELT LINE ROAD ACCESS ROAD TO BELT - MARSH. PUMP STATION Turner Collier & Braden Inc.			
Unit	PAL	Scale: Horiz. 1" = 20' Vert. 1" = 5'	Date FEB. 1982
Designed	GGG	Checked GGS	Job No. 6042-011 Contract
Drawn	LJK	Approved PAL	Sheet 23 of 66