

BELT LINE ROAD

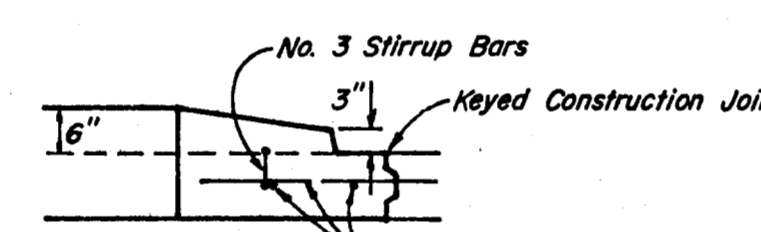

Note: Monolithic Med. Nose & Pvmt. Pavement Reinf. Bars shall be paid for as part of Item 360.3

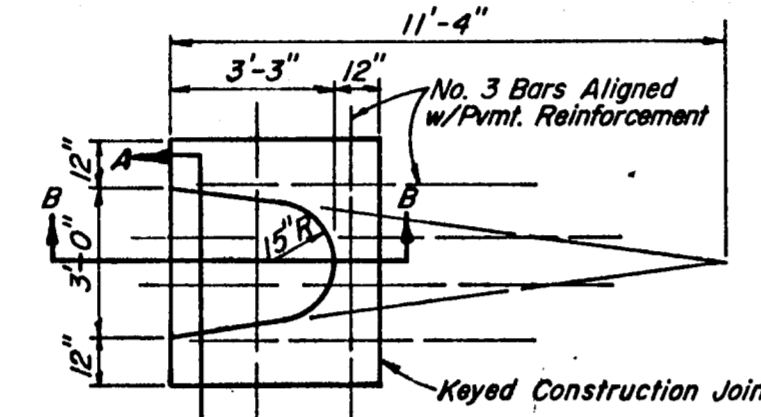
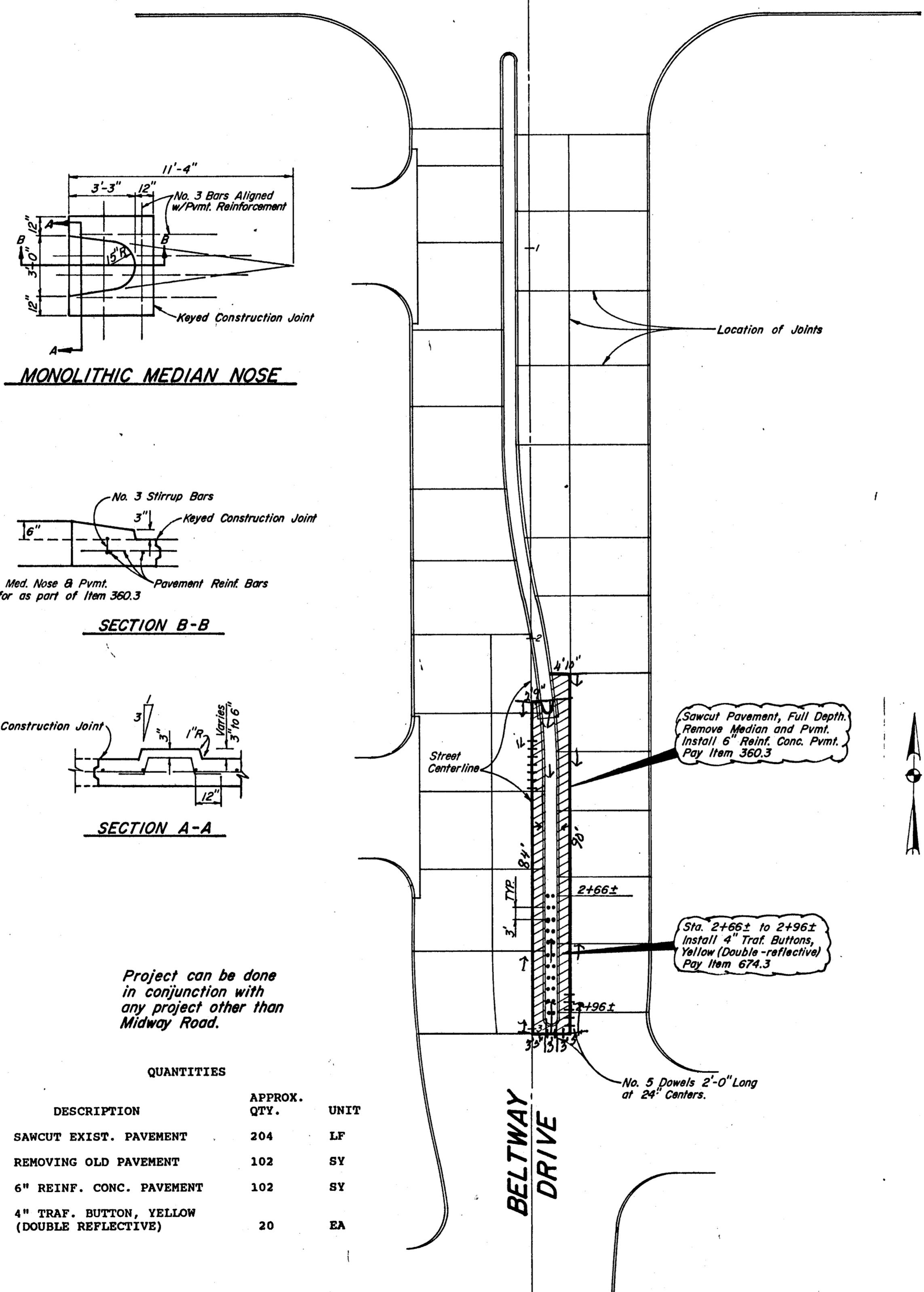
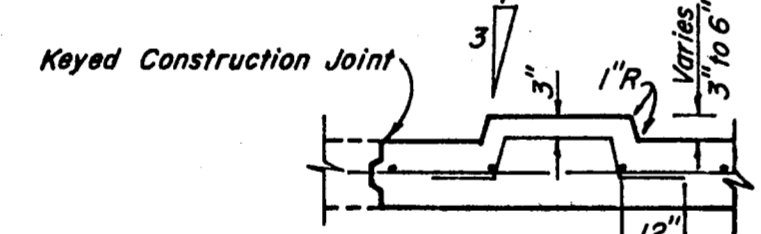

Project can be done in conjunction with any project other than Midway Road.

ITEM #	DESCRIPTION	APPROX. QTY.	UNIT
104.1	SAWCUT EXIST. PAVEMENT	204	LF
104.2	REMOVING OLD PAVEMENT	102	SY
360.3	6" REINF. CONC. PAVEMENT	102	SY
674.3	4" TRAF. BUTTON, YELLOW (DOUBLE REFLECTIVE)	20	EA

BELTWAY DRIVE IMPROVEMENTS

SCALE: 1" = 20'

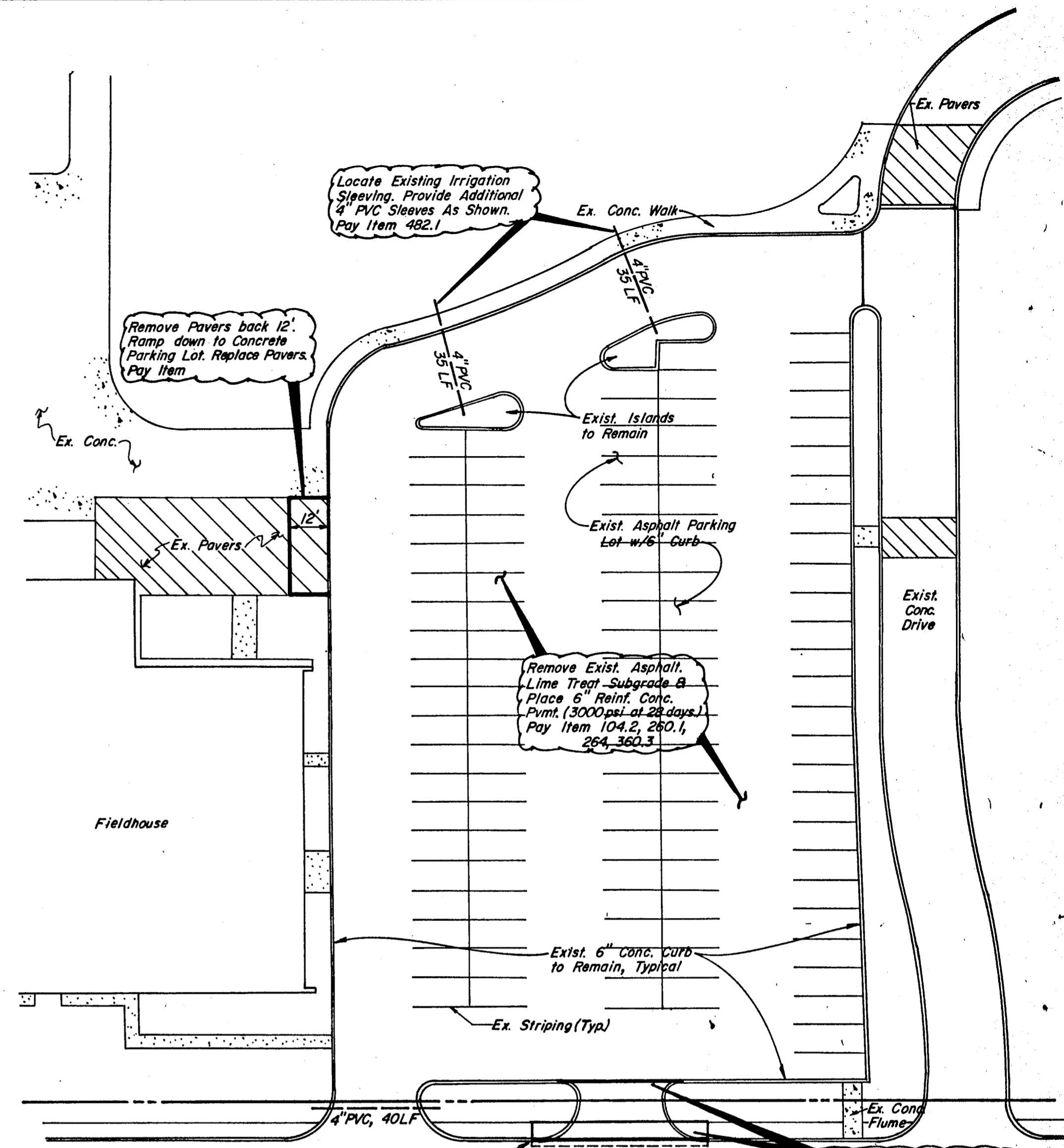

TRINITY CHRISTIAN ACADEMY PARKING LOT IMPROVEMENTS

SCALE: 1" = 30'

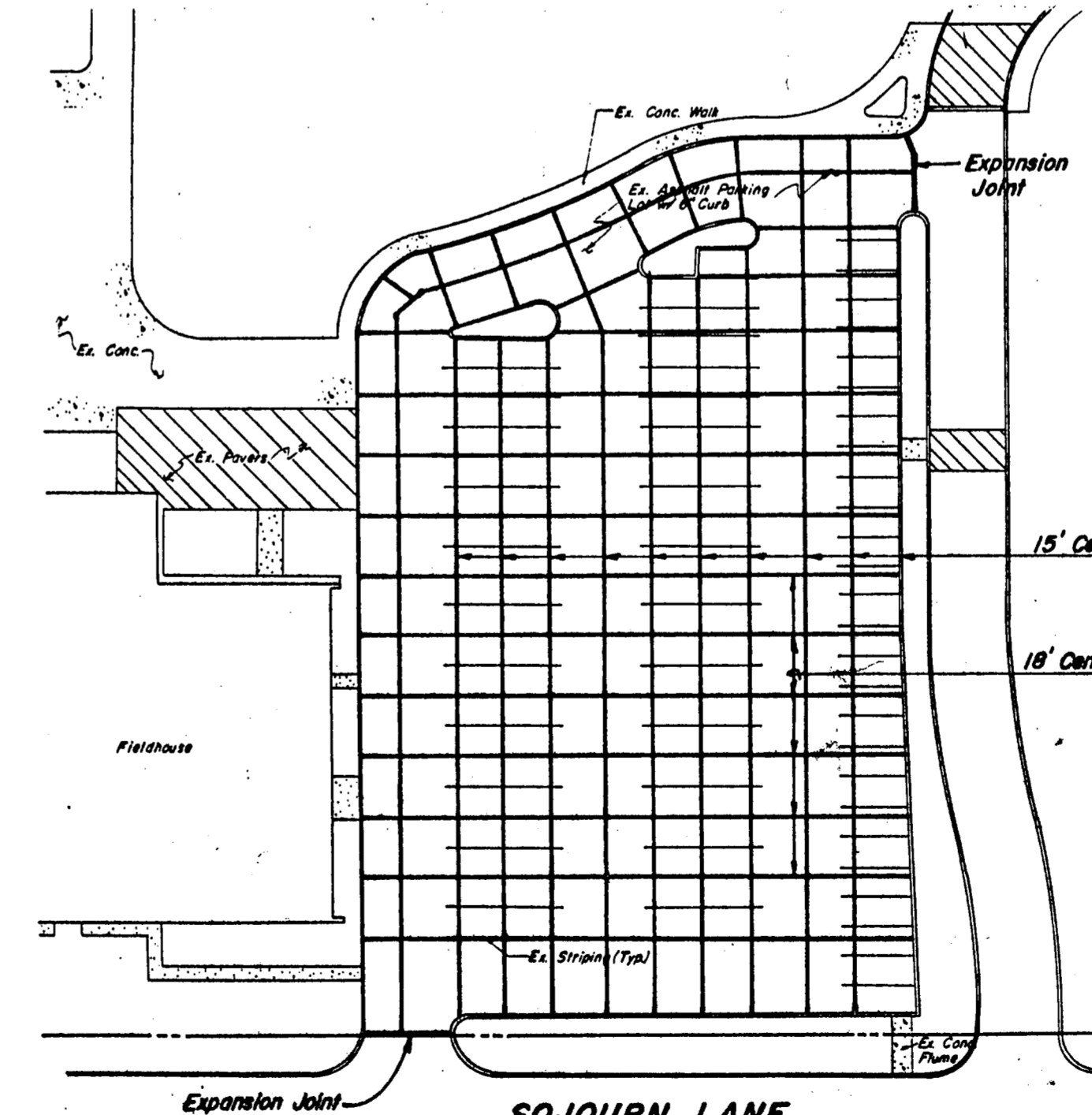

T.C.A. PARKING LOT SAWED JOINT LAYOUT

NO SCALE

ITEM #	DESCRIPTION	APPROX. QTY.	UNIT
104.1	SAWCUT EXIST. PAVEMENT	185	LF
104.2	REMOVING OLD PAVEMENT	4740	SY
260.1	LIME TREATMENT FOR MAT. IN PLACE	4740	SY
264	HYDRATED LIME (27#/SY) TYPE A-6#	64	TON
360.3	6" REINF. CONC. PAVEMENT	4740	SY
360.4	6" INTEGRAL CONCRETE CURB	40	LF
360.5	6" DOWELED CURB & GUTTER	55	LF
550.1	4" CONCRETE SIDEWALK	31	SY
670	PAVEMENT MARKINGS	2380	LF

RECORD DRAWING (C-11)

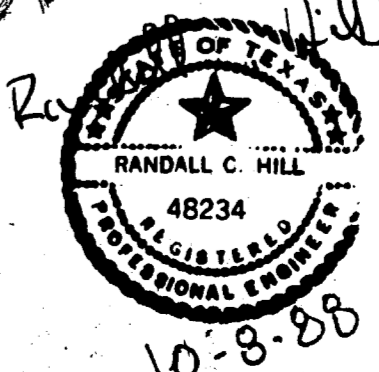

No.	Revision	By	Date
TOWN OF ADDISON DALLAS COUNTY, TEXAS MISC. PAVEMENT IMPROVEMENTS T.C.A. PARKING LOT IMPROVEMENTS BELTWAY DRIVE GINN, INC. Consulting Engineers Dallas, Texas			
Designed - RCH	Drawn - TEC	Date - OCTOBER, 1988	Job No. - 87372
Approved - HWG	Checked - RCH	Scale - AS SHOWN	Sheet 11 of 16