

GENERAL NOTES - MIDWAY ROAD IMPROVEMENTS

1. Prior to start, Contractor shall notify TU Electric crews to remove street light wires from the conduit. Contractor shall be responsible for repairing and replacing any TU Electric FVC conduit damaged during construction. He shall pay TU Electric for costs of labor for reinstalling the wire and damage to poles, bases and hand holes caused by his work. Contact Steve White at 323-8921 prior to beginning work.
2. The Town of Addison has a traffic signal interconnect conduit and cable in the median of Midway Road. Should the interconnect be damaged during construction, contractor shall pay for interconnect repairs which will be done by a Town approved signal contractor.
3. Traffic loops and pull boxes have been located on the plans to provide general information to the contractor. Contractor should use extreme care in removing concrete pavement so as not to damage traffic signal loops or wire. Any needed repairs to loops or pull boxes shall be done by a Town approved signal contractor.
4. Contractor must plan to keep existing landscape watered throughout construction process. Any materials removed shall be replaced with new materials similar in size and type. Where trees are in the narrow sections of the median, use of a narrow form is recommended (2x12) to allow for a minimum of excavation and disturbance to landscape. The Landscape Dept. shall be advised of sprinkler changes that might effect plant material. Contractor shall locate and relocate sprinkler lines and heads prior to start of work. He shall repair all damages to irrigation systems (pipes, wiring, and heads) at his cost and within a reasonable time. Concrete pavers removed to facilitate construction shall be replaced after completing the work.
5. Contractor shall remove curbs or panels of street sections to existing sawed joints or redwood headers. All dowels used to connect to existing pavement shall be epoxied with an approved product.
6. Early strength concrete shall be used for all concrete work on Midway Rd (3000 PSI in 48 Hours).
7. Buttons and road markings must be protected from equipment.
8. All concrete landscape headers shall be removed.
9. The General Contractor must have a superintendent from his office onsite at all times for the work along Midway Road.
10. Contractor shall maintain a minimum of two lanes of free flowing traffic for northbound and southbound traffic at all times.
11. Contractor shall confine blocking of any lanes of traffic and major construction activities to between 9:30 a.m. and 3:30 p.m.
12. Contractor shall contact the following representatives prior to beginning his work on Midway Road.  
 TU Electric - Steve White, 323-8921  
 Lone Star Gas - Leon Weatherford, 487-3808  
 Southwestern Bell - Bob Zechman, 739-7643  
 Storer Cable - Rudy Fernandez, 840-2288
13. After all existing concrete is removed from the repair area Contractor shall roll subgrade to locate any soft areas. Contractor shall notify Engineer of any soft areas immediately. The soft areas shall be excavated and recompacted with the same type material found in adjacent subgrade. The material shall be compacted to 95% of Standard. Proctor at 1 to 3 percentage points over optimum moisture as determined by AASHTO standard methods.
14. If length of removal of curb and gutter falls within 3 feet of a sawed joint, then the removal shall be extended to the sawed joint.

STA. 0+00 BEGIN THIS PROJECT

MATCH LINE STA. 5+00

MATCH LINE STA. 5+00

MATCH LINE STA. 10+00

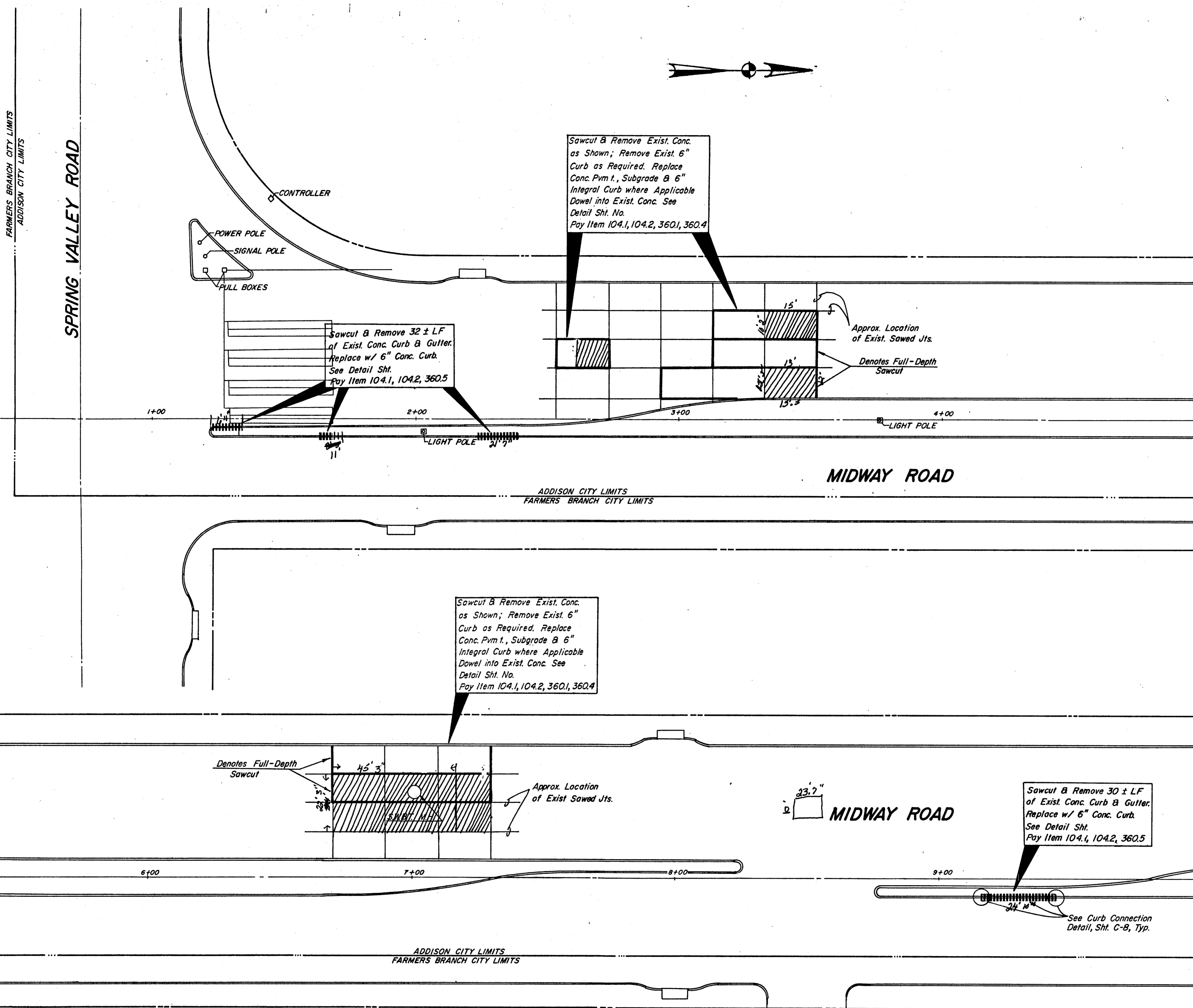

QUANTITIES

ITEM #	DESCRIPTION	APPROX. QTY.	UNIT
104.1	SAWCUT EXIST. PAVEMENT	520	LF
104.2	REMOVING OLD PAVEMENT	366	SY
360.1	10" REINF. CONC. PAVEMENT	356	SY
360.4	6" INTEGRAL CONC. CURB	90	LF
360.5	6" DOWELED CURB & GUTTER	62	LF
674.1	4" TRAF. BUTTON, WHITE (NON-REFLECTIVE)	28	EA
674.2	4" TRAF. BUTTON, WHITE (SINGLE REFLECTIVE)	8	EA

RECORD DRAWING

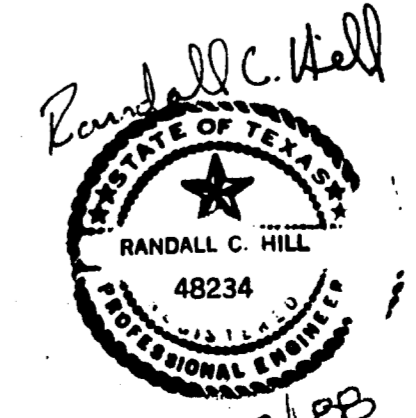

C-3

No.	Revision	By	Date

TOWN OF ADDISON  
DALLAS COUNTY, TEXAS  
**MISC. PAVEMENT IMPROVEMENTS**  
MIDWAY ROAD  
**STA. 0+00 to STA. 10+00**  
GINN, INC.  
Consulting Engineers Dallas, Texas

Designed - RCH Drawn - DEM Date - JULY, 1988 Job No. - 87372  
Approved - HWG Checked - RCH Scale - 1"=20' Sheet 3 of 16