

**SURVEY CONTROL POINTS**  
 CP 829 PK NAIL SET N 11207.0265 E 10038.2337  
 CP 830 PK NAIL SET N 10940.2447 E 10179.0812

- NOTES:**
- CONTRACTOR SHALL RECONSTRUCT AND REPLACE FLOWER BEDS WITH LIKE PLANTS AND FLOWERS AS DIRECTED BY TOWN OF ADDISON. FLOWER BEDS SHALL COMPOSED OF 8 INCHES OF IMPORTED TOP SOIL FOR BEDDING PLANTS.
  - CONTRACTOR SHALL PROTECT INLETS AND CURB ALONG MARSH LANE.
  - REPLACE 5' SIDEWALK FROM STA. 10+00 TO STA. 11+81.25, STA. 12+16.78 TO STA. 14+22.26 AND STA. 14+51.74 TO STA. 14+68.77, 3.84' RT.
  - COORDINATES ARE PROJECT SPECIFIC AND NOT STATE PLANE RELATED.
  - CONTRACTOR SHALL FURNISH & INSTALL NEW METER BOXES FOR EACH WATER SERVICE IN THE RIGHT-OF-WAY. EXISTING METER BOXES SHALL BE REMOVED AND WATER SERVICE LINE CONNECTED. EXISTING METER SHALL BE THE PROPERTY OF THE TOWN. ALL CONNECTIONS IN NEW METER BOX SHALL BE BY THE CONTRACTOR.
  - METER BOXES REMOVAL FROM SIDEWALK, CONTRACTOR SHALL REMOVE FULL SLAB OF SIDEWALK AND REPLACE WITH 4 INCH REINFORCED CONCRETE SIDEWALK.
  - METER BOXES REMOVED FROM PAVEMENT SECTIONS SHALL BE REPLACED WITH THE PAVEMENT REPLACEMENT SECTIONS SHOWN ON SHEET 8. SIZE OF PATCH SHALL BE MIN. 2 FT. BY 2 FT. AND MAXIMUM OF 3 FT. BY 3 FT. SAW CUT EXISTING PAVEMENT.

**CONTRACTOR TO FIELD VERIFY LOCATION OF EXISTING UTILITIES MIN. 48 HOURS PRIOR TO START OF CONSTRUCTION.**

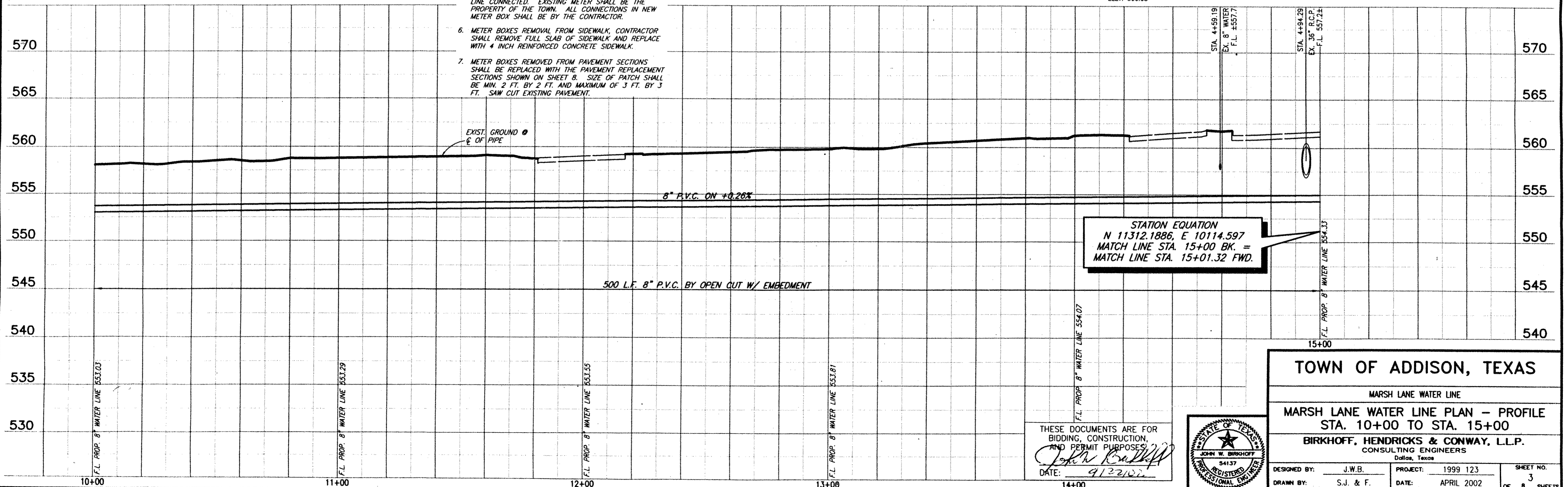

WATER SERVICES	
LOCATION	PROP. 2" SERVICE (L.F.)
STA. 13+85.4 LT.	5.1

FURNISH & INSTALL: PROP. 2" OUTLET, 2" TYPE K COPPER, METER BOX AND DOUBLE CHECK VALVE ASSEMBLY. CONNECT TO EXISTING WATER LINE AT EACH WATER SERVICE LOCATION. TOWN TO FURNISH WATER METER.

- H.M.A.C. REMOVAL AND REPLACEMENT
- CONCRETE PAVEMENT, CURB & WALK REMOVAL AND REPLACEMENT
- SHADING INDICATES APPROX. WIDTH OF TRACK HOE

These plans and related specifications were prepared for construction of this specific project only. Reuse of these documents is not permitted without written authorization of Birkhoff, Hendricks & Conway, L.L.P.

BENCHMARK: T.B.M. 27 "O" CENTER OF INLET LOCATED APPROX. 60' EAST OF NE INTERSECTION OF MARSH LN. & BROOKHAVEN CLUB DRIVE. ELEV. 546.91  
 T.B.M. ML-1 "O" CENTER OF INLET LOCATED APPROX. 530' SOUTH OF INTERSECTION OF MARSH LN. & SPRING VALLEY RD. ELEV. 566.08

**STATION EQUATION**  
 N 11312.1886, E 10114.597  
 MATCH LINE STA. 15+00 BK. =  
 MATCH LINE STA. 15+01.32 FWD.

**TOWN OF ADDISON, TEXAS**

MARSH LANE WATER LINE

**MARSH LANE WATER LINE PLAN - PROFILE**  
 STA. 10+00 TO STA. 15+00

**BIRKHOFF, HENDRICKS & CONWAY, L.L.P.**  
 CONSULTING ENGINEERS  
 Dallas, Texas

DESIGNED BY: J.W.B. PROJECT: 1999 123 SHEET NO. 3  
 DRAWN BY: S.J. & F. DATE: APRIL 2002 OF 8 SHEETS

THESE DOCUMENTS ARE FOR BIDDING, CONSTRUCTION AND PERMIT PURPOSES.  
 DATE: 4/3/02

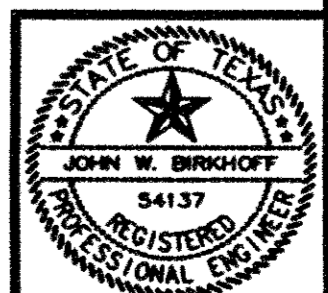

99123W03.DWG SCALE: 1"=20' BLOCKS: PROFILES  
 04/16/02 R.L.