

- 1133-Ln. 16" O.D. Const. 4' Dia. M.H.
- 0183-50-End LINE 14"
- 13170-Ln. 14" O.D. Const. 4' Dia. M.H.
- 4158-Ln. 14" O.D. Const. 4' Dia. M.H.
- 15130-Ln. 14" O.D. Const. 4' Dia. M.H.
- 11742-Ln. 14" O.D. Const. 4' Dia. M.H.
- 4440-Ln. 14" O.D. Const. 4' Dia. M.H.
- 20155-Ln. 14" O.D. Const. 4' Dia. M.H.

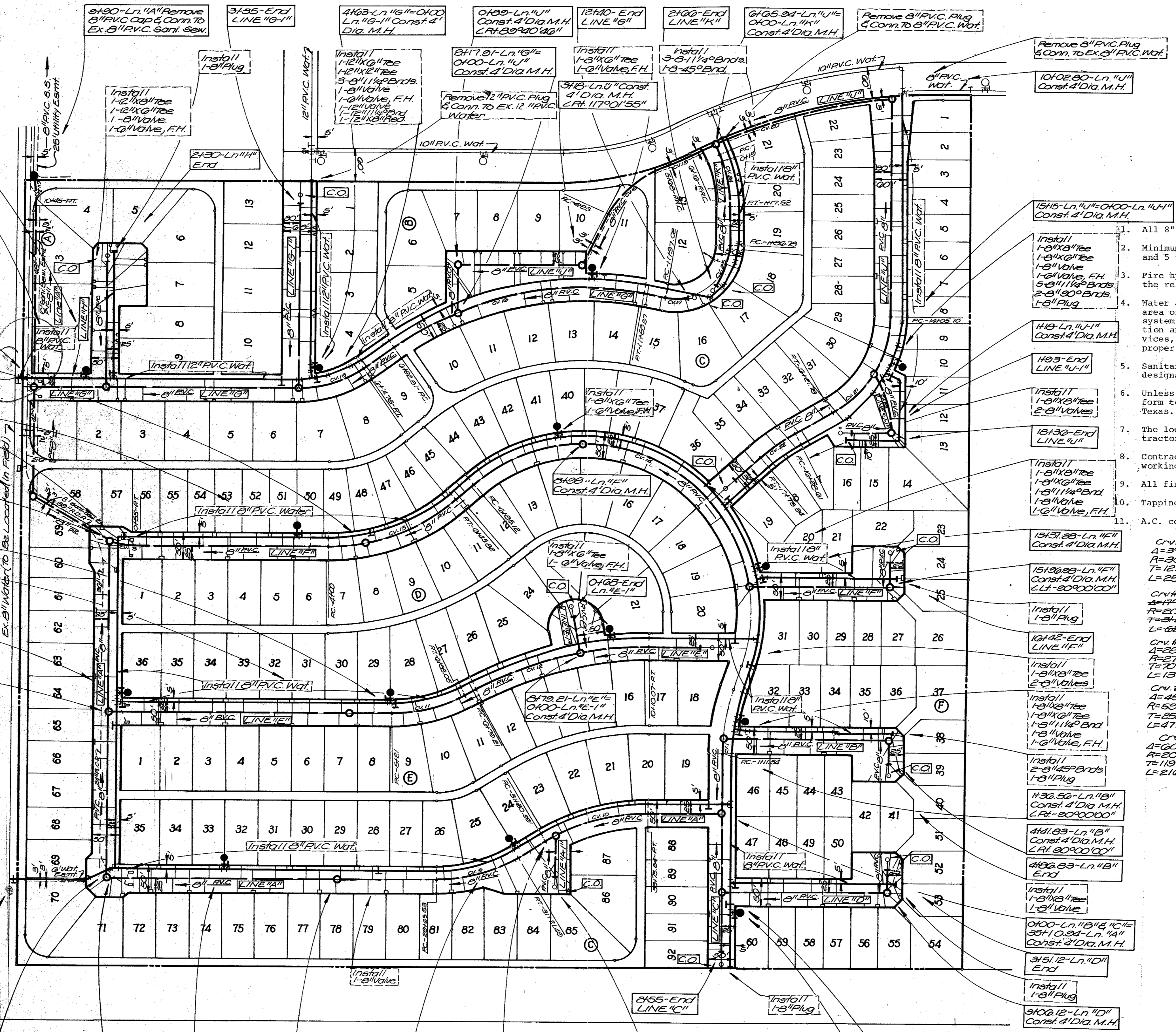

Install 1-3/8" tapping sleeve & 1-3/8" valve

- 23160-Ln. 14" Const. 4' Dia. M.H. C.R.# 3013154"
- Install 1-3/8" Tee 2-3/8" Valves
- Install 1-3/8" Tee 1-3/8" Valve, F.H.
- 27181-Ln. 14" Const. 4' Dia. M.H.
- Install 1-3/8" Tee 1-3/8" Valve, F.H.
- 32401.00-Ln. 14" O.D. Const. 4' Dia. M.H.
- 0175-End Ln. 14"
- 143146-Ln. 14" O.D. Const. 4' Dia. M.H.
- Install 1-3/8" Tee 1-3/8" Valve, F.H.

- 296 Meter Boxes
- 83 3/4" Services (short)
- 3 3/4" Services (long)
- 15 1" Services w/ 1/4" Bullhead (short)
- 90 1" Services w/ 1/4" Bullhead (long)

GENERAL NOTES

- All 8" and 12" water mains to be SDR-18 PVC with #12 tracer wire
- Minimum cover for water mains to be 4 feet for 6" and 8" pipe, and 5 to 6 feet for pipe 12" or larger.
- Fire hydrant and valve grade adjustments (after paving) shall be the responsibility of the utility contractor.
- Water and sanitary sewer easements shall also include additional area of working space for construction and maintenance of the system. Additional easement area is also conveyed for installation and maintenance of manholes, cleanouts, fire hydrants, services, laterals, meters, and other appurtenances necessary for proper operation of the systems.
- Sanitary sewer pipe joints shall conform to current A.S.T.M. designation C-245. SDR-35 PVC.
- Unless otherwise noted, all material and construction shall conform to the standard specifications of the City of Addison, Texas.
- The location of all existing utilities to be verified by contractor prior to start of construction.
- Contractor to notify utility companies at least 48 hours (2 working days) prior to start of construction.
- All fire hydrants shall be Mueller Centurion model.
- Tapping sleeves to be Mueller or Clow.
- A.C. collars to be provided in manholes.

Sanitary Sewer Curve Data

Cr. #1	Cr. #2	Cr. #3	Cr. #4	Cr. #5
A=3053.93'	A=15945.23'	A=15945.23'	A=2000.44'	A=1922.50'
R=300.23'	R=200'	R=200'	R=200'	R=200'
T=12.51'	T=27.01'	T=27.01'	T=43.00'	T=34.33'
L=25.02'	L=55.0'	L=55.0'	L=86'	L=68'

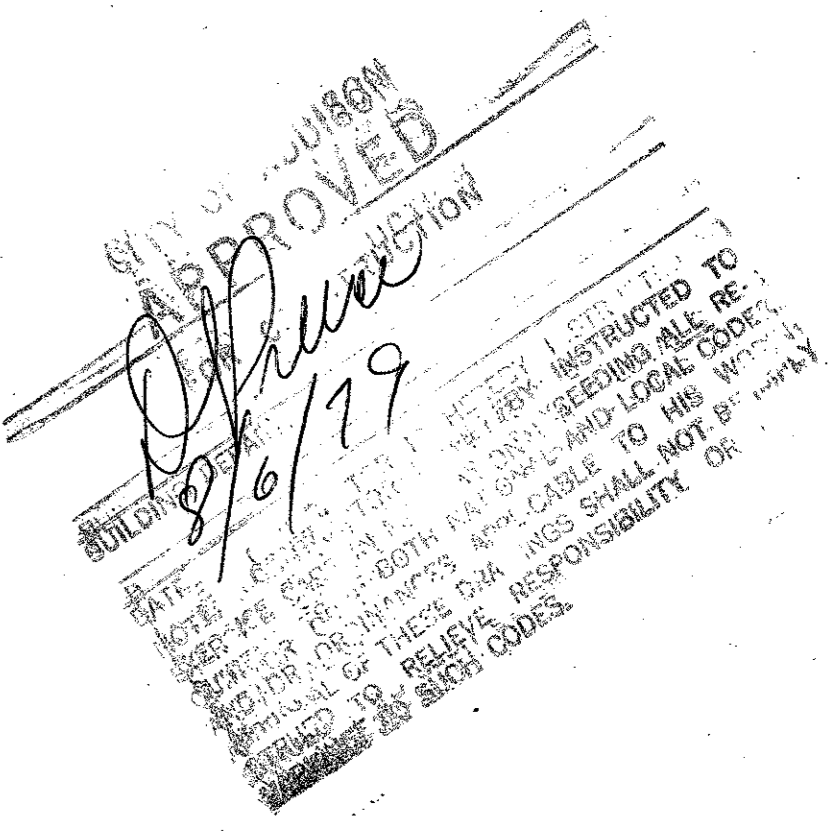

WATER & SEWER PLAN
MIDWAY MEADOWS
ADDISON, TEXAS
 Don A. Tipton, Inc. ~ Consulting Engineers
 13600 L.B.J. Freeway ~ Garland, Texas 75041

Design	Drawn	Date	Scale	Notes	File	No.
D.A.T.	D.A.T.	June 1, 1979	1" = 100'	d.b.	Midway Meadows	17

WATER & SEWER PLAN #1025