

LINE "A"

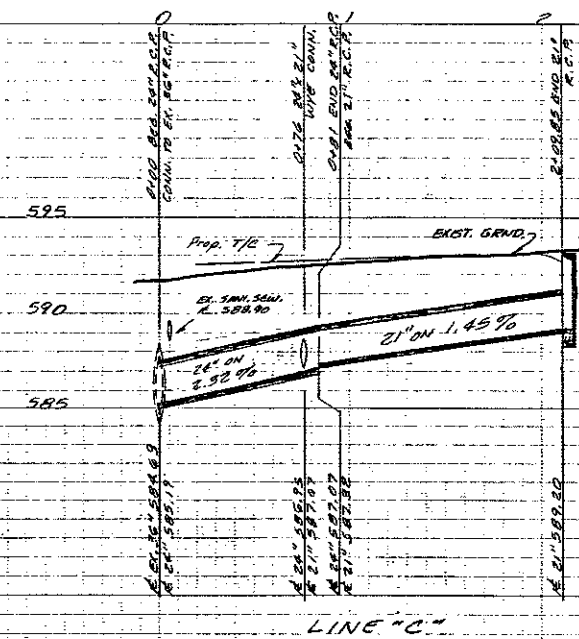

LINE "C"

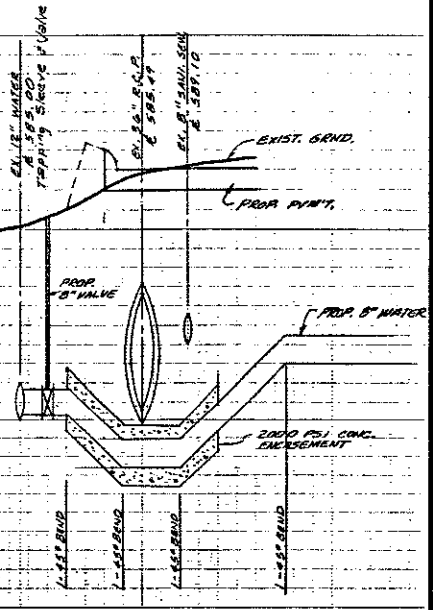

WATER LINE CROSSING DETAIL  
SCALE: 1" = 10' H.  
1" = 2' V.

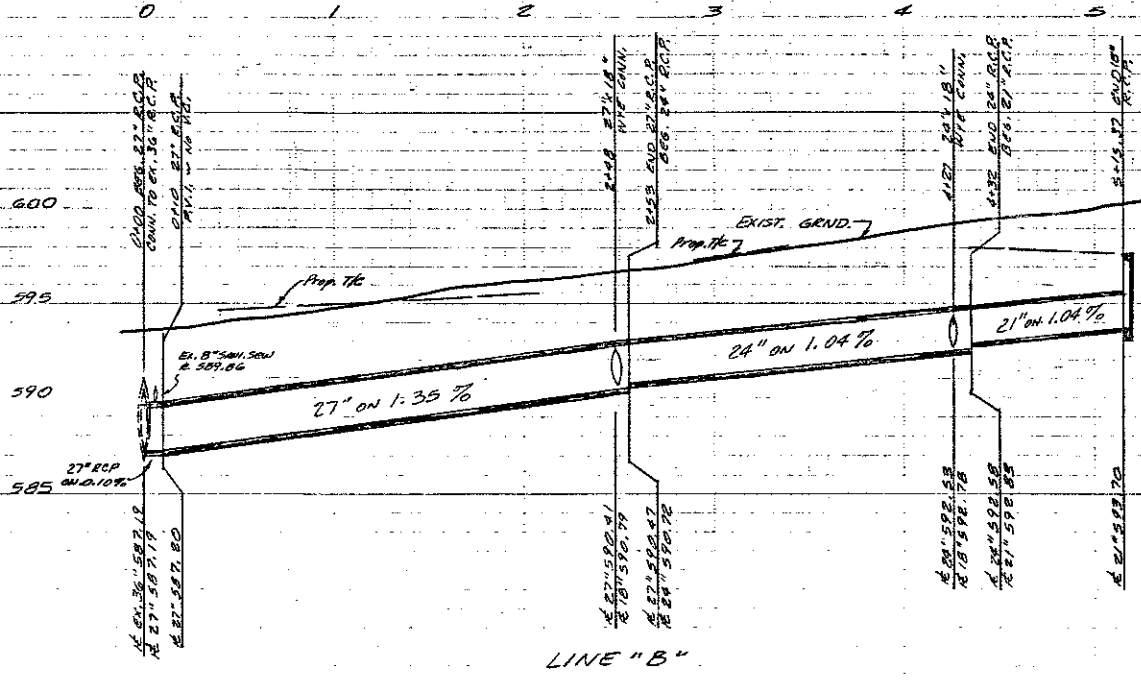

LINE "B"

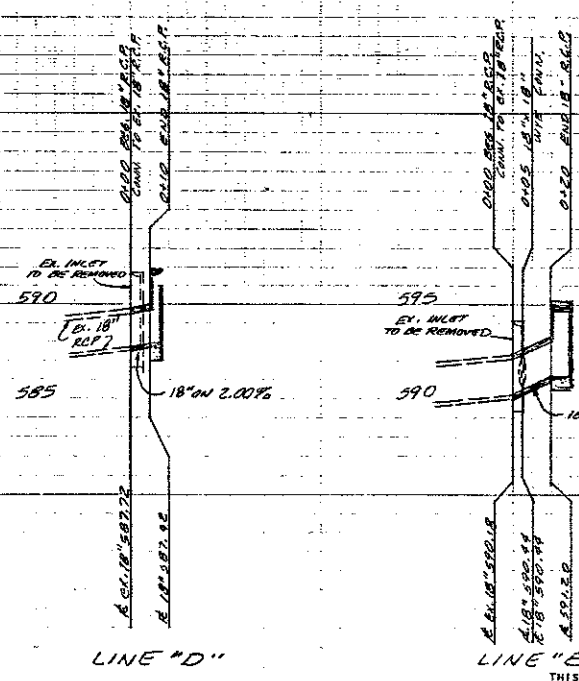

LINE "D"

LINE "E"

ALL STORM SEWER PIPE TO BE REINFORCED CONCRETE, CLASS III.  
**AS BUILT PLANS**

NOTE: THE INTENT OF THE OWNER AND ENGINEER WAS TO CONSTRUCT THE UTILITIES ACCORDING TO THESE PLANS AS APPROVED BY THE CITY OF ADDISON. THE LINES AND GRADES WERE SET ON THE GROUND FOR CONSTRUCTION ACCORDING TO SAID PLANS. THE CITY OF ADDISON INSPECTED THE CONSTRUCTION. THE OWNER OR ENGINEER DID NOT VERIFY LINES OR GRADES AFTER CONSTRUCTION. WE ARE NOT AWARE OF ANY CHANGES OR REVISIONS TO THESE PLANS DURING CONSTRUCTION, EXCEPT SOME PARKING ISLANDS HAVE CHANGED.

NOV. 14, 1985



BENCH MARK "D" OUT S.E. CORNER INLET @ N.E. CORNER OF POSTON ROAD & MIDWAY RD. ELEV. 598.77

OWNERSHIP OF DOCUMENTS  
THIS DOCUMENT, AND THE IDEAS AND DESIGNS INCORPORATED HEREIN, AS AN INSTRUMENT OF PROFESSIONAL SERVICE, IS THE PROPERTY OF THREADGILL-DOWDEY & ASSOCIATES AND IS NOT TO BE USED, IN WHOLE OR IN PART, FOR ANY OTHER PROJECT WITHOUT THE WRITTEN AUTHORIZATION OF THREADGILL-DOWDEY & ASSOCIATES

REVISED: SEPT. 5, 1984 R.E.

STORM SEWER PROFILES						
HUIE ADDISON ADDITION						
THOMAS L. CHENOWETH SUR., ABST. 273						
ADDISON, TEXAS						
THREADGILL - DOWDEY and ASSOCIATES						
CONSULTING ENGINEERS DALLAS, TEXAS						
DESIGN	DRAWN	CHECKED	DATE	SCALE	JOB	SHEET
ARN.	R.E.	D.M.D.	6-84	1/4" = 1'	920B	2/2