

- GENERAL NOTES
1. All work to be performed in accordance with City of Addison Standards and Specifications
 2. Sanitary Sewer line embedment shall be 6" sand cushion on all sides of pipe. Remaining trench shall be backfilled and compacted with "select" material in accordance with City of Addison Standards and Specifications.
 3. Sanitary Sewer Cleanouts shall have 18" X 18" X 6" Concrete pad poured around top.

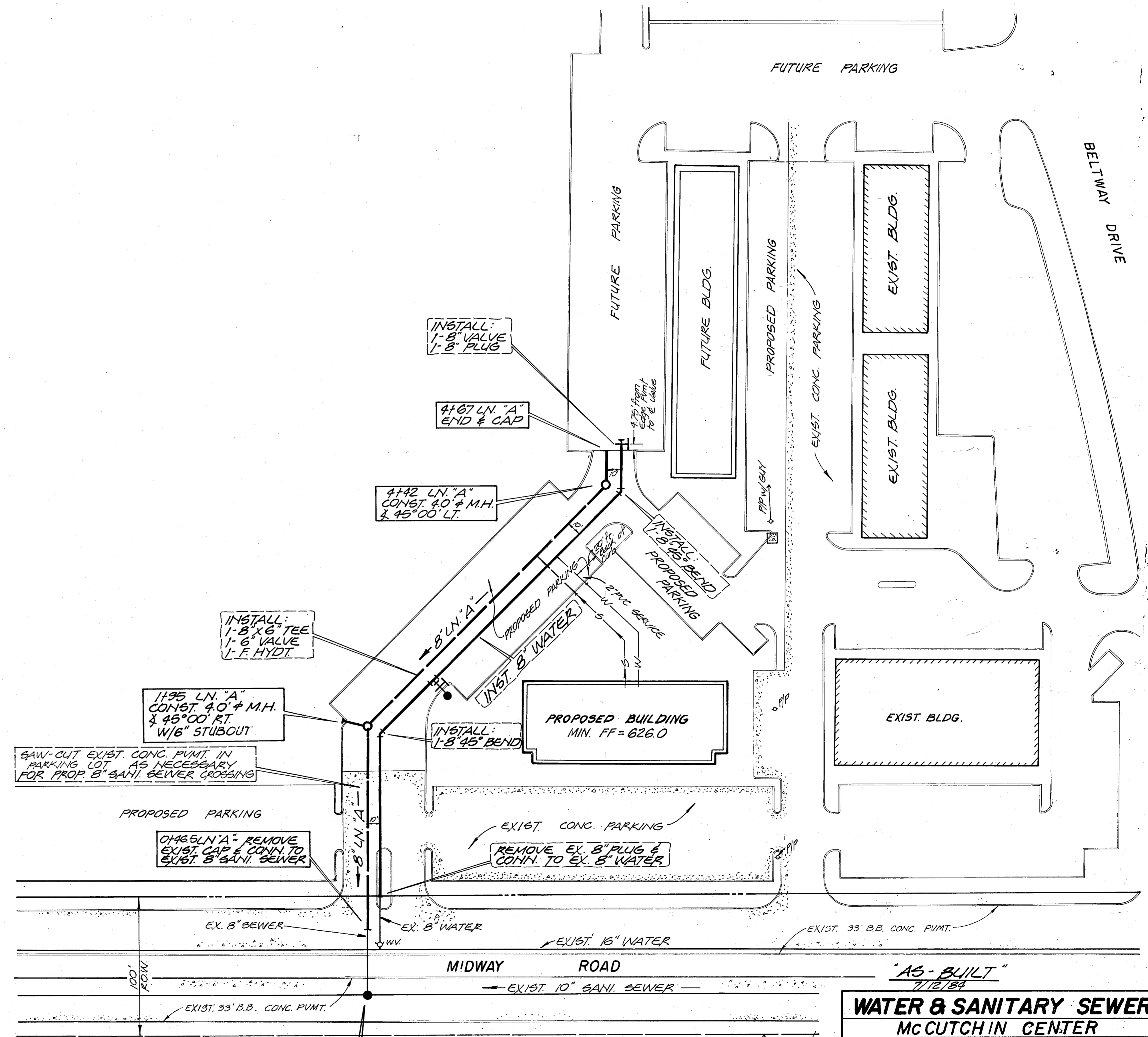

NOTE: IT IS THE RESPONSIBILITY OF THE CONTRACTOR TO LOCATE AND VERIFY ALL EXISTING UTILITIES PRIOR TO CONSTRUCTION IN THIS AREA.

"AS-BUILT"
7/12/84

WATER & SANITARY SEWER
MCCUTCHIN CENTER
ADDISON, TEXAS
HERSEY & ASSOCIATES, INC.
CONSULTING ENGINEERS DALLAS, TEXAS

DESIGN	DRAWN	DATE	SCALE	NOTES	FILE	NO.
H&A INC.	H&A INC.	9/83	1"=40'			

BM. ~ 1.8 IN 24" HACK, 300'± SOUTH OF BELTWAY 1000'± WEST OF MIDWAY ROAD. ELEV. = 633.61

