

LANDSCAPE SPECIFICATIONS

SECTION 02900

PART 1 - GENERAL

1. REFERENCED DOCUMENTS

- A. Refer to bidding requirements, special provisions, and schedules for additional requirements.

2. DESCRIPTION OF WORK

- A. Work includes: Furnish all supervision, labor, materials, services, equipment and supplies required to complete the work covered in combination with the landscaping covered in these specifications and landscaping plans, including:
1. Planting trees, shrubs, and grass
2. Bed preparation and fertilization
3. Watering
4. Water and maintenance until final acceptance
5. Cleanup

3. REFERENCE STANDARDS

- A. American Standard for Nursery Stock published by American Association of Nurserymen 27 October 1966, Edition by American National Standards Institute, Inc. (ANSI) standard.
B. American Joint Committee on Horticultural Nomenclature: 1942 Edition of Standardized Plant Names.
C. Taxus Association of Horticulture, Grasses and Standards.

4. NOTIFICATION OF SOURCES AND SUBMITTALS

- A. The Contractor shall submit the following items to the Architect/Owner of the project:
1. Samples of plant material and soil for analysis.
2. Samples of soil for analysis.
3. Samples of soil for analysis.
4. Samples of soil for analysis.
5. Samples of soil for analysis.

5. JOB CONDITIONS

- A. General Contractor to complete the following items:
1. General Contractor to complete the following items.
2. General Contractor to complete the following items.
3. General Contractor to complete the following items.

Section 02900 - 01

PART 3 - EXECUTION

3.1 BED PREPARATION & FERTILIZATION

- A. Landscape Contractor to inspect all existing conditions and report any deficiencies to the Owner.
B. All planting areas shall be conditioned as follows:
1. Prepare new planting beds by removing any existing grass and weeds to a depth of 10 inches and to a depth of 12 inches below the grade.
2. All planting beds shall be prepared to a depth of 12 inches below the grade.
3. Bedding for tree pits shall be as follows:
4. Grass Areas:

Section 02900 - 02

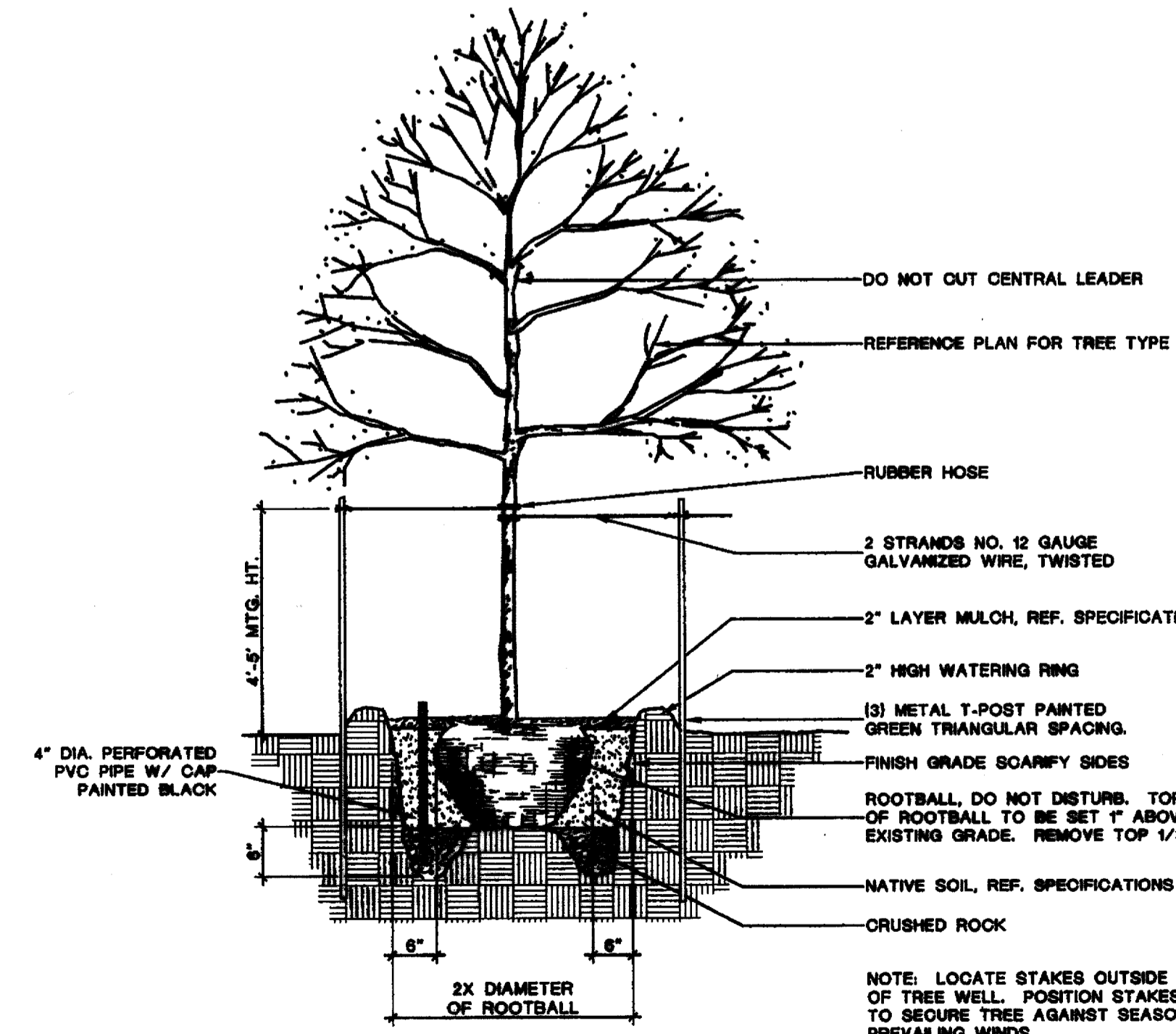

01 TREE PLANTING DETAIL NOT TO SCALE

Section 02900 - 02

3.2 INSTALLATION

- A. Maintenance of plant materials shall begin immediately after each plant is delivered to the site and shall continue until construction has been satisfactorily accomplished.
B. Plant materials shall be delivered to the site only after the beds are prepared and are ready for planting.
C. Dig a wide, rough sided hole exactly the same depth as the height of the ball, especially at the surface of the ground.
D. Fill the hole with water.
E. Examine the soil with vertical sides and horizontal bottom.
F. Pruning: All pruning of trees and shrubs, as directed by Landscape Architect, shall be executed by Landscape Contractor at no additional cost to the Owner.

Section 02900 - 03

3.3 INSTALLATION (cont.)

- F. Shrubs and tree pits shall be no less than two (2) feet, twenty-four (24") inches wider than the lateral diameter of the ball and six (6") inches deeper than the vertical dimension.
G. Dig a wide, rough sided hole exactly the same depth as the height of the ball, especially at the surface of the ground.
H. Perforation Test: Fill the hole with water.
I. Backfill only with 5 parts existing soil or sandy loam and 1 part bed preparation.
J. Do not wrap trees.
K. Do not over prune.
L. Match the top of the ball.
M. All plant beds and trees to be mulched with a minimum settled thickness of two (2") inches over the entire bed or pit.
N. Obstructions below ground: In the event rock or underground construction work or obstructions are encountered in any plant or shrub location, it shall be done under the section, alternate locations may be indicated by the Owner. Where locations cannot be changed, the obstructions shall be removed to a depth of not less than three (3) feet below grade and no less than six (6") inches below bottom of ball when such is properly set at the required grade.

Section 02900 - 04

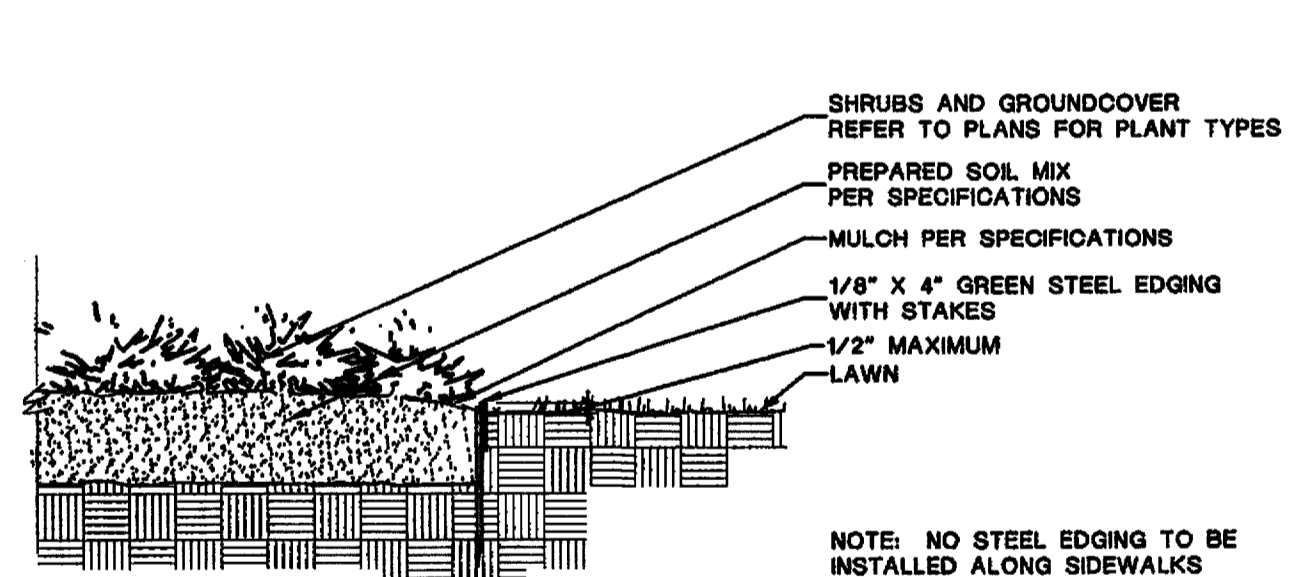

02 STEEL EDGING DETAIL NOT TO SCALE

Section 02900 - 05

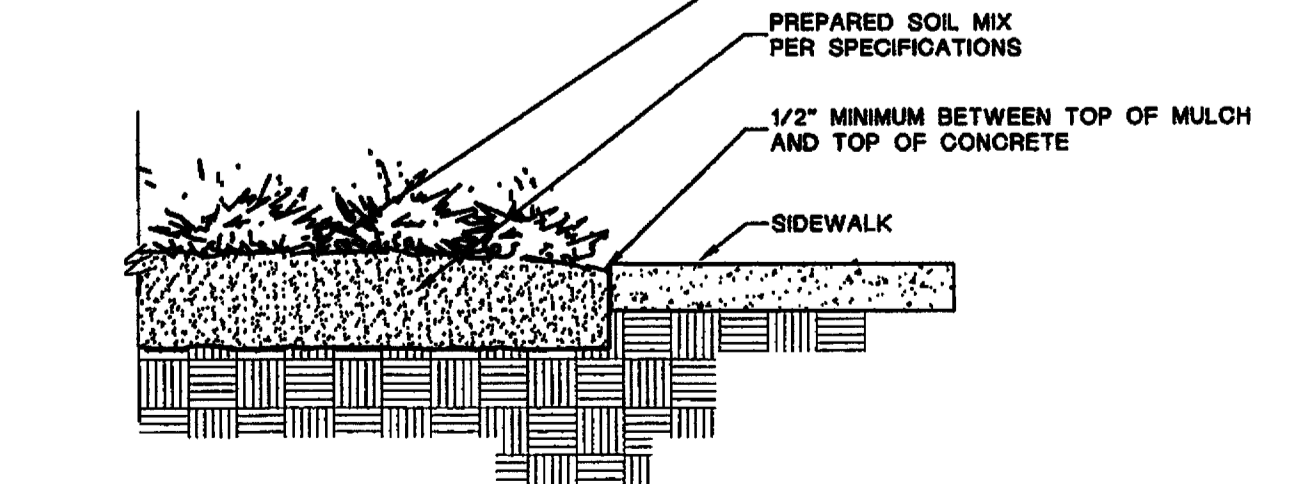

03 SHRUB / GROUNDCOVER DETAIL NOT TO SCALE

Section 02900 - 06



04 SIDEWALK / MULCH DETAIL NOT TO SCALE

2.2 SOIL PREPARATION MATERIALS

- A. Sandy Loam:
1. Friable, fertile, dark, loamy soil, free of clay lumps, subsoil, stones and other extraneous material.
2. Physical properties as follows:
3. Organic matter shall be 2% to 10% of total dry weight.
B. Organic Material Compost with a mixture of 90% vegetative matter and 10% animal waste.
C. Prepacked Bedding Soil as supplied by Vital Earth Resources, Gladewater, Texas.
D. Sharp Sand: Sharp sand must be free of seeds, soil particles and weeds.
E. Mulch: Double Shredded Hardwood Mulch, partially decomposed, dark brown.
F. Organic Fertilizer: Fertile, Sustene, or Green Sense or equal as recommended for required application.
G. Commercial Fertilizer: 10-20-10 or similar analysis.
H. Peat: Commercial sphagnum peat moss or partially decomposed shredded pine bark or other approved organic material.

2.3 MISCELLANEOUS MATERIALS

- A. Steel Edging: Shall be Ryerson "Estate Curbing", 1/8"x4" with stakes 4' on center.
B. Staking Material for Shade Trees:
1. Steel: Studied T-Post 1/2" Armo with anchor plate; 6'-0" length; paint black.
2. Wire: 12 gauge, single strand, galvanized wire.
3. Rubber hose: 2" inner diameter, minimum 1/2" inch inside diameter.
C. Gravel: Washed native pea gravel, graded 1 in. to 1 1/2" in.
D. Filter Fabric: Mifral 140H by Celanese Fibra Marketing Company, Available at Lottland Co., (214) 631-5290 or approved equal.

Section 02900 - 06

3.2 INSTALLATION (cont.)

- O. Trees and large shrubs shall be staked as site conditions require.
P. Pruning and Mulching: Each area shall be pruned in accordance with standard horticultural practice.
Q. Steel Curbing Installation:
1. Curbing shall be aligned as indicated on plans.
2. All steel curbing shall be free of kinks or abrupt bends.
3. Top of curbing shall be 1/2" maximum higher than existing grade.
4. Stakes are to be installed on the planting bed side of the curbing, as opposed to the grass side.
5. Do not install steel edging along sidewalks.
6. Cut steel edging at 45 degree angle where edging meets sidewalk.
R. Cleanup and Acceptance:
1. Cleanup: During the work, the premises shall be kept neat and orderly at all times. Storage areas for all materials shall be so organized that they, too, are neat and orderly. All trees and debris shall be removed from the site as work progresses. Keep paved areas clean by sweeping or hosing at end of each day's work.

END OF SECTION

Section 02900 - 08

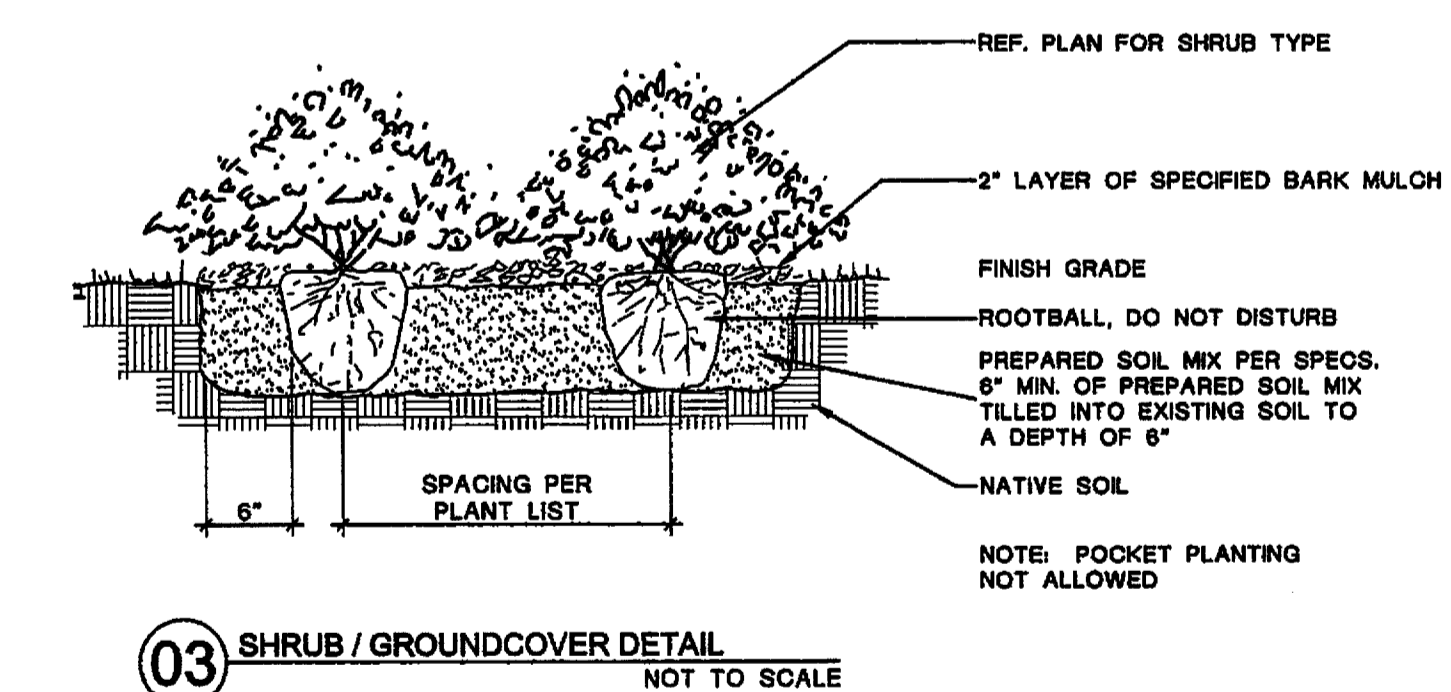

03 SHRUB / GROUNDCOVER DETAIL NOT TO SCALE

AS BUILT DATE 3.17.06

Table with columns: REV., DATE, REMARKS, LANDSCAPE SPECIFICATIONS, STARBUCKS - ADDISON PLAZA ADDITION, S.W.C. BELT LINE ROAD & MIDWAY RD., THE TOWN OF ADDISON, TEXAS, LAWRENCE A. CATES & ASSOC., LLP, CONSULTING ENGINEERS DALLAS, TEXAS, DESIGN, DRAWN, DATE, SCALE, NOTES, FILE, NO., BDA, BDA, 4-28-05, none, L.2

SMI landscape architects, inc. 1708 N. Griffin Street Dallas, Texas 75202 Tel 214.871.0083 Fax 214.871.0046 Email smi@smi-la.com

