

EXIST. FIRE HYDRANT  
120' +/- EAST OF SOUTHEAST  
CORNER OF TRACT

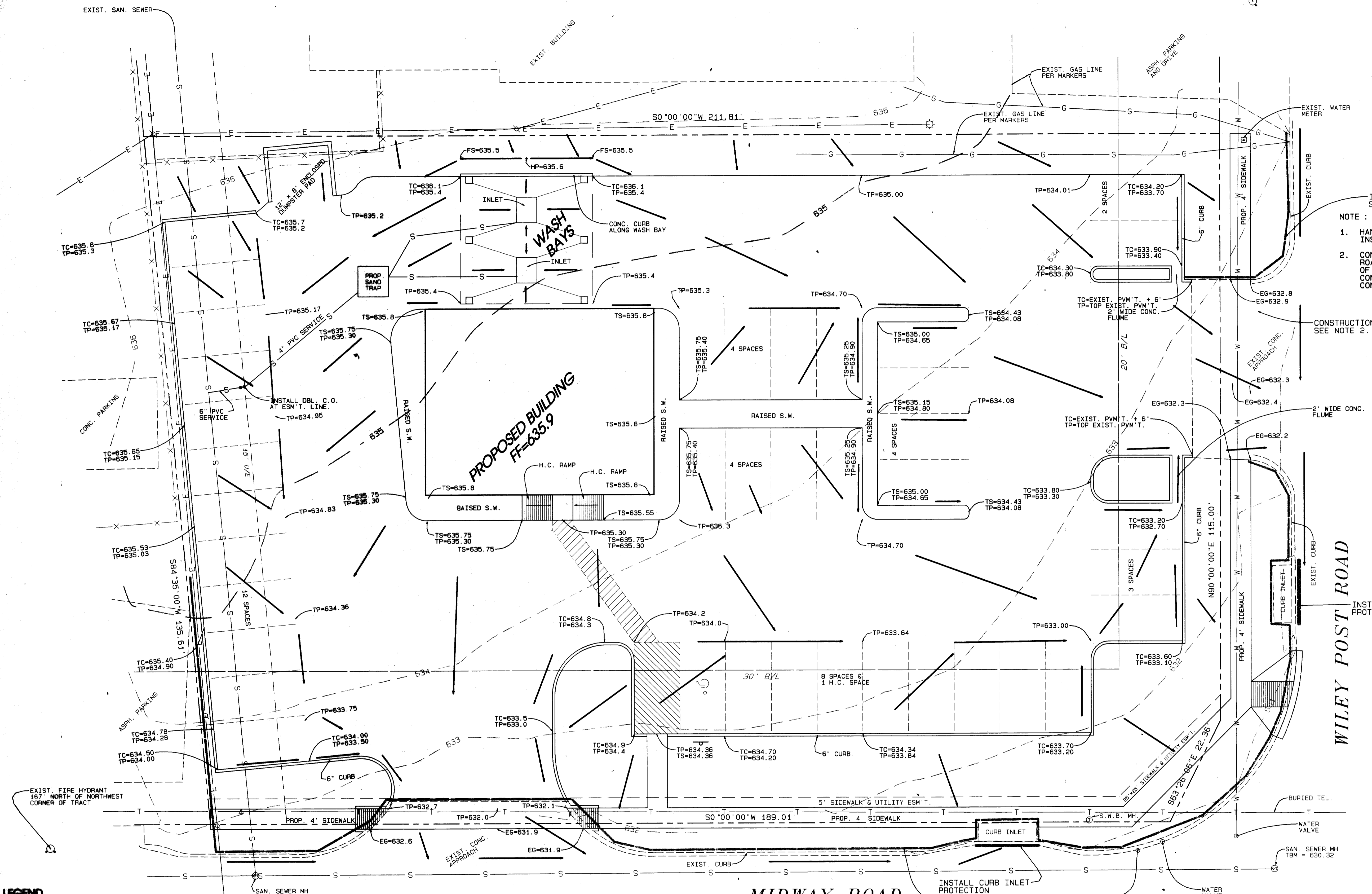

- NOTE:
- HANDICAP IMPROVEMENTS ARE TO BE INSPECTED BY THIRD PARTY INSPECTOR TO INSURE COMPLIANCE WITH T.A.S. REQUIREMENTS.
  - CONTRACTOR SHALL INSURE THAT NO MUD IS TRACKED ONTO EXISTING ROADWAYS. IF MUD IS TRACKED ONTO ADJACENT ROADWAYS, THE TOWN OF ADDISON, AT THE DISCRETION OF THE INSPECTOR, WILL REQUIRE A CONSTRUCTION ENTRANCE CONFORMING TO NCTCOG STANDARDS BE CONSTRUCTED AT THE CONTRACTOR'S EXPENSE.

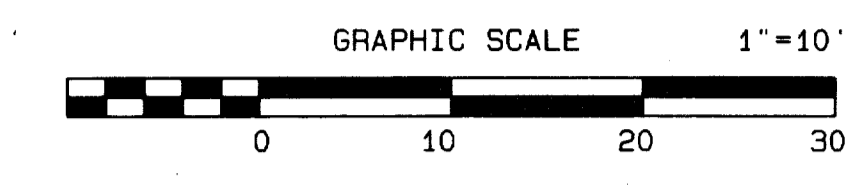
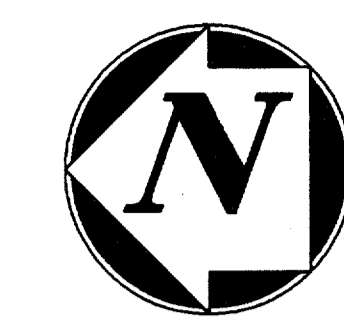
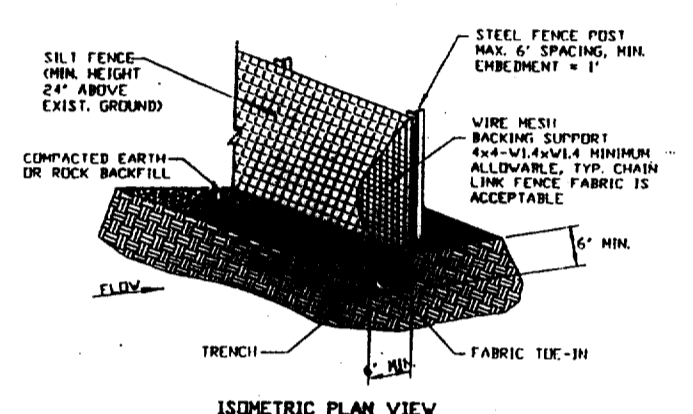

- SILT FENCE GENERAL NOTES**
- STEEL POSTS WHICH SUPPORT THE SILT FENCE SHALL BE INSTALLED IN A SLIGHT ANGLE TOWARD THE ANTICIPATED DIRECTION OF FLOW. POSTS MUST BE EMBEDDED A MINIMUM OF ONE FOOT.
  - THE TOP OF THE SILT FENCE SHALL BE TRENCHED IN WITH SPAN OR RECTANGULAR TRUSSELS SO THAT THE BOUNDARY FACE OF THE TRENCH IS FLAT AND PERPENDICULAR TO THE LINE OF FLOW. WIRE FENCE CANNOT BE TRENCHED IN TO PREVENT FLOW FROM SEEPING UNDER FENCE.
  - THE TRENCH MUST BE A MINIMUM OF 6 INCHES DEEP AND 6 INCHES WIDE TO ALLOW FOR THE SILT FENCE FABRIC TO BE LAYED IN THE GROUND AND BACKFILLED WITH COMPACTED MATERIAL.
  - SILT FENCE SHOULD BE SECURELY FASTENED TO EACH STEEL SUPPORT POST OR TO WOODEN WIPES WHEN IN TURN IT IS ATTACHED TO THE STEEL FENCE POST. THERE SHALL BE FABRIC WIPES SECURELY FASTENED WHICH LINE UP.
  - INSPECTION SHALL BE MADE EVERY TWO WEEKS AND AFTER EACH LOT RAINFALL. REPAIR OR REPLACEMENT SHALL BE MADE PROMPTLY AS NEEDED.
  - SILT FENCE SHALL BE REMOVED WHEN THE SITE IS COMPLETELY STABILIZED OR 30 DAYS NOT TO BLOCK OR IMPED STORM FLOW OR DRAINAGE.
  - ACCUMULATED SILT SHALL BE REMOVED WHEN IT REACHES A DEPTH OF HALF THE HEIGHT OF THE FENCE. THE SILT SHALL BE DISPOSED OF AT AN APPROVED SITE AND IN SUCH A MANNER AS TO NOT CONTRIBUTE TO ADDITIONAL POLLUTION.

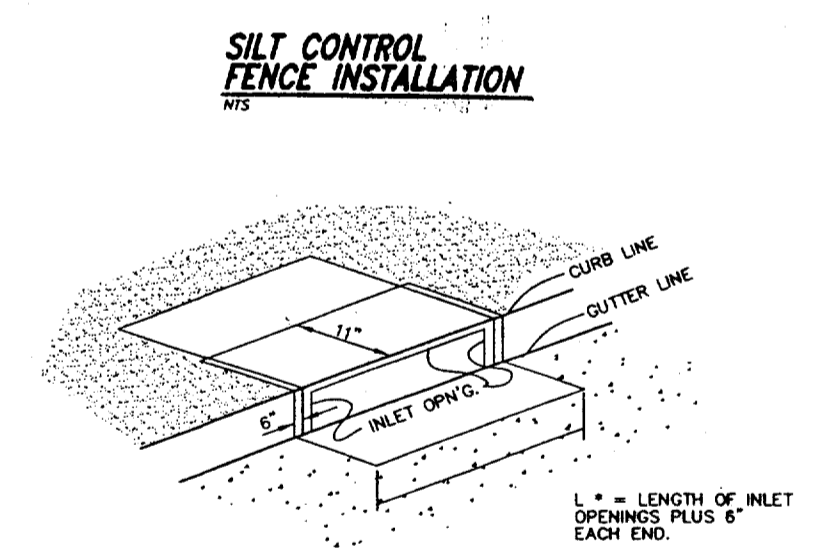

- GENERAL NOTES:**
- FRAME TO BE MADE OF 4 GAUGE GALVANIZED STEEL. 3" x 8" SQUARE FOR SECTION ADJACENT TO FACE OF INLET. 4" x 8" SQUARE FOR TOP AND BOTTOM SECTIONS.
  - FILTER FABRIC TO BE TS 500 POLYFIBER.
  - CURB INLET PROTECTION TO BE MANUFACTURED BY TEXAS ENVIRONMENTAL MANAGEMENT, INC. OR EQUAL (DESIGN ENGINEER TO APPROVE SUBSTITUTE PRIOR TO INSTALLATION).

**CURB INLET PROTECTION**

- LEGEND**
- FG = FINISH GRADE
  - EG = EXISTING GRADE
  - HP = HIGH POINT
  - TC = TOP OF CURB
  - TP = TOP OF PAVEMENT
  - TS = TOP OF SIDEWALK
  - TW = TOP OF WALL
  - BW = BOTTOM OF WALL
  - FS = FLOW LINE OF SWALE

- NOTE:**
- TOPOGRAPHIC INFORMATION PROVIDED BY DOUG CONNALLY & ASSOC., INC.
  - INSTALL WIRE BACKED SILT FENCE OR OTHER APPROVED EROSION CONTROL DEVICES TO CONTROL SILT RUN OFF FROM THE LOT TO THE STREET AND ADJACENT PROPERTY.

**RECORD DRAWINGS**

These record drawings have been prepared using information provided by the Construction Contractor and/or Owner. The signature below only signifies that the plans have been revised in accordance with the information provided and does not guarantee that these plans accurately show every detail of the constructed project.

*Richard W. Burns* Signature      05-08-07 Date

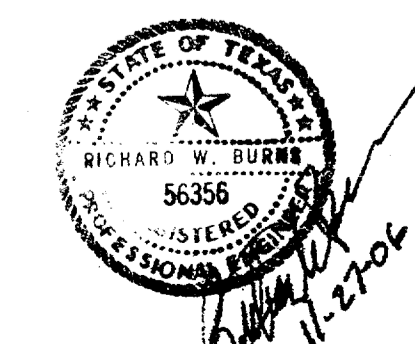

REVISED 01/18/07, COMBINED SAN. SEWER SERV. & SAND TRAP SERV  
REVISED 01/18/07, ADJUSTED FINAL GRADES  
REVISED 01/06/07 PER CITY COMMENTS DATED 01/04/07  
REVISED 12/29/06 PER CITY COMMENTS DATED 12/20/06

**GRADING & EROSION CONTROL PLAN  
LOT 12, BLOCK B, ADDISON  
AIRPORT INDUSTRIAL DISTRICT  
ENTERPRISE RENT-A-CAR  
15500 MIDWAY ROAD  
ADDISON, TEXAS**

**AMC BUILDING COMPANY  
4040 VERNON WAY  
KELLER, TEXAS 76248  
TEL. : 817.296.2895, FAX. : 817.741.7322**

KMT, INC., RICHARD W. BURNS, P.E.  
P. O. BOX 1775  
KELLER, TEXAS 76244  
TEL. : 817.431.3785  
FAX. : 817.431.8272

REVISED : 01/18/07  
REVISED : 01/06/07  
REVISED : 12/29/06  
PREPARED : 11/27/06