

EXIST. FIRE HYDRANT
120' +/- EAST OF SOUTHEAST
CORNER OF TRACT

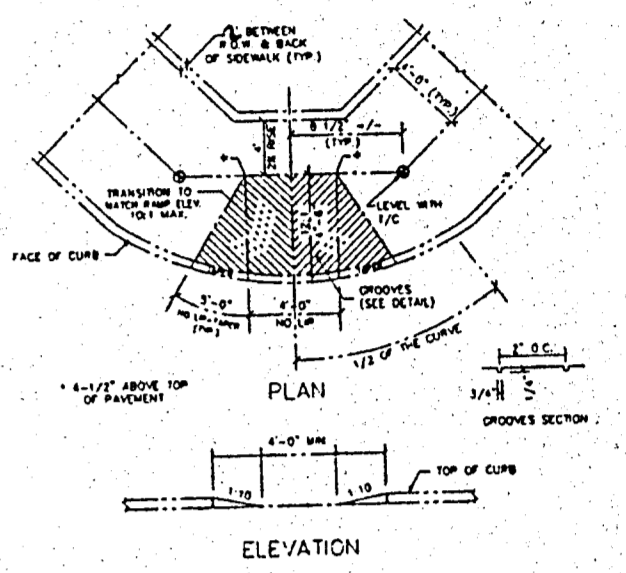

NOTES:
1. INSTALL 1/2" x 8" x 18" SMOOTH CORNERS @ 18"
2. CURBS SHALL BE 6" HIGH AND 6" WIDE
3. ALL CURBS SHALL BE CONCRETE WITH THE LATEST REQUIREMENTS OF THE
4. CONCRETE FOR CURBS SHALL BE CLASS 4
5. CURBS SHALL BE FINISHED WITH CONCRETE STAIN. THE FOLLOWING
6. CURBS SHALL BE FINISHED WITH CONCRETE STAIN BY THE NAME
7. CURBS SHALL BE FINISHED WITH CONCRETE STAIN BY THE NAME
8. CURBS SHALL BE FINISHED WITH CONCRETE STAIN BY THE NAME

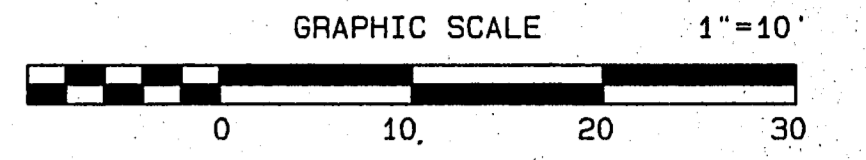
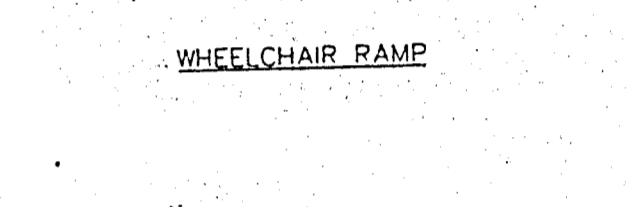

NOTES:
1. A 3" SMOOTH CORNER BAR SHALL BE USED IN 3" HIGH CURBS
2. LONGITUDINAL BUTT JOINTS SHALL BE UTILIZED IN PLACE OF LONGITUDINAL REINFORCED JOINTS AT CURB AND SIDEWALK
3. CURBS SHALL BE FINISHED WITH CONCRETE STAIN BY THE NAME
4. CURBS SHALL BE FINISHED WITH CONCRETE STAIN BY THE NAME
5. CURBS SHALL BE FINISHED WITH CONCRETE STAIN BY THE NAME

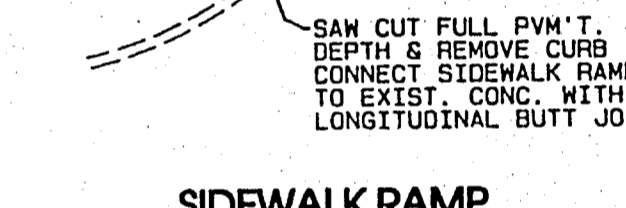

NOTES:
1. A 3" SMOOTH CORNER BAR SHALL BE USED IN 3" HIGH CURBS
2. LONGITUDINAL BUTT JOINTS SHALL BE UTILIZED IN PLACE OF LONGITUDINAL REINFORCED JOINTS AT CURB AND SIDEWALK
3. CURBS SHALL BE FINISHED WITH CONCRETE STAIN BY THE NAME
4. CURBS SHALL BE FINISHED WITH CONCRETE STAIN BY THE NAME
5. CURBS SHALL BE FINISHED WITH CONCRETE STAIN BY THE NAME

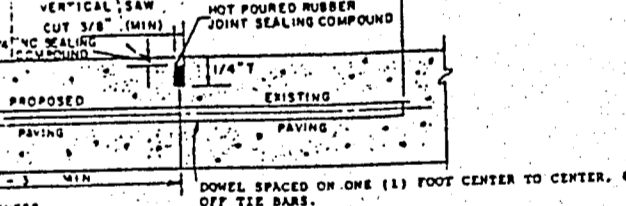

NOTES:
1. A 3" SMOOTH CORNER BAR SHALL BE USED IN 3" HIGH CURBS
2. LONGITUDINAL BUTT JOINTS SHALL BE UTILIZED IN PLACE OF LONGITUDINAL REINFORCED JOINTS AT CURB AND SIDEWALK
3. CURBS SHALL BE FINISHED WITH CONCRETE STAIN BY THE NAME
4. CURBS SHALL BE FINISHED WITH CONCRETE STAIN BY THE NAME
5. CURBS SHALL BE FINISHED WITH CONCRETE STAIN BY THE NAME

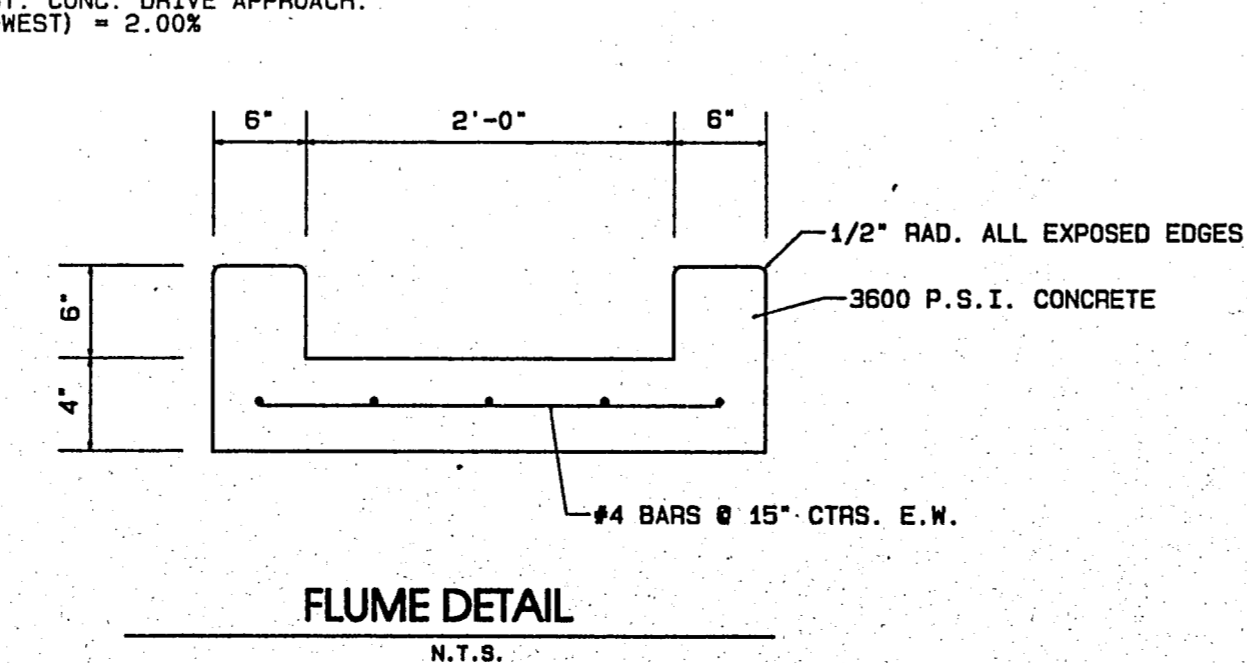
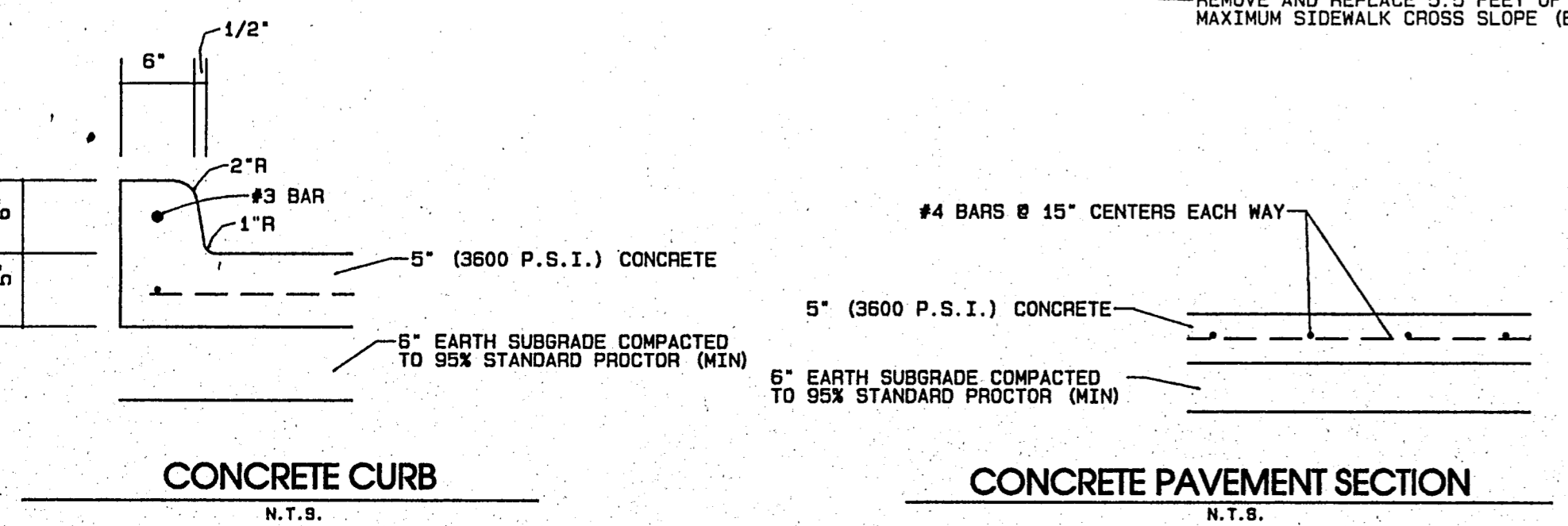
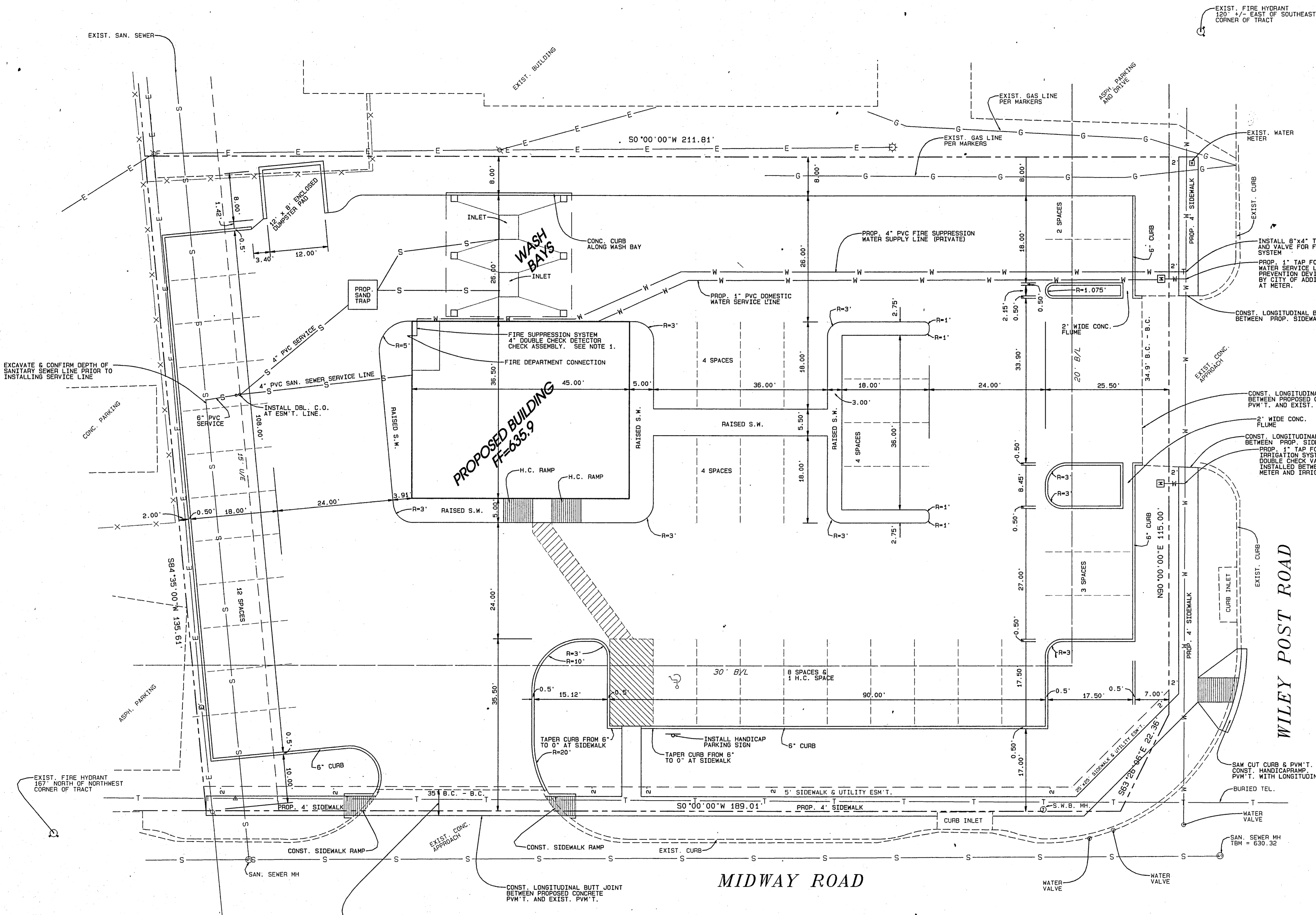

NOTE:
1. A TOUCH PAD FOR THE 4" DOUBLE CHECK DETECTOR ASSEMBLY SHALL BE MOUNTED ON THE EXTERIOR OF THE BUILDING AND SHALL BE ACCESSIBLE AT ALL TIMES.

RECORD DRAWINGS
These record drawings have been prepared using information provided by the Construction Contractor and/or Owner. The signature below only signifies that the plans have been revised in accordance with the information provided and does not guarantee that these plans accurately show every detail of the constructed project.

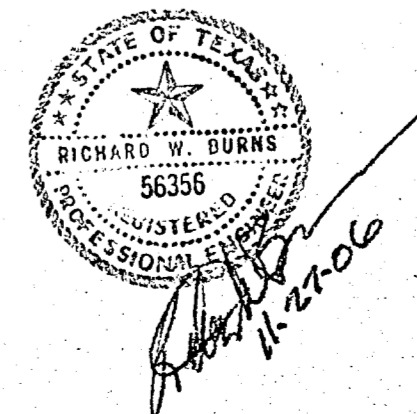

REVISED 01/18/07, COMBINED SAN. SEWER SERV. & SAND TRAP SERV
REVISED 01/18/07, ADJUSTED FINAL GRADES
REVISED 01/06/07 PER CITY COMMENTS DATED 01/04/07
REVISED 12/29/06 PER CITY COMMENTS DATED 12/20/06

SITE PLAN
LOT 12, BLOCK B, ADDISON
AIRPORT INDUSTRIAL DISTRICT
ENTERPRISE RENT-A-CAR
15500 MIDWAY ROAD
ADDISON, TEXAS
AMC BUILDING COMPANY
4040 VERNON WAY
KELLER, TEXAS 76248
TEL. : 817.296.2895, FAX. : 817.741.7322

KMT, INC., RICHARD W. BURNS, P.E.
P. O. BOX 1775
KELLER, TEXAS 76244
TEL. : 817.431.3785
FAX. : 817.431.8272

REVISED : 01/18/07
REVISED : 01/06/07
REVISED : 12/29/06
PREPARED : 11/27/06