

PLANS FOR THE CONSTRUCTION OF PAVING, WATER, WASTE WATER & DRAINAGE FACILITIES FOR **THE NJ MALIN EXPANSION** ADDISON, TEXAS

JAN, 2008
PW #2008-01

PREPARED FOR:

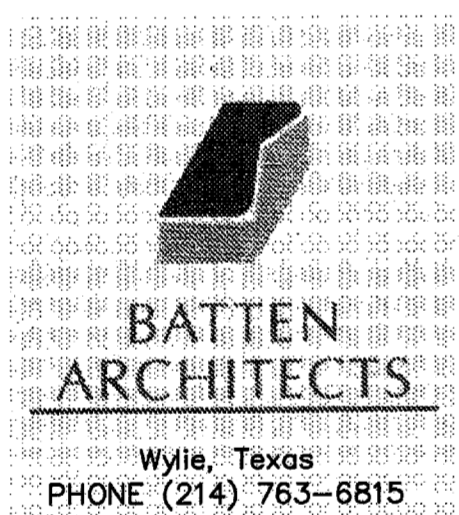

OWNER/DEVELOPER:

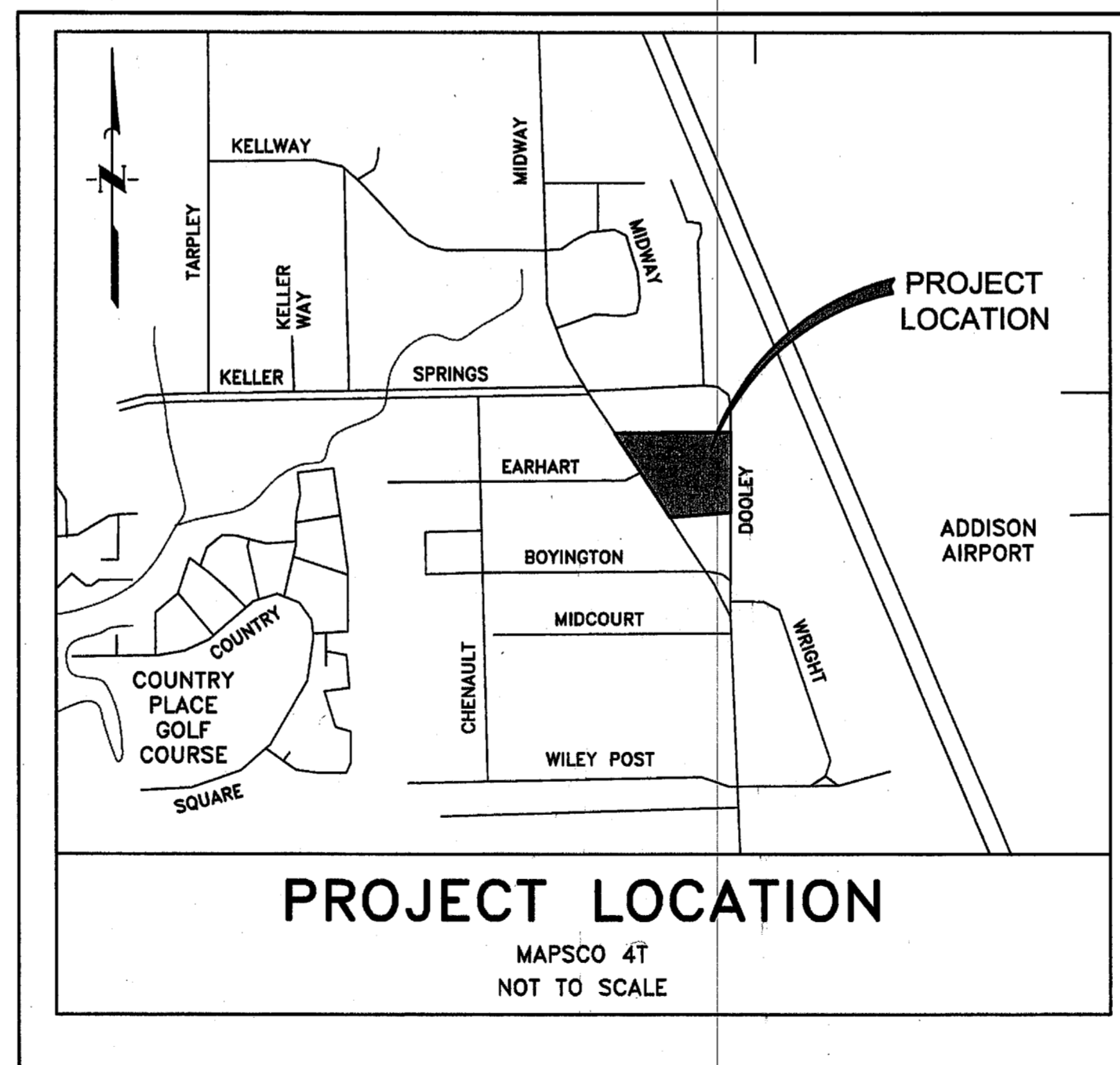

PREPARED BY:



TRC ENGINEERS, INC.
6115 Camp Bowie Blvd., Suite 200, Fort Worth, Texas 76116-5500
PHONE (817) 335-5065 • FAX (817) 335-5067

SHEET INDEX

SHEET No.

C-1	COVER SHEET
C-2	DEMOLITION PLAN
C-3	SITE, PAVEMENT & DIMENSION CONTROL PLAN
C-4	GRADING & DRAINAGE PLAN
C-5	STORM DRAIN PLAN
C-6	UTILITY PLAN
C-7	EROSION CONTROL PLAN
C-8	EROSION CONTROL DETAILS
C-9	PAVING & MISCELLANEOUS DETAILS

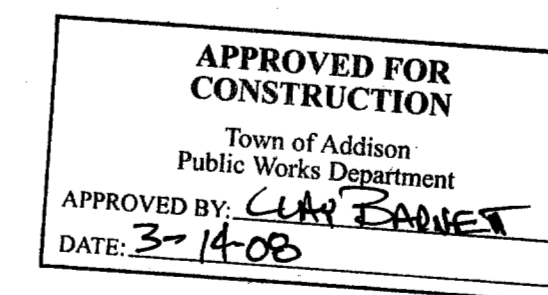

All responsibility for the adequacy of these plans remains with the Engineer who prepared them. In approving these plans, the Town of Addison makes no representation of adequacy of the work of the Design Engineer.

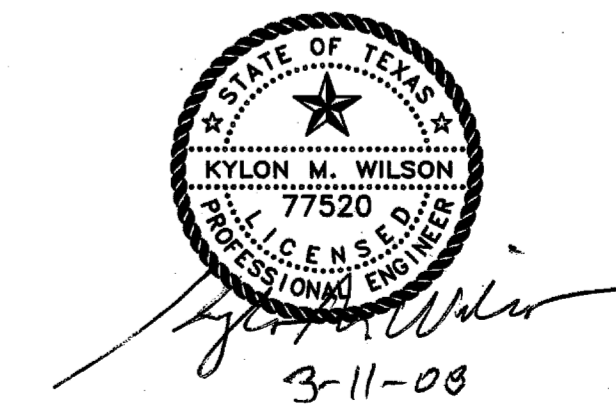

PROJECT MANAGER: KYLON WILSON, P.E.