

Sta. 30+00  
I.P. Set 100' Lt.

Sta. 30+00  
I.P. Set 50' Lt.

Sta. 30+00  
I.P. Set 50' Rt.

Sta. 30+00  
I.P. Set 100' Rt.

Sta. 35+00  
I.P. Set 100' Lt.

Sta. 35+00  
I.P. Set 50' Lt.

Sta. 35+00  
I.P. Set 50' Rt.

Sta. 35+00  
I.P. Set 100' Rt.

CAUTION: Underground Telephone

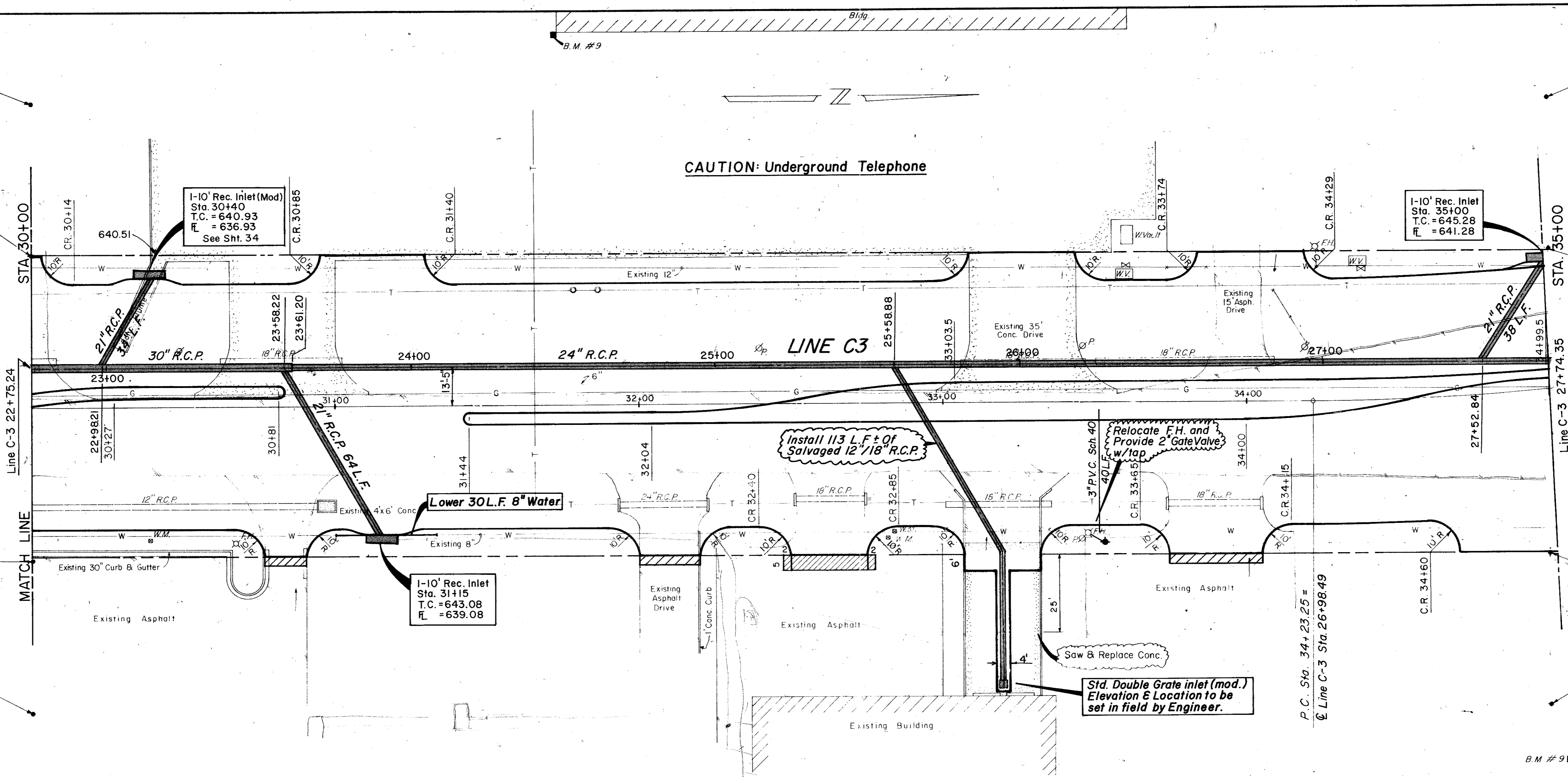

Install 113 L.F. of Salvaged 12"/18" R.C.P.

Relocate F.H. and Provide 2 Gate Valve w/ tap

Std. Double Gate inlet (mod.)  
Elevation & Location to be set in field by Engineer.

B.M. # 9 On Conc. Pavement At S.E. Corner Of Bldg. At 15635 Midway Rd. Elev. 642.61

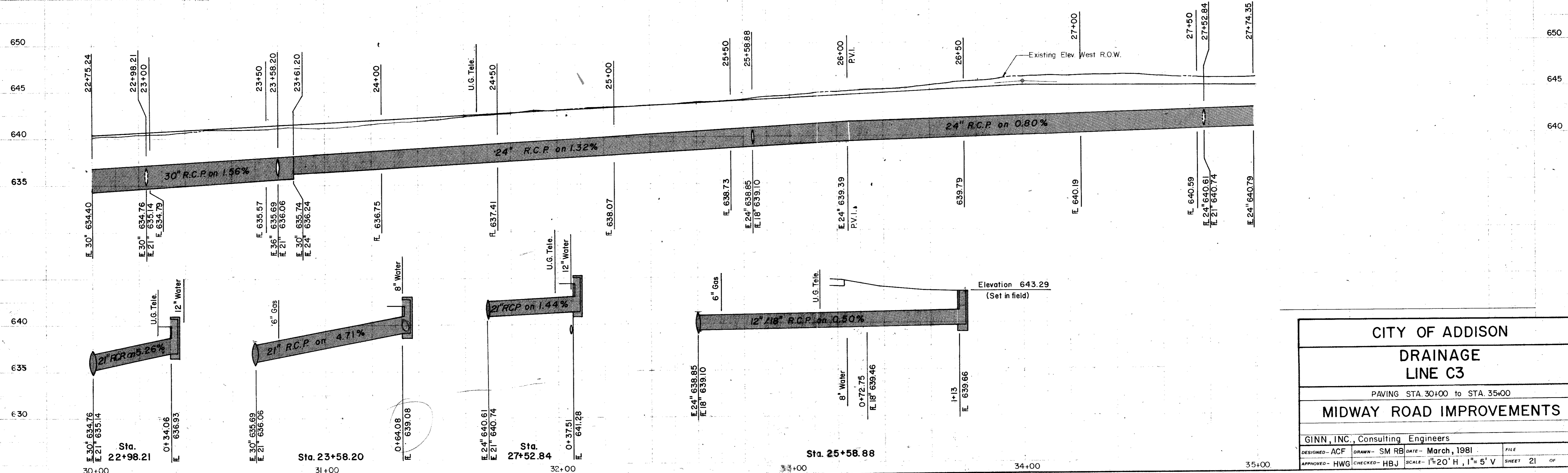

<b>CITY OF ADDISON</b>			
<b>DRAINAGE LINE C3</b>			
PAVING STA. 30+00 to STA. 35+00			
<b>MIDWAY ROAD IMPROVEMENTS</b>			
GINN, INC., Consulting Engineers			
DESIGNED - ACF	DRAWN - SM RB	DATE - March, 1981	FILE
APPROVED - HWG	CHECKED - HBJ	SCALE - 1"=20' H, 1"=5' V	SHEET 21 OF