

SECTION A-A
 DETAIL - TEMPORARY CROSSING
 NOTE: Salvaged flexible base mat. shall be used with approval of Engineer.

B.M. #5 On Conc. Walk At N.E. Corner Of Bldg. At 15321 Midway Rd. Elev. 625.55

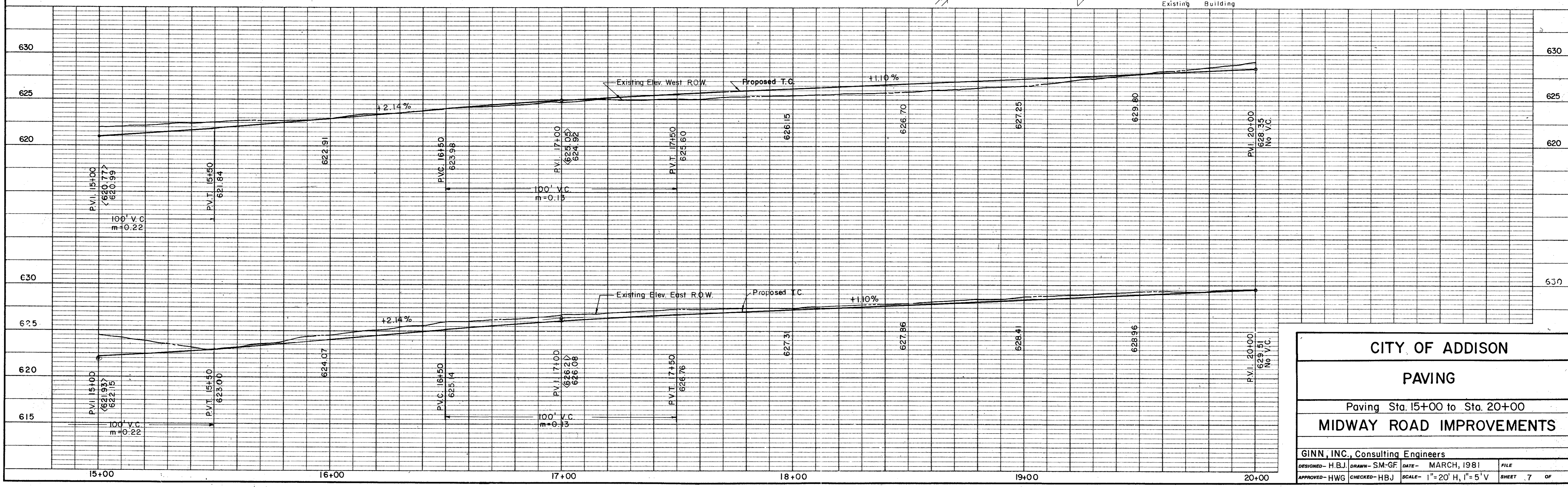

CITY OF ADDISON

PAVING

Paving Sta. 15+00 to Sta. 20+00
MIDWAY ROAD IMPROVEMENTS

GINN, INC., Consulting Engineers

DESIGNED - H.B.J. DRAWN - SM-GF DATE - MARCH, 1981 FILE
 APPROVED - HWG CHECKED - HBJ SCALE - 1" = 20' H, 1" = 5' V SHEET 7 OF